

m#P04

DISPLAY THIS CARD ON PRINCIPAL FRONTAGE OF WORK

CITY OF PORTLAND

BUILDING DEPARTMENT

PERMIT

MAY 2 2005

Permit Number: 05058

CITY OF PORTLAND

Please Read Application And Notes, If Any, Attached

This is to certify that Jaegerman Alexander Q &/D Kolbert & Remodeling
has permission to Replace bearing roof posts, deck beam & eewal along steps add a handrail
AT 398 Spring St 061 D001001

provided that the person or persons, firm or corporation accepting this permit shall comply with all of the provisions of the Statutes of Maine and of the ordinances of the City of Portland regulating the construction, maintenance and use of buildings and structures, and of the application on file in this department.

Apply to Public Works for street line and grade if nature of work requires such information.

Notification of inspection must be given and written permission procured before this building or part thereof is laid or closed-in. **HEAVY NOTICE IS REQUIRED.**

A certificate of occupancy must be procured by owner before this building or part thereof is occupied.

OTHER REQUIRED APPROVALS

Fire Dept. _____
Health Dept. _____
Appeal Board _____
Other _____
Department Name _____

Debbie Bourke 5/25/05
Director - Building & Inspection Services

PENALTY FOR REMOVING THIS CARD

City of Portland, Maine - Building or Use Permit Application

389 Congress Street, 04101 Tel: (207) 874-8703, Fax: (207) 874-8716

Permit No: 05-0584	Issue Date: MAY 25 2005	City: 061 D001001
-----------------------	-----------------------------------	----------------------

Location of Construction: 398 Spring St	Owner Name: Jaegerman Alexander Q &	Owner Address: 398 Spring St	Phone: 772-0955
Business Name:	Contractor Name: Dan Kolbert Building & Remodeling	Contractor Address: 90 Gray St Portland	Phone: 207-6507650
Lessee/Buyer's Name	Phone:	Permit Type: Alterations - Dwellings	Zone: R-4

Past Use: Single Family	Proposed Use: Single Family w/repair to front porch in historic district	Permit Fee: \$156.00	Cost of Work: \$15,000.00	CEO District: 2
		FIRE DEPT: <input type="checkbox"/> Approved <input type="checkbox"/> Denied	INSPECTION: Use Group: R3 Type: 5B	

Proposed Project Description: Replace bearing roof posts, deck beam & kneewalls along steps, add a handrail	Signature: <i>JMB 5/25/05</i>
PEDESTRIAN ACTIVITIES DISTRICT (P.A.D.)	
Action: <input type="checkbox"/> Approved <input type="checkbox"/> Approved w/Conditions <input type="checkbox"/> Denied	
Signature: _____ Date: _____	

Permit Taken By: jmb	Date Applied For: 05/16/2005	Zoning Approval	
-------------------------	---------------------------------	------------------------	--

<p>1. This permit application does not preclude the Applicant(s) from meeting applicable State and Federal Rules.</p> <p>2. Building permits do not include plumbing, septic or electrical work.</p> <p>3. Building permits are void if work is not started within six (6) months of the date of issuance. False information may invalidate a building permit and stop all work..</p>	<p>Special Zone or Reviews</p> <p><input type="checkbox"/> Shoreland</p> <p><input type="checkbox"/> Wetland</p> <p><input type="checkbox"/> Flood Zone</p> <p><input type="checkbox"/> Subdivision</p> <p><input type="checkbox"/> Site Plan</p> <p>Maj <input type="checkbox"/> Minor <input type="checkbox"/> MM <input type="checkbox"/></p> <p>Date: <i>JMB 5/16/05</i></p>	<p>Zoning Appeal</p> <p><input type="checkbox"/> Variance</p> <p><input type="checkbox"/> Miscellaneous</p> <p><input type="checkbox"/> Conditional Use</p> <p><input type="checkbox"/> Interpretation</p> <p><input checked="" type="checkbox"/> Approved</p> <p><input type="checkbox"/> Denied</p> <p>Date: _____</p>	<p>Historic Preservation</p> <p><input type="checkbox"/> Not in District or Landmark</p> <p><input type="checkbox"/> Does Not Require Review</p> <p><input checked="" type="checkbox"/> Requires Review</p> <p><input checked="" type="checkbox"/> Approved</p> <p><input type="checkbox"/> Approved w/Conditions</p> <p><input type="checkbox"/> Denied</p> <p>Date: <i>J. Andrews 5/25/05</i></p>
	<p><i>14-385</i> <i>refers to existing footprint</i></p>		

CERTIFICATION

I hereby certify that I am the owner of record of the named property, or that the proposed work is authorized by the owner of record and that I have been authorized by the owner to make this application as his authorized agent and I agree to conform to all applicable laws of this jurisdiction. In addition, if a permit for work described in the application is issued, I certify that the code official's authorized representative shall have the authority to enter all areas covered by such permit at any reasonable hour to enforce the provision of the code(s) applicable to such permit.

SIGNATURE OF APPLICANT	ADDRESS	DATE	PHONE
RCSPONSLBLE PERSON IN CHARGE OF WORK, TITLE		DATE	PHONE

City of Portland, Maine - Building or Use Permit

389 Congress Street, 04101 Tel: (207) 874-8703, Fax: (207) 874-8716

Permit No: 05-0584	Date Applied For: 0511612005	CBL: 061 D001001
-----------------------	---------------------------------	---------------------

Location of Construction: 398 Spring St	Owner Name: Jaegerman Alexander Q &	Owner Address: 398 Spring St	Phone: () 772-0955
Business Name:	Contractor Name: Dan Kolbert Building & Remodeling	Contractor Address: 90 Gray St Portland	Phone: (207) 650-7650
Lessee/Buyer's Name	Phone:	Permit Type: Alterations - Dwellings	

Proposed Use: Single Family w/repair to front porch in historic district	Proposed Project Description: Replace bearing roof posts, deck beam & kneewalls along steps, add a handrail
---	--

Dept: Historical Status: Approved with Conditions Reviewer: Deborah Andrews Approval Date: 05/25/2005
 Note: Ok to Issue:

1) Original skirting to be retained or replaced in kind

~~Dept: Zoning Status: Approved Reviewer: Jeanine Bourke Approval Date: 05/16/2005~~
~~Note: Ok to Issue:~~

Dept: Building Status: Approved Reviewer: Jeanine Bourke Approval Date: 05/25/2005
 Note: Ok to Issue:



Residential Building Permit Application

If you or the property owner owes real estate or personal property taxes or user charges on any property within the City, payment arrangements must be made before permits of any kind are accepted.

Location/Address of Construction: <u>398 SPRING ST</u>		
Total Square Footage of Proposed Structure	Square Footage of Lot	
Tax Assessor's Chart, Block & Lot Chart# <u>61</u> Block# <u>D</u> Lot# <u>1</u>	Owner: <u>Alexander J. Jagerman Susan Morris</u>	Telephone: <u>772-6455</u>
Lessee/Buyer's Name (If Applicable)	Applicant name, address & telephone: <u>Don Kolbert Bldg. Serv LLC</u> <u>90 Gray St</u> <u>Portland, OR 97202</u> <u>879-7019</u>	Cost Of Work: \$ <u>15,000</u> Fee: \$
Current Specific use: <u>Front Entry Porch</u>		
Proposed Specific use: <u>Same</u>		
Project description: <u>Rebuild existing front entry as per plans -</u> <u>NO WORK NO ADD change in existing foot print</u>		
Contractor's name, address & telephone: <u>Applicant</u>		
Who should we contact when the permit is ready: <u>Don Kolbert</u>		
Mailing address: <u>Applicant</u>		
Phone:		

Please submit all of the information outlined in the Residential Application Checklist. Failure to do so will result in the automatic denial of your permit.

At the discretion of the Planning and Development Department, additional information may be required prior to permit approval. For further information stop by the Building Inspections office, room 315 City Hall or call 874-8703.

I hereby certify that I am the Owner of record of the named property, or that the owner of record authorizes the proposed work and that I have been authorized by the owner to make this application as his/her authorized agent. I agree to conform to all applicable laws of this jurisdiction. In addition, if a permit for work described in this application is issued, I certify that the Code Official's authorized representative shall have the authority to enter all areas covered by this permit at any reasonable hour to enforce the provisions of the codes applicable to this permit.

Signature of applicant: *Don Kolbert* Date: 5/16/05

Permit Fee: \$30.00 for the first \$1000.00 Construction Cost, \$9.00 per additional \$1000.00 cost

This is not a Permit: you may not commence any work until the Permit is issued.

This page contains a detailed description of the Parcel ID you selected. Press the **New Search** button at the bottom of the screen to submit a new query.

Current Owner Information

Card Number 1 of 1
 Parcel ID 061 D001001
 Location 398 SPRING ST
 Land Use SINGLE FAMILY

Owner Address JAEGERMAN ALEXANDER & SUSAN E MORRIS JTS
 398 SPRING ST
 PORTLAND ME 04102

Book/Page 14797/67
 Legal 61-D-1
 SPRING ST 398
 VAUGHAN ST 29-35
 5257 SF

Don 5/16 11AM
#584
Sec-14-385 reconstruct

Current Valuation Information

Land	Building	Total
\$90,090	\$193,940	\$284,030

New Estimated Valuation Information

Land	Building	Total	Phase-In Value
\$231,900	\$327,700	\$559,600	\$421,815

Property Information

Year Built 1897	Style Old Style	Story Height 2	sq. Ft. 3436	Total Acres 0.121
Bedrooms 5	Full Baths 2	Half Baths 1	Total Rooms 9	Attic Part Finsh Basement Full

Outbuildings

Type	Quantity	Year Built	size	Grade	Condition
------	----------	------------	------	-------	-----------

Sales Information

Date	Type	Price	Book/Page
06/01/1999	LAND + BLDING	\$260,000	14797-067
09/01/1992	LAND + BLDING	\$123,000	10270-113

Picture and Sketch

Picture	Sketch	Tax Map
---------	--------	---------

[Click here to view Tax Roll Information.](#)

Any information concerning tax payments should be directed to the Treasury office at 874-8490 or [e-mailed](#).

[Click here to view comparable sales or below to view by:](#)

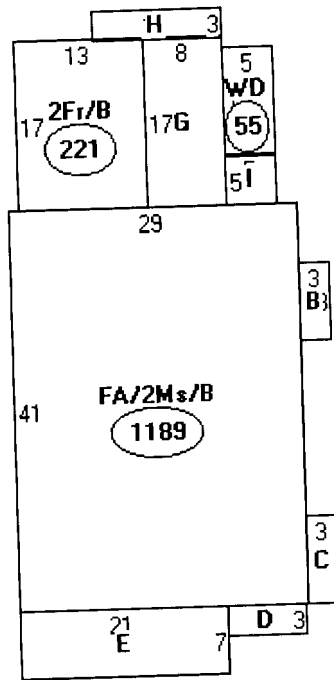

Descriptor/Area

- A:FA/2Ms/B
1189 sqft
- B:FBAY
24 sqft
- C:2sMB/B
27 sqft
- D:2sMB/B
24 sqft
- E:DFP
147 sqft
- F:2Fr/B
221 sqft
- G:WD/1Fr/B
136 sqft
- H:1Fr
39 sqft
- I: WD/FUB
25 sqft
- J:WD
55 sqft

Jalgerman \ Morris - 398 Spring St.
61-D-1

5/16/05

Jan Kolbert BTR LLC

Plot Plan

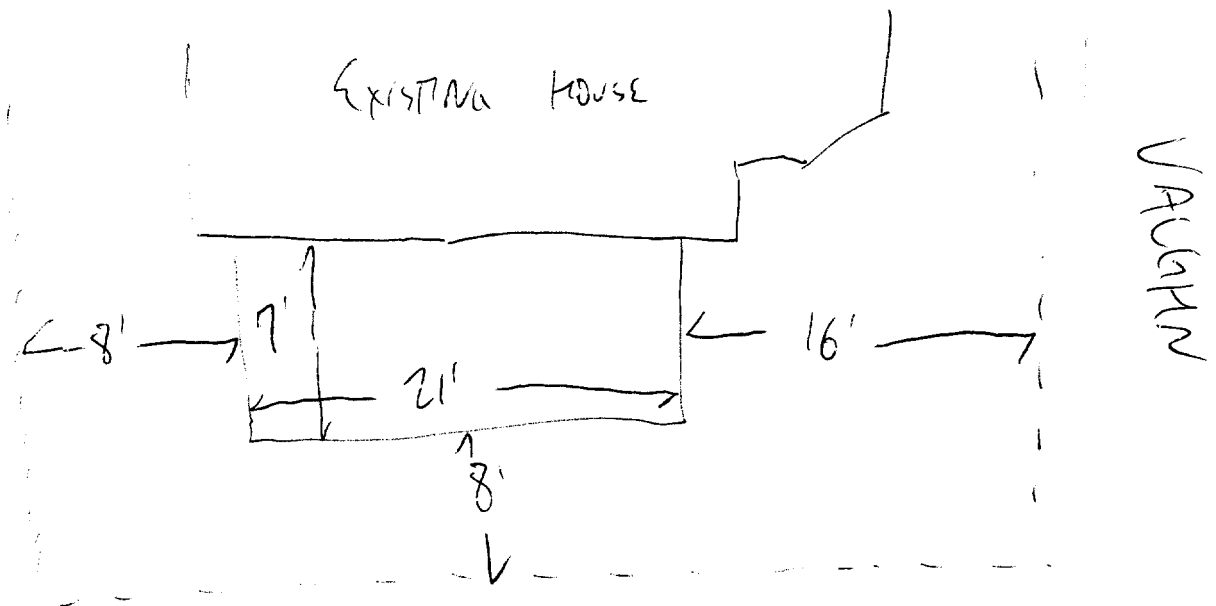

SPRING

Sec. 14-385

in existing
footprint

