

City of Portland, Maine – Building or Use Permit Application 389 Congress Street, 04101, Tel: (207) 874-8703, FAX: 874-8716

Location of Construction: 367 Spring St		Owner: Lutes Chris		Phone:		Permit No: 980413 PERMIT ISSUED Permit Issued: APR 27 1998 CITY OF PORTLAND Zone: CBL: 061-8-001		
Owner Address:		Lessee/Buyer's Name:		Phone:			Business Name:	
Contractor Name: Cash/anchors		Address: 17 Main St So, Portland 04106		Phone: 789-3111				
Past Use: Residential		Proposed Use: Same		COST OF WORK: \$			PERMIT FEE: \$ 10.00	
Proposed Project Description: Remove 500 gal tank				FIRE DEPT. <input type="checkbox"/> Approved <input type="checkbox"/> Denied		INSPECTION: Use Group: Type:		
				Signature:		Signature:		
PEDESTRIAN ACTIVITIES DISTRICT (P.A.D.) Action:				Approved <input type="checkbox"/> Approved with Conditions: <input type="checkbox"/> Denied <input type="checkbox"/>		Zoning Approval: Special Zone or Reviews: <input type="checkbox"/> Shoreland <input type="checkbox"/> Wetland <input type="checkbox"/> Flood Zone <input type="checkbox"/> Subdivision <input type="checkbox"/> Site Plan maj <input type="checkbox"/> minor <input type="checkbox"/> mm <input type="checkbox"/>		
				Signature:		Date:		
Permit Taken By: Sherry Flanagan		Date Applied For: April 21, 1998						

1. This permit application does not preclude the Applicant(s) from meeting applicable State and Federal rules.
2. Building permits do not include plumbing, septic or electrical work.
3. Building permits are void if work is not started within six (6) months of the date of issuance. False information may invalidate a building permit and stop all work..

Mail to cleananchors

PERMIT ISSUED
 WITH REQUIREMENTS

CERTIFICATION

I hereby certify that I am the owner of record of the named property, or that the proposed work is authorized by the owner of record and that I have been authorized by the owner to make this application as his authorized agent and I agree to conform to all applicable laws of this jurisdiction. In addition, if a permit for work described in the application is issued, I certify that the code official's authorized representative shall have the authority to enter all areas covered by such permit at any reasonable hour to enforce the provisions of the code(s) applicable to such permit

SIGNATURE OF APPLICANT Matt Quinn	ADDRESS:	DATE: April 21, 1998	PHONE:
RESPONSIBLE PERSON IN CHARGE OF WORK, TITLE			PHONE:

Historic Preservation

Not in District or Landmark
 Does Not Require Review
 Requires Review

Action:

Approved
 Approved with Conditions
 Denied

Date: 4-27-98

CEO DISTRICT 3

PORTLAND FIRE DEPARTMENT

Review Date: 4/27/21 Contractor: UPPER HILLS

Address: 365 Spruce St CBL: _____

Please note marked Conditions of Approval

- * The boiler or furnace shall be protected by enclosing with one hour fire rated construction including fire doors and ceiling or by providing automatic extinguishment and smoke protected enclosure. Sprinkler piping serving not more than six sprinklers may be connected to a domestic water supply system having a capacity sufficient to provide a 0.15 gpm per sq ft of floor throughout the entire area. An indicating shut-off valve shall be installed in an accessible location between the sprinkler and the connection to the domestic water supply. Minimum pipe size shall be 3/4" copper or 1" steel. Maximum coverage area of a residential sprinkler is 144 sq ft per sprinkler
- * All required fire alarm systems shall have the capacity of zone disconnect via switches or key pad program provided the method is approved by the Fire Prevention Bureau.
- * All remote annunciators shall have a visible trouble indicator along with the fire alarm zone indicators.
- * Any master box connected to the municipal fire alarm system shall have a supervised municipal disconnect switch.
- * All master box locations shall be approved by the Fire Dept. Director of Communications.
- * A master box shall be located so that the center of the box is five feet above finished floor.
- * All master box locations are required to have a Knox box.
- * A fire alarm acceptance report shall be submitted to the Portland Fire Department.
- ⊛ All underground tank removal(s) and/or installation(s) shall be done in accordance with the Department of Environmental Protection and Regulation (Chapter 691).
- ⊛ No cutting of tanks on site. Cutting of tanks to be done at an approved disposal site.
- * The fire dispatcher must be notified at least 48 hrs in advance of removal or transportation of tanks.
- * All above ground L/P tanks shall be located in accordance with NFPA 58 standards.
- * Any tank located near the path of vehicle movement shall be protected.
- * All piping shall be protected from possible mechanical damage and vandalism.
- * A 4" storz fire department connection is required.
- * Any renovation of sprinkler system over 20 heads must have State Fire Marshall approval.
- * A sprinkler performance test shall be submitted to the P.F.D. after completion of work.
- * State Fire Marshall approval is required for this project.

Lt. Gaylen Mc Dougall
Portland Fire Prevention Bureau

SUBMETER APPLICATION

(For Sewer User Charge Adjustments)



GEORGE A. FLAHERTY
DIRECTOR

PARKS & PUBLIC WORKS
55 PORTLAND STREET
PORTLAND MAINE 04101
(207) 874-8300

TO BE COMPLETED BY APPLICANT

Address where submeter is requested 357 SPRING ST. PORTLAND 04102

Property owner's name ROBERT F. + MAUREEN S. SAVADOVE

Tax Map Reference (On Real Estate Tax Bill) 61 B 2
(Assessor's Tele. No: 874-8300, ext. 8486)

Property owner's address 357 SPRING ST. PORTLAND 04102

Contact person (& tele. no.) to schedule inspections ROBT. SAVADOVE 772-7265 (DAY PHONE)

Portland Water District Account No. (On water bill) P 3603 -1 02465
(Portland Wtr. Dist. Tele. No: 761-8310)

P.W.D. Billing Name & Address (On water bill) ROBERT F. SAVADOVE
357 SPRING ST PORTLAND, ME, 04102

Size (and location) of existing Portland Water District Service Meter OUTSIDE READING LOCATION
UNDER BACK PORCH

Size (and location) of proposed submeter UNDER FRONT PORCH

Location of proposed submeter remote reading register ALSO UNDER FRONT PORCH

Description of proposed plumbing changes required for submetering RACKFLOW PARVANTEX

The volume of water to be submetered can be shown not to enter the sewerage system by virtue of its use for LAWN AND FISH POND IN YARD

The undersigned hereby requests permission to install an additional water meter ("submeter") in accordance with Section 24-76(c) of the "Code of Ordinances, the City of Portland, Maine".

It is understood that all expenses related to the purchase, installation, and maintenance of the meter is to be borne by the applicant.

I certify the above information is true and correct:

Robert F. Savadove
Signature

3-21-93
Date

DEPT. OF BUILDING INSPECTION
CITY OF PORTLAND, ME

RECEIVED
MAR 24 1993

INSTRUCTIONS

- First - The applicant is to complete the front of this form. The Tax Map Reference (i.e., the tax assessor's "CSL" number, for line 3 of the application) can be found to the right of the double asterisk, in the lower center of your Real Estate Tax Bill. The Portland Water District Account Number (for line 6 of the application) can be found at the left middle part of the Water and Sewer Bill. The billing name and address (for line 7 of the application) should be copied from your Water and Sewer Bill as well.
- Second - Mail the completed application form to:
City of Portland
Dept. of Parks & Public Works
55 Portland Street
Portland, Maine 04101-2991
ATTN: MR. FRANK BRANCIELI
- Third - The Public Works Department will call the person indicated on the front side to schedule a pre-installation inspection. During this inspection, information for the Public Works section of this form will be gathered. If the application is approved by Public Works, 3 copies will be made: one copy will be forwarded to the City Plumbing Inspector; one copy will be mailed to the Portland Water District; and one copy will be mailed to the Applicant. If the application is denied, then only one copy will be made and it will be mailed to the applicant showing the reason for denial. The original application will be kept on file in the Engineering Division, Dept. of Parks and Public Works.
- Fourth - Upon receipt of a copy of the approved application, the applicant can purchase and install the submeter, as approved. Following installation, the applicant, or a plumber, must call the Chief of Inspection Servs. at 874-8300, Ext. 8706 for an installation inspection. Following this plumbing inspection, the Portland Water District will be requested to seal the submeter, and subsequently to read and to credit the volume shown on the submeter to the Sewer User Charges of the applicant's water bill.

GENERAL INFORMATION

Section 24-76(c) of the "Code of Ordinances, City of Portland, Maine" reads as follows:

"Submetering of Water Volume. Any person who feels that recorded water records are not a reliable index of his discharge volume may install an additional water meter of a type approved by the public works authority to measure the volume of water which can be shown not to enter the sewerage system. The person installing such a meter shall immediately notify the public works authority of such installation and shall be responsible to the public works authority for reporting meter readings not less often than every three months. Such person shall be credited with the volume charges for the volume shown by such meter, which meter shall be accessible for reading by the City, or its agents, at all reasonable times."

The City and the Water District have arranged to relieve the customer from the reporting responsibility required above, if both meters can be read simultaneously by the District Meter Readers, during their regularly scheduled visits to read the pre-existing service meter. This can be accomplished by locating the submeter directly adjacent to the pre-existing service meter, or by equipping the submeter, located elsewhere, with a remote reading register, so that both service and submeter readings can be made simultaneously.

Approved "Neptune" and "Rockwell" meters shall have the following specifications: (1) a bronze case; (2) the meter number stamped into the main bronze case; (3) straight reading, cubic foot registers; (4) a magnetic drive; (5) either a nutating disc or oscillating piston; (6) met, or exceeded, ANSI accuracy (see requirements and be accompanied by a certificate of test accuracy. Approved meters are available from the Portland Water District, which sells them at the manufacturer's price. If you wish to purchase a submeter from the District, you must bring your yellow copy of the approved application with you, at the time of purchase.

TO BE COMPLETED BY APPLICANT

A sketch showing: the location of the existing and proposed meters; the location of the proposed remote reading register; the proposed plumbing changes; and the water flow through the submeter to the non-discharge equipment (or location).

① EXISTING METER IN BASEMENT

② REMOTE READING REGISTER OF EXISTING METER

③ PROPOSED METER AND REMOTE READING REGISTER

④ + ⑤ LAWN + YARD

PLUMBING EXCEPT FOR BACKFLOW PREVENTER, IS IN PLACE

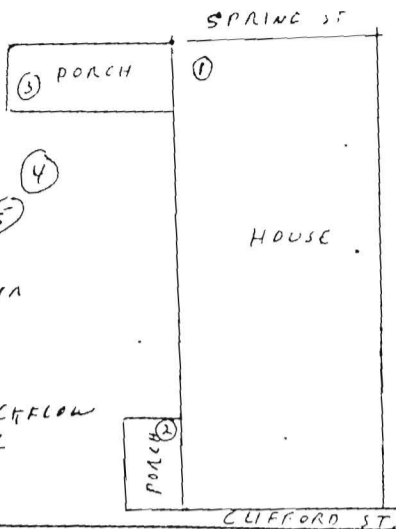

NOT REQUIRED AT THIS TIME

TO BE COMPLETED BY PUBLIC WORKS

MARCH 23, 1993

NANCY KNAUBER

Automatic reading system to be installed YES NO

A WATTS # 8 Back Flow Preventer, or equal, shall be installed _____

Application Approved Denied

Comments SUBMETER REMOTE IS TO BE LOCATED NEAR EXISTING REMOTE. SUBMETER IS TO BE INSTALLED IN AN UPRIGHT POSITION & SO IT MIGHT BE READ

TO BE COMPLETED BY THE PLUMBING INSPECTOR

An inspection of the completed submetering system installation approved on this application was conducted on _____ by _____, City of Portland, Maine.

The submetering system was installed as approved.

No cross connections were found. READING _____

The installation is Approved Disapproved

Comments _____

TO BE COMPLETED BY THE WATER DISTRICT

Date submeter sold _____

Submeter account number _____

Submeter make and serial number _____

Submeter installation readings _____

Submeter account entered into computer _____

Submeter account entered into meter book _____