

Legal Description

MAINE CENTRAL RAILROAD PARCEL

A CERTAIN LOT OR PARCEL OF LAND SITUATED ON THE EASTERLY SIDE OF WEST COMMERCIAL STREET IN THE CITY OF PORTLAND, COUNTY OF CUMBERLAND AND STATE OF MAINE BOUNDED AND DESCRIBED AS FOLLOWS:

COMMENCING AT A GRANITE MONUMENT IN A MANHOLE LOCATED IN THE SOUTHERLY SIDELINE OF WEST COMMERCIAL STREET AS SHOWN ON "LAND ON WEST COMMERCIAL STREET, PORTLAND, MAINE, MAINE CENTRAL RAILROAD COMPANY TO NEW YARD LLC" DATED JULY 30, 2013, BY OWEN HASKELL, INC. TO BE RECORDED IN THE CUMBERLAND COUNTY REGISTRY OF DEEDS;

THENCE, S 32°36'10" W ALONG THE SOUTHERLY SIDELINE OF WEST COMMERCIAL STREET 86.09 FEET TO THE POINT OF BEGINNING;

THENCE, FROM SAID POINT OF BEGINNING S 32°31'38" E ALONG LAND NOW OR FORMERLY OF PORTLAND TERMINAL COMPANY AND LAND NOW OR FORMERLY OF THE CITY OF PORTLAND 580 FEET MORE OR LESS TO LOW WATER;

THENCE, WESTERLY AND SOUTHWESTERLY ALONG LOW WATER 64 FEET MORE OR LESS TO LAND NOW OR FORMERLY OF CASCO WHARF & STORAGE AS DESCRIBED IN DEED RECORDED IN SAID REGISTRY OF DEEDS IN BOOK 1507, PAGE 126;

THENCE, N 32°31'38" W ALONG LAND NOW OR FORMERLY OF SAID CASCO WHARF & STORAGE 14 FEET MORE OR LESS TO THE NORTHEAST CORNER OF LAND NOW OR FORMERLY OF SAID CASCO WHARF & STORAGE;

THENCE, N 59°25'20" W ALONG LAND NOW OR FORMERLY OF SAID CASCO WHARF & STORAGE 602.21 FEET TO LAND NOW OR FORMERLY OF PORTLAND GAS LIGHT CO. AS DESCRIBED IN DEED RECORDED IN SAID REGISTRY OF DEEDS IN BOOK 346, PAGE 374 AND BOOK 645, PAGE 419;

THENCE, S 33°20'20" W ALONG LAND NOW OR FORMERLY OF SAID PORTLAND GAS LIGHT CO. 430 FEET MORE OR LESS TO LOW WATER;

THENCE, WESTERLY ALONG LOW WATER 679 FEET MORE OR LESS TO A POINT;

THENCE, N 18°58'37" W ALONG REMAINING LAND OF THE GRANTOR 541 FEET MORE OR LESS TO THE SOUTHERLY SIDELINE OF WEST COMMERCIAL STREET;

THENCE, N 73°01'23" E ALONG THE SOUTHERLY SIDELINE OF SAID WEST COMMERCIAL STREET 1053.20 FEET;

THENCE, N 32°38'10" E ALONG THE SOUTHERLY SIDELINE OF SAID WEST COMMERCIAL STREET 551.51 FEET TO THE POINT OF BEGINNING.

EXCEPTING FROM THE ABOVE DESCRIBED PARCEL THE FOLLOWING PARCEL OF LAND:

BEGINNING AT A POINT LOCATED 404.28 FEET ON A COURSE OF S 87°32'13" E FROM THE MOST NORTHWEST CORNER OF THE ABOVE DESCRIBED LOT;

THENCE THE FOLLOWING COURSES AND DISTANCES:

- N 70°47'58" E 181.08 FEET;
- N 70°50'01" E 232.75 FEET;
- N 70°47'58" E 20.12 FEET;
- S 25°12'02" E 6.50 FEET;
- N 79°57'28" E 33.57 FEET;
- N 70°47'58" E 36.77 FEET;
- N 70°47'58" E 226.63 FEET;

ALONG A CURVE TO THE RIGHT HAVING A RADIUS OF 603.80 FEET AN ARC DISTANCE OF 190.40 FEET, BEARING A CHORD OF S 23°07'23" W A DISTANCE OF 189.61 FEET;

- S 43°11'47" E 2.93 FEET;
- S 33°30'33" W 256.74 FEET;
- S 57°20'08" W 167.99 FEET;
- N 43°25'17" W 435.50 FEET TO THE POINT OF BEGINNING CONTAINING 3.96 ACRES.

THE TOTAL AREA OF THE ABOVE DESCRIBED PARCEL IS 14.86 ACRES MORE OR LESS. THE PROPERTY IS ALSO CONVEYED TOGETHER WITH THE BENEFIT OF THE RIGHT OF WAY AS DESCRIBED IN THE EASEMENT DEED FROM THE CITY OF PORTLAND TO PORTLAND TERMINAL COMPANY, DATED FEBRUARY 25, 1971 AND RECORDED IN SAID REGISTRY OF DEEDS IN BOOK 3161, PAGE 93.

STATE OF MAINE, CUMBERLAND, ss
REGISTRY OF DEEDS
RECEIVED _____
AT _____ hr. _____ min. _____ m AND RECORDED
IN PLAN BOOK _____, PAGE _____
ATTEST: _____ REGISTER

Legal Description

PROPERTY DESCRIPTION TO LEASE AGREEMENT BETWEEN UNITIL AND NEW YARD, LLC

THE FOLLOWING DESCRIPTION IS BASED UPON THE PLAN DEFINED BELOW, AND IS BELIEVED BY THE PARTIES TO BE REPRESENTATIVE OF THE PROPERTY. IN THE EVENT OF INCONSISTENCY BETWEEN THE PLAN AND THE MARCH 1, 1985 SURVEY PREPARED BY H.L. AND E.C. JORDAN FOR NORTHERN UTILITIES (THE "1985 SURVEY"), AT UNITIL'S DISCRETION, THE 1985 SURVEY SHALL CONTROL.

UNITIL PARCEL DESCRIPTION TM 59-A-5, 6, 9 & 10

A CERTAIN LOT OR PARCEL OF LAND SITUATED SOUTHEASTERLY OF BUT NOT ADJACENT TO WEST COMMERCIAL STREET IN THE CITY OF PORTLAND, COUNTY OF CUMBERLAND AND STATE OF MAINE BOUNDED AND DESCRIBED AS FOLLOWS:

COMMENCING AT A GRANITE MONUMENT IN A MANHOLE LOCATED IN THE SOUTHEASTERLY SIDELINE OF WEST COMMERCIAL STREET AS SHOWN ON "ALTA/ACSM LAND TITLE SURVEY ON WEST COMMERCIAL STREET, PORTLAND, MAINE MADE FOR NEW YARD LLC" DATED JULY 2, 2012 REVISED THRU JULY 29, 2013 BY OWEN HASKELL, INC. (THE "PLAN");

THENCE, S 32°36'10" W ALONG THE SOUTHERLY SIDELINE OF WEST COMMERCIAL STREET 152.22 FEET;

THENCE, S 32°31'38" E THROUGH LAND NOW OR FORMERLY OF PORTLAND TERMINAL COMPANY RECORDED IN SAID REGISTRY OF DEEDS IN BOOK 7026, PAGE 187 552.62 FEET TO THE TRUE POINT OF BEGINNING OF THE PARCEL HEREIN DESCRIBED;

THENCE, FROM SAID POINT OF BEGINNING S 59°25'20" W ALONG LAND NOW OR FORMERLY OF SAID PORTLAND TERMINAL COMPANY 602.21 FEET;

THENCE, S 33°20'20" W ALONG LAND NOW OR FORMERLY OF SAID PORTLAND TERMINAL COMPANY 430 FEET MORE OR LESS TO LOW WATER;

THENCE, CONTINUING ALONG THE SAME COURSE 85 FEET MORE OR LESS TO THE FORMER HARBOR COMMISSIONERS LINE OF 1929;

THENCE, EASTERLY ALONG THE HARBOR COMMISSIONERS LINE OF 1929, 1,117 FEET MORE OR LESS TO LAND NOW OR FORMERLY OF SAID PORTLAND TERMINAL COMPANY;

THENCE, N 32°31'38" W ALONG LAND NOW OR FORMERLY OF SAID PORTLAND TERMINAL COMPANY 64 FEET MORE OR LESS TO THE TRUE POINT OF BEGINNING.

UNITIL PARCEL DESCRIPTION TM 59-A-2

A CERTAIN LOT OR PARCEL OF LAND SITUATED SOUTHEASTERLY OF BUT NOT ADJACENT TO WEST COMMERCIAL STREET IN THE CITY OF PORTLAND, COUNTY OF CUMBERLAND AND STATE OF MAINE AS SHOWN ON THE PLAN AND BOUNDED AND DESCRIBED AS FOLLOWS:

COMMENCING AT A GRANITE MONUMENT IN A MANHOLE LOCATED IN THE SOUTHEASTERLY SIDELINE OF WEST COMMERCIAL STREET AS SHOWN ON THE PLAN;

THENCE, S 32°36'10" W ALONG THE SOUTHEASTERLY SIDELINE OF WEST COMMERCIAL STREET 637.60 FEET TO AN ANGLE POINT IN SAID STREET;

THENCE, S 73°01'23" W CONTINUING ALONG THE SOUTHERLY SIDELINE OF WEST COMMERCIAL STREET 1053.20 FEET;

THENCE, S 87°32'13" E THROUGH LAND NOW OR FORMERLY OF SAID PORTLAND TERMINAL COMPANY AS RECORDED IN SAID REGISTRY OF DEEDS IN BOOK 7026, PAGE 187 404.28 FEET TO THE TRUE POINT OF BEGINNING OF THE PARCEL HEREIN DESCRIBED;

THENCE ALONG THE FOLLOWING COURSES AND DISTANCES:

- N 70°47'58" E 181.08 FEET;
- N 70°50'01" E 232.75 FEET;
- N 70°47'58" E 20.12 FEET;
- S 25°12'02" E 6.50 FEET;
- N 79°57'28" E 33.57 FEET;
- N 70°47'58" E 36.77 FEET;
- N 70°47'58" E 226.63 FEET;

ALONG A CURVE TO THE RIGHT HAVING A RADIUS OF 603.80 FEET AN ARC DISTANCE OF 190.40 FEET, BEARING A CHORD OF S 23°07'23" W A DISTANCE OF 189.61 FEET;

- S 43°11'47" E 2.93 FEET;
- S 33°30'33" W 256.74 FEET;
- S 57°20'08" W 167.99 FEET;
- N 43°25'17" W 435.50 FEET TO THE POINT OF BEGINNING, CONTAINING 3.96 ACRES.

THE ABOVE-DESCRIBED PARCELS ARE LEASED TOGETHER WITH LANDLORD'S RIGHT, TITLE AND INTEREST IN AND TO:

- 1. THE RIGHT OF WAY AS DESCRIBED IN THE EASEMENT DEED FROM THE CITY OF PORTLAND TO PORTLAND TERMINAL COMPANY, DATED FEBRUARY 25, 1971 AND RECORDED IN SAID REGISTRY OF DEEDS IN BOOK 3161, PAGE 93.
- 2. THE EASEMENTS RESERVED IN THE DEED FROM PORTLAND GAS LIGHT COMPANY TO PORTLAND AND KENNEBEC RAIL ROAD COMPANY, DATED OCTOBER 6, 1866 AND RECORDED IN SAID REGISTRY OF DEED BOOK AT 346, PAGE 376.
- 3. THE RESERVATIONS DESCRIBED IN THE DEED FROM PORTLAND GAS LIGHT COMPANY TO MAINE CENTRAL RAILROAD COMPANY, DATED MAY 5, 1897 AND RECORDED IN SAID REGISTRY OF DEEDS IN BOOK 645, PAGE 488.

WITHOUT LIMITING THE PROVISIONS OF SECTION 15 OF THE LEASE AGREEMENT, THE ABOVE-DESCRIBED PARCELS ARE LEASED SUBJECT TO ALL MATTERS OF RECORD.

Schedule B Section 2 Exceptions:

Maine Central Railroad Parcel

OLD REPUBLIC NATIONAL TITLE INSURANCE COMPANY
FILE #: POCO15. EFFECTIVE DATE: UPDATE FROM 11-30-12
40 WEST COMMERCIAL STREET, PORTLAND, CUMBERLAND COUNTY, STATE OF MAINE

- 1-10. NON-SURVEY ITEMS
- 11. INTENTIONALLY DELETED
- 12. INTENTIONALLY DELETED
- 13. INTENTIONALLY DELETED
- 14. EASEMENT RESERVED IN DEED FROM PORTLAND GAS LIGHT COMPANY TO PORTLAND AND KENNEBEC RAIL ROAD COMPANY, DATED OCTOBER 6, 1866 AND RECORDED IN BOOK AT 346, PAGE 376. - AS SHOWN.
- 15. INTENTIONALLY DELETED
- 16. EASEMENT RESERVED IN DEED FROM PORTLAND GAS LIGHT COMPANY TO MAINE CENTRAL RAILROAD COMPANY, DATED MAY 5, 1897 AND RECORDED IN BOOK 648, PAGE 488 - AS SHOWN.
- 17. EASEMENT FROM PORTLAND TERMINAL COMPANY TO COUNTY OF CUMBERLAND, DATED AUGUST 30, 1916 AND RECORDED IN BOOK 976, PAGE 73 - AS SHOWN.
- 18. EASEMENT RESERVED IN DEED FROM COUNTY OF CUMBERLAND TO PORTLAND TERMINAL COMPANY, DATED AUGUST 30, 1916 AND RECORDED IN BOOK 976, PAGE 74 - AS SHOWN.
- 19. INTENTIONALLY DELETED
- 20. EASEMENT FROM PORTLAND TERMINAL COMPANY TO CENTRAL MAINE POWER COMPANY, DATED APRIL 15, 1975 AND RECORDED IN BOOK 3069, PAGE 136 - AS SHOWN.
- 21. INTENTIONALLY DELETED
- 22. EASEMENT FROM PORTLAND TERMINAL COMPANY TO PORTLAND WATER DISTRICT, DATED FEBRUARY 11, 1977 AND RECORDED IN BOOK 3975, PAGE 292 - AS SHOWN.
- 23. EASEMENT FROM PORTLAND TERMINAL COMPANY AND MAINE CENTRAL RAILROAD COMPANY TO CENTRAL MAINE POWER COMPANY, DATED FEBRUARY 9, 1993 AND RECORDED IN BOOK 10511, PAGE 111 - AS SHOWN.
- 24. EASEMENT FROM PORTLAND TERMINAL COMPANY TO STATE OF MAINE, DATED JANUARY 14, 1998 AND RECORDED IN BOOK 13562, PAGE 163 - AS SHOWN.
- 25. SUCH STATE OF FACTS AS IS SHOWN ON THE ALTA/ACSM LAND TITLE SURVEY BY OWEN HASKELL ENTITLED "WEST COMMERCIAL STREET, PORTLAND, CUMBERLAND COUNTY, MAINE MADE FOR NEW YEAR LLC", DATED JULY 2, 2012, LAST REVISED AUGUST _____, 2013 AND RECORDED IN PLAN BOOK _____, PAGE _____ (THE "PLAN") INCLUDING SPECIFICALLY:

- (a) ENCROACHMENT OF BUILDING OWNED BY THE EASTERLY ABUTTER ON THE INSURED PREMISES. - AS SHOWN.
- (b) TRAIN TRACKS CROSSING THE INSURED PREMISES. - AS SHOWN.

- 26. EASEMENT (GAS REGULATOR STATION) FROM NEW YARD, LLC TO NORTHERN UTILITIES, INC., D/B/A UNITIL, DATED AUGUST 2, 2013 AND RECORDED IN BOOK 30895, PAGE 317. - AS SHOWN.
- 27. REMEDIATION AND GAS FACILITIES EASEMENT FROM NEW YARD, LLC TO NORTHERN UTILITIES, INC., D/B/A UNITIL, DATED AUGUST 2, 2013 AND RECORDED IN BOOK 30895, PAGE 321. - BLANKET IN NATURE, NOT PLOTTABLE.
- 28. UNRECORDED EASEMENT FROM BOSTON AND MAINE RAILROAD TO PORTLAND GAS LIGHT COMPANY DATED SEPTEMBER 18, 1897 TO LAY AND MAINTAIN A 12" PIPE ACROSS AND UNDER THE LAND AND LOCATION OF THE RAILROAD AS REFERENCED IN NOTE 4 OF THE PLAN. - AS SHOWN.
- 29. UNRECORDED PERMISSION TO LAY AND MAINTAIN PIPES FROM MAINE CENTRAL RAILROAD COMPANY (PORTLAND TERMINAL COMPANY) TO PORTLAND GAS LIGHT COMPANY, DATED DECEMBER 30, 1941 FOR A 4-INCH STEEL GAS PIPE AS NOTED IN NOTE 4 OF THE PLAN. - AS SHOWN.

Unitil Parcels

OLD REPUBLIC NATIONAL TITLE INSURANCE COMPANY
FILE #: POCO15. EFFECTIVE DATE: UPDATE FROM 11-30-12
WEST COMMERCIAL STREET, PORTLAND, CUMBERLAND COUNTY, STATE OF MAINE

- 1-8. NON-SURVEY ITEMS
- 9. EASEMENT FROM WILLIAM LINDSEY TO PORTLAND GAS LIGHT COMPANY, DATED OCTOBER 28, 1863 AND RECORDED IN BOOK 318, PAGE 466 - LOCATION UNKNOWN.
- 10. INTENTIONALLY DELETED
- 11. CONDITIONS DESCRIBED IN THE DEED FROM PORTLAND GAS LIGHT COMPANY TO PORTLAND AND KENNEBEC RAIL ROAD COMPANY, DATED OCTOBER 6, 1866 AND RECORDED IN BOOK AT 346, PAGE 376. - AS SHOWN.
- 12. CONDITIONS DESCRIBED IN THE DEED FROM PORTLAND TERMINAL COMPANY TO PORTLAND GAS LIGHT COMPANY, DATED DECEMBER 26, 1925 AND RECORDED IN BOOK 1222, PAGE 188. - AS SHOWN.
- 13. EASEMENTS DESCRIBED IN THE DEED FROM PORTLAND TERMINAL COMPANY TO CASCO WHARF AND STORAGE COMPANY, DATED AUGUST 31, 1936 AND RECORDED IN BOOK 1507, PAGE 126, AS AFFECTED BY AN EASEMENT FROM CASCO WHARF AND STORAGE CO. TO NEW ENGLAND TELEPHONE AND TELEGRAPH COMPANY, DATED JUNE 15, 1957 AND RECORDED IN BOOK 2381, PAGE 361. - AS SHOWN.
- 14. EASEMENT FROM PORTLAND GAS LIGHT COMPANY TO NEW ENGLAND TELEPHONE AND TELEGRAPH COMPANY, DATED NOVEMBER 1, 1951 AND RECORDED IN BOOK 2070, PAGE 128 - POLE #65.3 NOT LOCATED.
- 15. EASEMENT FROM PORTLAND GAS LIGHT COMPANY TO CENTRAL MAINE POWER COMPANY, DATED JANUARY 6, 1956 AND RECORDED IN BOOK 2276, PAGE 265 - POLE #62.1 NOT LOCATED.
- 16. INTENTIONALLY DELETED
- 17. EASEMENT FROM NORTHERN UTILITIES, INC. TO CENTRAL MAINE POWER COMPANY, DATED SEPTEMBER 2, 1982 AND RECORDED IN BOOK 5061, PAGE 229 - AS SHOWN.
- 18. EASEMENT AS DESCRIBED IN THE INDENTURE BY AND BETWEEN NORTHERN UTILITIES, INC. AND CENTRAL MAINE POWER COMPANY, DATED JULY 23, 1953 AND RECORDED IN BOOK 10862, PAGE 32 - AS SHOWN.
- 19. INTENTIONALLY DELETED
- 20. NON-SURVEY ITEM
- 21. SUCH STATE OF FACTS AS IS SHOWN ON THE ALTA/ACSM LAND TITLE SURVEY ENTITLED "LAND TITLE SURVEY ON WEST COMMERCIAL STREET, PORTLAND, MAINE MADE FOR NEW YEAR LLC", DATED JULY 2, 2012, REVISED THROUGH AUGUST _____, 2013 BY OWEN HASKELL, INC. AND RECORDED IN PLAN BOOK _____, PAGE _____ INCLUDING SPECIFICALLY:

- (a) ENCROACHMENT OF CHAIN LINK FENCE ONTO WESTERLY ABUTTER'S PROPERTY. - AS SHOWN.
- 22. NON-SURVEY ITEM.

Plan References:

- 1. HARBOR LINES, PORTLAND HARBOR, MAINE U.S. ENGINEER OFFICE, BOSTON, MASS. JUNE 30, 1939.
- 2. STANDARD BOUNDARY SURVEY SOUTH OF COMMERCIAL STREET, PORTLAND, MAINE FOR CENTRAL MAINE POWER COMPANY, PROPOSED EASEMENT LOCATION ON LAND OF PORTLAND TERMINAL COMPANY & MAINE CENTRAL RAILROAD AND CASCO WHARF AND STORAGE DATED DEC. 10, 1992 REV. 2 JAN. 27, 1993 BY OWEN HASKELL, INC.
- 3. STANDARD BOUNDARY & TOPOGRAPHIC SURVEY ON COMMERCIAL STREET, PORTLAND, MAINE MADE FOR NORTHERN UTILITIES, INC. DATED AUGUST 6, 1999 BY OWEN HASKELL, INC.
- 4. STANDARD BOUNDARY SURVEY FOR PROPERTY AT PORTLAND INTERNATIONAL MARINE TERMINAL, COMMERCIAL STREET, PORTLAND, CUMBERLAND COUNTY, MAINE OWNED BY CITY OF PORTLAND DATED AUGUST 14, 2002 BY EASTERLY SURVEYING, INC.
- 5. PLAN OF LAND ON WEST COMMERCIAL STREET, PORTLAND, MAINE MADE FOR CENTRAL MAINE POWER COMPANY DATED APRIL 24, 2003 BY OWEN HASKELL, INC.
- 6. ALTA/ACSM LAND TITLE SURVEY AT WEST COMMERCIAL STREET, PORTLAND, MAINE MADE FOR BINGHAM MCCUTCHEEN LLP DATED DEC. 18, 2006 BY OWEN HASKELL, INC.
- 7. PORTLAND HARBOR, PORTLAND, MAINE CONDITION SURVEY, 35 AND 45-FOOT CHANNELS, 45-FOOT ANCHORAGE, 35-FOOT TURNING BASINS, DATED SEPT. 13, 2011 U.S. ARMY CORPS OF ENGINEER NEW ENGLAND DISTRICT SHEET ID. NO. V-105.
- 8. STANDARD BOUNDARY SURVEY FOR PROPERTY AT PORTLAND INTERNATIONAL MARINE TERMINAL, COMMERCIAL STREET, PORTLAND, CUMBERLAND COUNTY, MAINE OWNED BY CITY OF PORTLAND DATED AUGUST 14, 2002 BY NORTHEASTERLY SURVEYING, INC.
- 9. PORTLAND TERMINAL COMPANY OFFICE OF THE VICE PRESIDENT - ENGINEERING, LAND SALE PLAN, PORTLAND, ME DATED DEC. 30, 2011.
- 10. COMMERCIAL STREET DRAINAGE AND TRAFFIC IMPROVEMENTS CIVIL PLAN MADE BY CITY OF PORTLAND, MAINE PUBLIC WORKS DEPARTMENT ENGINEERING SECTION DATED JUNE 2007.
- 11. PLAN OF PROPERTY IN THE CITY OF PORTLAND BY W. ANSON, CITY ENGINEER, PORTLAND, JUNE 1884, RECORDED IN THE PLAN BOOK 2 PAGE 5.
- 12. ATLAS OF THE CITY OF PORTLAND AND SOUTH PORTLAND MAINE PLAT 4 BY RICHARDS MAP CO. SPRINGFIELD, MASS. DATED 1914.
- 13. LAND ON WEST COMMERCIAL STREET, PORTLAND, MAINE, MAINE CENTRAL RAILROAD COMPANY TO NEW YARD LLC, DATED JULY 30, 2013, BY OWEN HASKELL, INC.

Record Owners

TM 59-A-1,3,4,7,8,11 NEW YARD LLC, BOOK 30887 PAGE 247
TM 59-A-2,5,6,9,10 UNITIL, VOL. 89 PAGE 21

ALTA/ACSM Land Title Survey

West Commercial Street
Portland, Cumberland County, Maine
made for
New Yard LLC
58 Fore Street, Portland, Maine

Randy R. Loubier
RANDY R. LOUBIER
PROFESSIONAL LAND SURVEYOR NO. 2407
IN THE STATE OF MAINE
DATE OF PLAN: JULY 2, 2012
REVISION DATE: SEPTEMBER 23, 2013
OHI JOB NO. 2012-051P

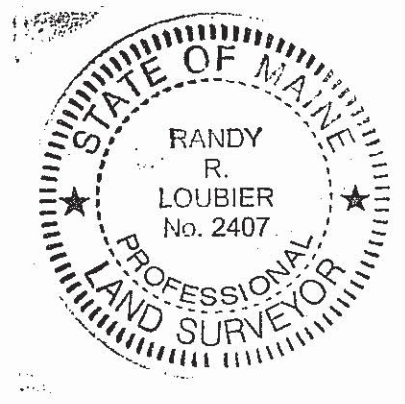

SHEET 2 OF 2

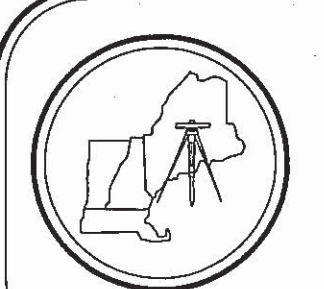

OWEN HASKELL, INC.
PROFESSIONAL LAND SURVEYORS
390 U.S. Route One, Unit #10
Falmouth, Maine 04105
Tel. (207)774-0424 Fax (207)774-0511
www.owenhaskell.com