

MOHR & SEREDIN
Landscape Architects, Inc.

18 Pleasant Street, Portland, Maine 04101
ph: 1.207.871.0003
fax: 1.207.871.1419

PORTLAND YACHT SERVICES
Portland, Maine
West Commercial Street

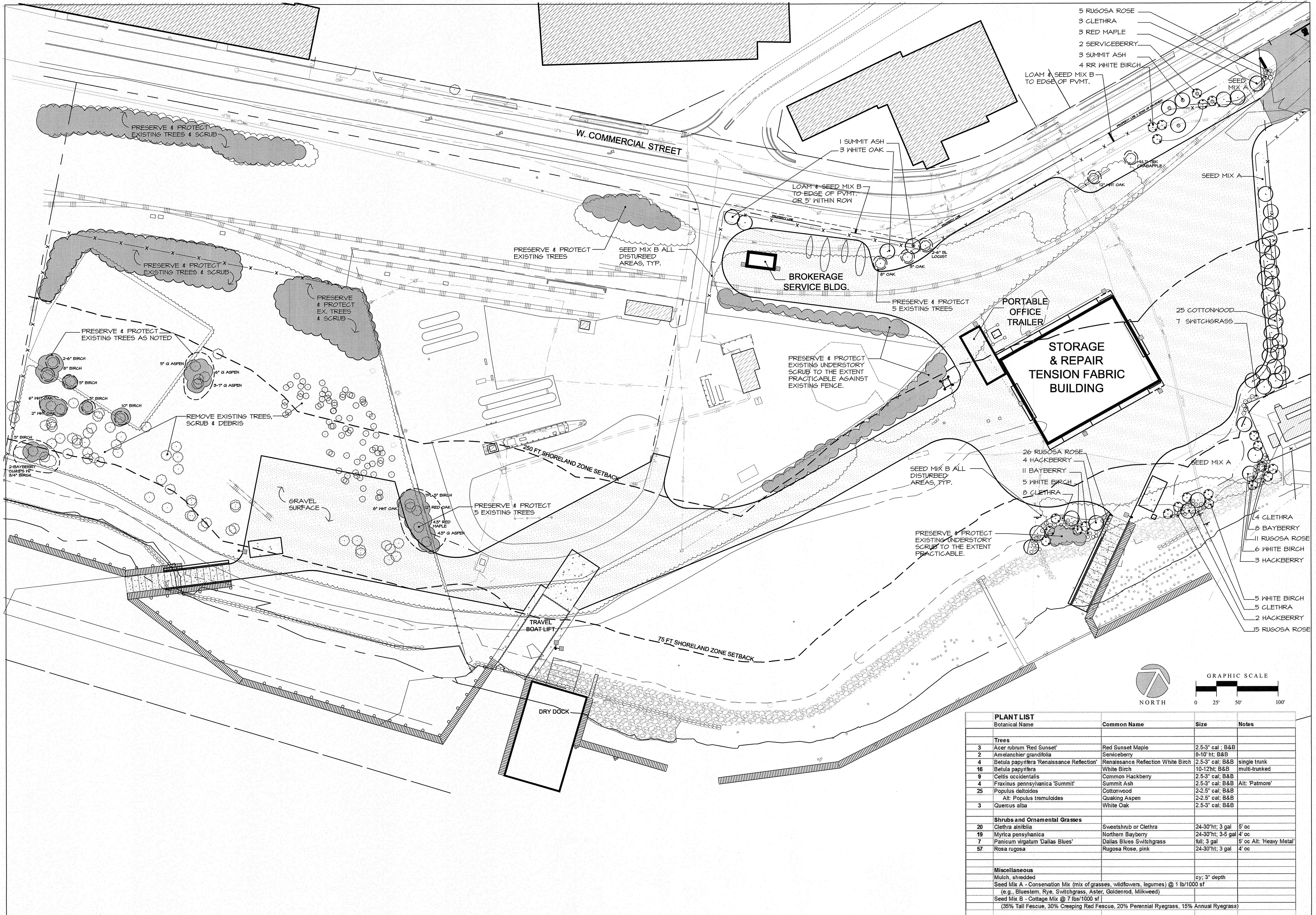

PLANT LIST			
Botanical Name	Common Name	Size	Notes
Trees			
3 Acer rubrum 'Red Sunset'	Red Sunset Maple	2.5-3' cal; B&B	
2 Amelanchier grandifolia	Serviceberry	8-10' ht; B&B	
4 Betula papyrifera 'Renaissance Reflection'	Renaissance Reflection White Birch	2.5-3' cal; B&B	single trunk
16 Betula papyrifera	White Birch	10-12ht; B&B	multi-trunked
9 Celtis occidentalis	Common Hackberry	2.5-3' cal; B&B	
4 Fraxinus pennsylvanica 'Summit'	Summit Ash	2.5-3' cal; B&B	Alt: 'Palmore'
25 Populus deltoides	Cottonwood	2-2.5' cal; B&B	
Alt: Populus tremuloides	Quaking Aspen	2-2.5' cal; B&B	
3 Quercus alba	White Oak	2.5-3' cal; B&B	
Shrubs and Ornamental Grasses			
20 Clethra alnifolia	Sweetshrub or Clethra	24-30'ht; 3 gal	5' oc
19 Myrica pensylvanica	Northern Bayberry	24-30'ht; 3-5 gal	4' oc
7 Panicum virgatum 'Dallas Blues'	Dallas Blues Switchgrass	full; 3 gal	5' oc Alt: 'Heavy Metal'
57 Rosa rugosa	Rugosa Rose, pink	24-30'ht; 3 gal	4' oc
Miscellaneous			
Mulch: shredded		cy; 3" depth	
Seed Mix A - Conservation Mix (mix of grasses, wildflowers, legumes) @ 1 lb/1000 sf		(e.g. Blueslem, Rye, Switchgrass, Aster, Goldenrod, Milkweed)	
Seed Mix B - Cottage Mix @ 7 lbs/1000 sf		(35% Tall Fescue, 30% Creeping Red Fescue, 20% Perennial Ryegrass, 15% Annual Ryegrass)	

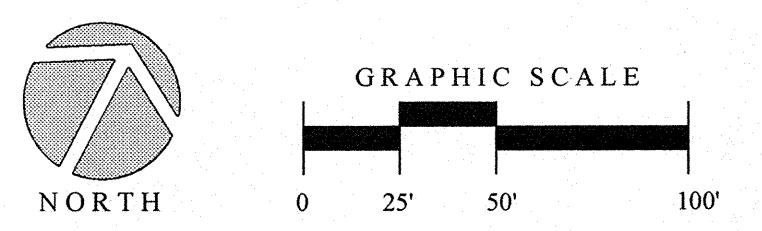

Title: **PHASE I LANDSCAPE PLAN**

No.	Date	Revision

Job # 799 Dwg. No.
Date: 10-16-2012
Scale: 1" = 50'-0"
Drawn: SEB **L1.0**
Checked: SM

SUBMITTED FOR PERMITTING 10-29-2012