

RIGID FRAME: BASIC COLUMN REACTIONS (k)

Frame Line	Column Line	Dead		Collateral		Live		Snow		Wind_Left1		Wind_Right1	
		Horiz	Vert	Horiz	Vert	Horiz	Vert	Horiz	Vert	Horiz	Vert	Horiz	Vert
1	A	2.8	5.3	1.9	3.0	6.9	10.8	21.2	33.1	-17.9	-25.8	-4.5	-25.3
1	N	-2.8	5.3	-1.9	3.0	-6.9	10.8	-21.2	33.1	4.5	-25.3	17.9	-25.8

Frame Line	Column Line	Wind_Left2		Wind_Right2		Wind_Long1		Wind_Long2		Seismic_Left		Seismic_Right	
		Horiz	Vert	Horiz	Vert	Horiz	Vert	Horiz	Vert	Horiz	Vert	Horiz	Vert
1	A	-10.5	0.7	2.9	1.1	-9.9	-33.6	-2.5	-7.2	-2.1	-0.7	2.1	0.7
1	N	-2.9	1.1	10.5	0.7	9.9	-33.6	2.5	-7.2	-2.1	0.7	2.1	-0.7

Frame Line	Column Line	Seismic_Long		LWIND1_L2E		LWIND1_R2E		LWIND2_L2E		LWIND2_R2E		F1UNB_SL_L	
		Horiz	Vert	Horiz	Vert	Horiz	Vert	Horiz	Vert	Horiz	Vert	Horiz	Vert
1	A	0.0	-9.8	0.7	-2.7	-0.9	-0.6	0.7	-2.7	-0.9	-0.6	18.3	32.0
1	N	0.0	-9.8	0.9	-0.6	-0.7	-2.7	0.9	-0.6	-0.7	-2.7	-18.4	19.9

Frame Line	Column Line	F1UNB_SL_R		F2UNB_SL_L		F2UNB_SL_R		F3UNB_SL_L		F3UNB_SL_R	
		Horiz	Vert	Horiz	Vert	Horiz	Vert	Horiz	Vert	Horiz	Vert
1	A	18.4	19.9	-18.3	32.0						
1	N	-18.3	32.0								

Frame Line	Column Line	Dead		Collateral		Live		Snow		Wind_Left1		Wind_Right1	
		Horiz	Vert	Horiz	Vert	Horiz	Vert	Horiz	Vert	Horiz	Vert	Horiz	Vert
2*	A	3.7	6.7	2.6	4.0	9.3	14.4	28.6	44.1	-19.2	-29.1	-5.5	-29.1
2*	N	-3.7	6.7	-2.6	4.0	-9.3	14.4	-28.6	44.1	5.5	-29.1	19.2	-29.1

Frame Line	Column Line	Wind_Left2		Wind_Right2		Wind_Long1		Wind_Long2		Seismic_Left		Seismic_Right	
		Horiz	Vert	Horiz	Vert	Horiz	Vert	Horiz	Vert	Horiz	Vert	Horiz	Vert
2*	A	-9.1	6.2	4.7	6.2	-13.5	-43.5	-3.3	-8.3	-2.4	-0.8	2.4	0.8
2*	N	-4.7	6.2	9.1	6.2	13.5	-43.5	3.3	-8.3	-2.4	0.8	2.4	-0.8

Frame Line	Column Line	Seismic_Long		LWIND1_L2E		LWIND1_R2E		LWIND2_L2E		LWIND2_R2E		F2UNB_SL_L	
		Horiz	Vert	Horiz	Vert	Horiz	Vert	Horiz	Vert	Horiz	Vert	Horiz	Vert
2*	A	0.0	-9.8	0.9	-3.5	-1.2	-0.9	0.9	-3.5	-1.2	-0.9	24.6	42.6
2*	N	0.0	-9.8	1.2	-0.9	-0.9	-3.5	1.2	-0.9	-0.9	-3.5	-24.8	26.5

Frame Line	Column Line	F2UNB_SL_R		F3UNB_SL_L		F3UNB_SL_R	
		Horiz	Vert	Horiz	Vert	Horiz	Vert
2*	A	24.8	26.5				
2*	N	-24.6	42.6				

Frame Line	Column Line	Dead		Collateral		Live		Snow		Wind_Left1		Wind_Right1	
		Horiz	Vert	Horiz	Vert	Horiz	Vert	Horiz	Vert	Horiz	Vert	Horiz	Vert
9	A	2.8	5.3	1.9	3.0	6.9	10.8	21.2	33.1	-17.9	-25.8	-4.5	-25.3
9	N	-2.8	5.3	-1.9	3.0	-6.9	10.8	-21.2	33.1	4.5	-25.3	17.9	-25.8

Frame Line	Column Line	Wind_Left2		Wind_Right2		Wind_Long1		Wind_Long2		Seismic_Left		Seismic_Right	
		Horiz	Vert	Horiz	Vert	Horiz	Vert	Horiz	Vert	Horiz	Vert	Horiz	Vert
9	A	-10.5	0.7	2.9	1.1	-9.9	-33.6	-2.5	-7.2	-2.1	-0.7	2.1	0.7
9	N	-2.9	1.1	10.5	0.7	9.9	-33.6	2.5	-7.2	-2.1	0.7	2.1	-0.7

Frame Line	Column Line	Seismic_Long		LWIND1_L2E		LWIND1_R2E		LWIND2_L2E		LWIND2_R2E		F3UNB_SL_L	
		Horiz	Vert	Horiz	Vert	Horiz	Vert	Horiz	Vert	Horiz	Vert	Horiz	Vert
9	A	0.0	-9.8	0.7	-2.7	-0.9	-0.6	0.7	-2.7	-0.9	-0.6	18.3	32.0
9	N	0.0	-9.8	0.9	-0.6	-0.7	-2.7	0.9	-0.6	-0.7	-2.7	-18.4	19.9

Frame Line	Column Line	F3UNB_SL_R		F3UNB_SL_L	
		Horiz	Vert	Horiz	Vert
9	A	18.4	19.9		
9	N	-18.3	32.0		

2* Frame lines: 2 3 4 5 6 7 8

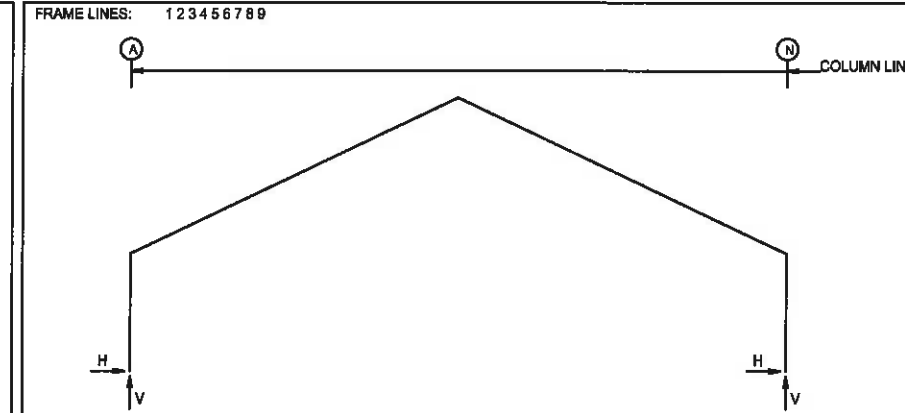

RIGID FRAME: MAXIMUM REACTIONS, ANCHOR BOLTS, & BASE PLATES

Frm Line	Col Line	Column Reactions (k)						Anc. Bolt		Base Plate (in)		
		Load ID	Hmax H	V Vmax	Load ID	Hmin H	V Vmin	Qty	Dia	Width	Length	Thick
1	A	1	26.0	41.3	2	-16.2	-22.6	4	1.000	8.000	11.25	0.625
1	N	3	18.2	-22.6	1	-26.0	41.3	4	1.000	8.000	11.25	0.625
		1			5	7.5	-33.1					

RIGID FRAME: MAXIMUM REACTIONS, ANCHOR BOLTS, & BASE PLATES

Frm Line	Col Line	Column Reactions (k)						Anc. Bolt		Base Plate (in)		
		Load ID	Hmax H	V Vmax	Load ID	Hmin H	V Vmin	Qty	Dia	Width	Length	Thick
2*	A	1	34.9	54.8	2	-17.0	-25.1	4	1.000	8.000	11.25	0.625
2*	N	3	17.0	-25.1	1	-34.9	54.8	4	1.000	8.000	11.25	0.625
		1			5	10.4	-43.1					

2* Frame lines: 2 3 4 5 6 7 8

RIGID FRAME: MAXIMUM REACTIONS, ANCHOR BOLTS, & BASE PLATES

Frm Line	Col Line	Column Reactions (k)						Anc. Bolt		Base Plate (in)		
		Load ID	Hmax H	V Vmax	Load ID	Hmin H	V Vmin	Qty	Dia	Width	Length	Thick
9	A	1	26.0	41.3	2	-16.2	-22.6	4	1.000	8.000	11.25	0.625
9	N	3	16.2	-22.6	1	-26.0	41.3	4	1.000	8.000	11.25	0.625
		1			5	7.5	-33.1					

ANCHOR BOLT SUMMARY

Qty	Locate	Dia (in)	Type	Total Len (in)	Bend Len (in)	Proj (in)
48	Endwall Frame	5/8"	A307			2.50
72	Frame	1"	A307	3.00		2.50

BUILDING BRACING REACTIONS

Wall Loc	Col Line	Rigid Frame At Endwall	Reactions (k)		Panel Shear (lb/ft)	
			Wind	Seismic	Wind	Seis
L_EW	1	Rigid Frame At Endwall				
F_SW	N		1.2	3.8	3.8	3.3
			2.3	3.8	3.8	3.3
			3.4	3.8	3.8	3.3
			6.7	3.8	3.8	3.3
			7.8	3.8	3.8	3.3
			8.9	3.8	3.8	3.3
R_EW	9	Rigid Frame At Endwall				
B_SW	A		9.8	3.8	3.8	3.3
			8.7	3.8	3.8	3.3
			7.6	3.8	3.8	3.3
			4.3	3.8	3.8	3.3
			3.2	3.8	3.8	3.3
			2.1	3.8	3.8	3.3

NOTES FOR REACTIONS

Building reactions are based on the following building data:

- Width (ft) = 120.0
- Length (ft) = 160.5
- Eave Height (ft) = 21.5/ 21.5
- Roof Slope (rise/12) = 5.7/ 5.7
- Dead Load (psf) = 2.0
- Collateral Load (psf) = 3.0
- Roof Live Load (psf) = 20.0
- Frame Live Load (psf) = 12.0
- Snow Load (psf) = 36.8
- Wind Speed (mph) = 110.0
- Wind Code = IBC 09
- Exposure = C
- Closed/Open = P
- Importance Wind = 1.00
- Importance Seismic = 1.00
- Seismic Design Category = C
- Seismic Coeff (Fe*Se) = 0.60

ID	Description
1	Dead+Collateral+Snow+Slide_Snow
2	0.6Dead+Wind_Left1
3	0.6Dead+Wind_Right1
4	0.6Dead+Wind_Long1+LWIND1_L2E
5	0.6Dead+Wind_Long1+LWIND1_R2E
6	1.06Dead+1.06Collateral+0.7Seismic_Left
7	0.6Dead+Wind_Right2+Wind_Suction
8	0.6Dead+Wind_Pressure+Wind_Long2

ENDWALL COLUMN: BASIC COLUMN REACTIONS (k)

Frm Line	Col Line	Dead Vert	Wind Press Horiz		Wind Suct Horiz	
			Horz	Vert	Horz	Vert
1	B	1.3	-5.4	5.9		
1	D	1.7	-8.7	9.3		
1	F	2.7	-17.6	18.7		
1	I	2.7	-17.6	18.7		
1	K	1.7	-8.7	9.3		
1	M	1.3	-5.4	5.9		
9	L	1.4	-7.6	8.2		
9	J	1.9	-10.2	10.9		
9	H	2.3	-13.8	14.7		
9	G	2.3	-13.8	14.7		
9	E	1.9	-10.2	10.9		
9	C	1.4	-7.6	8.2		

ENDWALL COLUMN: MAXIMUM REACTIONS, ANCHOR BOLTS, & BASE PLATES

Frm Line	Col Line	Column Reactions (k)						Anc. Bolt		Base Plate (in)		
		Load ID	Hmax H	V Vmax	Load ID	Hmin H	V Vmin	Qty	Dia	Width	Length	Thick
1	B	7	5.9	0.8	6	-5.4	0.8	4	0.625	SEE S1.1	SEE S1.1	0.250
		6	0.0	1.4								
1	D	7	9.3	1.0	8	-8.7	1.0	4	0.625	SEE S1.1	SEE S1.1	0.250
		6	0.0	1.8								
1	F	7	18.7	1.6	8	-17.6	1.6	4	0.625	SEE S1.1	SEE S1.1	0.375
		6	0.0	2.9								
1	I	7	18.7	1.6	8	-17.6	1.6	4	0.625	SEE S1.1	SEE S1.1	0.375
		6	0.0	2.9								
1	K	7	9.3	1.0	8	-8.7	1.0	4	0.625	SEE S1.1	SEE S1.1	0.250
		6	0.0	1.8								
1	M	7	5.9	0.8	8	-5.4	0.8	4	0.625	SEE S1.1	SEE S1.1	0.250
		6	0.0	1.4								
9	L	7	8.2	0.9	8	-7.6	0.9	4	0.625	SEE S1.1	SEE S1.1	0.250
		6	0.0	1.5								
9	J	7	10.9	1.1	8	-10.2	1.1	4	0.625	SEE S1.1	SEE S1.1	0.250
		6	0.0	2.0								
9	H	7	14.7	1.4	8	-13.8	1.4	4	0.625	SEE S1.1	SEE S1.1	0.250
		6	0.0	2.5								
9	G	7	14.7	1.4	8	-13.8	1.4	4	0.625	SEE S1.1	SEE S1.1	0.250
		6	0.0	2.5								
9	E	7	10.9	1.1	8	-10.2	1.1	4				