



PLAN REFERENCES

1. BOUNDARY AND TOPOGRAPHIC SURVEY WEST COMMERCIAL STREET PORTLAND, CUMBERLAND COUNTY, MAINE. MADE FOR HNTB AND THE MAINE DEPARTMENT OF TRANSPORTATION BY OWEN HASKELL, INC. DATED APRIL 4, 2014.
2. PLAN TITLED "STATE OF MAINE DEPARTMENT OF TRANSPORTATION RIGHT OF WAY MAP" "LAND ACQUISITIONS" BY OWEN HASKELL, INC. DATED APRIL 4, 2014.
3. PLAN SET TITLED "STATE OF MAINE DEPARTMENT ON TRANSPORTATION" CITY OF PORTLAND, MAINE. MADE FOR HNTB AND THE MAINE DEPARTMENT OF TRANSPORTATION BY OWEN HASKELL, INC. DATED APRIL 4, 2014.
4. PORTLAND HARBOR, PORTLAND, ME AFTER DREDGE SURVEY - 35 FOOT CHANNEL AND EXISTING LAYDOWN AND CONNECTING CORRIDOR CONNECTION WIN. 022892201 V-10A DATED APRIL 18, 2014.

STRUCTURES WITHIN PROJECT TO BE CONSTRUCTED IN ACCORDANCE WITH PORTLAND CITY CODE, SECTION 14-492.0 FLOOD PLAN MANAGEMENT.

HIGH ANNUAL TIDE (HAT) = ELEV 7.4
 MEAN HIGH WATER = ELEV 4.72
 MEAN LOW WATER = ELEV - 4.28

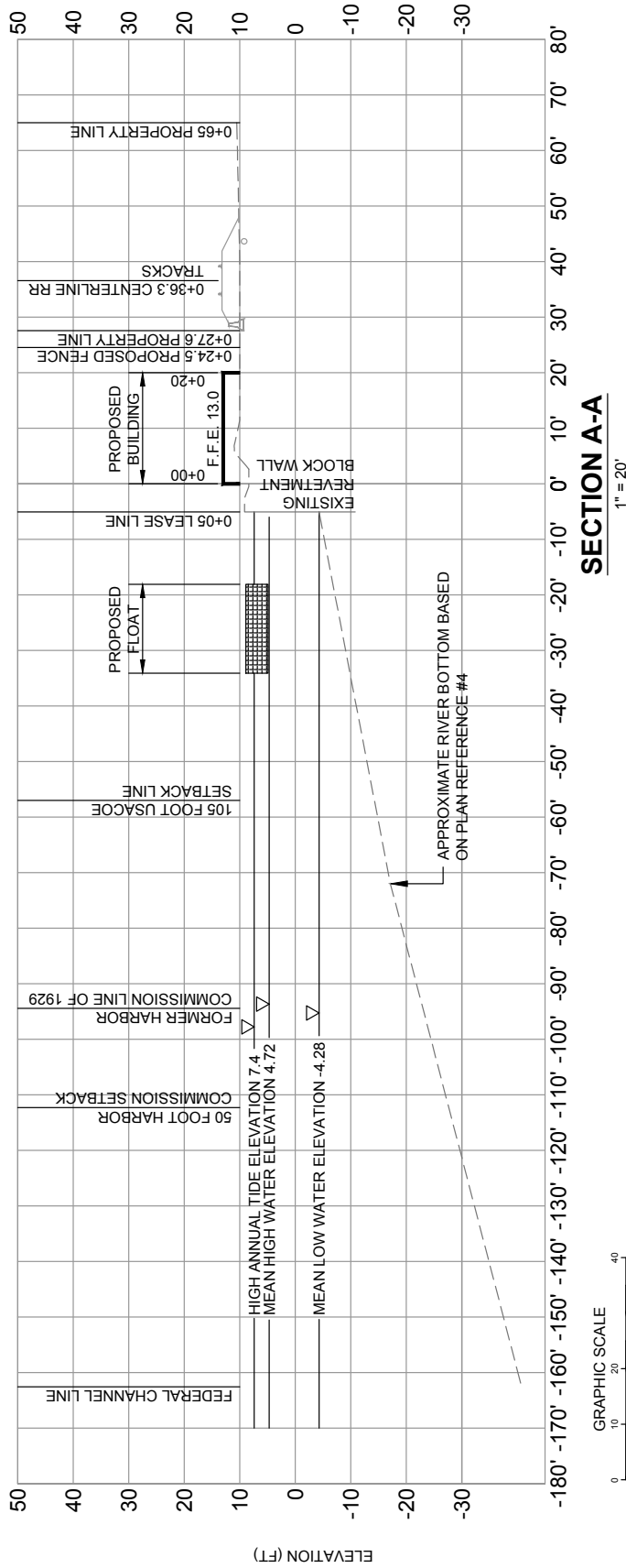

SECTION A-A

1" = 20'

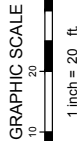

STANTEC CONSULTING SERVICES INC.

482 PAYNE ROAD SCARBOROUGH COURT
 SCARBOROUGH, MAINE 04074
 WWW.STANTEC.COM



DRAWN: DEF	DATE: 04/12/16
DESIGNED: SRB	SCALE: 1" = 20'
CHECKED: SRB	JOB NO.: 156350129
FILE NAME: 3091 04-SITE LAYOUT	

CANAL LANDING
 PROPOSED SHELL STORAGE AND
 PIER / FLOAT EXPANSION
 WAYNFLETE SCHOOL c/o ECO-ANALYSTS

WAYNFLETE SCHOOL PLAN

FIGURE

3