

# ELECTRICAL PERMIT

City of Portland, Maine

To the Electrical Inspector, Portland Maine :

The undersigned hereby applies for a permit to make electrical installations in accordance with the laws of Maine, the City of Portland's Electrical Ordinances, National Electrical Code and the following specifications:



Date: 2/5/15

Permit #: \_\_\_\_\_

CBL#: 059 A002001

ADDRESS: 2 West Commercial METER MAKE/MODEL #: MilbankU9701-QG

CMP Work Order #: 10300085649, meter acct# 441-1709543 OWNER: Portland Gas Light Co.

TENANT: Unutil PHONE #: 207-518-9722

**PLEASE HAVE YOUR PERMIT # (OR JOB ID) READY & CALL 874-8703 TO SCHEDULE AN INSPECTION!** TOTAL EACH FEE

<b>OUTLETS:</b>		Receptacles		Switches		Smoke Detector	<b>0.20</b>
<b>FIXTURES:</b>		Incandescent		Flourescent		Strips	<b>0.20</b>
<b>SERVICES:</b>	<input type="checkbox"/>	Overhead	<input checked="" type="checkbox"/>	Underground	<input type="checkbox"/>	TTL Amps <800	<b>15.00</b>
					<input type="checkbox"/>	TTL Amps >800	<b>25.00</b>
<b>TEMPORARY SERVICE:</b>		Overhead	<input checked="" type="checkbox"/>	Underground		TTL Amps	<b>25.00</b>
<b>METERS:</b>	1	(Number of)					<b>1.00</b>
<b>MOTORS:</b>		(Number of)					<b>2.00</b>
<b>RESID/COMMER:</b>		Electric Units					<b>1.00</b>
<b>HEATING:</b>		Oil/Gas Units	<input type="checkbox"/>	Interior	<input type="checkbox"/>	Exterior	<b>5.00</b>
<b>APPLIANCES:</b>		Ranges		Cook Tops		Wall Ovens	<b>2.00</b>
		Insta-hot		Water Heaters		Fans	<b>2.00</b>
		Dryers		Disposals		Dishwasher	<b>2.00</b>
		Compactors		Spa		Washing Machine	<b>2.00</b>
		Others (denote)					<b>2.00</b>
<b>MISC. (# of):</b>		Air Cond (Window)					<b>3.00</b>
		Air Cond (Central)				Pools	<b>10.00</b>
		HVAC		EMS		Thermostat	<b>5.00</b>
		Signs					<b>10.00</b>
		Alarms/Resident					<b>5.00</b>
		Alarms/Commer					<b>15.00</b>
		Heavy Duty (CRKT)					<b>2.00</b>
		Alterations					<b>5.00</b>
		Fire Repairs					<b>15.00</b>
		Emergency Lights					<b>1.00</b>
		Emer Generators					<b>20.00</b>
		Circus/Carnival					<b>25.00</b>
<b>PANELS:</b>	<input checked="" type="checkbox"/>	Service	<input type="checkbox"/>	Remote	<input type="checkbox"/>	Main	<b>4.00</b>
<b>TRANSFORMER:</b>	<input type="checkbox"/>	0-25 Kva					<b>5.00</b>
	<input checked="" type="checkbox"/>	25-200 Kva					<b>8.00</b>
	<input type="checkbox"/>	Over 200 Kva					<b>10.00</b>

**MINIMUM COMMERCIAL FEE: \$55.00** **MINIMUM RESIDENTIAL FEE: \$45.00** **TOTAL DUE: 55.00**

Brief Description of work: 059 A002001: Replace CMP xfmr & Meter, install breaker, install new xfmr feeding panel inside bldg

**PLEASE HAVE YOUR PERMIT # (OR JOB ID) READY & CALL 874-8703 TO SCHEDULE AN INSPECTION!**

**CONTRACTOR INFORMATION:**  
 Contractor Name: Cianbro/Lance Keen Master License #: MS60011445  
 Address: Cianbro, 60 Cassidy Point Dr, Portland, ME 04102 Limited License #: \_\_\_\_\_  
 Telephone & E Mail: 207-416-9973, lkeen@cianbro.com

**Contractor Signature:** *Lance Keen*

**PLEASE HAVE YOUR PERMIT # (OR JOB ID) READY & CALL 874-8703 TO SCHEDULE AN INSPECTION!**

CBL :



# PORTLAND MAINE

*Strengthening a Remarkable City, Building a Community for Life • [www.portlandmaine.gov](http://www.portlandmaine.gov)*

Jeff Levine, AICP, Director  
Director of Planning and Urban Development

Tammy Munson  
Director, Inspections Division

## **Electronic Signature and Fee Payment Confirmation**

*Notice: Your electronic signature is considered a legal signature per state law.*

By digitally signing the attached document(s), you are signifying your understanding this is a legal document and your electronic signature is considered a **legal signature** per Maine state law. You are also signifying your intent on paying your fees by the opportunities below.

I, the undersigned, intend and acknowledge that no permit application can be reviewed until payment of appropriate permit fees are **paid in full** to the Inspections Office, City of Portland Maine by method noted below:



Within 24-48 hours, once my complete permit application and corresponding paperwork has been electronically delivered, I intend to **call the Inspections Office** at 207-874-8703 and speak to an administrative representative and provide a credit/debit card over the phone.



Within 24-48 hours, once my permit application and corresponding paperwork has been electronically delivered, I intend to **hand deliver** a payment method to the Inspections Office, Room 315, Portland City Hall.



I intend to deliver a payment method through the U.S. Postal Service mail once my permit paperwork has been electronically delivered.

Applicant Signature:

*Lance Keen*

Date: 2/5/15

I have provided digital copies and sent them on:

Date: 2/5/15

NOTE: All electronic paperwork must be delivered to [buildinginspections@portlandmaine.gov](mailto:buildinginspections@portlandmaine.gov) or by physical means ie; a thumb drive or CD to the office.

Room 315 - 389 Congress Street- Portland, Maine 04101 (207) 874-8703 - Fax: 874-8716 - TTY: 874-8936

**ELECTRICAL SITE PLAN NOTES:**

- WHERE INDICATED, ARRANGE WITH THE CENTRAL MAINE POWER COMPANY TO REMOVE THE EXISTING UTILITY POLE AND ATTACHED UTILITY LINES.
- NOT USED.
- WHERE INDICATED, ARRANGE WITH THE CENTRAL MAINE POWER COMPANY TO PROVIDE A NEW 120/240V, 1PH, 3W 100A SERVICE TO BE EXTENDED UNDERGROUND TO A NEW TRAFFIC SIGNAL ENCLOSURE WITH SERVICE METER. SEE THE CIVIL DRAWINGS FOR DETAILS OF THE TRAFFIC SIGNAL ENCLOSURE.
- PROVIDE A 50-PAIR CAT 5 TELEPHONE CABLE FROM THE NEW TELEPHONE SERVICE DEMARCATION POINT ON THE OUTSIDE OF THE UNTIL COMPRESSOR BUILDING TO THE EXISTING TELEPHONE SERVICE BOARD AT THE INSIDE SOUTHWEST CORNER OF THE BUILDING.
- WHERE INDICATED, ARRANGE WITH THE CENTRAL MAINE POWER COMPANY TO MODIFY THE EXISTING OVERHEAD UTILITY LINE TO ACCOMMODATE A NEW UNDERGROUND PRIMARY SERVICE CONDUIT RISER.
- WHERE INDICATED, PROVIDE THREE 4-INCH CONDUITS FOR A NEW CENTRAL MAINE POWER COMPANY UNDERGROUND PRIMARY SERVICE. ENCASE CONDUITS WITHIN A 2-INCH CONCRETE ENVELOPE WHERE CROSSING PAVED ROADWAYS. INSTALL CONDUITS WITHIN LIMITS OF EASEMENT (SEE CIVIL SITE PLAN FOR EASEMENT LOCATION).
- WHERE INDICATED, ARRANGE WITH THE CENTRAL MAINE POWER COMPANY TO RELOCATE AN EXISTING UTILITY POLE.
- SEE SHEET E3 FOR DETAILS OF THE NEW ELECTRICAL EQUIPMENT RACK. SEE SHEET E2 FOR ELECTRICAL MANHOLE DETAIL.
- WHERE INDICATED, PROVIDE A 1-1/2" CONDUIT RISER TO ACCOMMODATE THE NEW LIGHTING CIRCUIT. (SEE CIVIL UTILITY SITE PLAN FOR EASEMENT LOCATION).
- NOT USED.
- SEE CIVIL ENGINEERING UTILITY PLANS FOR EXISTING UNDERGROUND UTILITY LINES.
- PROVIDE A 1-INCH CONDUIT FROM ALL CAMERAS AND CARD READERS TO THE CLOSEST NETWORK SWITCH. CARD READERS, CAMERAS, AND ASSOCIATED WIRING SHALL BE PROVIDED BY OTHERS.
- WHERE INDICATED, EXISTING CMP ROADWAY LIGHT MOUNTED ON THE EXISTING UTILITY POLE TO REMAIN.
- WHERE INDICATED, EXISTING CMP ROADWAY LIGHT MOUNTED ON THE EXISTING UTILITY POLE TO REMAIN (LIGHT TO BECOME PRIVATELY OWNED).
- PROVIDE 3#6, 1#8 GND, IN A 1-1/2" CONDUIT FOR ALL TYPE S1, S1A, S1B, AND S2 LIGHTING POLE CIRCUITS.
- PROVIDE 2#6, 1#8 GND, IN A 1-1/2" CONDUIT FOR THE GATE OPERATOR CIRCUIT.
- THE MINIMUM BURIAL DEPTH FOR UNDERGROUND CONDUITS WITH SECONDARY WIRING SHALL BE 30 INCHES, EXCEPT FOR THE CONDUITS THAT SERVICE THE THREE TYPE S2 LIGHTING POLES ALONG THE WATERFRONT WHICH SHALL BE BURIED AT 18 INCHES TO AVOID CONFLICT WITH THE EXISTING WRAP.
- NOT USED.
- WHERE INDICATED, RELOCATE EXISTING KEYPAD. INSTALL RELOCATED KEYPAD ON FENCE.
- WHERE INDICATED, PROVIDE A WEATHERPROOF FIRE ALARM MANUAL PULL STATION. EXTEND FIRE ALARM CABLE IN A 1-1/2" CONDUIT UNDERGROUND BETWEEN PULL STATIONS, AND EXTEND TO THE EXISTING FIRE ALARM SYSTEM IN THE IMT RUBB BUILDING EAST OF THE CASCO BRIDGE. INSTALL FIRE ALARM PULL STATION ON A 2" RIGID GALVANIZED CONDUIT POST TO MOUNT THE PULL STATION AT 48" ABOVE GRADE. VERIFY EXACT LOCATION OF PULL STATION WITH OWNER PRIOR TO INSTALLATION.
- WHERE INDICATED, PROVIDE A WEATHERPROOF BOX FOR OWNER'S NETWORK SWITCH. PROVIDE A 120 VAC CIRCUIT TO EACH BOX WITH 2 #6 CONDUCTORS PLUS A #8 GND IN A 1-1/2" CONDUIT. CIRCUIT TO PANEL P2 # 2. PROVIDE A 120V, 20A QUAD RECEPTACLE OUTLET WITHIN EACH BOX.
- VERIFY EXACT LOCATION OF FENCE GATES, KEY PAD CONTROLS, AND CARD READERS PRIOR TO INSTALLATION.

- WHERE INDICATED, WIRE KEYPAD CONTROL TO GATE OPERATOR. KEYPAD SHALL BE FURNISHED BY OTHERS AND SHALL BE INSTALLED UNDER THIS CONTRACT.
- WHERE INDICATED, PROVIDE 2#12, 1#12 GND, IN A 1" CONDUIT FOR THE GATE OPERATOR CIRCUIT. WIRE GATE CIRCUIT TO EXISTING WESTINGHOUSE PANEL WITHIN THE UNTIL BUILDING. CONNECT TO SPARE CIRCUIT #2.
- WHERE INDICATED, ARRANGE WITH THE CENTRAL MAINE POWER COMPANY TO PROVIDE A NEW 120/240V, 1PH, 3W 60A SERVICE TO BE EXTENDED UNDERGROUND TO THE RELOCATED BRIDGE-UP BEACON WITH METER.
- PROVIDE AN 8-INCH SQUARE, RECESSED WIRING BOX WITH A STAINLESS STEEL SCREW-COVER AT EACH TYPE S1 AND TYPE S1A LIGHT POLE. INSTALL BOXES FLUSH IN SIDE WALL OF CONCRETE BARRIERS AS INDICATED ON SHEET S01. EXTEND A 1" CONDUIT FROM EACH BOX TO THE RESPECTIVE LIGHTING POLE BASE.
- WHERE INDICATED, ARRANGE WITH THE CENTRAL MAINE POWER COMPANY TO PROVIDE A NEW UTILITY POLE.
- CONDUIT FOR PRIMARY ELECTRICAL SERVICES SHALL BE INSTALLED 30" BELOW GRADE (MIN.), WHERE LESSER COVER IS REQUIRED DUE TO EXISTING CONDITIONS, PRIMARY SERVICE CONDUIT MAY BE INSTALLED 4" BELOW GRADE WITH A 4" CONCRETE COVER.
- WHERE INDICATED, PROVIDE A 2" CONDUIT UNDERGROUND FROM THE WEATHERPROOF NETWORK SWITCH BOX TO THE ADJACENT RUBB BUILDING. VERIFY WITH OWNER THE EXACT LOCATION OF THE CONDUIT ENTRANCE AT THE RUBB BUILDING.
- WHERE INDICATED, PROVIDE A 3" CONDUIT FOR A NEW TELEPHONE SERVICE TO THE EXISTING UNTIL COMPRESSOR BUILDING. INSTALL CONDUIT 12" BELOW GRADE WITH A 2" CONCRETE COVER. ARRANGE WITH FAIRPOINT TO PROVIDE A NEW SERVICE CABLE. MINIMIZE THE DOWN-TIME FOR THE TELEPHONE SERVICE SWITCH-OVER FOLLOWING THE REMOVAL OF THE EXISTING OVERHEAD TELEPHONE SERVICE. NOTIFY UNTIL 72 HOURS IN ADVANCE OF ANY TELEPHONE SERVICE INTERRUPTION.
- WHERE INDICATED, REMOVE EXISTING OVERHEAD CMP SERVICE AND SERVICE METER. (SEE DETAIL OF NGL BUILDING EAST OUTSIDE WALL, THIS SHEET).
- NOT USED.
- ON THE OUTSIDE SOUTH WALL OF THE UNTIL COMPRESSOR BUILDING, PROVIDE A NEW SERVICE METER WITH A 60A/3P, 480V MAIN C.B. IN A WEATHERPROOF ENCLOSURE. EXTEND A NEW FEEDER CONSISTING OF 4#6, 1#8 GND FROM THE METER INTO THE BUILDING IN A 1-1/4" CONDUIT. CONNECT THE FEEDER TO A NEW 45 KVA DRY-TYPE TRANSFORMER TO BE INSTALLED INSIDE THE BUILDING. PROVIDE A 100A/3P CIRCUIT BREAKER ON THE LOAD SIDE OF THE TRANSFORMER AND EXTEND A NEW FEEDER CONSISTING OF 4 #2, 1#8 GND IN AN 2" CONDUIT TO SERVE THE EXISTING WESTINGHOUSE PANEL WITHIN THE UNTIL BUILDING. PROVIDE A 5/8" DIAMETER BY 8'-0" LONG SERVICE GROUND ROD OUTSIDE THE BUILDING WITH A #8 BARE COPPER SERVICE GROUND CONDUCTOR.
- THE EXISTING UNTIL COMPRESSOR BUILDING IS CURRENT SERVED BY A CIRCUIT THAT ORIGINATES IN THE OUTSIDE PANEL ON THE EAST WALL AT THE NGL BUILDING ACROSS THE DRIVE. THE SERVICE FEEDER EXTENDS UNDERGROUND AND IS CONNECTED TO A WESTINGHOUSE PANEL WITHIN THE UNTIL COMPRESSOR BUILDING. UNDER THIS CONTRACT THE SERVICE SHALL BE REVERSED SUCH THAT THE OUTSIDE PANEL SHALL BE SERVED FROM THE WESTINGHOUSE PANEL IN THE UNTIL COMPRESSOR BUILDING (SEE DETAIL OF NGL BUILDING EAST OUTSIDE WALL, SHEET E02).

- WHERE INDICATED, PROVIDE 2#12, 1#12 GND, IN A 1" CONDUIT FOR THE GATE OPERATOR CIRCUIT. WIRE GATE CIRCUIT TO EXISTING PANEL WITHIN THE NGL ELECTRICAL BUILDING. CONNECT TO SPARE CIRCUIT #16.
- WHERE INDICATED, PROVIDE AN UNDERGROUND 120V CIRCUIT CONSISTING OF 2#12, 1#12 GND, IN A 1" CONDUIT TO SERVE AN EXISTING POLE MOUNTED LIGHT. CONNECT THE CIRCUIT TO THE EXISTING PANEL WITHIN THE NGL ELECTRICAL BUILDING. SPARE CIRCUIT #18.
- WHERE INDICATED, PROVIDE UNDERGROUND 1-1/2" CDT. FOR RELOCATION OF EXISTING CATHODIC PROTECTION SYSTEM CABLE. EXTEND CONDUIT FROM EXISTING SYSTEM CONTROLLER AT UTILITY POLE WEST OF NGL BUILDING TO NEW IN-GROUND BOX (SEE NOTE 38). CATHODIC PROTECTION CABLE SHALL BE FURNISHED AND INSTALLED BY UNTIL.
- WHERE INDICATED, PROVIDE A FLUSH, IN-GROUND POLYMER CONCRETE BOX AS MANUFACTURED BY OLDCASTLE #1212-18, OR EQUAL, TO FACILITATE NEW UNDERGROUND CATHODIC PROTECTION SYSTEM CABLE CONNECTION TO EXISTING UNDERGROUND CABLE. VERIFY EXACT LOCATION WITH UNTIL AND MDOT PRIOR TO INSTALLATION.

**ELECTRICAL SYMBOLS**

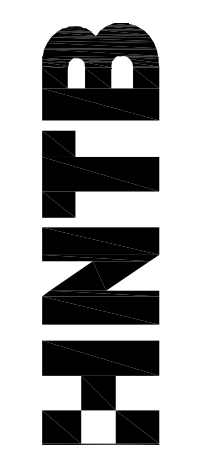
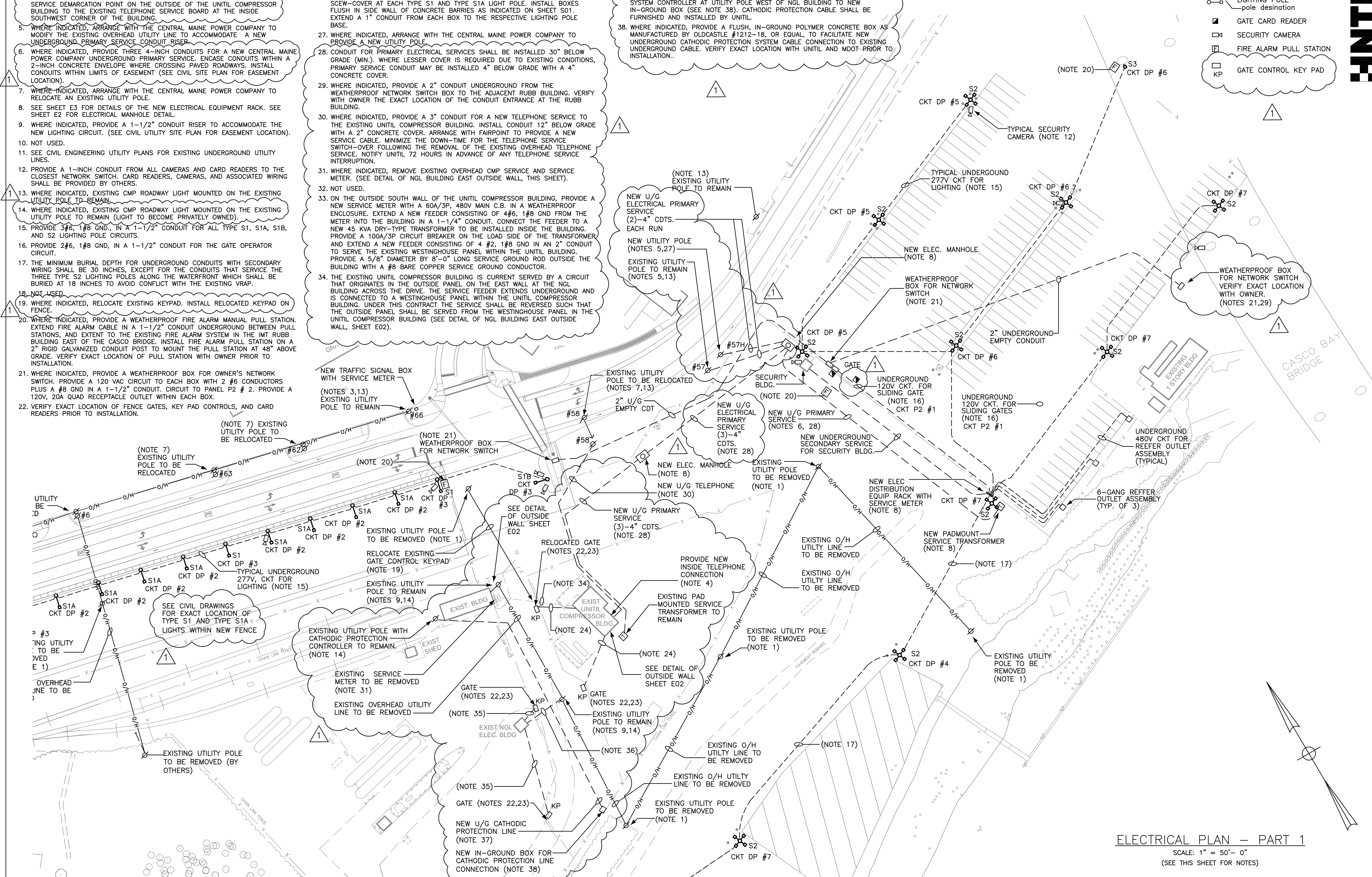
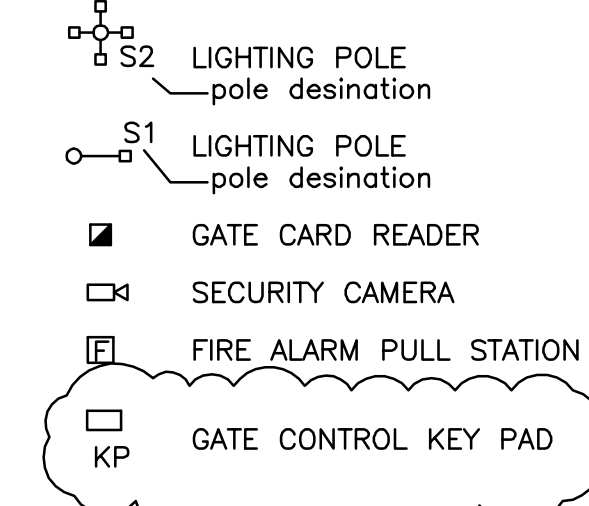

PROJ. MANAGER	CRAG R. MORIN	DATE	07/11/14
DESIGN-DETAILED	LEB	BY	LEB
CHECKED-REVIEWED	LEB	DATE	02/26/14
DESIGN-DETAILED	LEB	DATE	02/26/14
DESIGN-DETAILED	LEB	DATE	02/26/14
REVISIONS 1	CMP/ANG/UNTIL REV.	P.E. NUMBER	7928
REVISIONS 2		DATE	06/26/14
REVISIONS 3		DATE	10/17/14
REVISIONS 4		DATE	10/17/14
FIELD CHANGES		DATE	10/17/14

PORTLAND INTERNATIONAL MARINE TERMINAL  
EXISTING LAYDOWN AND CONNECTING CORRIDOR CONNECTION  
PORTLAND  
CUMBERLAND COUNTY  
ELECTRICAL PLAN - PART 1

**ELECTRICAL PLAN - PART 1**  
SCALE: 1" = 50'-0"  
(SEE THIS SHEET FOR NOTES)



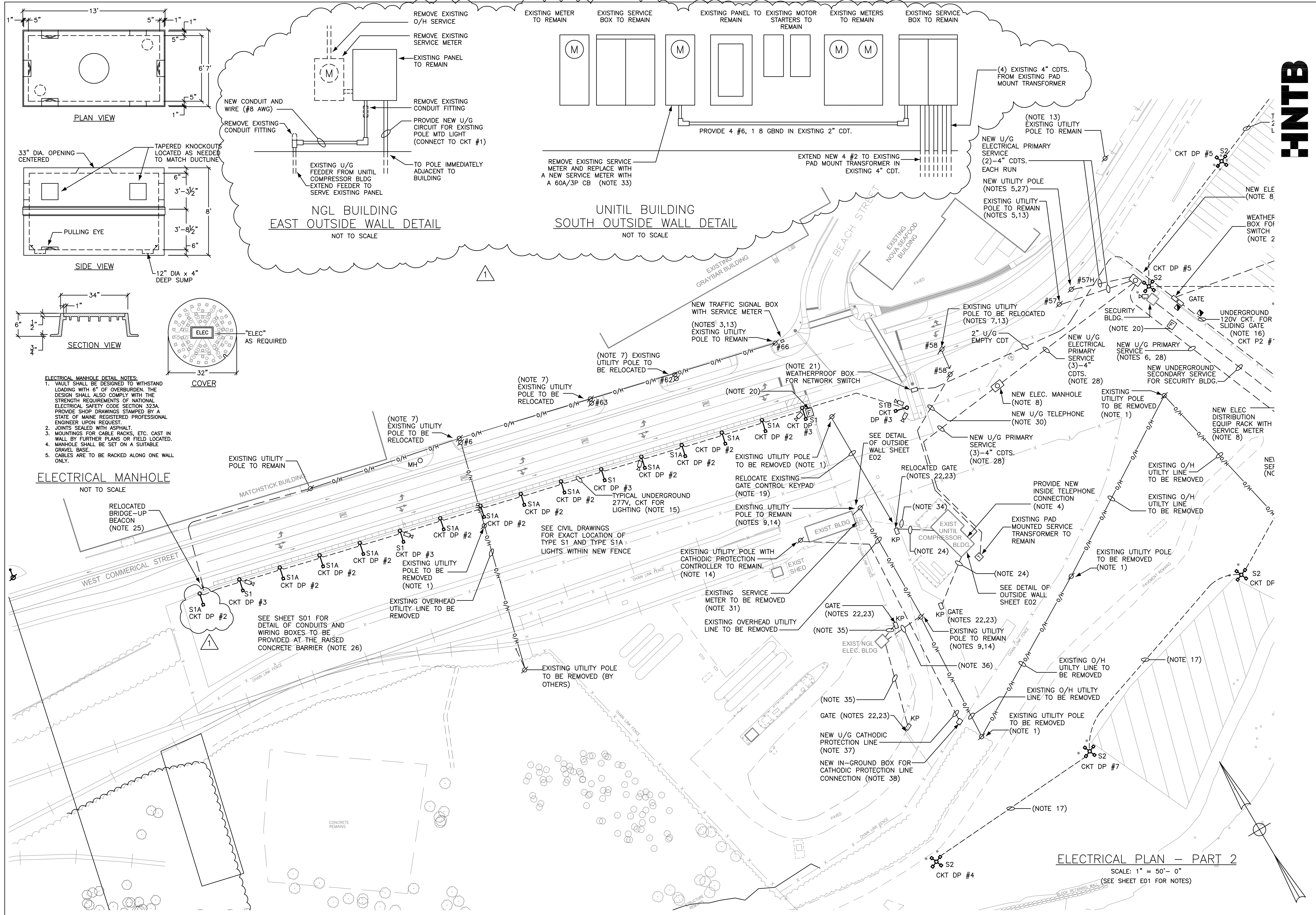

PROJ. MANAGER	GRAIG R. MORIN	DATE	07/11/14
DESIGN-REVIEWED	LEB	BY	LEB
CHECKED-REVIEWED	LEB	DATE <td>07/11/14</td>	07/11/14
DESIGN-DETAILED3	---	SIGNATURE <td>Lawrence E. Bartlett</td>	Lawrence E. Bartlett
DESIGN-DETAILED2	---	P. E. NUMBER <td>7928</td>	7928
REVISIONS 1	CMF/MGL/UNTIL REV. <td>P. E. NUMBER <td>02/26/14</td> </td>	P. E. NUMBER <td>02/26/14</td>	02/26/14
REVISIONS 2	---	DATE <td>06/06/14</td>	06/06/14
REVISIONS 3	---	DATE <td>---</td>	---
REVISIONS 4	---	DATE <td>---</td>	---
FIELD CHANGES	---	DATE <td>---</td>	---

PORTLAND INTERNATIONAL MARINE TERMINAL  
EXISTING LAYDOWN AND CONNECTING CORRIDOR CONNECTION  
PORTLAND  
CUMBERLAND COUNTY  
ELECTRICAL PLAN - PART 2

**ELECTRICAL PLAN - PART 2**  
SCALE: 1" = 50'- 0"  
(SEE SHEET E01 FOR NOTES)