

Date: 12/15/2017

Username:

Division:

Filename: 003_Existing Conditions (G03).dgn

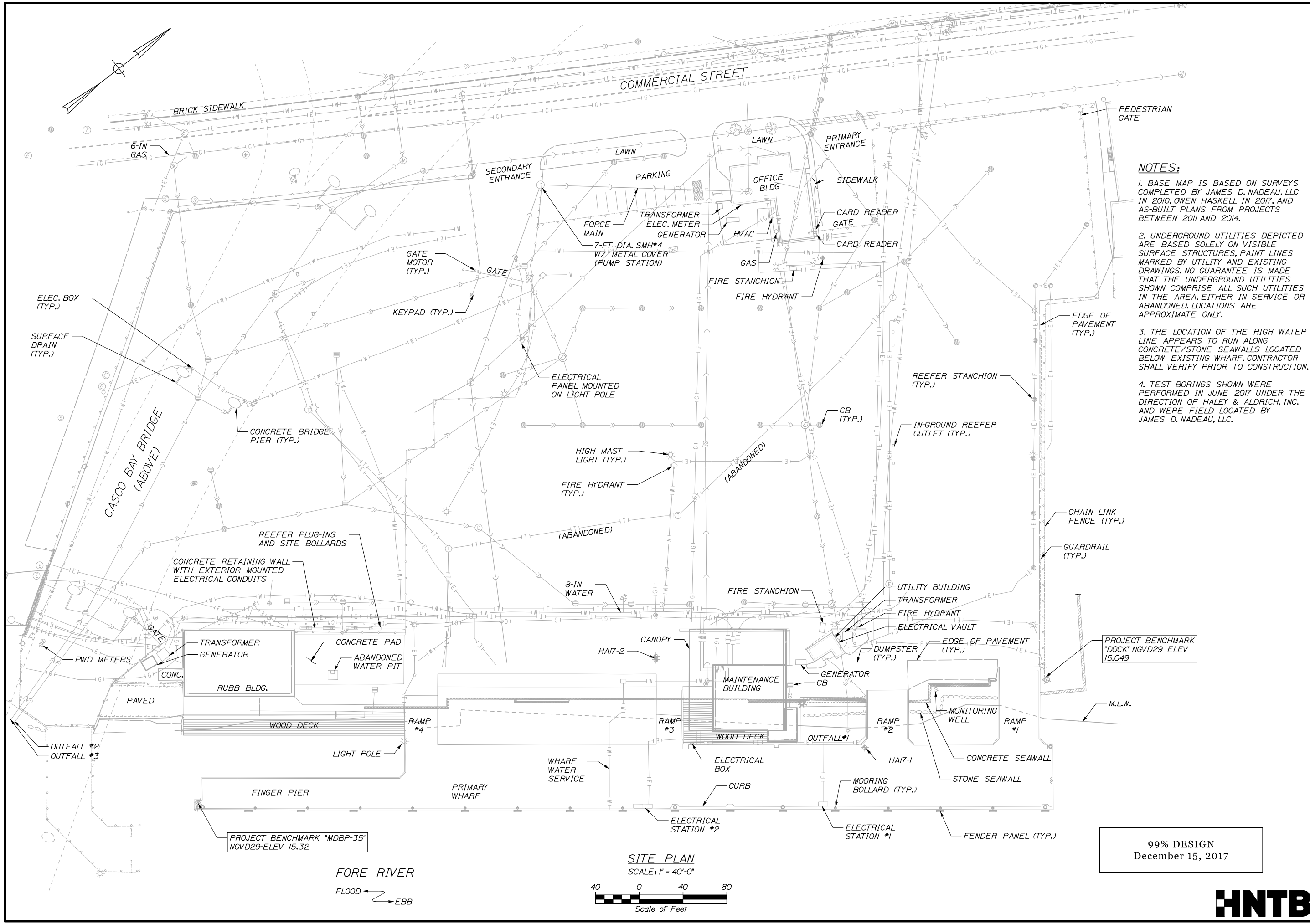

- NOTES:**
1. BASE MAP IS BASED ON SURVEYS COMPLETED BY JAMES D. NADEAU, LLC IN 2010, OWEN HASKELL IN 2017, AND AS-BUILT PLANS FROM PROJECTS BETWEEN 2011 AND 2014.
 2. UNDERGROUND UTILITIES DEPICTED ARE BASED SOLELY ON VISIBLE SURFACE STRUCTURES, PAINT LINES MARKED BY UTILITY AND EXISTING DRAWINGS. NO GUARANTEE IS MADE THAT THE UNDERGROUND UTILITIES SHOWN COMPRISE ALL SUCH UTILITIES IN THE AREA, EITHER IN SERVICE OR ABANDONED. LOCATIONS ARE APPROXIMATE ONLY.
 3. THE LOCATION OF THE HIGH WATER LINE APPEARS TO RUN ALONG CONCRETE/STONE SEAWALLS LOCATED BELOW EXISTING WHARF. CONTRACTOR SHALL VERIFY PRIOR TO CONSTRUCTION.
 4. TEST BORINGS SHOWN WERE PERFORMED IN JUNE 2017 UNDER THE DIRECTION OF HALEY & ALDRICH, INC. AND WERE FIELD LOCATED BY JAMES D. NADEAU, LLC.

SITE PLAN

SCALE: 1" = 40'-0"

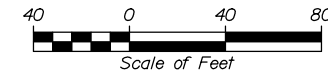

99% DESIGN
December 15, 2017

STATE OF MAINE		DEPARTMENT OF TRANSPORTATION	
STP 2194(206)		WIN 021942.06	
PROJECT MANAGER	DESIGN-DETAILED	CHECKED-REVIEWED	DESIGNS-DETAILED
J. Burns	T. Poplin		
BY	DATE	DATE	DATE
P. Bishop	12/17		
C. Marin	12/17		
SIGNATURE	P.E. NUMBER	DATE	
PORTLAND INTERNATIONAL MARINE TERMINAL		EXISTING CONDITIONS	
MAINE INTERMODAL PORT PRODUCTIVITY PROJECT			
WHARF INFILL & BUILDING REMOVAL			
PORTLAND CUMBERLAND COUNTY			
SHEET NUMBER		G03	
		3 OF 21	

