

\\ds413\projects\11-46 sprague boatyard\cad\11-46 new yard llc civil.dwg

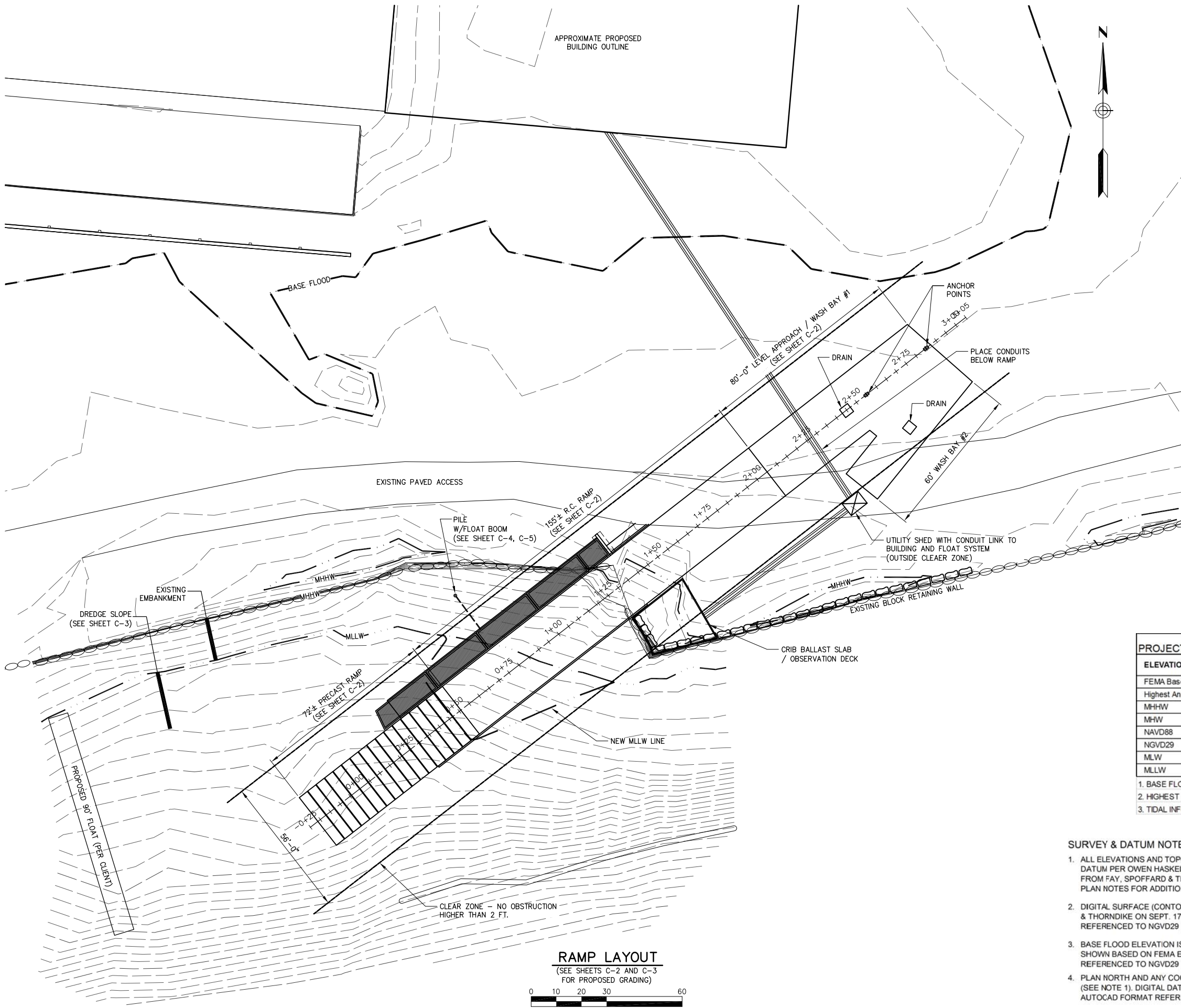

LEGEND:

- - - - - INDEX CONTOUR (EG)
- - - - - INTERMEDIATE CONTOUR (EG)
- · — · — MHHW
- · — · — MLLW
- · — · — INDEX CONTOUR (FG)
- · — · — INTERMEDIATE CONTOUR (FG)
- — — — FLOOD PLAIN



**RAMP LAYOUT**  
 (SEE SHEETS C-2 AND C-3  
 FOR PROPOSED GRADING)

PROJECT ELEVATIONS (BY DATUM)				
ELEVATION	CHART (ft)	NGVD29 (ft)	NAVD88 (ft)	Notes
FEMA Base Flood	14.52	10.00	9.27	FEMA Zone "A2"
Highest Annual Tide	11.90	7.38	6.65	2013 MEDEP Predictions
MHHW	9.90	5.38	4.65	BASED ON TIDAL BM "PORTLAND"
MHW	9.47	4.95	4.22	
NAVD88	5.25		0.00	
NGVD29	4.52	0.00		
MLW	0.34	-4.18	-4.91	
MLLW	0.00	-4.52	-5.25	

1. BASE FLOOD INFORMATION TAKEN FROM FEMA FLOOD INSURANCE RATE MAP  
 2. HIGHEST ANNUAL TIDE TAKEN FROM MAINE DEP PUBLISHED PREDICTIONS  
 3. TIDAL INFORMATION TAKEN FROM NOAA PUBLISHED DATA

- SURVEY & DATUM NOTES**
- ALL ELEVATIONS AND TOPOGRAPHY PROVIDED ON THE PLANS ARE REFERENCED TO NGVD29 DATUM PER OWEN HASKELL, INC. ALTA/ACSM LAND TITLE SURVEY DATED 7-02-2012 RECEIVED FROM FAY, SPOFFARD & THORNDIKE, UNLESS OTHERWISE NOTED. SEE OWEN HASKEEL, INC PLAN NOTES FOR ADDITIONAL INFORMATION.
  - DIGITAL SURFACE (CONTOURS) PROVIDED IN AUTOCAD (CIVIL3D) FORMAT BY FAY, SPOFFARD & THORNDIKE ON SEPT. 17, 2013. TOPOGRAPHY IS FROM OWEN HASKELL, INC SURVEY REFERENCED TO NGVD29 (SEE NOTE 1).
  - BASE FLOOD ELEVATION IS BASED ON FEMA FLOOD INSURANCE RATE MAP. BASE FLOOD LINE SHOWN BASED ON FEMA ELEVATION (NGVD29) AND OWEN HASKELL, INC TOPOGRAPHY REFERENCED TO NGVD29 (SEE NOTE 1).
  - PLAN NORTH AND ANY COORDINATES PROVIDED ARE BASED ON OWEN HASKELL, INC SURVEY (SEE NOTE 1). DIGITAL DATA (PLAN) RECEIVED FROM FAY, SPOFFARD & THORNDIKE IN AUTOCAD FORMAT REFERENCED TO "MAINE STATE PLANE WEST NAD83 DATUM".

**BAKER DESIGN CONSULTANTS**  
 Civil, Marine, and Structural Engineering  
 7 Spruce Road • Freeport • Maine • 04032 • 207-866-5724 • info@bakerdcs.com

NO.	A	B	C	D	E	CONSTRUCTION (7' SHIFT NW)	9-26-13	B/JB	INT.
						CLIENT REVIEW	9-17-13	JJC	
						CLIENT REVIEW	9-16-13	B/JB	
						CLIENT REVIEW	9-11-13	B/JB	
						FINAL ALIGNMENT REVIEW	8-29-13	B/JB	
						SUBMISSION			

DESIGNED BY: B/JB  
 DRAWN BY: JJC  
 CHECKED BY: B/JB  
 SCALE: AS SHOWN

**BOAT RAMP SITE LAYOUT**

PROJECT: NEW YARD LLC  
 CANAL LANDING  
 PORTLAND, MAINE

DATE	AUG 2013
CONTRACT NO.	11-46
SHEET NO.	C-1
REV.	E