

City of Portland, Maine - Building or Use Permit Application

389 Congress Street, 04101 Tel: (207) 874-8703, Fax: (207) 874-8716

Permit No: 04-0959	Issue Date:	CBL: 058 F013001
-----------------------	-------------	---------------------

Location of Construction: 24 Brackett St	Owner Name: Mesden Llc	Owner Address: 28 Chestnut St	Phone:
Business Name:	Contractor Name: Spencer Gould	Contractor Address: 8 Homewood Gray	Phone: 2076573763
Lessee/Buyer's Name	Phone:	Permit Type: HVAC	Zone: R-6

Past Use: Condo	Proposed Use: Condo Direct Vent Fireplace	Permit Fee: \$93.00	Cost of Work: \$8,000.00	CEO District: 2
--------------------	--	------------------------	-----------------------------	--------------------

Proposed Project Description: Condo Direct Install a Simpson Direct Vent Fireplace on the floor	FIRE DEPT: <input checked="" type="checkbox"/> Approved <input type="checkbox"/> Denied	INSPECTION: Use Group: U Type: Heating State Craft Regs
	Signature: <i>UMW7</i>	Signature: <i>[Signature]</i>
PEDESTRIAN ACTIVITIES DISTRICT (P.A.D.) Action: <input type="checkbox"/> Approved <input type="checkbox"/> Approved w/Conditions <input type="checkbox"/> Denied Signature: _____ Date: _____		

Permit Taken By: dmartin	Date Applied For: 07/13/2004	Zoning Approval
-----------------------------	---------------------------------	------------------------

1. This permit application does not preclude the Applicant(s) from meeting applicable State and Federal Rules. 2. Building permits do not include plumbing, septic or electrical work. 3. Building permits are void if work is not started within six (6) months of the date of issuance. False information may invalidate a building permit and stop all work..	Special Zone or Reviews <input type="checkbox"/> Shoreland <input type="checkbox"/> Wetland <input type="checkbox"/> Flood Zone <input type="checkbox"/> Subdivision <input type="checkbox"/> Site Plan Maj <input type="checkbox"/> Minor <input type="checkbox"/> (MM)	Zoning Appeal <input type="checkbox"/> Variance <input type="checkbox"/> Miscellaneous <input type="checkbox"/> Conditional Use <input type="checkbox"/> Interpretation <input type="checkbox"/> Approved <input type="checkbox"/> Denied	Historic Preservation <input checked="" type="checkbox"/> Not in District or Landmark <input type="checkbox"/> Does Not Require Review <input type="checkbox"/> Requires Review <input type="checkbox"/> Approved <input type="checkbox"/> Approved w/Conditions <input type="checkbox"/> Denied
	Date: <i>OK 7/14/04</i>	Date: _____	Date: _____

CERTIFICATION

I hereby certify that I am the owner of record of the named property, or that the proposed work is authorized by the owner of record and that I have been authorized by the owner to make this application as his authorized agent and I agree to conform to all applicable laws of this jurisdiction. In addition, if a permit for work described in the application is issued, I certify that the code official's authorized representative shall have the authority to enter all areas covered by such permit at any reasonable hour to enforce the provision of the code(s) applicable to such permit.

SIGNATURE OF APPLICANT	ADDRESS	DATE	PHONE
RESPONSIBLE PERSON IN CHARGE OF WORK, TITLE		DATE	PHONE

#2

58 F 013



FILL IN AND SIGN WITH INK

APPLICATION FOR PERMIT HEATING OR POWER EQUIPMENT

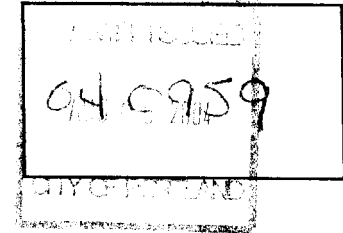

To the INSPECTOR OF BUILDINGS, PORTLAND, ME.

The undersigned hereby applies for a permit to install the following heating, cooking or power equipment in accordance with the Laws of Maine, the Building Code of the City of Portland, and the following specifications:

Location / CBL 20-24 BRACKETT ST PORTLAND ME Use of Building CONDOMINIUMS Date 7-15-09
 Name and address of owner of appliance MESDEN, LLC 28 CHESTNUT ST.
OLD ORCHARD BEACH ME. 04064
 Installer's name and address Spencer Gould 8 Homewood Way Gray
04039 Maine Telephone 657-3763 / 415-8070

Location of appliance:

Basement Floor
 Attic Roof

Type of Fuel:

Gas Oil Solid

Appliance Name: WONESSEN-FIREPLACE
 U.L. Approved Yes No

Will appliance be installed in accordance with the manufacture's installation instructions? Yes No

IF NO Explain: _____

The Type of License of Installer:

Master Plumber # _____
 Solid Fuel # _____
 Oil # _____
 Gas # PNT4866
 Other _____

Type of Chimney:

Masonry Lined
 Factory built _____

Metal
 Factory Built U.L. Listing # _____

Direct Vent
 Type SIMPSON DIRECT UL# _____

Type of Fuel Tank

Oil
 Gas

Size of Tank NONE

Number of Tanks NONE

Distance from Tank to Center of Flame _____ feet.

Cost of Work: \$ 6000⁰⁰

Permit Fee: \$ 93.00

Approved

Approved with Conditions

Fire: AD 11/17
 Ele.: _____
 Bldg.: _____

See attached letter or requirement

Signature of Installer _____

Inspector's Signature _____

Date Approved _____

7/12/09

White - Inspection Yellow - File Pink - Applicant's Gold - Assessor's Copy

CK# 619

City of Portland, Maine - Building or Use Permit

389 Congress Street, 04101 Tel: (207) 874-8703, Fax: (207) 874-8716

Permit No: 04-0959	Date Applied For: 07/13/2004	CBL: 058 F013001
------------------------------	--	----------------------------

Location of Construction: 24 Brackett St	Owner Name: Mesden Llc	Owner Address: 28 Chestnut St	Phone:
Business Name:	Contractor Name: Spencer Gould	Contractor Address: 8 Homeword Gray	Phone (207) 657-3763
Lessee/Buyer's Name	Phone:	Permit Type: HVAC	

Proposed Use: Condo Direct Vent Fireplace - no change of use	Proposed Project Description: Condo Direct Install a Simpson Direct Vent Fireplace on the floor
--	---

Dept: Zoning	Status: Approved	Reviewer: Marge Schmuckal	Approval Date: 07/14/2004
Note: four legal condominium dwelling units			Ok to Issue: <input checked="" type="checkbox"/>
Dept: Building	Status: Approved with Conditions	Reviewer: Tammy Munson	Approval Date: 08/05/2004
Note:			Ok to Issue: <input checked="" type="checkbox"/>
Dept: Fire	Status: Approved with Conditions	Reviewer: Lt. MacDougal	Approval Date: 07/19/2004
Note: 1) fireplace shall be installed in accordance with the manufactors instructions			Ok to Issue: <input checked="" type="checkbox"/>

Comments:
7/19/04-mjn: Need Fire separation assembly information, Left message with the applicant
8/5/04-tmm: ok to issue - rating enclosure submitted and inspected for vent.

Prmt	9524	Text93	Other	Nurm1	40959
Permit Nbr	04-0959	Location of Construction	Brackett St	Appl. Date	07/13/2004
Status	Hold	Permit Type	HVAC	Issue Date	
CBL	058 F013001	District Nbr	2	Estimated Cost	\$8,000.00
		Constr Type	Other	Date Closed	

Comment Date	Comment	Name	Follow Up Date	Completed
08/05/2004	ok to issue - raftering enclosure submitted and inspected for vent.	frmm		<input type="checkbox"/>
07/19/2004	Need fire separation assembly information, left message with the applicant	mjin		<input type="checkbox"/>

CreatedBy	dmartin	CreateDate	07/13/2004	ModBy	mjin	ModDate	07/19/2004
-----------	---------	------------	------------	-------	------	---------	------------

20-24 BRACKETT ST
PORTLAND MAINE

58 F 013

1.) FLOOR SHEATHING $\frac{3}{4}$ " TONGUE AND GROOVE APA RATED
PLYWOOD

2.) B.D.Y 500 Series DIRECT VENT FIREPLACE

B.T.U 18,000 - 26,000

NATURAL GAS

VENTING PIPE

SIMPSON DURA VENT $4" \times 6\frac{5}{8}"$

2 EA 45° ELBOWS

1 EA 90° ELBOWS

13' SIMPSON DURA VENT PIPE

COST \$8000.00

20-24 BRACKETT ST
PORTLAND, MAINE

BUILDER
MESDEN, LLC

High Voltage
Cable
↓

2nd Floor

Living Room
Floor

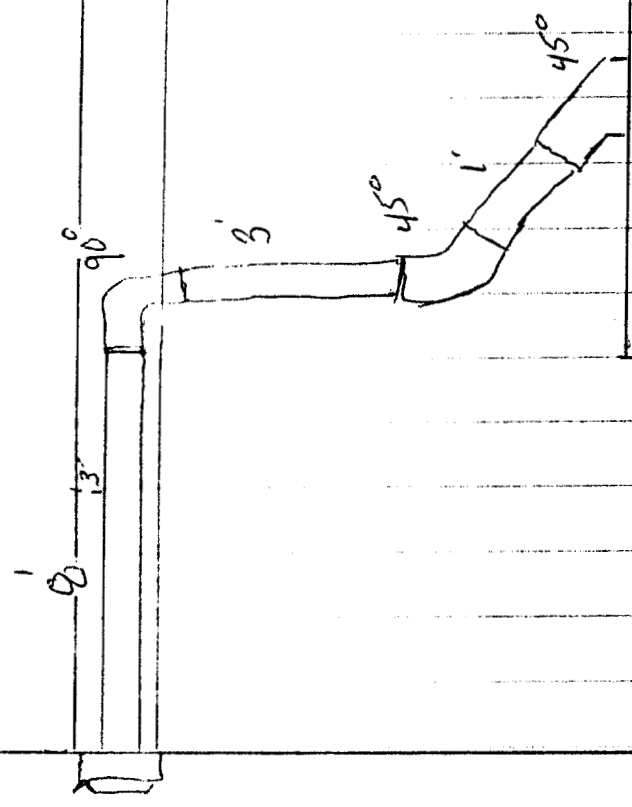

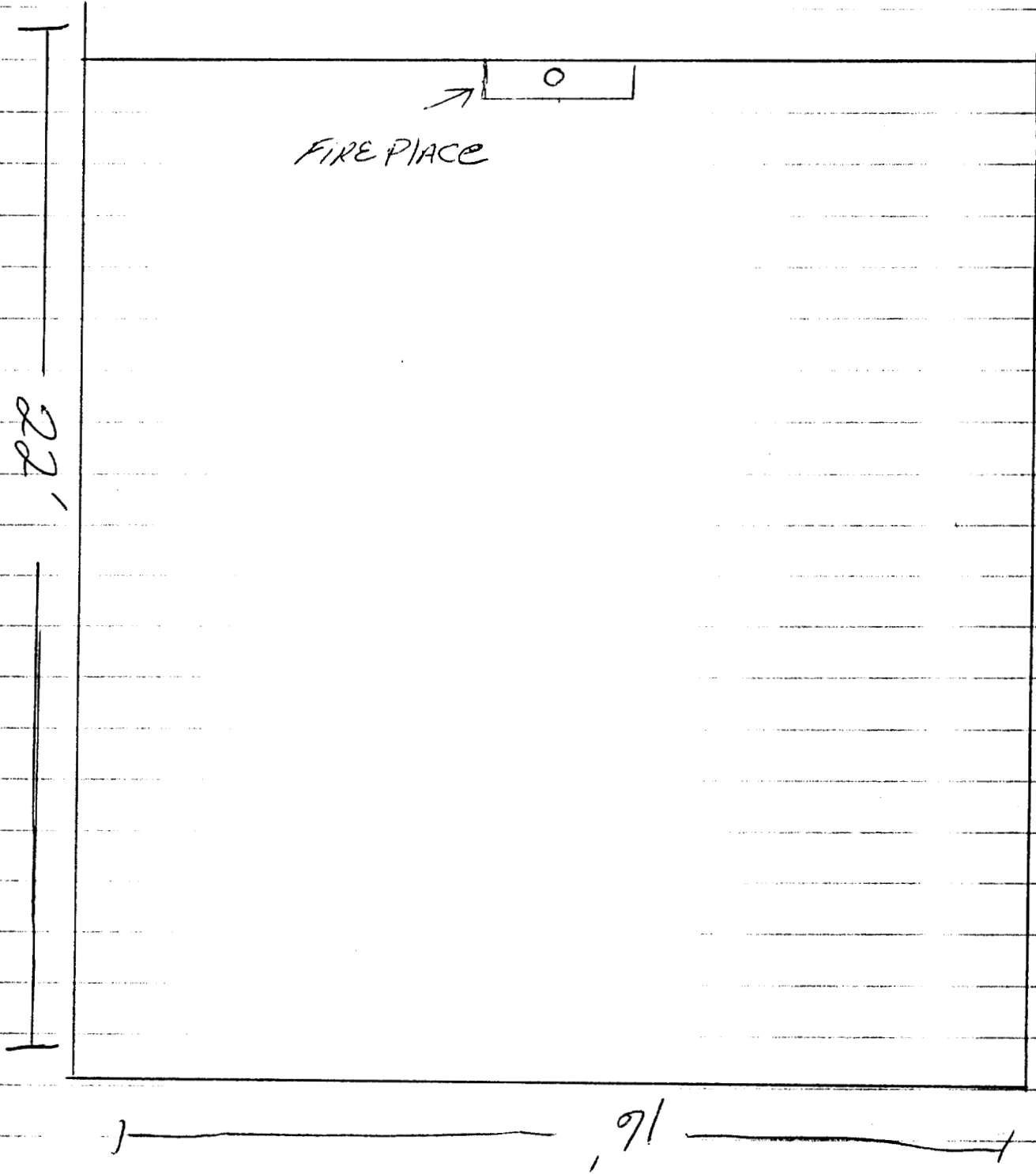

FIRE PLACE

22'

16'

Manufactured by:
Monessen Hearth Systems, Inc.
149 Cleveland Drive
Paris, KY 40361

Model: BDV500NV
Serial No: 04-B-032057

Gas: NATURAL

Input Rating: Max. 26000 BTU/Hr.
Min. 20000 BTU/Hr.

Manifold Pressure: 3.5" W.C.
For Purpose of Input Adjustment:
Min. Supply Pressure: 4" W.C.
Max. Supply Pressure: 10.5" W.C.

Control Type: 21

Burner Orifice Size—#41 DMS
This unit Complies with:
ANS Z21.88—2002, CSA 2.33—2002
BLOT400 fan or blower may be used
(120V/60Hz/1A)

**VENTED GAS FIREPLACE HEATER
NOT FOR USE WITH SOLID FUEL**

Clearances to combustibles
Back: 0" Side: 0"
Bottom: 0" Top: 0"
Clearances to pipe
Top: 3" Sides/Bottom: 1"
Mantel clearances from top of unit
2" Mantel: 3" 6" Mantel: 5"
8" Mantel: 7" 12" Mantel: 11"
This appliance equipped only for altitudes
0—2000 feet (0—610 m).

This appliance must be installed in accordance*
with local codes, if any; if none, follow the
National Fuel Gas Code, ANSI Z223.1, or
Canadian Installation Codes, CAN/CGA—B149.



HORIZONTAL SQUARE TERMINATION CAP

Standard Termination Cap

For horizontal (through-wall) terminations only. Check installation instructions for restrictions on horizontal cap terminations such as minimum distance from windows and doors.

High Wind Termination Cap (shown below)

May be required when high winds are present. For horizontal (through-wall) installations only.

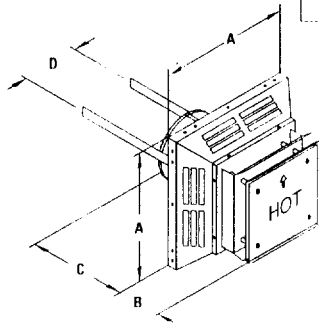
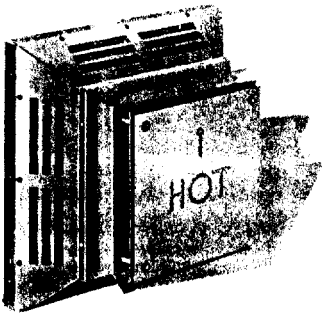

4" x 6 ⁵ / ₈ " Standard Termination Cap	A	B	C	D
984	13 ¹ / ₂ "	6 ⁷ / ₈ "	3"	6 ⁵ / ₈ "

5" x 8" Standard Termination Cap	A	B	C	D
1284	16"	6 ⁷ / ₈ "	3"	8"

4" x 6 ⁵ / ₈ " High Wind Termination Cap	A	B	C	D
985	13 ¹ / ₂ "	6 ⁷ / ₈ "	3"	6 ⁵ / ₈ "

5" x 8" High Wind Termination Cap	A	B	C	D
1285	16"	6 ⁷ / ₈ "	3"	8"

SNORKEL TERMINATION CAP

The Snorkel is used when a vertical rise is desired in the system to meet appliance manufacturer recommended minimum heights. Do not enclose Snorkel in the wall. Do not install below grade. For horizontal (through-wall) terminations only.

4" x 6 ⁵ / ₈ " Snorkel	Stock #	A	B	C	D
14" Rise	982	13 ¹ / ₂ "	27"	14"	10"
36" Rise	981	13 ¹ / ₂ "	49"	36"	10"

5" x 8" Snorkel	Stock #	A	B	C	D
14" Rise	1282	13 ¹ / ₂ "	27"	14"	10"
36" Rise	1281	13 ¹ / ₂ "	49"	36"	10"

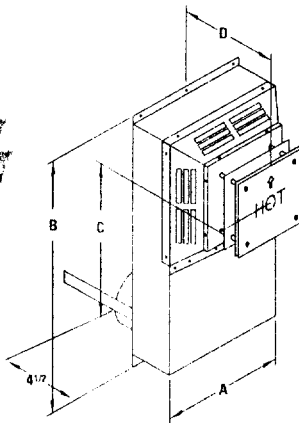
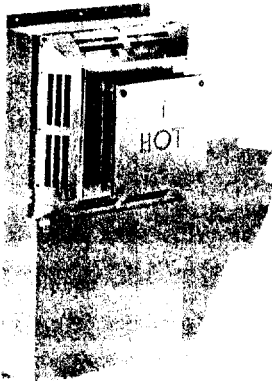

#2

58 F 013



FILL IN AND SIGN WITH INK

APPLICATION FOR PERMIT HEATING OR POWER EQUIPMENT

040959

To the INSPECTOR OF BUILDINGS, PORTLAND, ME.

The undersigned hereby applies for a permit to install the following heating, cooking or power equipment in accordance with the Laws of Maine, the Building Code of the City of Portland, and the following specifications:

Location / CBL 30-24 BRACKET ST PORTLAND ME Use of Building CONDOMINIUMS Date 7-13-04
 Name and address of owner of appliance MESDEN, LLC 28 CHESTNUT ST,
OLD ORCHARD BEACH ME 04064
 Installer's name and address Spencer Gould 8 Homewood way Gray
04039 Maine Telephone 657-3763/415-8070

Location of appliance:

- Basement
- Floor
- Attic
- Roof

Type of Fuel:

- Gas
- Oil
- Solid

Appliance Name: MO NESSEN-FIRE PLACE

U.L. Approved Yes No

Will appliance be installed in accordance with the manufacture's installation instructions? Yes No

IF NO Explain: _____

The Type of License of Installer:

- Master Plumber # _____
- Solid Fuel # _____
- Oil # _____
- Gas # PNT4866
- Other _____

Type of Chimney:

- Masonry Lined
Factory built _____
- Metal
Factory Built U.L. Listing # _____
- Direct Vent
Type SIMPSON DIRECT UL# _____

Type of Fuel Tank

- Oil
- Gas

JUL 13

Size of Tank NONE

Number of Tanks NONE

Distance from Tank to Center of Flame _____ feet.

Cost of Work: \$ 8000.00

Permit Fee: \$ 93.00

Approved

Fire: [Signature]
 Ele.: _____
 Bldg.: _____

Approved with Conditions

- See attached letter or requirement

Signature of Installer [Signature]

Inspector's Signature

Date Approved

7/12/04

White - Inspection Yellow - File Pink - Applicant's Gold - Assessor's Copy

CHK # 619