

18 SUMMER STREET

SHANKS & CO.

Full cut # 920R - Half cut # 920H - Third cut # 9203H - Fine cut

INTERIOR CHIMNEY

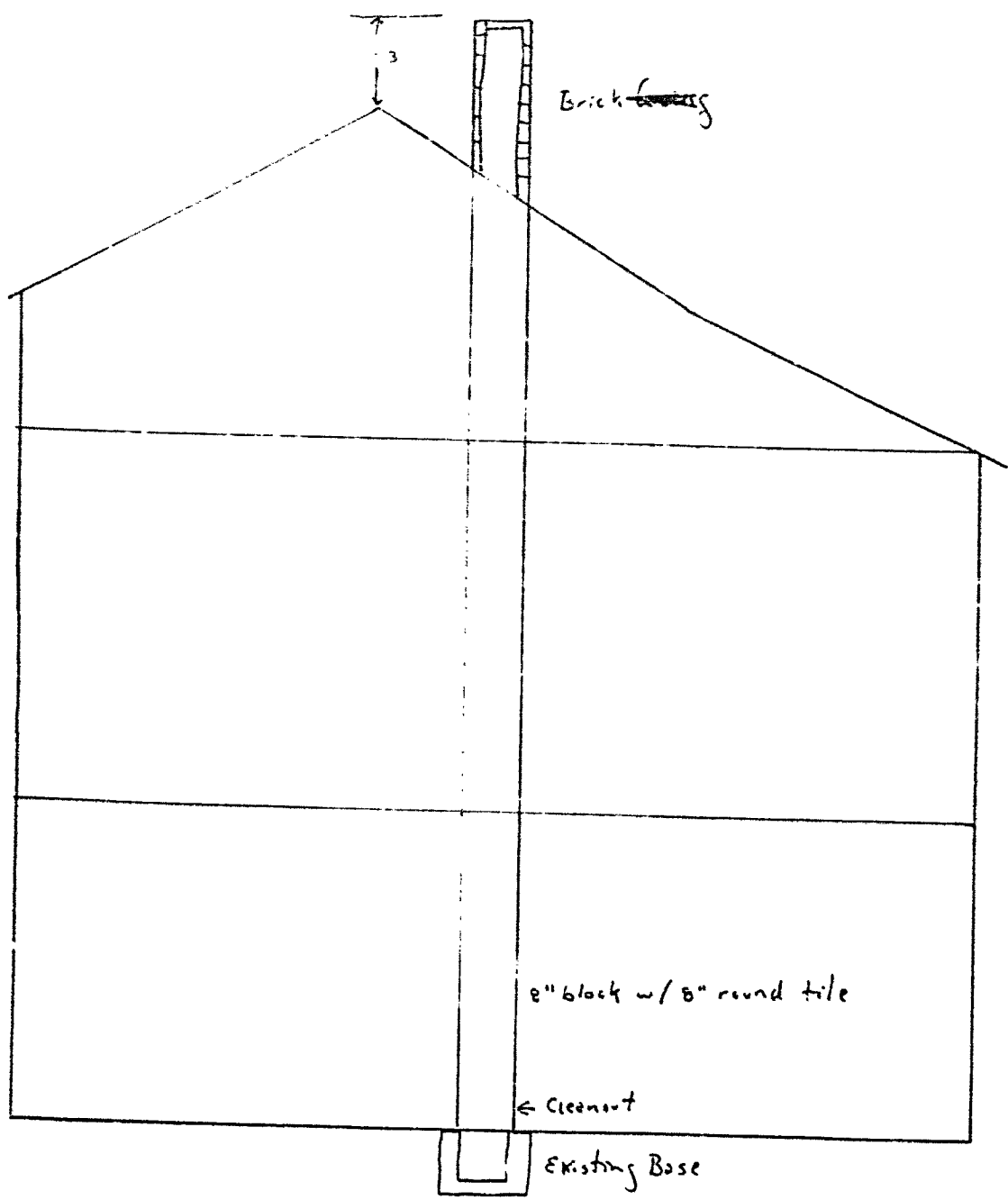

William Carroll
18 Summer Street

RECEIVED
OCT 20 1982
DEPT. OF BLDG. INSP.
CITY OF PORTLAND



CITY OF PORTLAND

JOSEPH E. GRAY, JR.
DIRECTOR OF PLANNING
AND URBAN DEVELOPMENT

October 21, 1982

Mr. William Carroll
18 Summer Street
Portland, Maine 04102

Re: 18 Summer Street

Dear Mr. Carroll:

Your application for a building permit to erect a chimney at 18 Summer Street is being issued with the following requirements:

1. The foundation of a masonry chimney shall be supported on properly designed foundation of approved noncombustible material having a fire resistance rating of not less than three hours provided such supports are independent of the building construction and the load is transferred to the ground.
2. Chimneys shall not support any structural load other than their own weight unless designed to act as supporting member. Chimneys in combustible buildings shall be anchored laterally at the ceiling liner, and at each floor line which is more than 6 feet above grade, except when entirely within the framework of the building.
3. Chimney passageways shall not be smaller in area than vent connection on the appliance attached thereto.
4. Every connector or inlet to any masonry chimney shall enter the side thereof and shall be of metal not less than No. 24 manufacturers standard gauge.
5. Approved cleanouts shall be provided having a tight fitting cover. Such cleanouts shall be installed at least 12 inches below the lowest chimney inlet opening.
6. All spaces between chimneys, and floors, and ceilings through which chimneys may pass shall be fire stopped with noncombustible material. The firestopping of spaces between chimneys and wood joist, beams, or headers shall be to a depth of 1 inch only placed on strips of metal or metal lath laid across the spaces between combustible material and the chimney.

If you have any questions on these requirements, please call this office.

Sincerely,

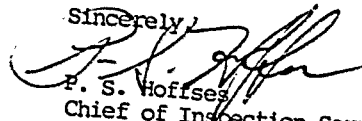
P. S. Hoffses
Chief of Inspection Services

PSH/jmr

380 CONGRESS STREET • PORTLAND, MAINE 04101 • TELEPHONE (207) 775-5451

APPLICATION FOR PERMIT

B.O.C.A. USE GROUP
B.O.C.A. TYPE OF CONSTRUCTION 00942
ZONING LOCATION PORTLAND, MAINE Oct. 20, 82

PERMIT ISSUED

OCT 21 1982

CITY of PORTLAND

To the CHIEF OF BUILDING & INSPECTION SERVICES, PORTLAND, MAINE

The undersigned hereby applies for a permit to erect, alter, repair, demolish, move or install the following building, structure, equipment or change use in accordance with the Laws of the State of Maine, the Portland B.O.C.A. Building Code and Zoning Ordinance of the City of Portland with plans and specifications, if any, submitted herewith and the following specifications:

LOCATION 18 Summer Street
1. Owner's name and address William Carroll - same Fire District #1, #2
2. Lessee's name and address Telephone 773-2645
3. Contractor's name and address Ralph Mahon - Freeport, Maine Telephone

Proposed use of building single fam. No. of sheets 1
Last use same No. families
Material No. stories Heat Style of roof Roofing
Other buildings on same lot
Estimated contractual cost \$ 1,000.00

FIELD INSPECTOR - Mr. Appeal Fees \$
Base Fee
Late Fee
TOTAL \$ 15.00

To replace existing chimney, as per plan. Interior chimney.

(SEND PERMIT TO ABOVE ADDRESS)

Stamp of Special Conditions
PERMIT ISSUED
WITH LETTER

NOTE TO APPLICANT: Separate permits are required by the installers and subcontractors of heating, plumbing, electrical and mechanicals.

DETAILS OF NEW WORK

Is any plumbing involved in this work? Is any electrical work involved in this work?
Is connection to be made to public sewer? If not, what is proposed for sewage?
Has septic tank notice been sent? Form notice sent?
Height average grade to top of plate Height average grade to highest point of roof
Size, front depth No. stories solid or filled land? earth or rock?
Material of foundation Thickness, top bottom cellar
Kind of roof Rise per foot Roof covering
No. of chimneys Material of chimneys Brick or lining Kind of heat fuel
Framing Lumber - Kind Dressed or full size? Corner posts Sills
Size Girder Columns under girders Size Max. on centers
Studs (outside walls and carrying partitions) 2x4-16" O. C. Bridging in every floor and flat roof span over 8 feet.
Joists and rafters: 1st floor, 2nd, 3rd, roof
On centers: 1st floor, 2nd, 3rd, roof
Maximum span: 1st floor, 2nd, 3rd, roof
If one story building with masonry walls, thickness of walls? height?

IF A GARAGE

No. cars now accommodated on same lot, to be accommodated, number commercial cars to be accommodated
Will automobile repairing be done other than minor repairs to cars habitually stored in the proposed building?

APPROVALS BY: DATE
BUILDING INSPECTION - PLAN EXAMINER
ZONING:
BUILDING CODE:
Fire Dept.:
Health Dept.:
Others:

MISCELLANEOUS
Will work require disturbing of any tree on a public street?
Will there be in charge of the above work a person competent to see that the State and City requirements pertaining thereto are observed?

Signature of Applicant William G. Carroll Phone #
Type Name of above William Carroll 1, 2, 3, 4

PERMIT ISSUED
WITH LETTER

5 Mr. Lewis

FIELD INSPECTOR'S COPY APPLICANT'S COPY OFFICE FILE COPY

NOTES

Nov 5/82
Chimney in Receipt

Permit # 82/912
 Location 18 Sunway St
 Owner M. Williams-Cornell
 Date of permit 10-20-82
 Approved 10-21-82
 Dwelling Chimney
 Garage _____
 Alteration _____

[Empty lined area for notes]

[Empty lined area for notes, crossed out with a large X]



APPLICATION FOR PERMIT
 DEPARTMENT OF BUILDING INSPECTIONS SERVICES
 ELECTRICAL INSTALLATIONS

Date Nov 23, 19 76
 Receipt and Permit number A1981

To the CHIEF ELECTRICAL INSPECTOR, Portland, Maine:
 The undersigned hereby applies for a permit to make electrical installations in accordance with the laws of Maine, the Portland Electrical Ordinance, the National Electrical Code and the following specifications:

LOCATION OF WORK: 18 Summer St.
 OWNER'S NAME: Patrick G. Dube ADDRESS: same

OUTLETS: (number of) 1-30

Lights	_____	
Receptacles	_____	
Switches	_____	
Plugmold	_____ (number of feet)	
TOTAL	_____	FEES

Incandescent	_____	
Fluorescent	_____ (Do not include strip fluorescent)	
TOTAL	_____	3.00
Strip Fluorescent, in feet	_____	

SERVICES:

Permanent, total amperes	_____	
Temporary	_____	

METERS: (number of) _____

MOTORS: (number of)

Fractional	_____	
1 HP or over	_____	

RESIDENTIAL HEATING:

Oil or Gas (number of units)	_____	
Electric (number of rooms)	_____	

COMMERCIAL OR INDUSTRIAL HEATING:

Oil or Gas (by a main boiler)	_____	
Oil or Gas (by separate units)	_____	
Electric (total number of kws)	_____	

APPLIANCES: (number of)

Ranges	_____	Water Heaters	_____
Cook Tops	_____	Disposals	_____
Wall Ovens	_____	Dishwashers	_____
Dryers	_____	Compactors	_____
Fans	_____	Others (denote)	_____
TOTAL	_____		

MISCELLANEOUS: (number of)

Branch Panels	<u>1</u>		<u>1.00</u>
Transformers	_____		
Air Conditioners	_____		
Signs	_____		
Fire/Burglar Alarms	_____		
Circus, Fairs, etc.	_____		
Alterations to wires	_____		
Repairs after fire	_____		
Heavy Duty, 220v outlets	_____		
Emergency Lights, battery	_____		
Emergency Generators	_____		

INSTALLATION FEE DUE:	_____
FOR ADDITIONAL WORK NOT ON ORIGINAL PERMIT	_____
FOR REMOVAL OF A "STOP ORDER" (304-16.b)	_____
FOR PERFORMING WORK WITHOUT A PERMIT (304-9)	_____
TOTAL AMOUNT DUE:	<u>4.00</u>

INSPECTION:
 Will be ready on _____, 19____; or Will Call

CONTRACTOR'S NAME: Caron & Waltz
 ADDRESS: 416 Preble St., So Portland
 TEL.: 799-2228

MASTER LICENSE NO. 2498 SIGNATURE OF CONTRACTOR: _____
 LIMITED LICENSE NO. _____

INSPECTOR'S COPY

CITY OF PORTLAND, MAINE
Application for Permit to Install Wires

Permit No. 58915

Issued
 Portland, Maine Sept 1, 1972

To the City Electrician, Portland, Maine:

The undersigned hereby applies for a permit to install wires for the purpose of conducting electric current, in accordance with the laws of Maine, the Electrical Ordinance of the City of Portland, and the following specifications:

(This form must be completely filled out - Minimum Fee, \$1.00)

Owner's Name and Address Priscilla Smith Tel. _____
 Contractor's Name and Address Tommy Cavello Tel. 774 3813
 Location 18 Summer St. Use of Building Home
 Number of Families 1 Apartments _____ Stories 2 Number of Stories 2
 Description of Wiring: New Work _____ Additions _____ Alterations _____
new service

Pipe _____ Cable _____ Metal Molding _____ BX Cable _____ Plug Molding (No. of feet) _____
 No. Light Outlets _____ Plugs _____ Light Circuits _____ Plug Circuits _____
 FIXTURES: No. _____ Fluor. or Strip Lighting (No. feet) _____
 SERVICE: Pipe _____ Cable _____ Underground _____ No. of Wires 3 Size 7/8 - 1/4 in.
 METERS: Relocated _____ Added _____ Total No. Meters _____
 MOTORS: Number _____ Phase _____ H. P. _____ Amps _____ Volts _____ Starter _____
 HEATING UNITS: Domestic (Oil) _____ No. Motors _____ Phase _____ H.P. _____
 Commercial (Oil) _____ No. Motors _____ Phase _____ H.P. _____
 Electric Heat (No. of Rooms) _____

APPLIANCES: No. Ranges _____ Watts _____ Brand Feeds (Size and No.) _____
 Elec. Heaters _____ Watts _____
 Miscellaneous _____ Watts _____ Extra Cabinets or Panels _____
 Transformers _____ Air Conditioners (No. Units) _____ Signs (No. Units) _____
 Will commence _____ 19 _____ Ready to cover in _____ 19 _____ Inspection _____ 19 _____
 Amount of Fee \$ 2.00

Signed Tommy Cavello

DO NOT WRITE BELOW THIS LINE

SERVICE	METER	GROUND
VISITS: 1	2	3
4	5	6
7	8	9
10	11	12

REMARKS:

INSPECTED BY F. W. [Signature]
 (OVER)

LOCATION *Summer ST 18*
 INSPECTION DATE *9/21/72*
 WORK COMPLETED *9/21/72*
 TOTAL NO. INSPECTIONS *1*
 REMARKS:

FEES FOR WIRING PERMITS EFFECTIVE JULY 31, 1963

WIRING

1 to 30 Outlets \$ 2.00
 31 to 60 Outlets 3.00
 Over 60 Outlets, each Outlet .05
 (Each twelve feet or fraction there of fluorescent lighting or
 any type of plug molding will be classed as one outlet).

SERVICES

Single Phase 2.00
 Three Phase 4.00

MOTORS

Not exceeding 50 H.P. 3.00
 Over 50 H.P. 4.00

HEATING UNITS

Domestic (Oil) 2.00
 Commercial (Oil) 4.00
 Electric Heat (Each Room) .75

APPLIANCES

Ranges, Cooking Tops, Ovens, Water Heaters, Dishwashers, Built-in
 Dishwashers, Dryers, and any permanent built-in appliance — each
 unit 1.50

MISCELLANEOUS

Temporary Service, Single Phase 1.00