

**City of Portland, Maine - Building or Use Permit Application**

389 Congress Street, 04101 Tel: (207) 874-8703, Fax: (207) 874-8716

Permit No: 09-1361	Issue Date:	CBL: 058 B013001
-----------------------	-------------	---------------------

Location of Construction: 25 SUMMER ST	Owner Name: WEYAND RACHAEL E & SETH	Owner Address: 25 SUMMER ST	Phone:
Business Name:	Contractor Name: Bertel E Serfes Jr	Contractor Address: 21 Ridge Terrace Drive Casco	Phone:
Lessee/Buyer's Name	Phone:	Permit Type: HVAC	Zone: R-6

Past Use: Single Family Home	Proposed Use: Single Family Home - install a Vekmann 100 boiler in basement	Permit Fee: \$50.00	Cost of Work: \$2,200.00	CEO District: 2
---------------------------------	--------------------------------------------------------------------------------	------------------------	-----------------------------	--------------------

**Proposed Project Description:**  
install a Vekmann 100 boiler in basement

**FIRE DEPT:**  Approved  Denied

**INSPECTION:**  
Use Group: R3 Type: HVAC  
IRC 2003  
ST ME GAS REGS  
Signature: JM 12/7/09

**PEDESTRIAN ACTIVITIES DISTRICT (P.A.D.)**  
Action:  Approved  Approved w/Conditions  Denied  
Signature: Date:

Permit Taken By: Ldobson	Date Applied For: 11/30/2009	<b>Zoning Approval</b>
-----------------------------	---------------------------------	------------------------

<p>1. This permit application does not preclude the Applicant(s) from meeting applicable State and Federal Rules.</p> <p>2. Building permits do not include plumbing, septic or electrical work.</p> <p>3. Building permits are void if work is not started within six (6) months of the date of issuance. False information may invalidate a building permit and stop all work..</p>	<p><b>Special Zone or Reviews</b></p> <input type="checkbox"/> Shoreland <input type="checkbox"/> Wetland <input type="checkbox"/> Flood Zone <input type="checkbox"/> Subdivision <input type="checkbox"/> Site Plan Maj <input type="checkbox"/> Minor <input type="checkbox"/> MM <input type="checkbox"/> Date: 12/1/09	<p><b>Zoning Appeal</b></p> <input type="checkbox"/> Variance <input type="checkbox"/> Miscellaneous <input type="checkbox"/> Conditional Use <input type="checkbox"/> Interpretation <input type="checkbox"/> Approved <input checked="" type="checkbox"/> Denied Date: 12/1/09	<p><b>Historic Preservation</b></p> <input checked="" type="checkbox"/> Not in District or Landmark <input type="checkbox"/> Does Not Require Review <input type="checkbox"/> Requires Review <input type="checkbox"/> Approved <input type="checkbox"/> Approved w/Conditions <input type="checkbox"/> Denied Date:
	<p><b>PERMIT ISSUED</b></p> <p>DEC - 7 2009</p> <p>City of Portland</p>		

**CERTIFICATION**

I hereby certify that I am the owner of record of the named property, or that the proposed work is authorized by the owner of record and that I have been authorized by the owner to make this application as his authorized agent and I agree to conform to all applicable laws of this jurisdiction. In addition, if a permit for work described in the application is issued, I certify that the code official's authorized representative shall have the authority to enter all areas covered by such permit at any reasonable hour to enforce the provision of the code(s) applicable to such permit.

SIGNATURE OF APPLICANT	ADDRESS	DATE	PHONE
RESPONSIBLE PERSON IN CHARGE OF WORK, TITLE		DATE	PHONE

**City of Portland, Maine - Building or Use Permit**

389 Congress Street, 04101 Tel: (207) 874-8703, Fax: (207) 874-8716

<b>Permit No:</b> 09-1361	<b>Date Applied For:</b> 11/30/2009	<b>CBL:</b> 058 B013001
------------------------------	----------------------------------------	----------------------------

<b>Location of Construction:</b> 25 SUMMER ST	<b>Owner Name:</b> WEYAND RACHAEL E & SETH S	<b>Owner Address:</b> 25 SUMMER ST	<b>Phone:</b>
<b>Business Name:</b>	<b>Contractor Name:</b> Bertel E Serfes Jr	<b>Contractor Address:</b> 21 Ridge Terrace Drive Casco	<b>Phone:</b>
<b>Lessee/Buyer's Name</b>	<b>Phone:</b>	<b>Permit Type:</b> HVAC	

<b>Proposed Use:</b> Single Family Home - install a Vekmann 100 boiler in basement	<b>Proposed Project Description:</b> install a Vekmann 100 boiler in basement
---------------------------------------------------------------------------------------	----------------------------------------------------------------------------------

**Dept:** Zoning      **Status:** Approved with Conditions      **Reviewer:** Marge Schmuckal      **Approval Date:** 12/01/2009

**Note:** **Ok to Issue:**

- 1) This property shall remain a single family dwelling. Any change of use shall require a separate permit application for review and approval.
- 2) This is NOT an approval for an additional dwelling unit. You SHALL NOT add any additional kitchen equipment including, but not limited to items such as stoves, microwaves, refrigerators, or kitchen sinks, etc. Without special approvals.
- 3) Separate permits shall be required for any new signage.

**Dept:** Building      **Status:** Approved with Conditions      **Reviewer:** Tom Markley      **Approval Date:** 12/07/2009

**Note:** **Ok to Issue:**

- 1) The appliance and venting shall be installed in accordance with the UL listing, IMC 2003 and NFPA 211.
- 2) The installation must comply with the State of Maine Gas Regulations.
- 3) Application approval based upon information provided by applicant. Any deviation from approved plans requires separate review and approval prior to work.



FILL IN AND SIGN WITH INK

PERMIT ISSUED  
DEC - 7 2009

# APPLICATION FOR PERMIT HEATING OR POWER EQUIPMENT

City of Portland

To the INSPECTOR OF BUILDINGS, PORTLAND, ME.

The undersigned hereby applies for a permit to install the following heating, cooking or power equipment in accordance with the Laws of Maine, the Building Code of the City of Portland, and the following specifications:

Location / CBL 59-B-13 Use of Building Single Date 11/30/09

Name and address of owner of appliance SETH HARKNESS 25 Summer St. Portland ME 04102

Installer's name and address DETEL SERFES 21 Ridge Terrace Dr. Casco ME 04015 Telephone 207-918-6006

**Location of appliance:**

Basement       Floor  
 Attic             Roof

**Type of Fuel:**

Gas       Oil       Solid

**Appliance Name:** VEIKMANN 100

U.L. Approved  Yes  No

Will appliance be installed in accordance with the manufacture's installation instructions?  Yes  No

IF NO Explain: \_\_\_\_\_

**Type of Chimney:**

Masonry Lined  
Factory built \_\_\_\_\_

Metal  
Factory Built U.L. Listing # \_\_\_\_\_

Direct Vent  
Type \_\_\_\_\_ UL# \_\_\_\_\_

**Type of Fuel Tank**

Oil  
 Gas

Size of Tank NOV 30 2009

Number of Tanks Dept. of Building Inspections  
City of Portland Maine

Distance from Tank to Center of Flame \_\_\_\_\_ feet.

Cost of Work: \$ 2,200

Permit Fee: \$ 50

RECEIVED

**The Type of License of Installer:**

Master Plumber # \_\_\_\_\_  
 Solid Fuel # \_\_\_\_\_  
 Oil # \_\_\_\_\_  
 Gas # PNT 3962  
 Other \_\_\_\_\_

**Approved**

**Approved with Conditions**

Fire: \_\_\_\_\_  
Ele.: \_\_\_\_\_  
Bldg.: \_\_\_\_\_

See attached letter or requirement

Inspector's Signature

Date Approved

Signature of Installer

*[Handwritten Signature]*

White - Inspection    Yellow - File    Pink - Applicant's    Gold - Assessor's Copy

**Side Wall Vent Termination (stainless steel or CPVC)**

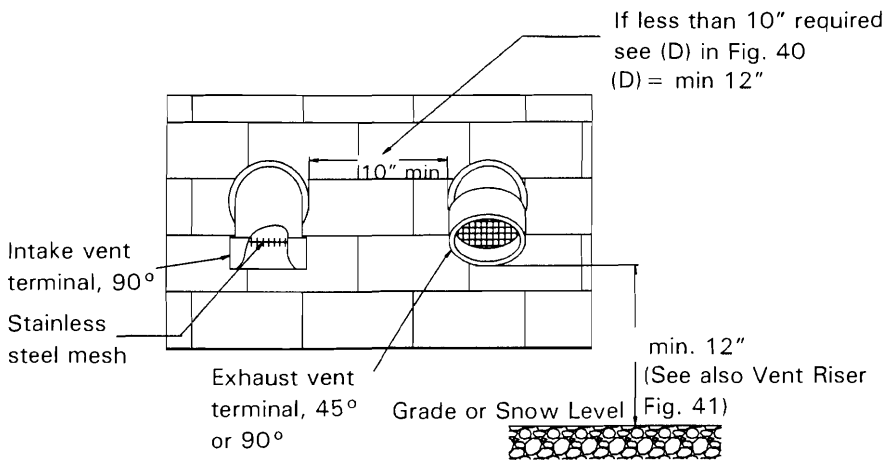

Fig. 39 Side wall vent termination (front view)

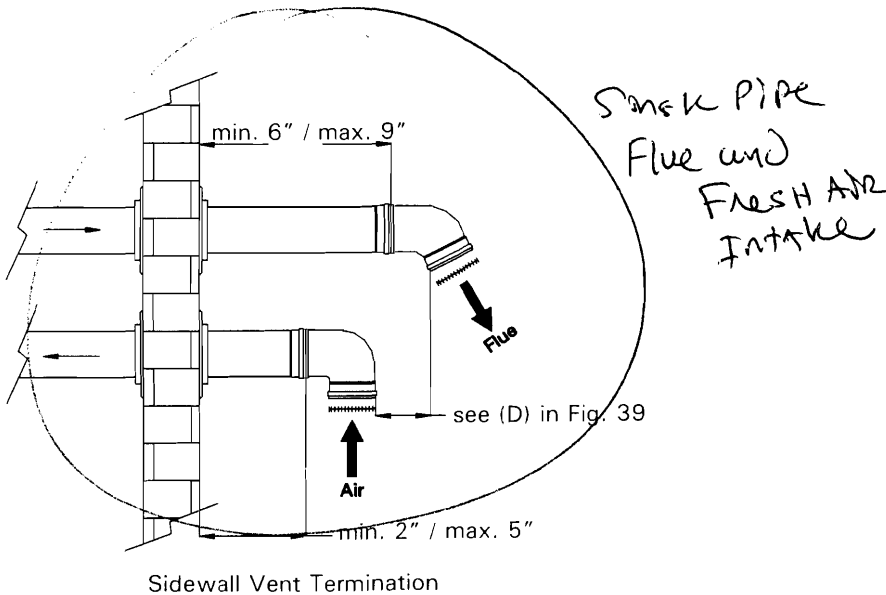

Fig. 40 Side wall vent termination (side view)

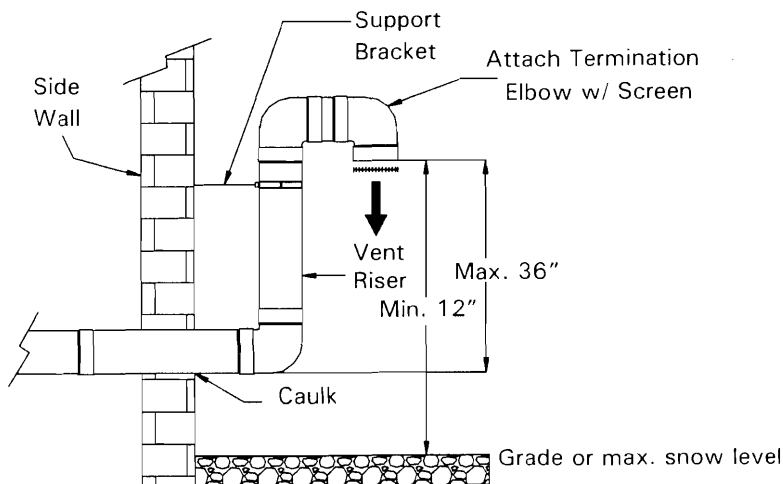

Fig. 41 Installation of field fabricated vent riser

**IMPORTANT**

The exhaust vent/air intake system must terminate so that proper clearances are maintained as cited in local codes or the latest edition of the "Natural Gas and Propane Installation Code" CAN/CSA-B149.1 (Canada), or the "National Fuel Gas Code" ANSI Z223.1 (NFPA 54) (U.S.A.). See pages 19 and 20.

**! WARNING**

Vent termination must be at least 12"/300 mm above the anticipated snow level (consult your local building authorities or local weather office). Locate vent termination in such a way that it cannot be blocked by snow.

# Installation and Service Instructions

for use by heating contractor

# VIESSMANN

Vitodens 100-W  
WB1B Series

Wall-mounted, gas-fired condensing boiler

Heating input      37 to 118 MBH  
                             10.8 to 34.5 kW

Please file in Service Binder

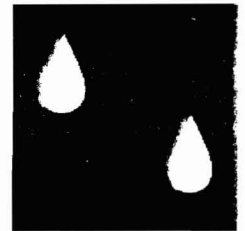

## VITODENS 100-W

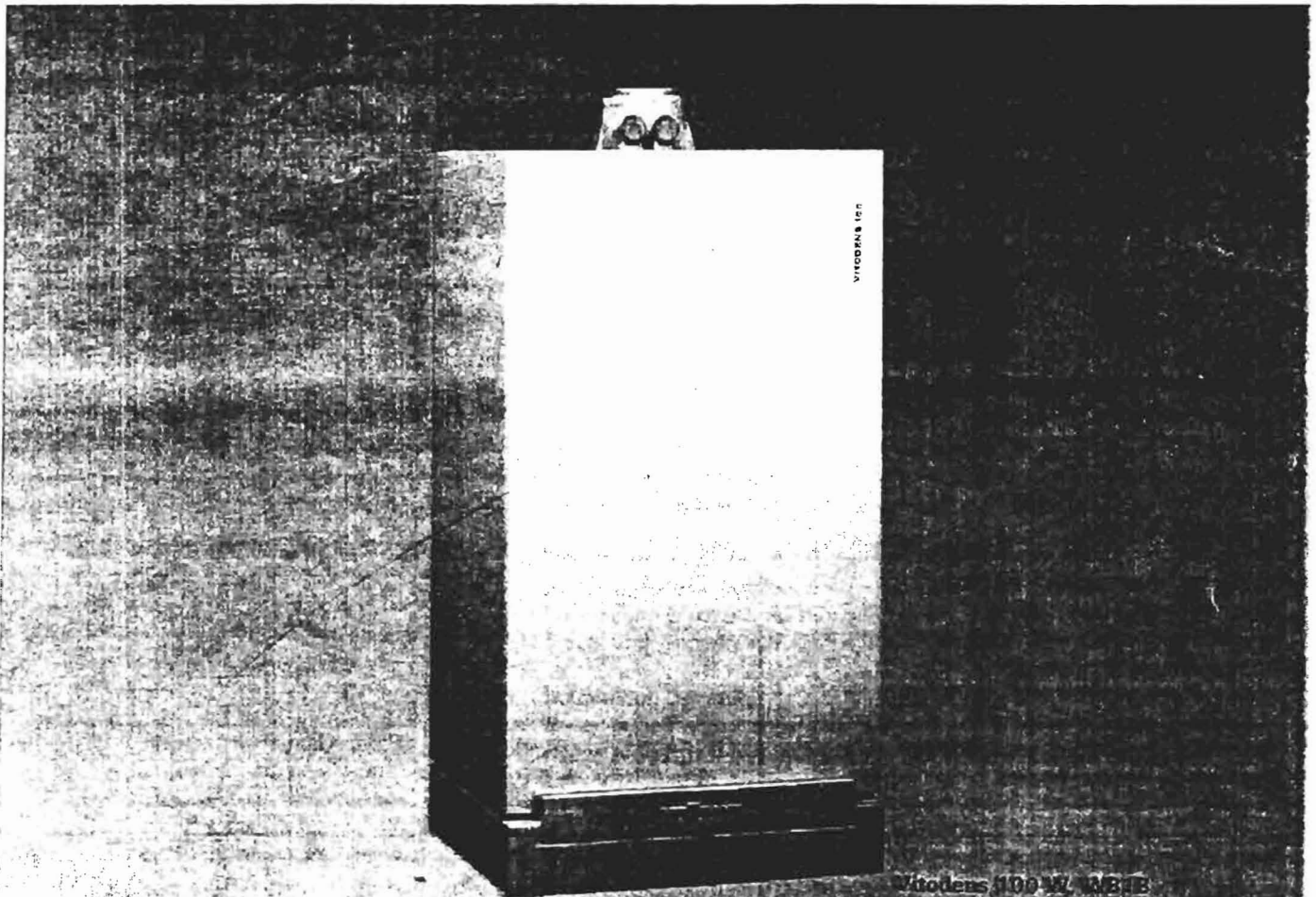

Vitodens 100-W, 1024E  
(with pre-installed optional vent pipe adaptor)



**IMPORTANT**  
Read and save these instructions  
for future reference.

\* This trademark is registered with the U.S. Patent and Trademark Office

## Before Set-up

Before placing boiler in its installation location, ensure all necessary accessories are installed.

### CAUTION

The boiler must be installed in such a way that gas ignition system components are protected from water (spraying, splashing, etc.) during boiler operation and service.

## Minimum Clearances

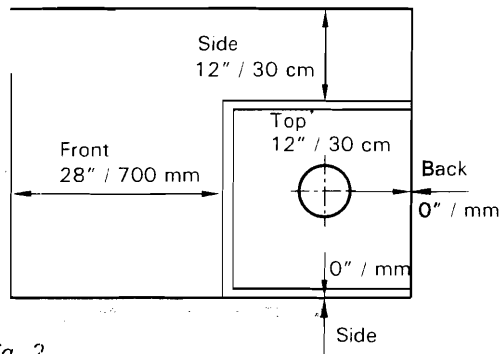

Fig. 2

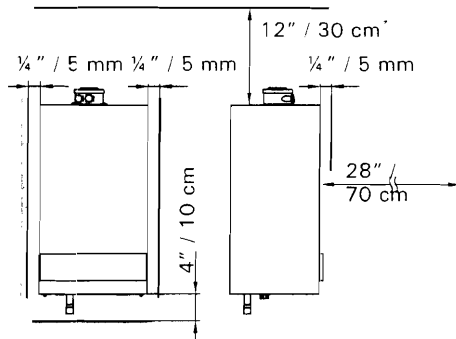

Fig. 3

### Recommended minimum service clearances

Refer to Fig. 2 and 3.

#### Note:

The Vitodens 100-W boiler has passed the zero inches vent clearance to combustibles testing requirements dictated by the boiler Harmonized Standard ANSI Z21.13, CSA 4.9.2007 and therefore is listed for zero clearance to combustibles when vented with a single-wall special venting system (AL-29-4C material) or UL/ULC-listed CPVC gas vent material. The zero inches vent clearance to combustibles for the Vitodens 100-W boiler supercedes the clearance to combustibles listing that appears on the special venting system label.

Top clearance - 12" / 30 cm.



See the *Vitodens Venting System Installation Instructions*.

### Clearance to combustibles

Top	Front	Rear	Left	Right	Vent pipe*
0	0 AL, CL	0	0	0	

AL = Alcove

CL = Closet

\*1 Refer to the *Installation Instructions of the Vitodens Venting System* for details.