

FOR MORTGAGE LENDER USE ONLY

(1) DISTANCES SHOWN ARE TAKEN FROM PROVIDED TITLE REFERENCES SHOWN BELOW. (2) THE PURPOSE OF THIS TO RENDER AN OPINION AS FOLLOWS: A) DWELLING AND ACCESSORY STRUCTURE'S COMPLIANCE WITH RESPECT TO SETBACKS, AND B) FLOOD ZONE DETERMINATION BY HORIZONTAL SCALING ON BELOW REFERENCED FEMA MAP. THIS INSPECTION DOES NOT EXCEPTS OUT ALL TECHNICAL STANDARDS CURRENTLY SET FORTH BY STATE OF MAINE BOARD OF LICENSURE OF PROFESSIONAL LAND SURVEYORS. (4) THIS INSPECTION IS TO BE USED ONLY BY THE BELOW LISTED LENDER, TITLE ATTORNEY AND SHOULD NOT BE USED BY ANOTHER PARTY FOR BOUNDARY LINE LOCATIONS OR LAND TITLE OPINIONS. A BOUNDARY SURVEY SHOULD BE PERFORMED TO RENDER A PROFESSIONAL OPINION PERTAINING TO BOUNDARY LINE LOCATIONS, EASEMENTS, RIGHTS OF WAY, ENCUMBRANCES, AND/OR ENCROACHMENTS.

ADDRESS: 198 DANFORTH STREET
PORTLAND, MAINE

INSPECTION DATE: MAY 29, 2001
SCALE: 1" = 30'

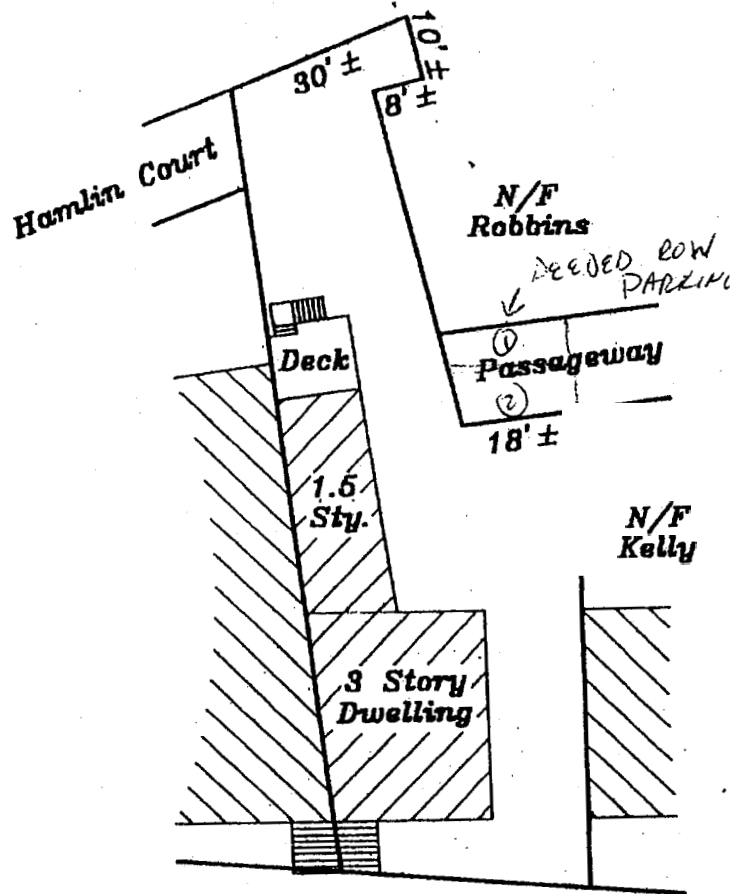

DANFORTH STREET
To Brackett

*Requires 1 pkg space for owner's dwelling unit
+ 1 pkg space for the 2 B+B guest room*

Geometric shape shown per assessor's map.

SEE PROVIDED TITLE REFERENCES FOR APPLICABLE APPURTENANCES, IF ANY.

APPLICANT: LEIF LAUDAMUS REQUESTING PARTY: NEW ENGLAND TITLE
OWNER: SUSANNE & DALE E. SINCLAIR ATTORNEY: _____
LENDER: FIRST FINANCIAL MORTGAGE CORP. FILE No. 2019967 FIELD BOOK: 205

TITLE REFERENCES:
DEED BOOK: 15233 PAC! 149
PLAN BOOK: _____ PAGE: _____ DT: _____
COUNTY: CUMBERLAND LOT: _____

MUNICIPAL REFERENCE:

YOUR FILE #: NO1-678

NADEAU & LODGE, INC.
PROFESSIONAL LAND SURVEYORS

544 STEVENS AVENUE
PORTLAND, ME 04103
(207) 878-7870

232 CLARES WOODS ROAD
LYMAN, ME 04002
(207) 499-2358

SKETCH ADDENDUM

Borrower or Owner **Laudamus/Aptowitz**
 Property Address **198 Danforth Street**
 City **Portland** County **Cumberland** State **ME** Zip Code **04102**
 Lender or Client **First Financial Mortgage**

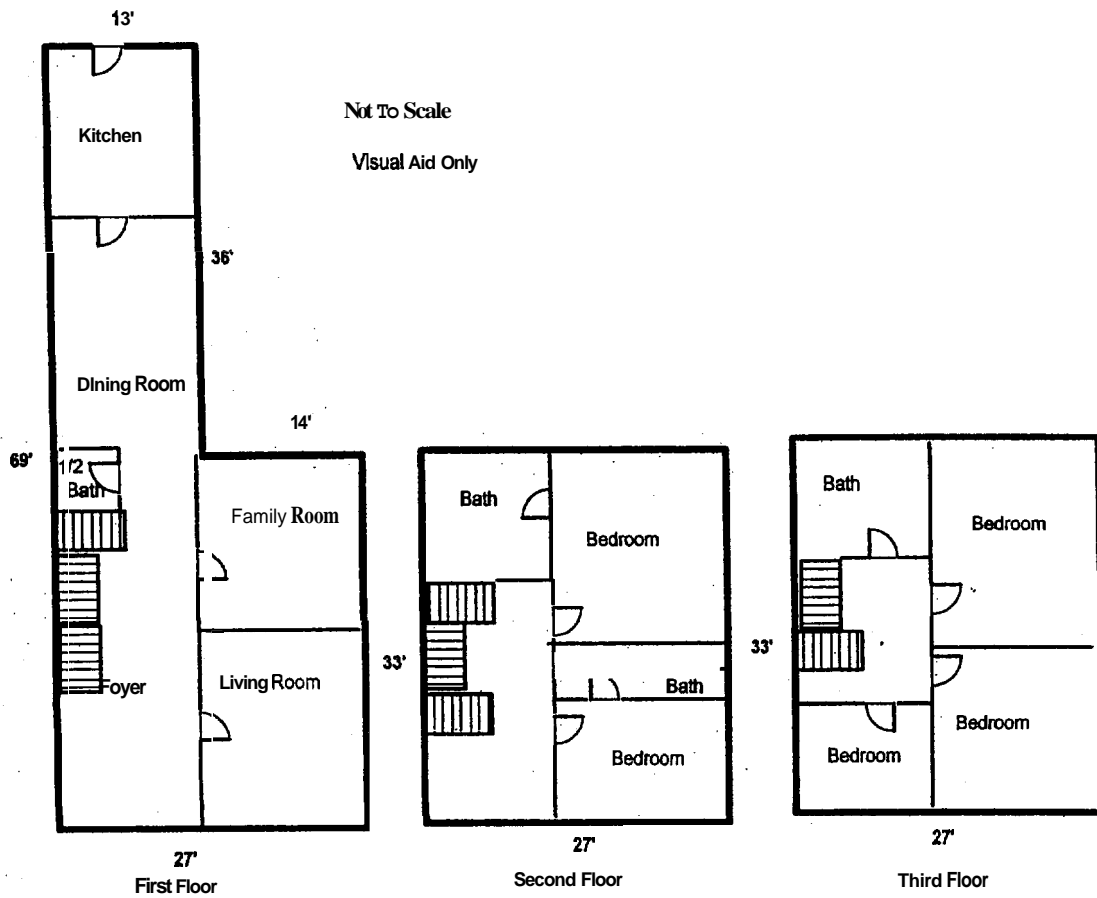

SUMMARY SQ FT AREA PERIMETER AREA CALCULATION DETAILS

Living Area		SQ FT AREA	PERIMETER	AREA CALCULATION DETAILS	
First Floor		1369	192	13.0 X 89.0 =	897.0
Second Floor		891	120	14.0 X 33.0 =	482.0
Third Floor		891	120	Total	1359.0
Total		3141	432	Second Floor	
				27.0 X 33.0 =	891.0
				Third Floor	
				27.0 X 33.0 =	891.0