

CITY OF PORTLAND

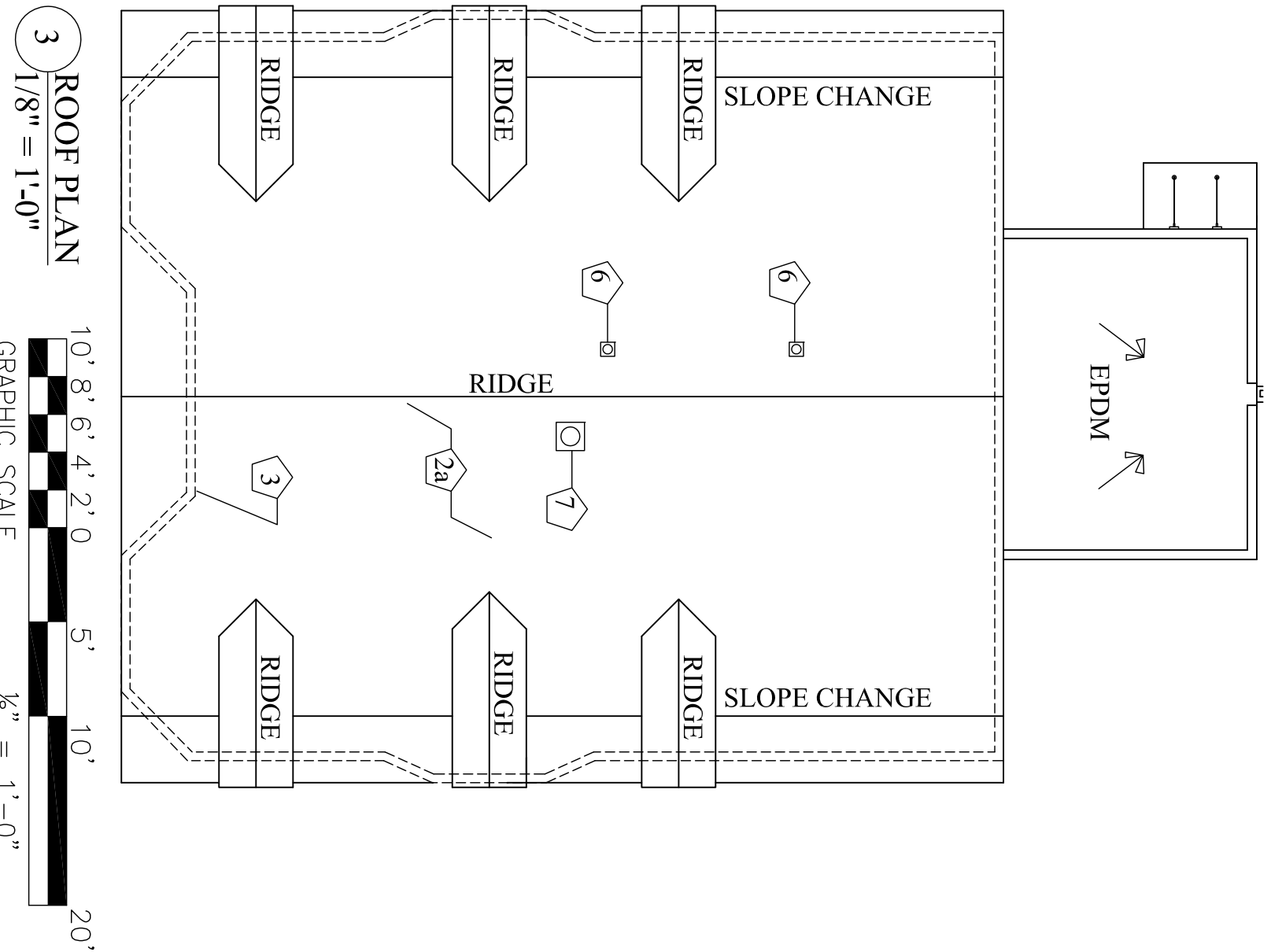

- LEGEND**
- EXISTING WALL / ITEM
 - WALL
 - 5/8" G.B. - PTD.
 - DOOR KEY
 - FLOORING UNDERLAYMENT NOTE
 - 1. INSTALL WOOD UNDERLAYMENT UNDER ALL FINISH FLOORING SEE SECTIONS 09650 & 09680.
 - CLOSET NOTE
 - 1. CLOSETS ARE 2'-0" DEEP UNLESS NOTED OTHERWISE.
 - KEYED NOTES
 - 1 CASSED OPENING.
 - 2 CANOPY.
 - 2a EXISTING ASPHALT ROOFING SHINGLES.
 - 3 DASHED LINES ON ROOFING PLAN INDICATE WALLS BELOW.
 - 4 INTERCOM STATION, COORDINATE LOCATION WITH ARCHITECT & OWNER.
 - 5 ATTIC ACCESS PANEL.
 - 6 THIRD FLOOR BATHROOM FAN EXHAUST.
 - 7 ATTIC VENTILATION FAN.
 - 8 FLOORING TRANSITION LINE - CARPET AT LIVING ROOM SIDE, SHEET VINYL AT CORRIDOR SIDE.
 - 9 ZIG ZAG LINE INDICATES AREA WHERE WOOD PANELING WALL FINISH WAS REMOVED. INSTALL 5/8" G.B. IN THESE AREAS. THESE AREAS ARE LIMITED TO THE THIRD FLOOR WEST UNIT.
 - 10 WALL INFILL AT LOCATIONS OF DEMOLISHED DOORS & WINDOWS - MATCH EXISTING CONSTRUCTION AND FINISHES.

