

# EXISTING WALL TYPES

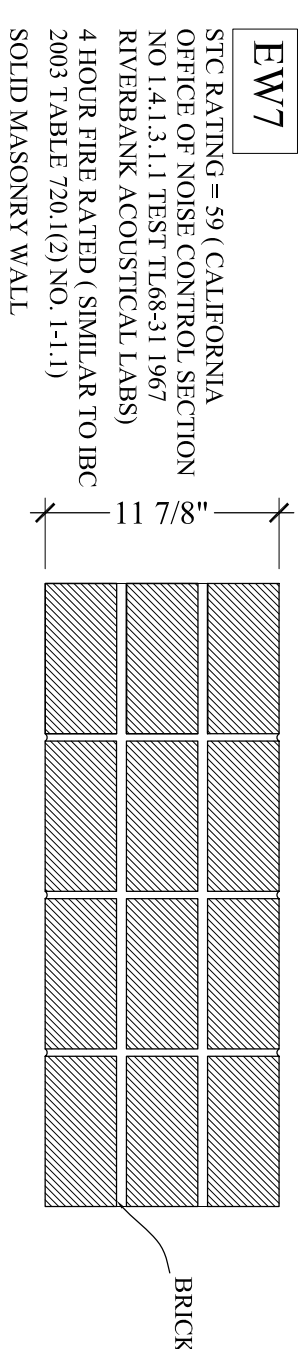

# EXISTING TYPICAL FLOOR/CEILING ASSEMBLY

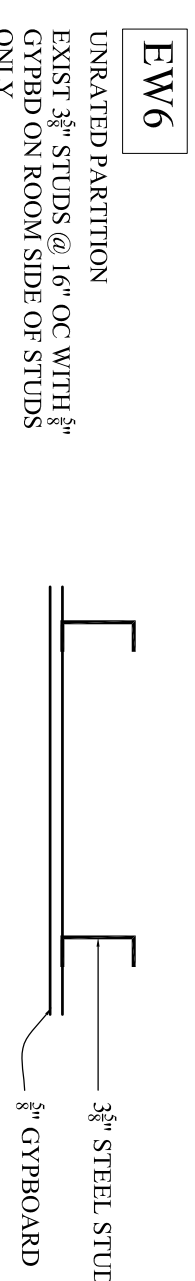
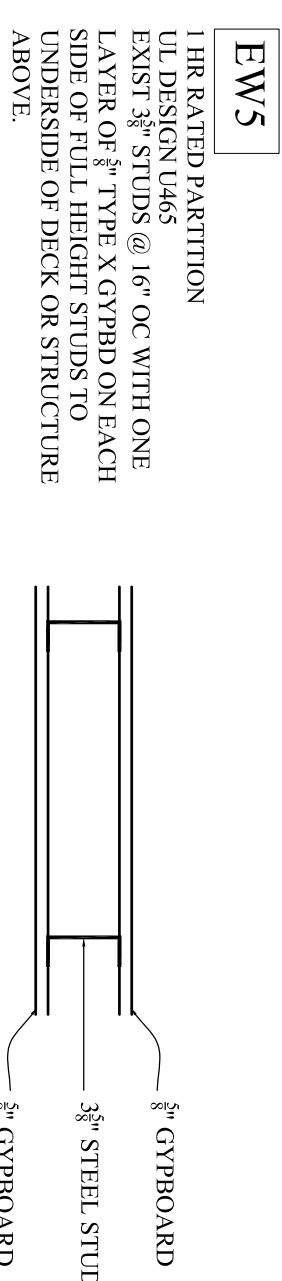
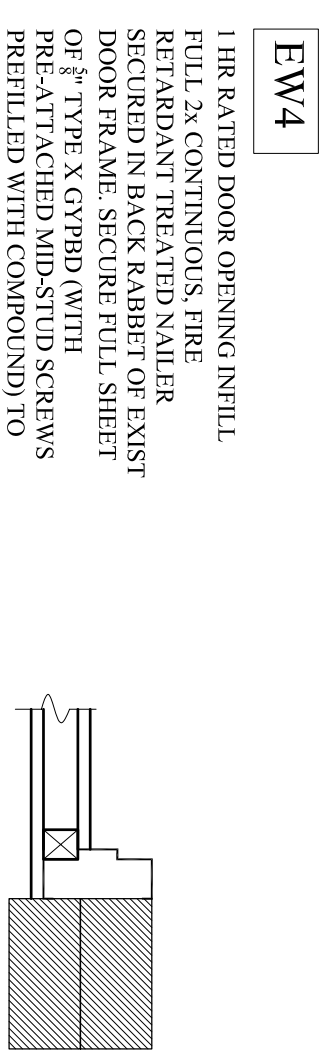
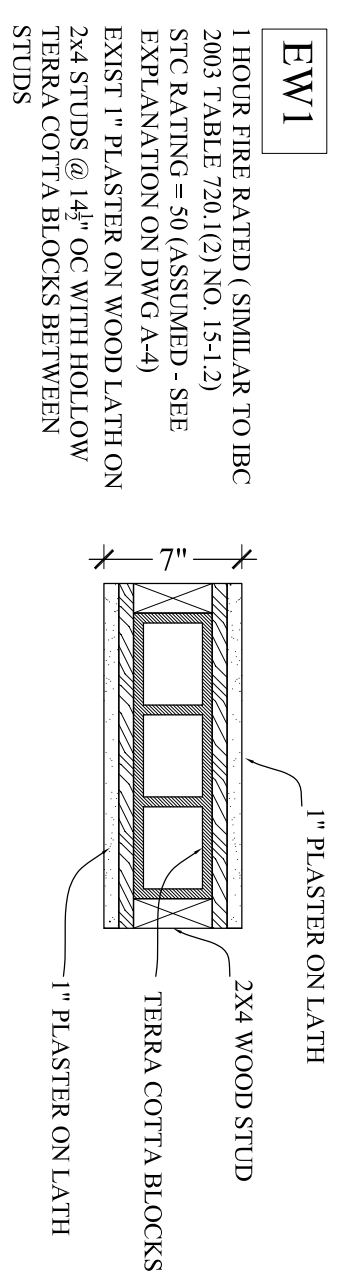
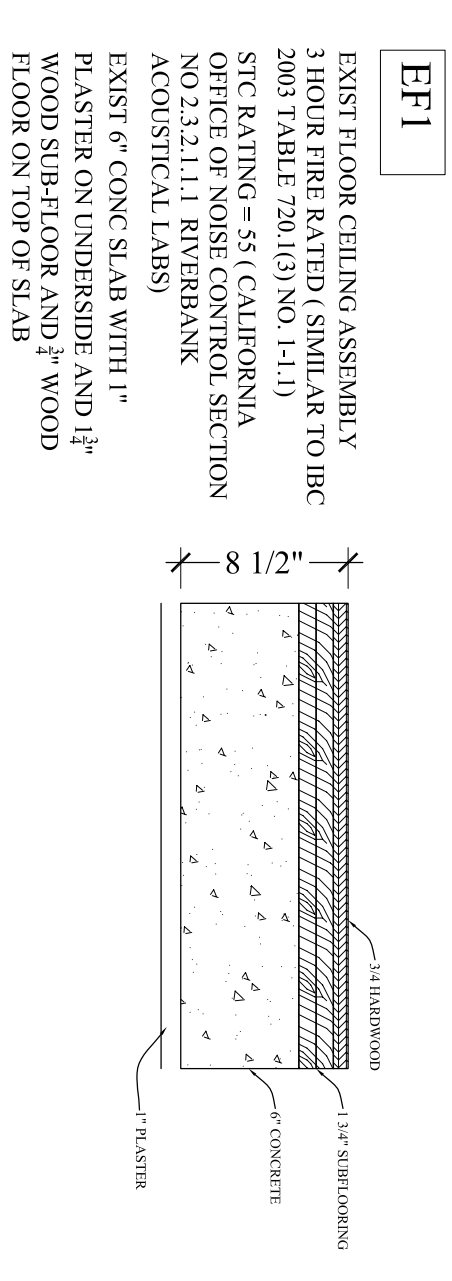

# NEW WALL TYPES

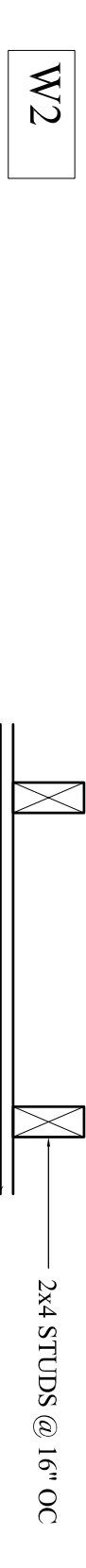
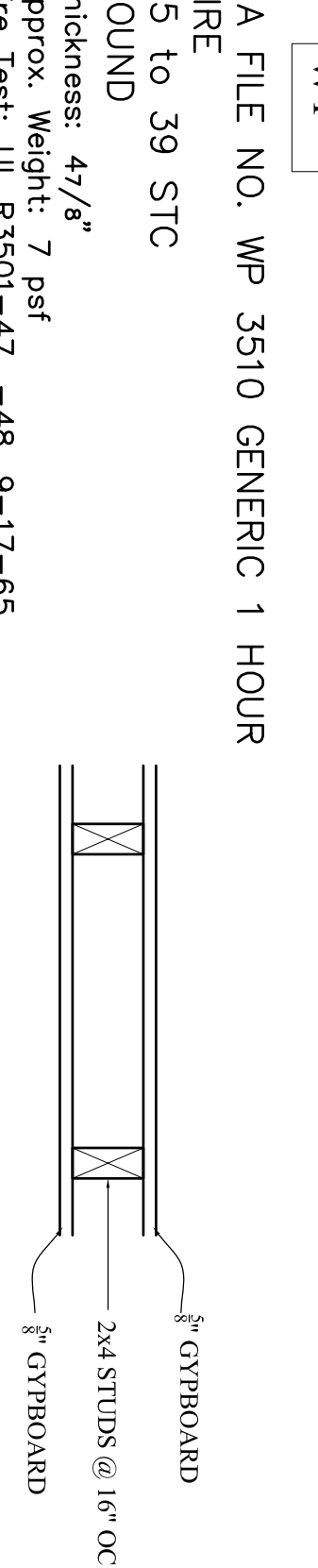

DOOR	LOCATION	SIZE			DOOR		THRESH	FRAME	LABEL	REMARKS
		Width	Height	Thick	Type	Material				
E1	Existing door	3'-0"	7'-0"						1 Hr	
E2	Existing door								45 Min	
E3	Existing door								20 Min	
E4	Existing door								Unrated	
1	Store rooms	3'-0"	6'-8"	1 3/4"	A	Wood	Wood	20 Min		
2	Unit interior	3'-0"	6'-8"	1 3/8"	B	Wood	Wood			
3	Stair to corridor	3'-0"	6'-8"	1 3/4"	A	Wood	Metal	1 Hr		

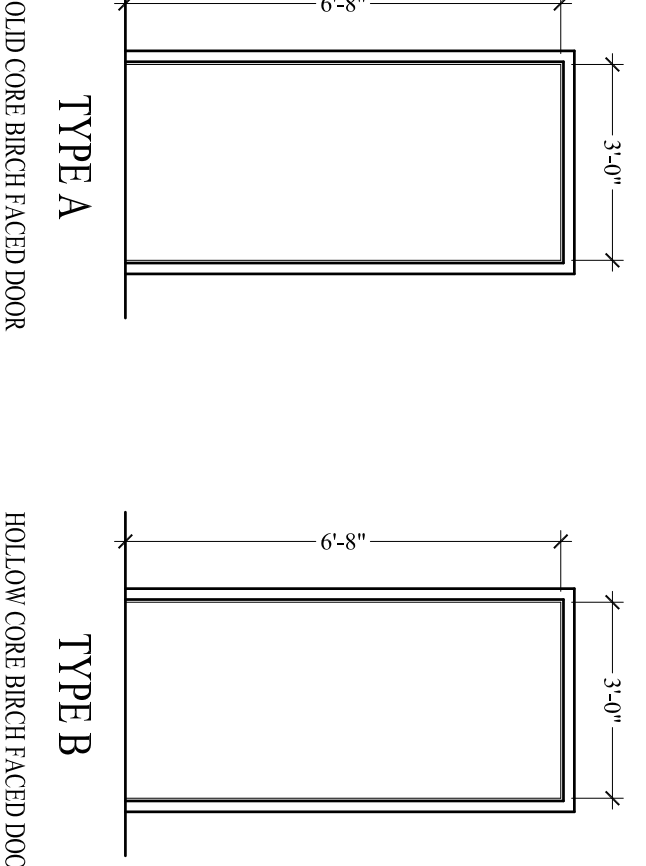

# TESTED GYPSUM ASSOCIATION WALL ASSEMBLY - 45-49 STC

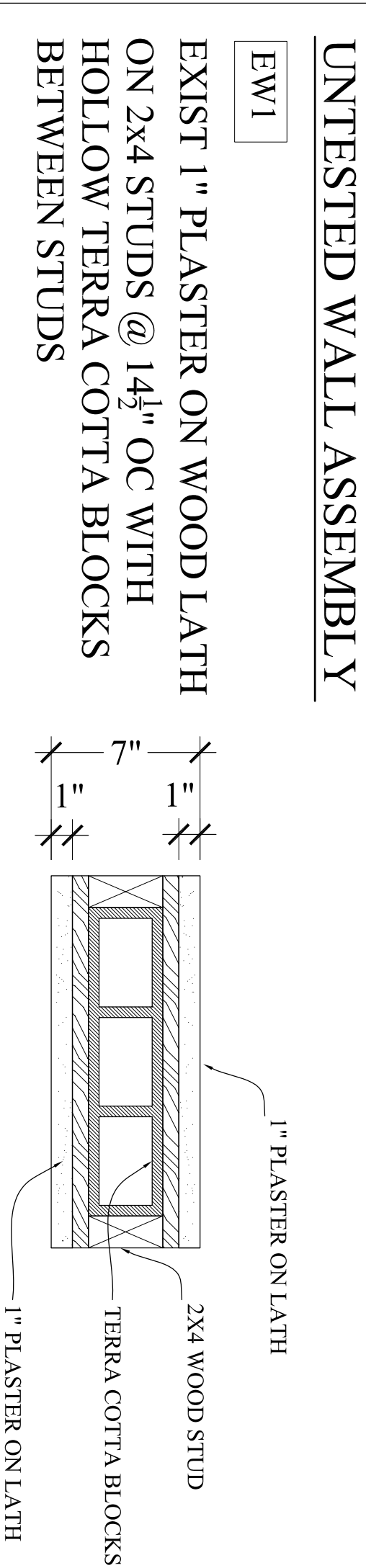
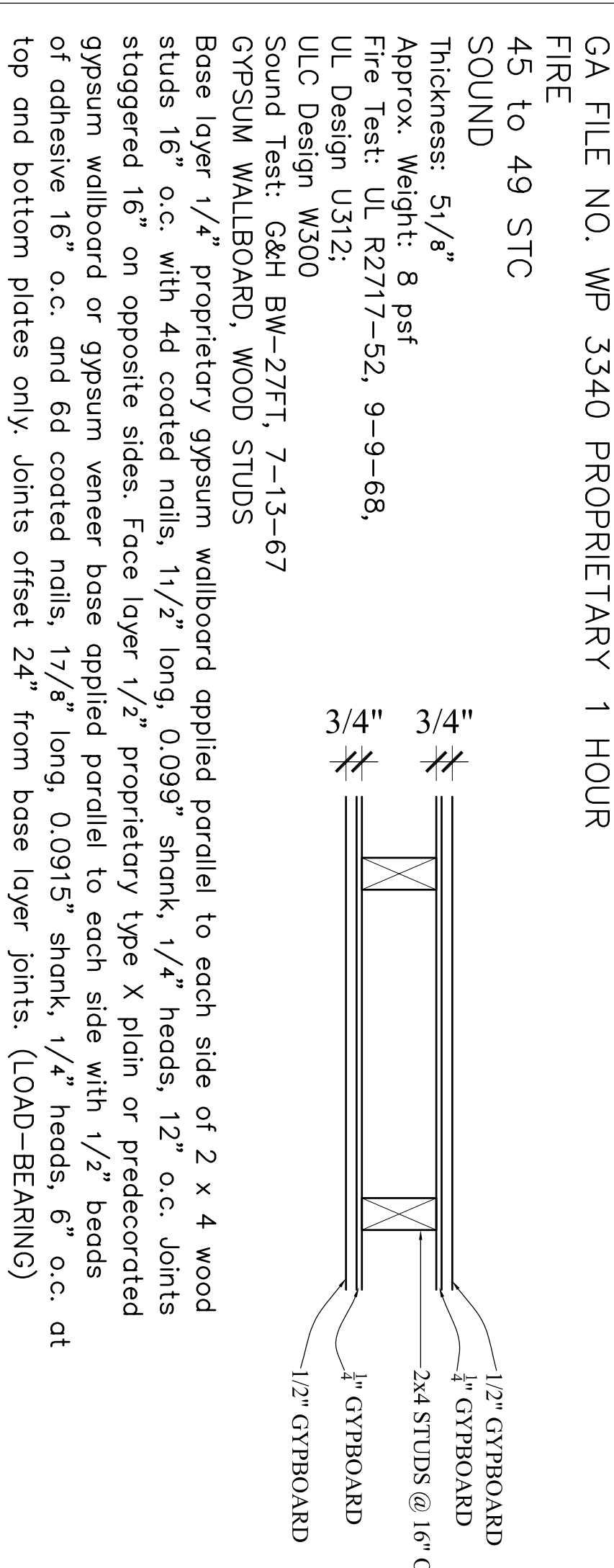

IT IS OUR ASSUMPTION THAT THE UNTESTED ASSEMBLY HAS A GREATER STC RATING THAN THE TESTED ASSEMBLY IN THAT THE PLASTER IS 33% THICKER THAN THE GYPSUMBOARD AND THAT THE HOLLOW STUD WALL OF THE TESTED ASSEMBLY NOW HAS TERRA COTTA BLOCKS ADDED. THE TESTED ASSEMBLY HAS A STC RATING OF JUST UNDER 50. WITH THE THICKER PLASTER AND THE TERRA COTTA BLOCKS ADDED WE ASSUME THAT THE STC RATING WILL EXCEED 50.