

Renovations - see site and plans for details
- address to be written in to window south

CONTENTS -

1. COVER
2. WORK INCLUDED
3. DEED
4. PLOT PLAN
5. FIRST FLOOR PLAN
6. SECOND FLOOR PLAN
7. THIRD FLOOR PLAN
8. ELEVATIONS
9. " "
10. " "
11. " "
12. WINDOW SCHEDULE
13. DETAILS - PORCH
14. SHED PLANS + DETAILS

RENOVATIONS
220 SPRING STREET
PORTLAND, MAINE

TERRY YALE, OWNER
SUBMITTED BY ED OECHELSLIE
JUNE 2002

WORK INCLUDED -

- 1) SELECTED WINDOW REPLACEMENT
- 2) REPLACE WORN/DAMAGED SIDING
- 3) ELECTRICAL UPGRADES
- 4) SMOKE DETECTOR SYSTEM
- 5) REPLACE PORCH ROOF
- 6) INSTALL PORCH STRUCTURAL SUPPORT
- 7) INSTALL LOLLY COLUMN IN BASEMENT
- 8) INSTALL BUILDING INSULATION
- 9) INSTALL GAS HEATERS
- 10) RENOVATE SHED
 - A) REPLACE SILL STRUCTURE
 - B) REPLACE WINDOWS
 - C) REPLACE WORN/DAMAGED SIDING
 - D) INSULATE
 - E) INTERIOR FINISHES
 - F) LIGHTING
 - G) WASHER/DRYER HOOKUPS
- 11) REPAIR, LINE CHIMNEY



RENOVATIONS
220 SPRING STREET
PORTLAND, MAINE

STATUTORY WARRANTY DEED

WE, SARAH C. WEBBER and JENNIFER WEBBER, with a mailing address of 220 Spring Street, Portland, Maine 04102,

For Consideration Paid, GRANT with WARRANTY COVENANTS TO:

TERRY YALE, with a mailing address of 33 Sunshine Farm Road, Litchfield, Maine, 04350,

A certain lot or parcel of land with the buildings thereon, situated on the southeasterly side of Spring Street in the City of Portland, County of Cumberland and State of Maine, and bounded and described as follows:

Beginning on the westerly corner of land now or formerly of Joseph Johnson; thence running westerly on said Spring Street thirty-five (35) feet; and from these two points extending back from said street seventy-five (75) feet to land now or formerly of the heirs of Nicholas Emery, holding the width of thirty-five (35) feet from the line of said Johnson's land.

Being the same premises conveyed to Grantors herein by deed of Sarah C. Webber dated July 20, 2001, and recorded at the Cumberland County Registry of Deeds in Book 16562, Page 223.

WITNESS our hands this 6th day of May, 2002.

Terry Yale

Sarah C. Webber
Sarah C. Webber

Jennifer Webber

Jennifer Webber
Jennifer Webber

STATE OF MAINE
CUMBERLAND, SS.

Date: May 6, 2002

Then personally appeared the above-named SARAH C. WEBBER and JENNIFER WEBBER and acknowledged the foregoing instrument to be their free act and deed.

Before me,

Terry N. Snow
Attorney at Law/Notary Public
TERRY N. SNOW

SITE PLAN

1" = 20'

220 Spring Street (bituminous)

Apparent R/W

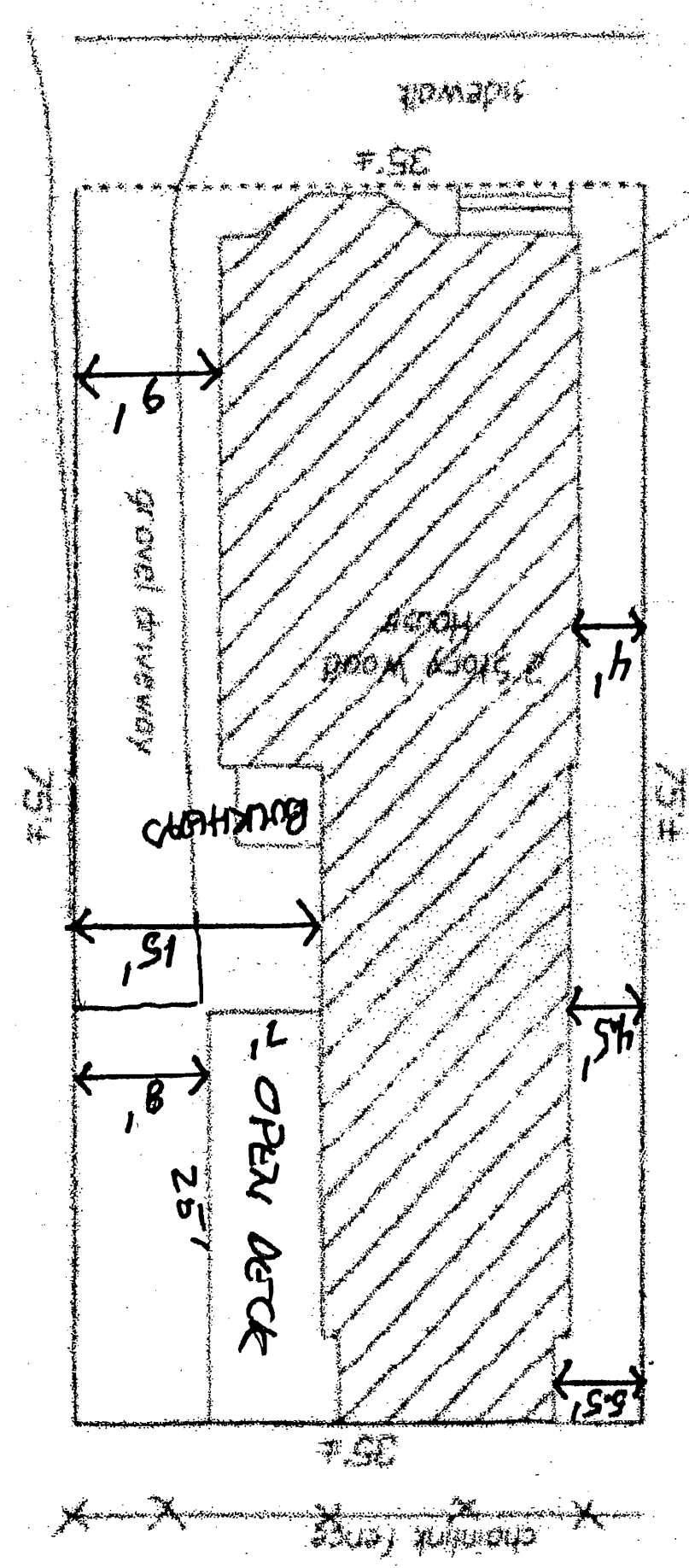

to Mon.

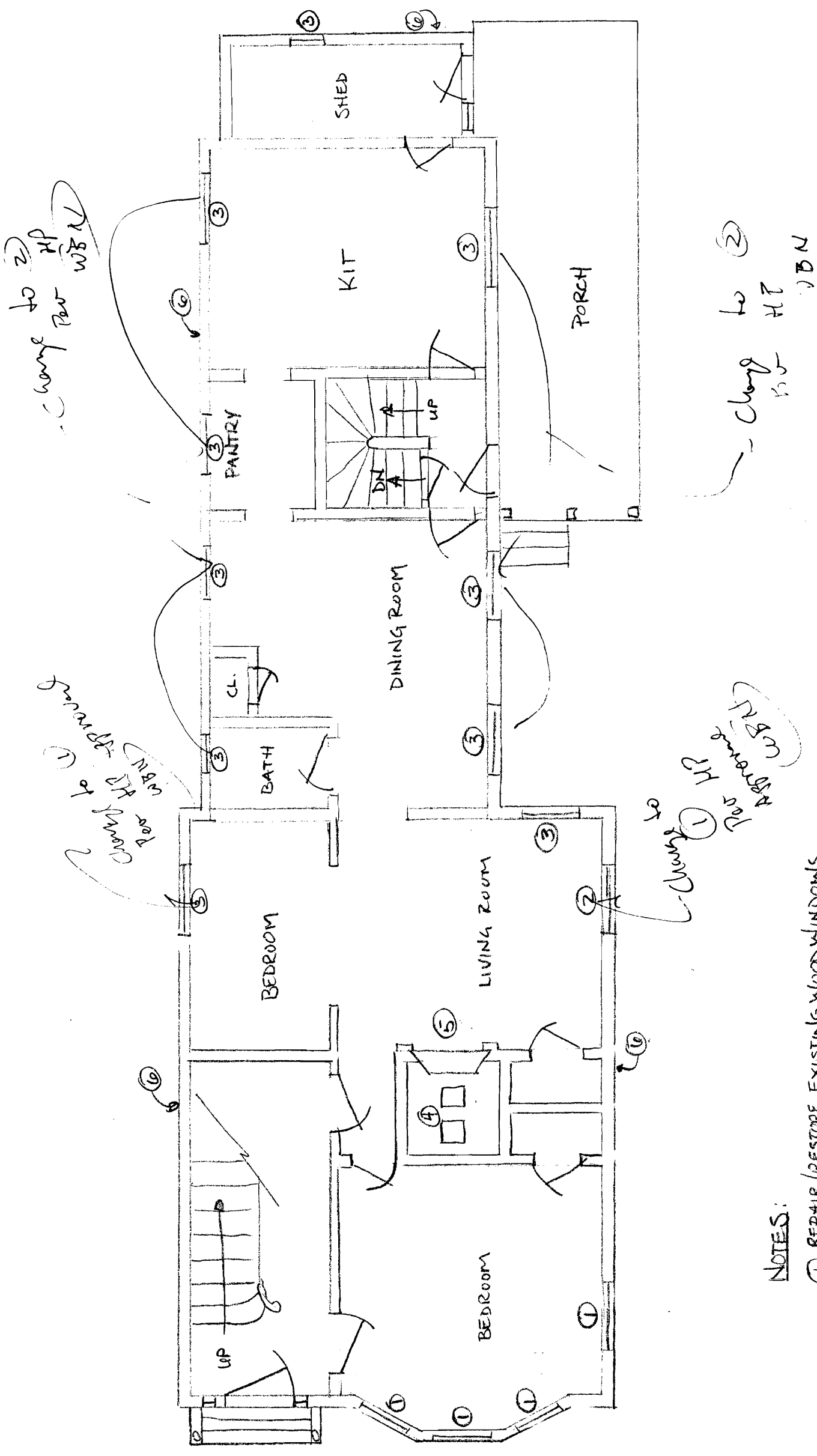

NOTES:

- ① REPAIR/RESTORE EXISTING WOOD WINDOWS
- ② NEW WOOD REPLACEMENT WINDOWS
- ③ NEW VINYL REPLACEMENT WINDOWS
- ④ LINE FLUES AND REPAIR CHIMNEY
- ⑤ INSTALL NEW GAS HEATER
- ⑥ INSULATE EXTERIOR WALLS (TYP)
- ⑦ NEW ELECTRICAL OUTLETS

FIRST FLOOR PLAN

RENOVATIONS
 220 SPRING STREET
 PORTLAND, MAINE

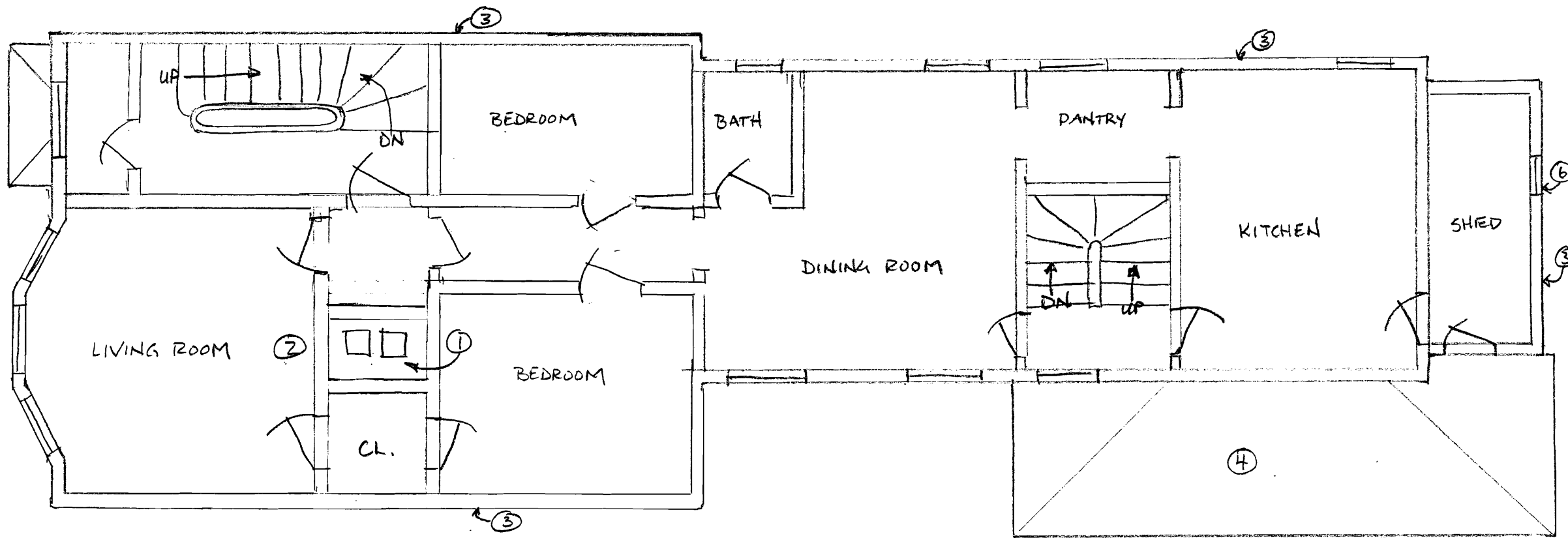

NOTES:

- ① LINE FLUES/REPAIR CHIMNEY
- ② INSTALL NEW GAS HEATER
- ③ INSULATE EXTERIOR WALLS (TYP)
- ④ REPLACE ROOF ON PORCH
- ⑤ NEW ELECTRICAL OUTLETS
- ⑥ NEW VINYL REPLACEMENT WINDOW

SECOND FLOOR PLAN

RENOVATIONS
220 SPRING STREET
PORTLAND, MAINE

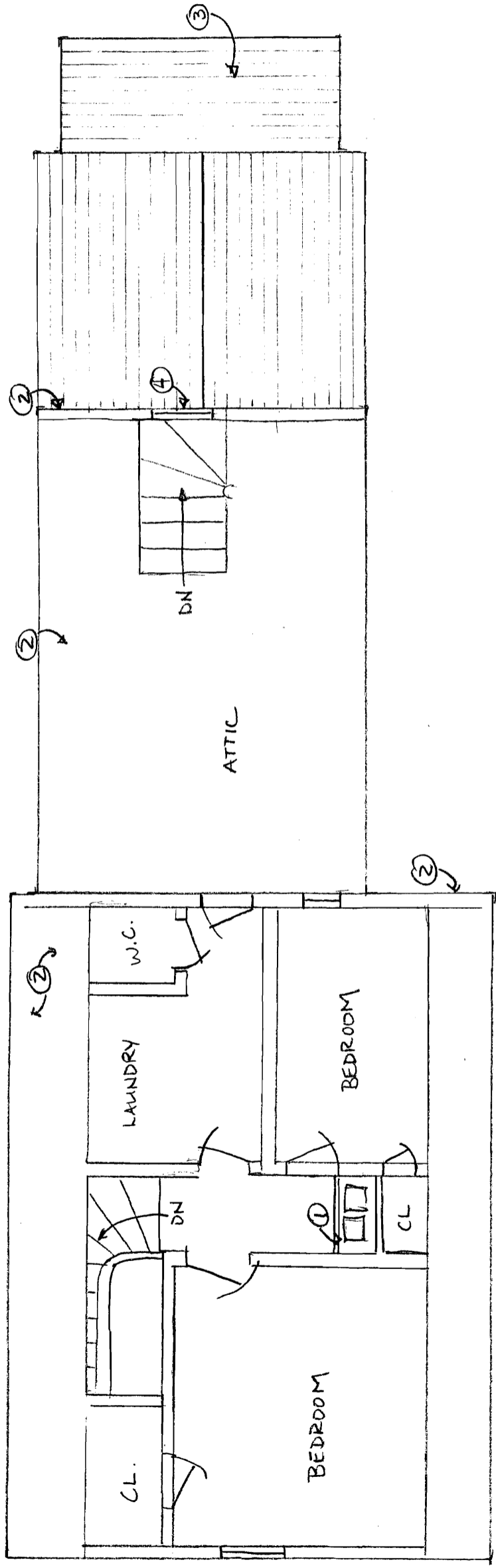

NOTES

- ① LINE FLUES AND REPAIR CHIMNEY
- ② INSULATE EXTERIOR WALLS (TYP)
INCLUDES ROOF AT ATTIC/3RD FLOOR
- ③ NEW ROOF AT SHED
- ④ NEW VINYL REPLACEMENT WINDOW

THIRD FLOOR PLAN

RENOVATIONS
220 SPRING STREET
PORTLAND, MAINE

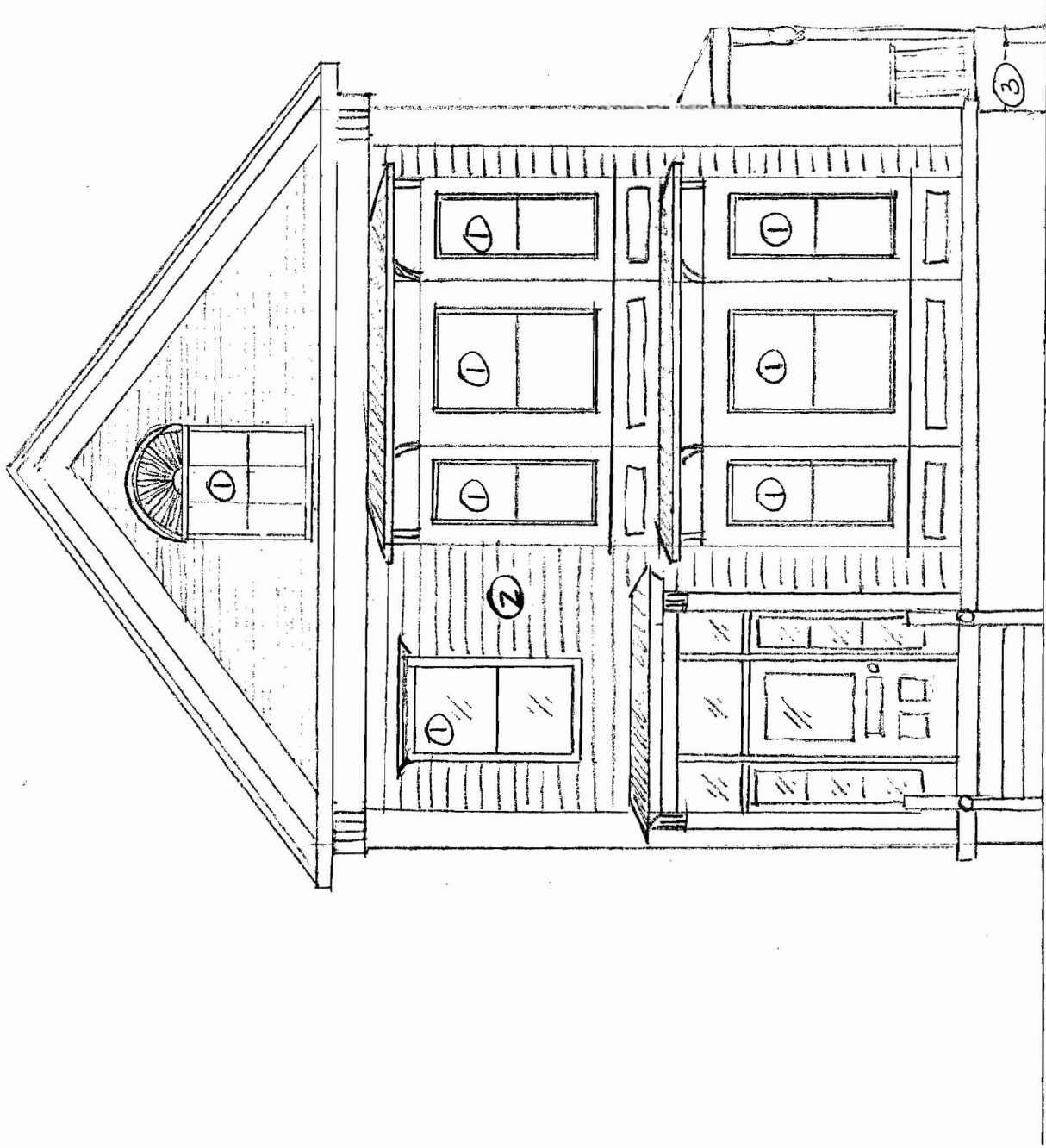

NOTES:

- ① REMOVE STORM WINDOWS, REPLACE WEATHERSTRIP, RE-CAULK AND REINSTALL. REGLAZE PRIME WINDOWS AND REPAIR AS NEEDED.
- ② INSULATE EXTERIOR WALLS (TIP.)
- ③ REPOINT BRICK FOUNDATION AT WEST CORNER

NORTHWEST ELEVATION

RENOVATIONS
220 SPRING STREET
PORTLAND, MAINE

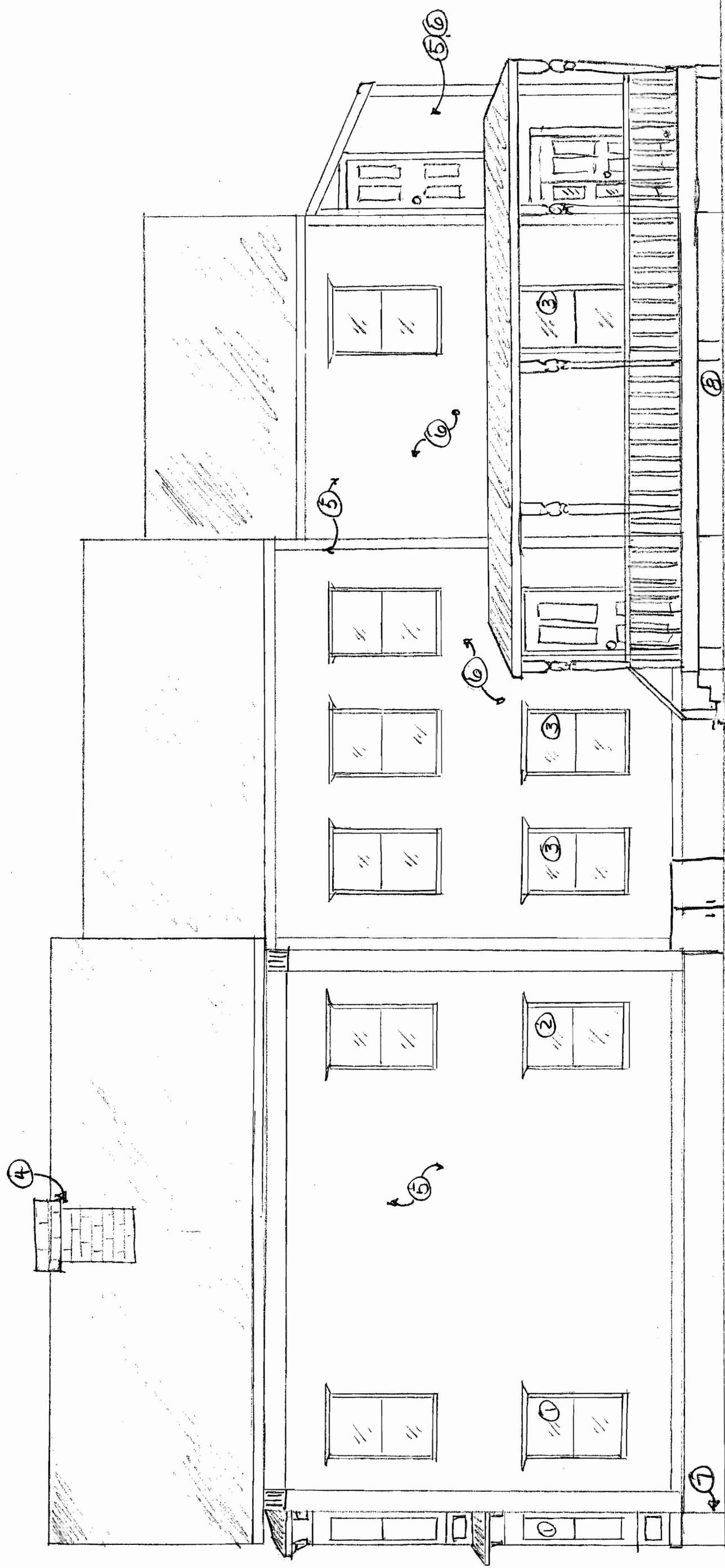

WBN

SOUTHWEST ELEVATION

- NOTES: See 5/14 for KP window conditions
- ① REPAIR/RESTORE EXISTING WOOD WINDOWS
 - ② NEW WOOD REPLACEMENT WINDOWS
 - ③ NEW VINYL REPLACEMENT WINDOWS
 - ④ LINE FLUES + REPAIR CHIMNEY
 - ⑤ INSULATE EXTERIOR WALLS (TYP)
 - ⑥ REPLACE DAMAGED/WORN CEDAR SIDING
 - ⑦ REPAIR FOUNDATION
 - ⑧ INSTALL PORCH SUPPORT

RENOVATIONS
220 SPRING STREET
PORTLAND, MAINE

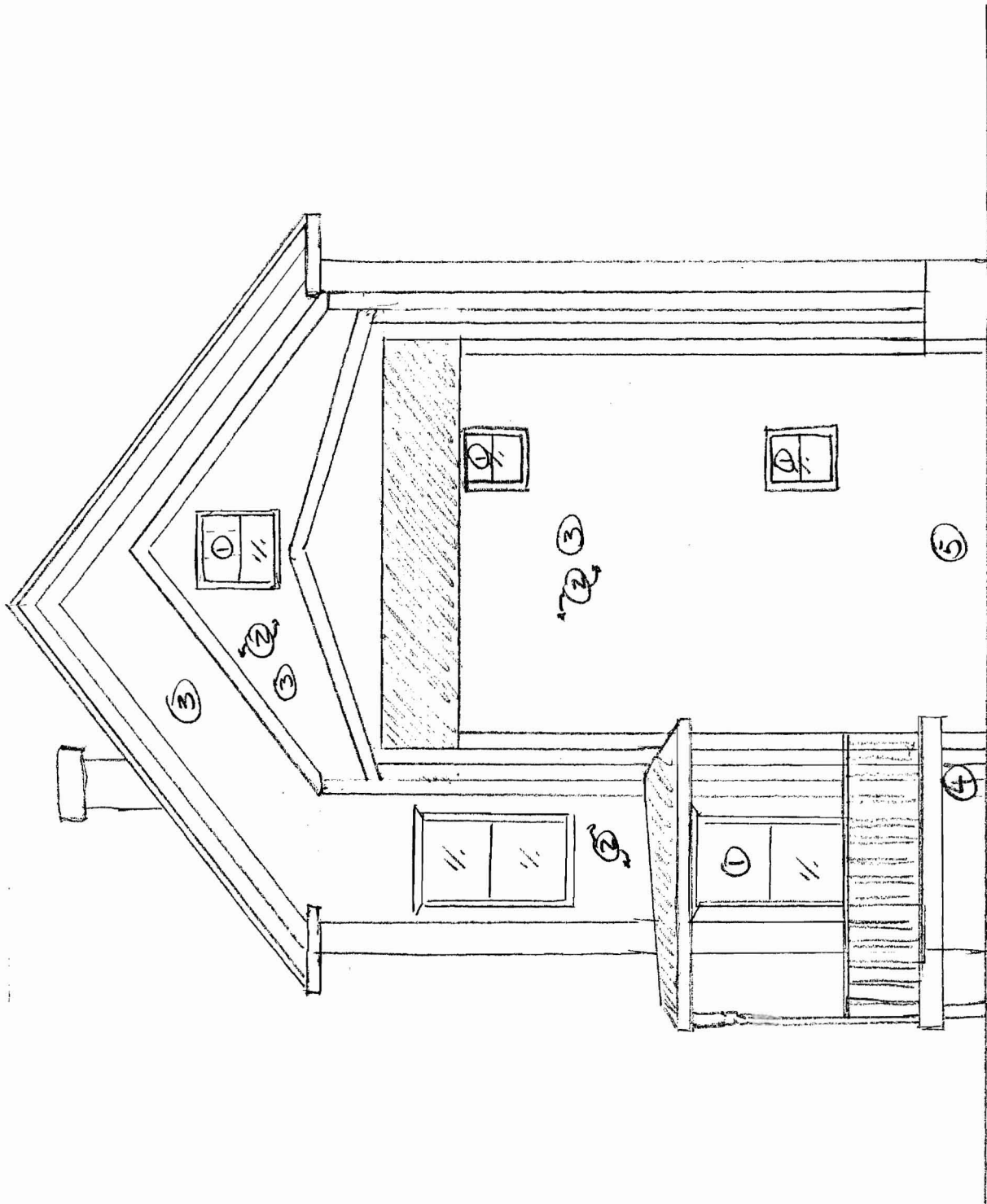

NOTES:

- ① NEW VINYL REPLACEMENT WINDOWS
- ② REPLACE DAMAGED/WORN CEDAR SIDING
- ③ INSULATE EXTERIOR WALLS (TYP)
- ④ INSTALL PORCH SUPPORT
- ⑤ REPLACE SILLS AND SUPPORTS AT SHED

SOUTHEAST ELEVATION

RENOVATIONS
220 SPRING STREET
PORTLAND, MAINE

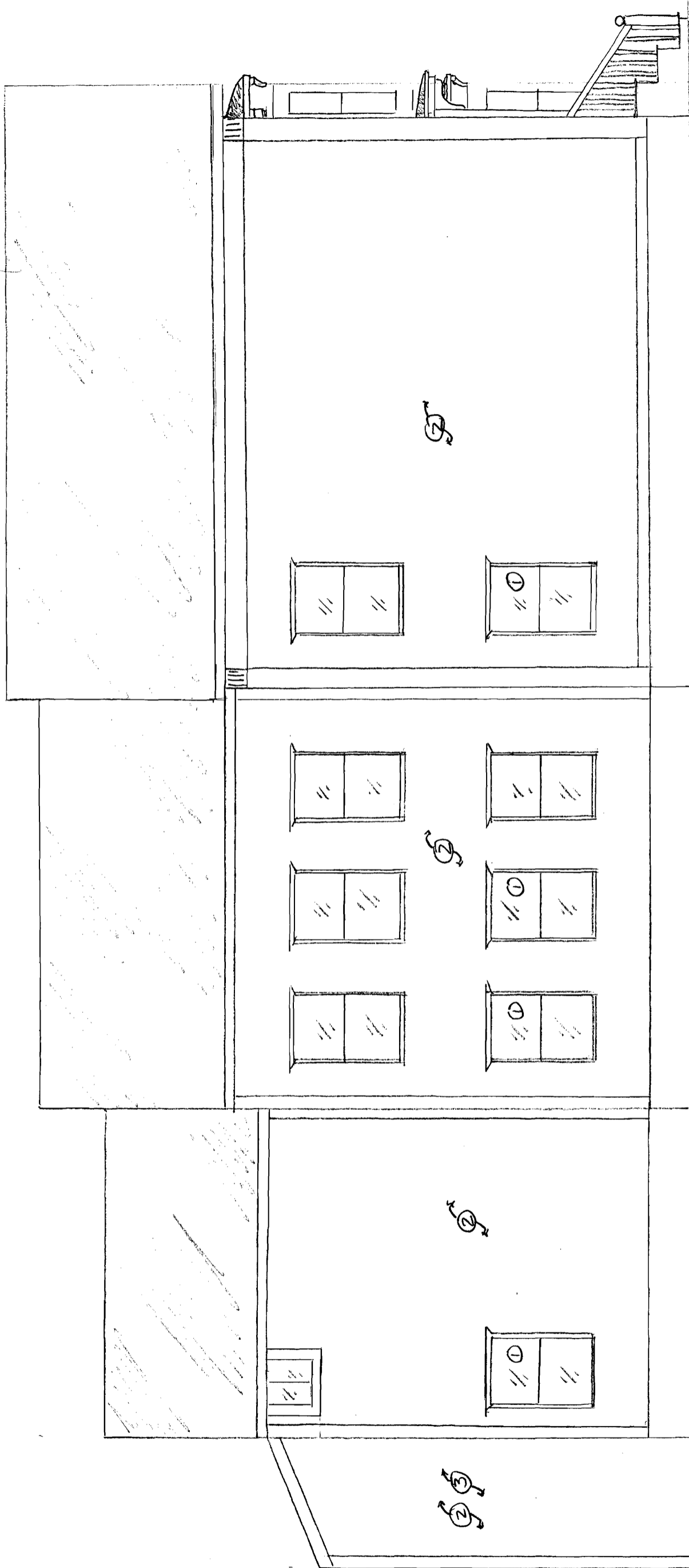

NOTES: See 5 of 14 for HP window conditions (WBN)
 ① NEW VINYL REPLACEMENT WINDOWS
 ② INSULATE EXTERIOR WALLS (TYP)
 ③ REPLACE DAMAGED/WORN CEDAR SIDING

NORTHEAST ELEVATION
 RENOVATIONS
 220 SPRING STREET
 PORTLAND, MAINE

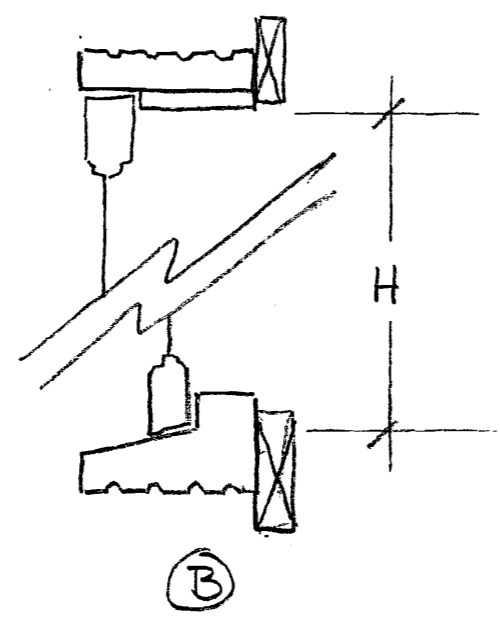
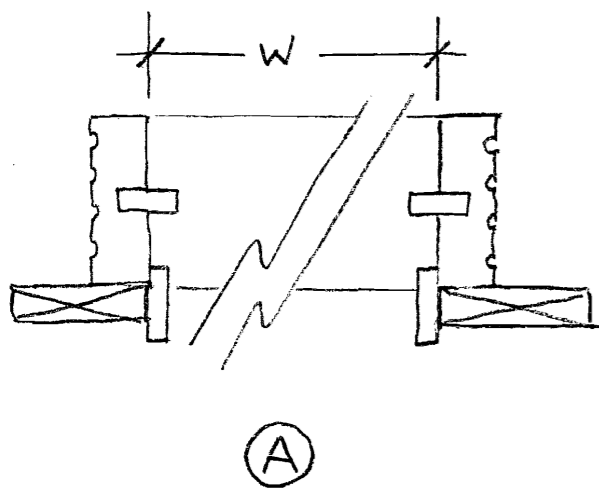
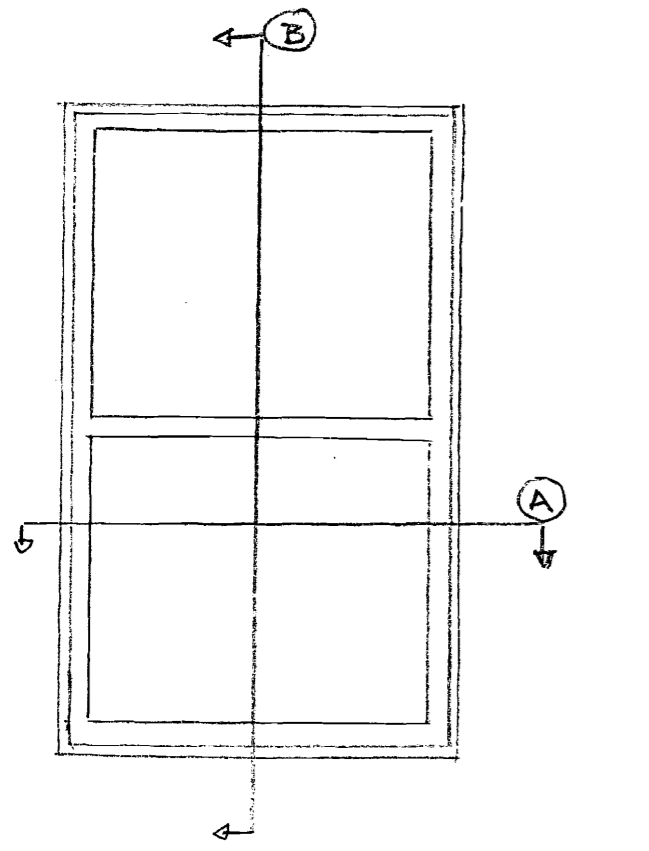

LOCATION	SIZE (W x H)	MATERIAL	BRAND / REMARKS
KITCHEN - SOUTH	33 5/8 x 64 3/8	VINYL	
KITCHEN - NORTH	33 5/8 x 64 1/8	VINYL	
PANTRY - NORTH	33 5/8 x 64 1/8	VINYL	
DINING - NORTH	33 5/8 x 64 1/8	VINYL	
DINING - SOUTHEAST	33 5/8 x 64 1/8	VINYL	
DINING - SOUTHWEST	33 5/8 x 64 1/8	VINYL	
PARLOR - EAST	33 5/8 x 68 1/8	VINYL	
PARLOR - SOUTH	36 5/8 x 68 1/4	WOOD	
PARLOR - NORTH	36 5/8 x 68 1/4	VINYL	
LIVING - SOUTH	36 5/8 x 68 1/4	WOOD	REPAIR EXISTING
LIVING - SOUTHWEST	33 5/8 x 68 1/4	WOOD	REPAIR EXISTING
LIVING - WEST	39 5/8 x 68 1/4	WOOD	REPAIR EXISTING
LIVING - NORTHWEST	33 5/8 x 68 1/4	WOOD	REPAIR EXISTING
1ST FLOOR LAUNDRY	(R.O.) 28" x 32"	VINYL (NEW)	APPROX. MEASURE
2ND FLOOR PANTRY	(R.O.) 28" x 32"	VINYL (NEW)	APPROX. MEASURE
ATTIC	(R.O.) 36" x 48"	VINYL (NEW)	APPROX. MEASURE

WINDOW SCHEDULE

RENOVATIONS
 220 SPRING STREET
 PORTLAND, MAINE

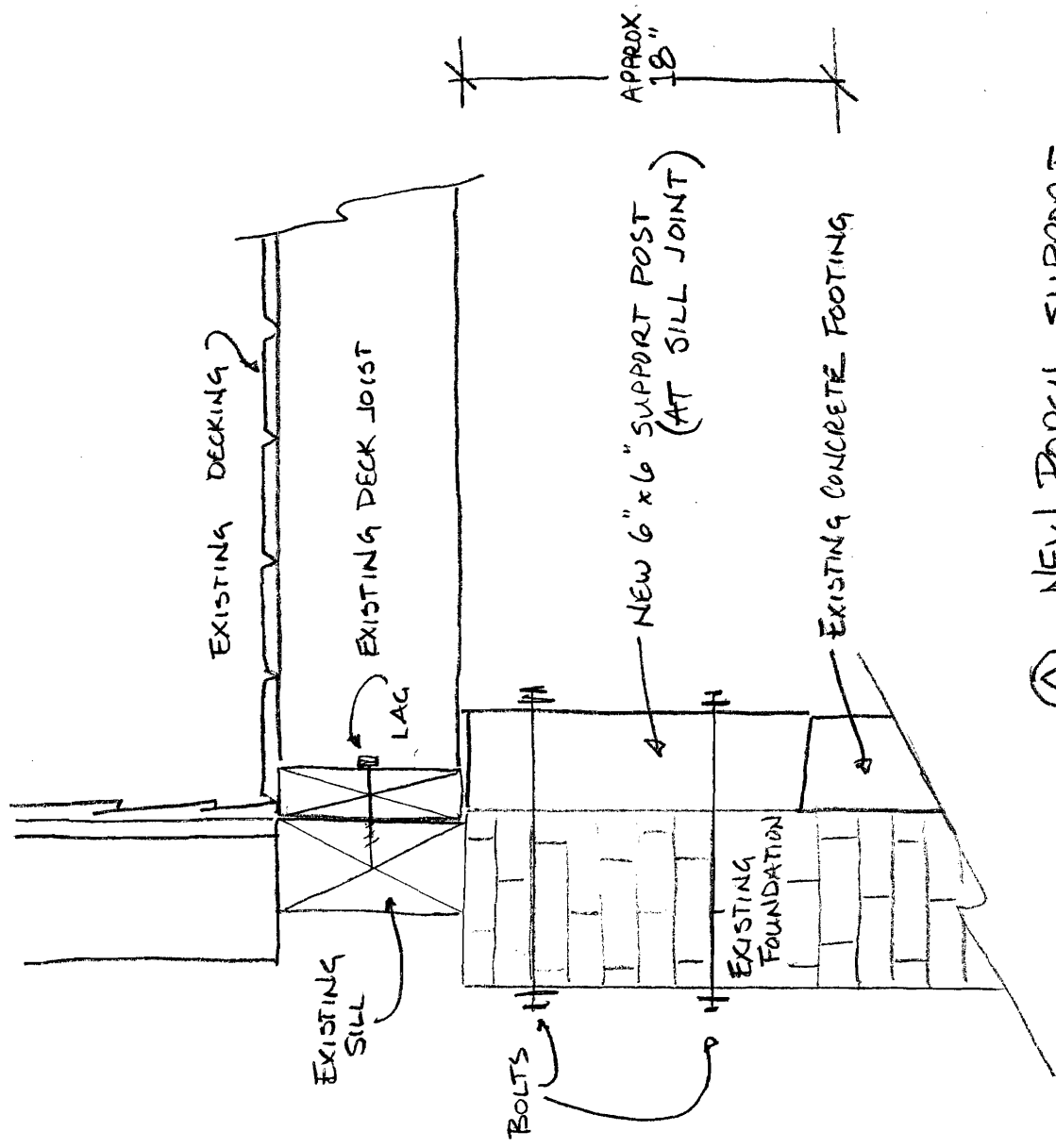

Ⓐ NEW PORCH SUPPORT

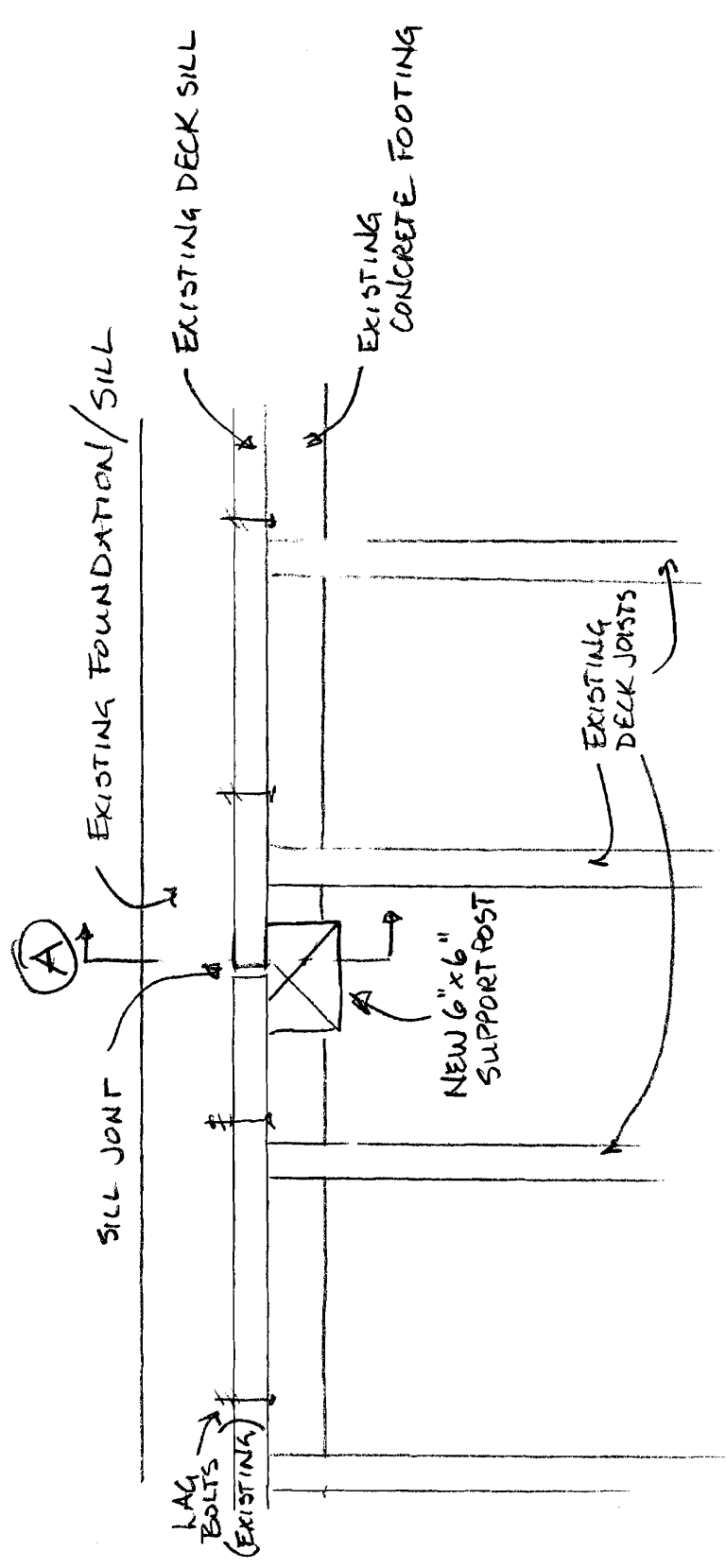

DETAILS OF PORCH SUPPORT

RENOVATIONS
220 SPRING ST
PORTLAND, MAINE

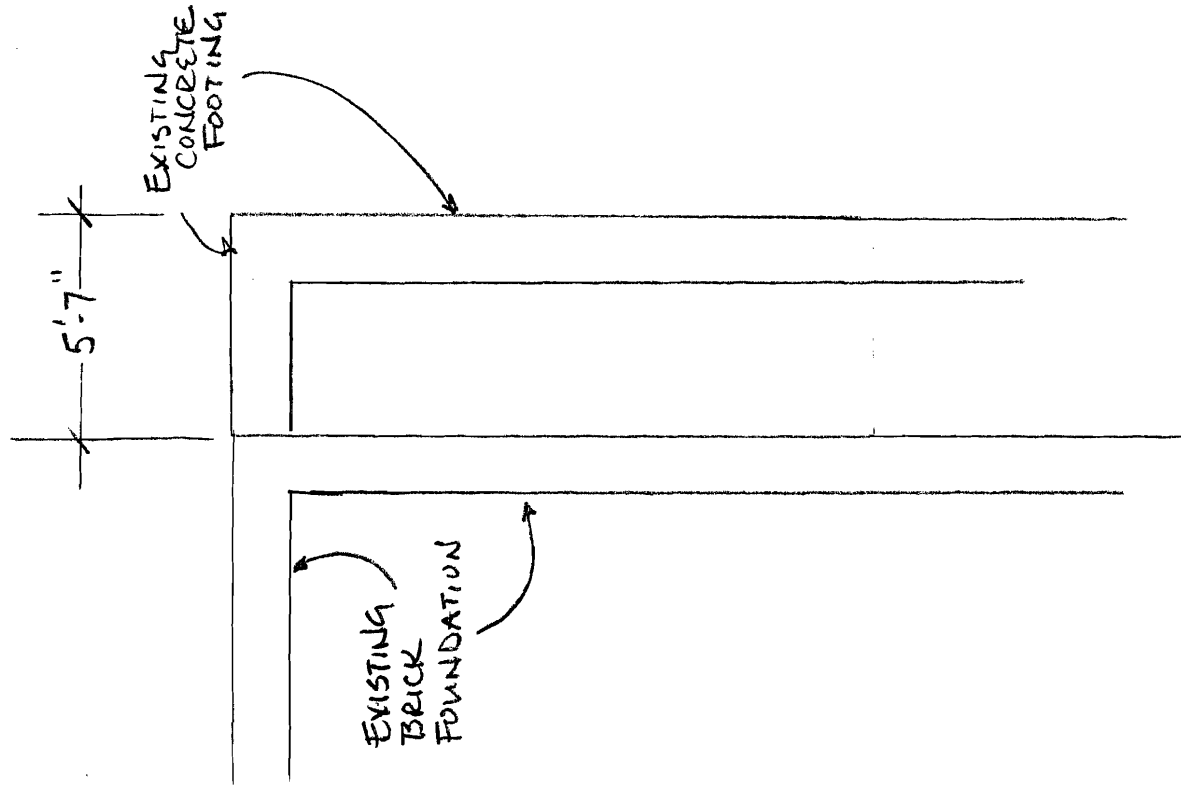

EXISTING FOUNDATION PLAN

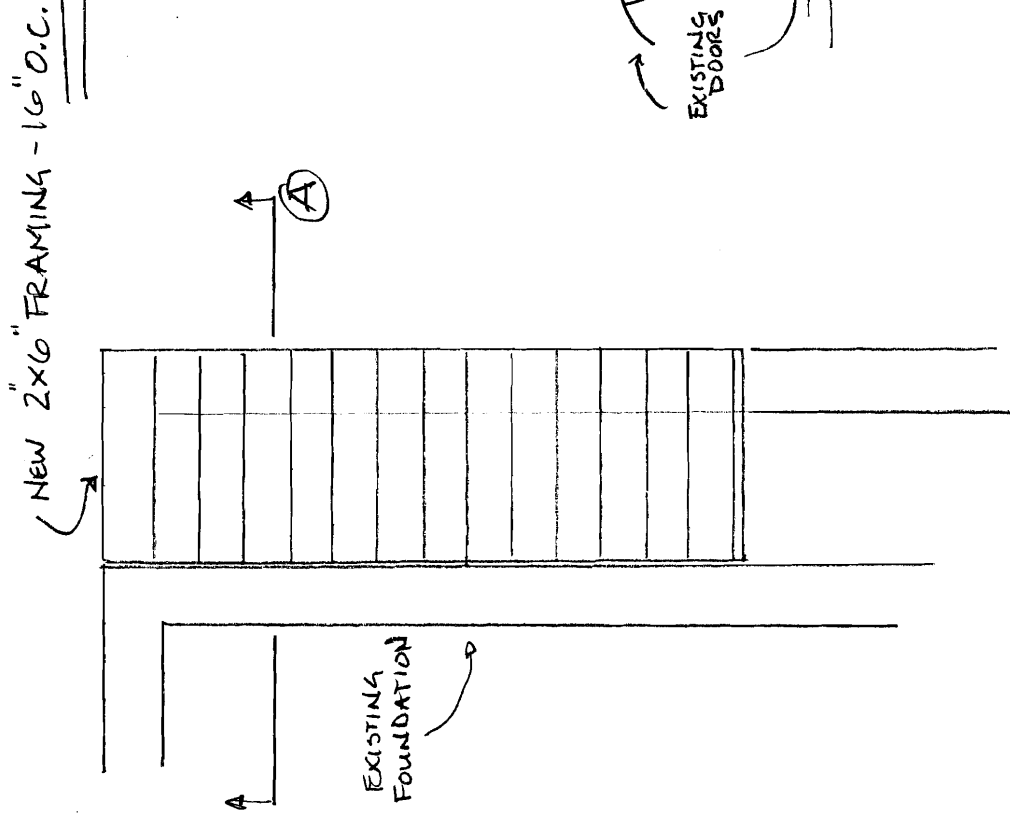

NEW STRUCTURAL PLAN

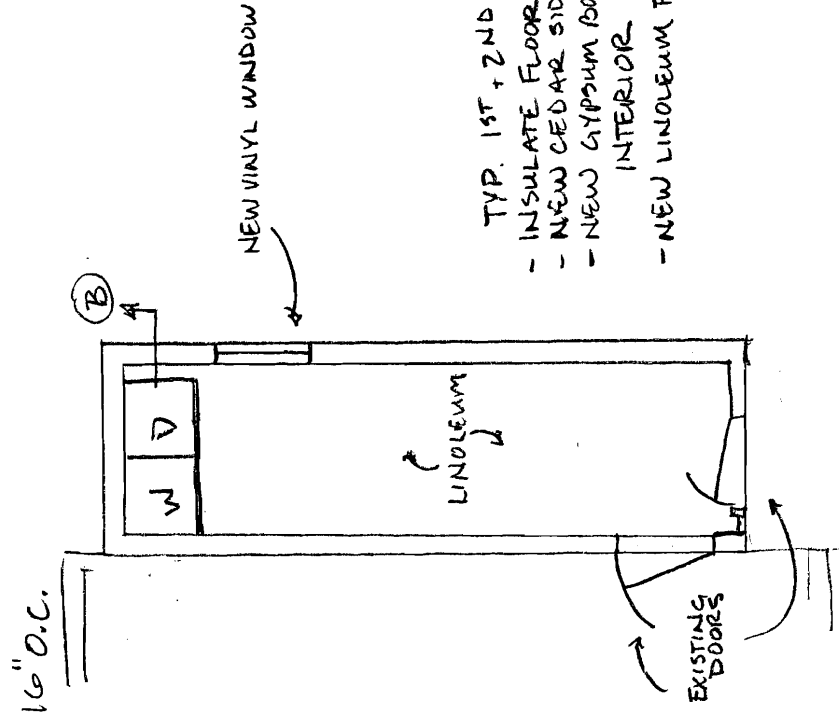

FIRST FLOOR PLAN

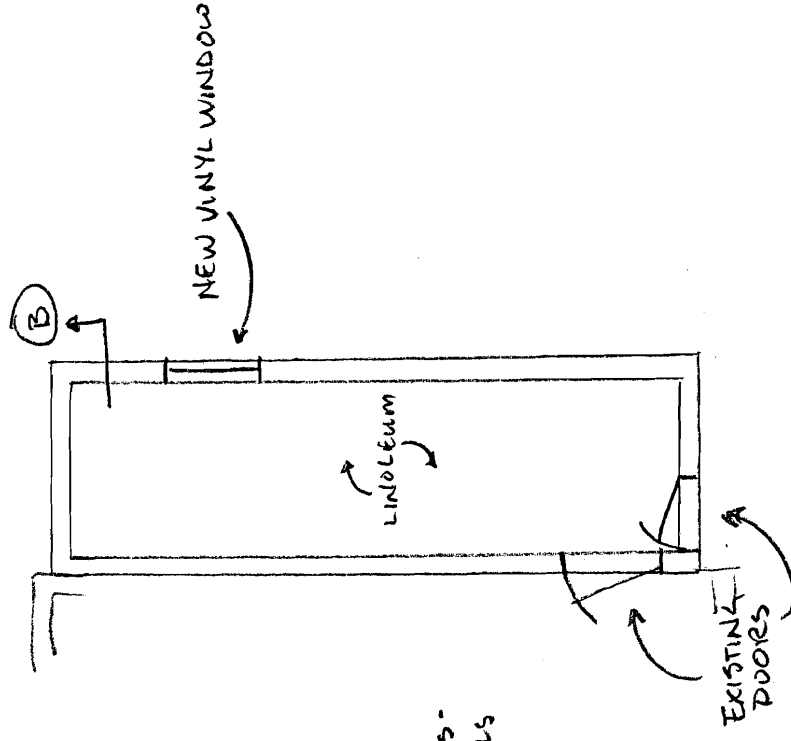

SECOND FLOOR PLAN

- TYP. 1ST + 2ND FLOORS -
- INSULATE FLOOR + WALLS
 - NEW CEDAR SIDING
 - NEW GYPSUM BOARD INTERIOR
 - NEW LINOLEUM FLOOR

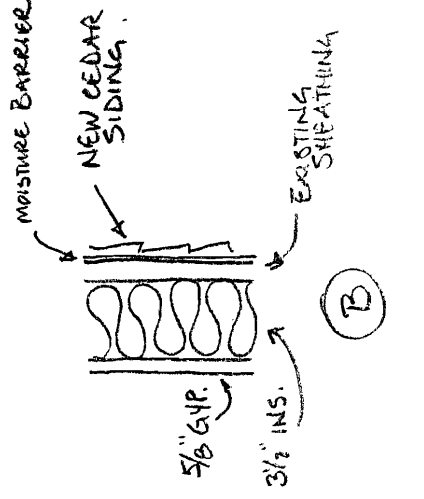

SHED RENOVATIONS
1/4" = 1'-0"

RENOVATIONS
220 SPRING STREET
PORTLAND, MAINE

