

City of Portland, Maine - Building or Use Permit Application

389 Congress Street, 04101 Tel: (207) 874-8703, Fax: (207) 874-8716

PERMIT ISSUED

Permit No: 06-1372	Issue Date: SEP 18 2006	CDEN 051 C01 2001
-----------------------	----------------------------	----------------------

Location of Construction: 21 MAY ST	Owner Name: PORTLAND WEST NEIGHBORH	Owner Address: 155 BRACKETT ST	Phone:
Business Name:	Contractor Name: Waynes Plumbing and Heating	Contractor Address: 158 St. John St Portland	Phone: 2077747849
Lessee/Buyer's Name	Phone:	Permit Type: HVAC	Zone:

Past Use: Duplex	Proposed Use: Duplex- install a Weil-McLain Gold Gas Boiler in basement w/ new 275 gallon oil tank to feed existing oil fired furnace	Permit Fee: \$110.00	Cost of Work: \$8,500.00	CEO District: 2
Proposed Project Description: install a Weil-McLain Gold Gas Boiler in basement w/ new 275 gallon oil tank to feed existing oil fired furnace		FIRE DEPT: <input type="checkbox"/> Approved <input type="checkbox"/> Denied	INSPECTION: Use Group: R3 Type: HVAC	
		Signature:	Signature: JMB 9/18/06	
PEDESTRIAN ACTIVITIES DISTRICT (P.A.D.)				
Action: <input type="checkbox"/> Approved <input type="checkbox"/> Approved w/Conditions <input type="checkbox"/> Denied				
Signature: _____ Date: _____				

Permit Taken By: Idobson	Date Applied For: 09/18/2006	Zoning Approval		
------------------------------------	--	------------------------	--	--

<ol style="list-style-type: none"> This permit application does not preclude the Applicant(s) from meeting applicable State and Federal Rules. Building permits do not include plumbing, septic or electrical work. Building permits are void if work is not started within six (6) months of the date of issuance. False information may invalidate a building permit and stop all work.. 	Special Zone or Reviews <input type="checkbox"/> Shoreland <input type="checkbox"/> Wetland <input type="checkbox"/> Flood Zone <input type="checkbox"/> Subdivision <input type="checkbox"/> Site Plan Maj <input type="checkbox"/> Minor <input type="checkbox"/> MM <input type="checkbox"/> Date: _____	Zoning Appeal <input type="checkbox"/> Variance <input type="checkbox"/> Miscellaneous <input type="checkbox"/> Conditional Use <input type="checkbox"/> Interpretation <input type="checkbox"/> Approved <input type="checkbox"/> Denied Date: _____	Historic Preservation <input type="checkbox"/> Not in District or Landmark <input type="checkbox"/> Does Not Require Review <input type="checkbox"/> Requires Review <input type="checkbox"/> Approved <input type="checkbox"/> Approved w/Conditions <input type="checkbox"/> Denied Date: _____
---	---	---	---

CERTIFICATION

I hereby certify that I am the owner of record of the named property, or that the proposed work is authorized by the owner of record and that I have been authorized by the owner to make this application as his authorized agent and I agree to conform to all applicable laws of this jurisdiction. In addition, if a permit for work described in the application is issued, I certify that the code official's authorized representative shall have the authority to enter all areas covered by such permit at any reasonable hour to enforce the provision of the code(s) applicable to such permit.

SIGNATURE OF APPLICANT ADDRESS DATE PHONE

RESPONSIBLE PERSON IN CHARGE OF WORK, TITLE DATE PHONE



FILL IN AND SIGN WITH INK

APPLICATION FOR PERMIT HEATING OR POWER EQUIPMENT

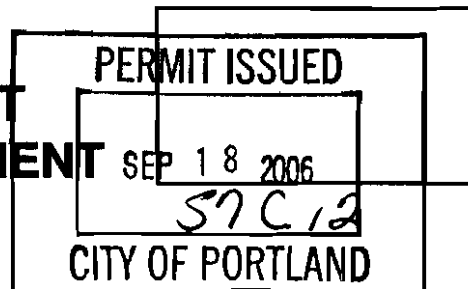

To the INSPECTOR OF BUILDINGS, PORTLAND, ME.

The undersigned hereby applies for a permit to install the following heating, cooking or power equipment in accordance with the Laws of Maine, the Building Code of the City of Portland, and the following specifications:

Location / CBL 21 May St 061372 Use of Building Res Date 9/18/06
 Name and address of owner of appliance Portland West 181 Brackett St Port
 Installer's name and address Waynes PTH
 Telephone 774 7849

Location of appliance:

- Basement
- Attic
- Floor
- Roof

Type of Fuel:

- Gas
- Oil
- Solid

Appliance Name:

U.L. Approved Yes No

Will appliance be installed in accordance with the manufacture's installation instructions? Yes No

IF NO Explain: _____

The Type of License of Installer:

- Master Plumber # _____
- Solid Fuel # _____
- Oil # _____
- Gas # PNT 130
- Other _____

Type of Chimney:

- Masonry Lined new stainless liner
Factory built _____
- Metal
Factory Built U.L. Listing # _____
- Direct Vent
Type _____ UL# _____

Type of Fuel Tank

- Oil
- Gas

Size of Tank 275

Number of Tanks 1

Distance from Tank to Center of Flame 8 feet.

Cost of Work: \$ 8500.00

Permit Fee: \$ _____

Approved

Approved with Conditions

Fire: _____

Ele.: _____

Bldg.: JMB 9/18/06

- See attached letter or requirement

Signature of Installer [Signature]

Inspector's Signature _____

Date Approved _____

May st

21 May St
Portland West

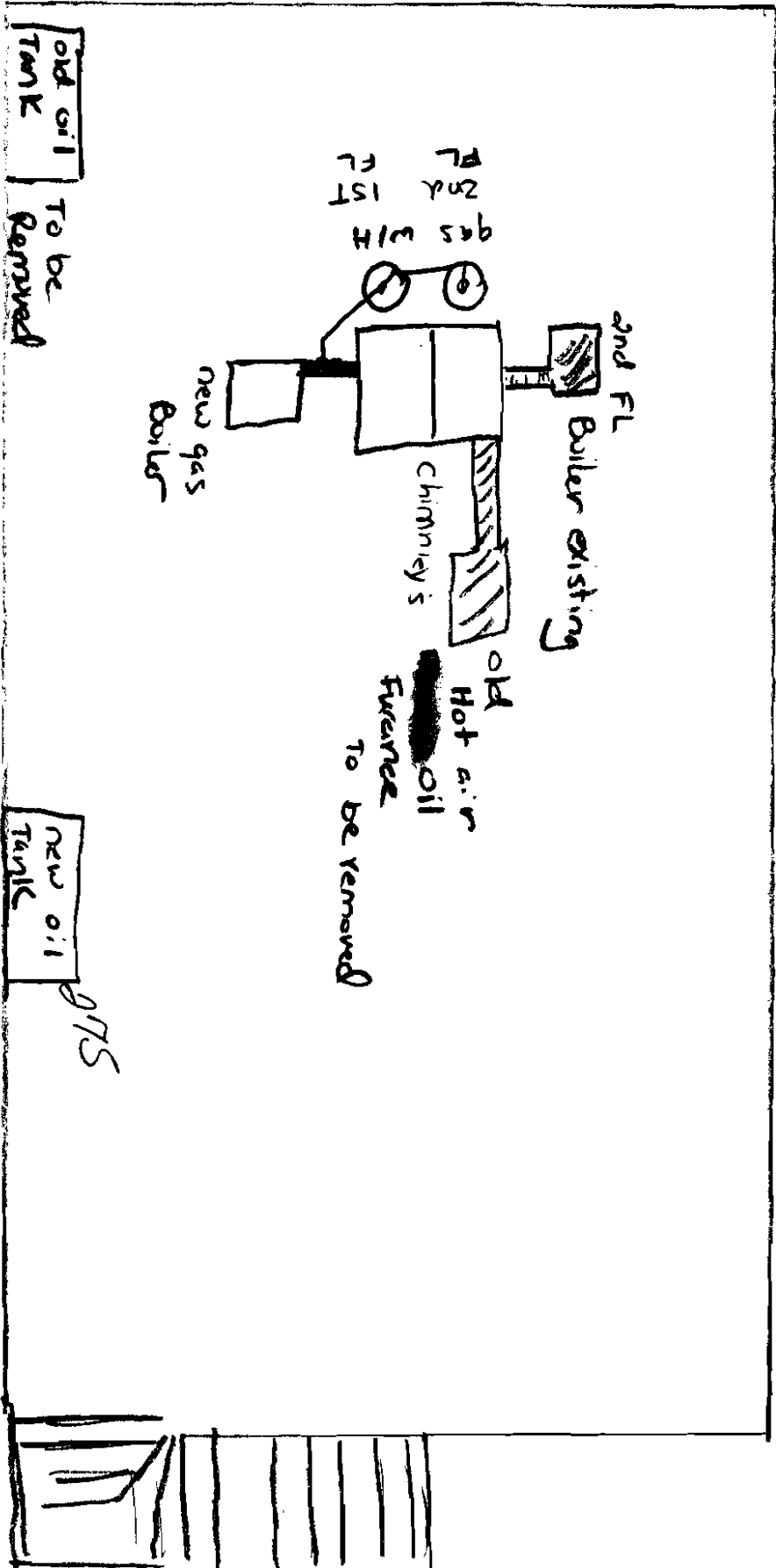



CITY OF PORTLAND, MAINE

Department of Building Inspections

9-18 2006

Received from _____

Location of Work 21 May St

Cost of Construction \$ 48,500

Permit Fee \$ _____

Building (I1)

Plumbing (I5)

Electrical (I2)

Site Plan (U2)

Other HVAC

2 C12

Check # 201

Total Collected \$ 110⁰⁰/₁₀₀

THIS IS NOT A PERMIT

No work is to be started until PERMIT CARD is actually posted upon the premises. Acceptance of fee is no guarantee that permit will be granted. PRESERVE THIS RECEIPT. In case permit cannot be granted the amount of the fee will be refunded upon return of the receipt less \$10.00 or 10% whichever is greater.

WHITE - Applicant's Copy

YELLOW - Office Copy

PINK - Permit Copy



FILL IN AND SIGN WITH INK

APPLICATION FOR PERMIT HEATING OR POWER EQUIPMENT

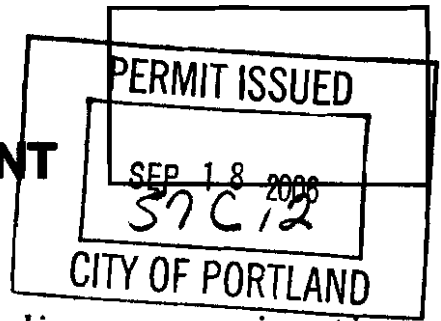

To the INSPECTOR OF BUILDINGS, PORTLAND, ME.

The undersigned hereby applies for a permit to install the following heating, cooking or power equipment in accordance with the Laws of Maine, the Building Code of the City of Portland, and the following specifications:

Location / CBL 21 May St 061372 Use of Building Res Date 9/18/06

Name and address of owner of appliance Portland West 181 Brackett St Port

Installer's name and address Waynes PTH

Telephone 774 7849

Location of appliance:

- Basement
- Attic
- Floor
- Roof

Type of Fuel:

- Gas
- Oil
- Solid

Appliance Name:

U.L. Approved Yes No

Will appliance be installed in accordance with the manufacture's installation instructions? Yes No

IF NO Explain:

The Type of License of Installer:

- Master Plumber # _____
- Solid Fuel # _____
- Oil # _____
- Gas # PNT 130
- Other _____

Type of Chimney:

- Masonry Lined new stainless liner
Factory built _____
- Metal
Factory Built U.L. Listing # _____
- Direct Vent
Type _____ UL# _____

Type of Fuel Tank

- Oil
- Gas

Size of Tank 275

Number of Tanks 1

Distance from Tank to Center of Flame 8 feet.

Cost of Work: \$ 8500.00

Permit Fee: \$ _____

Approved

Approved with Conditions

- See attached letter or requirement

Fire: _____

Ele.: _____

Bldg.: JMB 9/18/06

Signature of Installer [Signature]

Inspector's Signature

Date Approved