

DISPLAY THIS CARD ON PRINCIPAL FRONTAGE OF WORK



CITY OF PORTLAND

BUILDING PERMIT

This is to certify that 294 Spring Street LLC

Located At 294 SPRING ST

Job ID: 2011-12-2833-HVAC

CBL: 056- I-005-001

has permission to Install a Viessman 200-W

provided that the person or persons, firm or corporation accepting this permit shall comply with all of the provisions of the Statues of Maine and of the Ordinances of the City of Portland regulating the construction, maintenance and use of the buildings and structures, and of the application on file in the department.

Notification of inspection and written permission procured before this building or part thereof is lathed or otherwise closed-in. 48 HOUR NOTICE IS REQUIRED.

A final inspection must be completed by owner before this building or part thereof is occupied. If a certificate of occupancy is required, it must be

Fire Prevention Officer

Code Enforcement Officer / Plan Reviewer

**THIS CARD MUST BE POSTED ON THE STREET SIDE OF THE PROPERTY
PENALTY FOR REMOVING THIS CARD**

BUILDING PERMIT INSPECTION PROCEDURES

Please call 874-8703 or 874-8693 (ONLY)

or email: buildinginspections@portlandmaine.gov

With the issuance of this permit, the owner, builder or their designee is required to provide adequate notice to the city of Portland Inspections Services for the following inspections. Appointments must be requested 48 to 72 hours in advance of the required inspection. The inspection date will need to be confirmed by this office.



- **Please read the conditions of approval that is attached to this permit!! Contact this office if you have any questions.**
- **Permits expire in 6 months. If the project is not started or ceases for 6 months.**
- **If the inspection requirements are not followed as stated below additional fees may be incurred due to the issuance of a "Stop Work Order" and subsequent release to continue.**

The project cannot move to the next phase prior to the required inspection and approval to continue, REGARDLESS OF THE NOTICE OF CIRCUMSTANCES.

IF THE PERMIT REQUIRES A CERTIFICATE OF OCCUPANCY, IT MUST BE PAID FOR AND ISSUED TO THE OWNER OR DESIGNEE BEFORE THE SPACE MAY BE OCCUPIED.

City of [redacted], Maine - Building or Use Permit Application

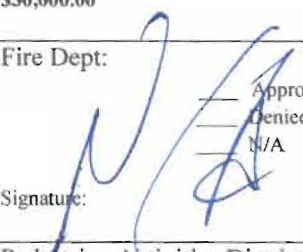
389 Congress Street, 04101 Tel: (207) 874-8703, FAX: (207) 8716

Job No: 2011-12-2833-HVAC	Date Applied: 11/30/2011	CBL: 056-1-005-001	
Location of Construction: 294 SPRING ST	Owner Name: 294 Spring Street LLC	Owner Address: 49 MORNING ST PORTLAND, ME 04102	Phone:
Business Name:	Contractor Name: Jeffery M Grover, @Grover contracting	Contractor Address: P.O. Box 917 RAYMOND MAINE 04071	Phone: (207) 577-7282
Lessee/Buyer's Name:	Phone:	Permit Type: HVAC	Zone: R-6
Past Use: Two Family Dwelling	Proposed Use: Same: Two Family Dwelling – to install Viessman Vitodens 200-W heating system	Cost of Work: \$30,000.00	CEO District:
		Fire Dept: <input type="checkbox"/> Approved <input type="checkbox"/> Denied <input type="checkbox"/> N/A Signature: 	Inspection: Use Group: <input checked="" type="checkbox"/> Type: HVAC Signature: 
Proposed Project Description: Install a Viessman 200-W		Pedestrian Activities District (P.A.D.)	
Permit Taken By: Lannie		Zoning Approval	

1. This permit application does not preclude the Applicant(s) from meeting applicable State and Federal Rules. 2. Building Permits do not include plumbing, septic or electrical work. 3. Building permits are void if work is not started within six (6) months of the date of issuance. False informatin may invalidate a building permit and stop all work.	Special Zone or Reviews <input type="checkbox"/> Shoreland <input type="checkbox"/> Wetlands <input type="checkbox"/> Flood Zone <input type="checkbox"/> Subdivision <input type="checkbox"/> Site Plan <input type="checkbox"/> Maj <input type="checkbox"/> Min <input type="checkbox"/> MM Date: 	Zoning Appeal <input type="checkbox"/> Variance <input type="checkbox"/> Miscellaneous <input type="checkbox"/> Conditional Use <input type="checkbox"/> Interpretation <input type="checkbox"/> Approved <input type="checkbox"/> Denied Date:	Historic Preservation <i>within</i> <input type="checkbox"/> Not in Dist or Landmark <input type="checkbox"/> Does not Require Review <input type="checkbox"/> Requires Review <input type="checkbox"/> Approved <input type="checkbox"/> Approved w/Conditions <input type="checkbox"/> Denied Date: <i>Any exterior work requires A Separate Review and Approval</i>
	CERTIFICATION		

I hereby certify that I am the owner of record of the named property, or that the proposed work is authorized by the owner of record and that I have been authorized by the owner to make this application as his authorized agent and I agree to conform to all applicable laws of this jurisdiction. In addition, if a permit for work described in the appication is issued, I certify that the code official's authorized representative shall have the authority to enter all areas covered by such permit at any reasonable hour to enforce the provision of the code(s) applicable to such permit.

SIGNATURE OF APPLICANT	ADDRESS	DATE	PHONE
RESPONSIBLE PERSON IN CHARGE OF WORK, TITLE		DATE	PHONE



FILL IN AND SIGN WITH INK

APPLICATION FOR PERMIT HEATING OR POWER EQUIPMENT



To the INSPECTOR OF BUILDINGS, PORTLAND, ME.

The undersigned hereby applies for a permit to install the following heating, cooking or power equipment in accordance with the Laws of Maine, the Building Code of the City of Portland, and the following specifications:

Location / CBL 294 SPRING ST 56-I-5 Use of Building Res Date 11-30-11

Name and address of owner of appliance JENKINS
GROVER CONTRACTING

Installer's name and address JEFF GROVER P O Box 917 Raymond Me
Telephone 207 577-7282

Location of appliance:

- Basement
- Attic
- Floor
- Roof

Type of Fuel:

- Gas
- Oil
- Solid

Appliance Name: VISSMAN VITODENS

U.L. Approved Yes No 200-W

Will appliance be installed in accordance with the manufacture's installation instructions? Yes No

IF NO Explain: _____

The Type of License of Installer:

- Master Plumber # _____
- Solid Fuel # _____
- Oil # _____
- Gas # PNT 3882
- Other _____

Type of Chimney:

Masonry Lined
Factory built _____

Metal
Factory Built U.L. Listing # _____

Direct Vent
Type PVC U.L.# _____

Type of Fuel Tank

- Oil
- Gas

Size of Tank _____

Number of Tanks _____

Distance from Tank to Center of Flame _____ feet.

Cost of Work: \$ 30,000

Permit Fee: \$ 320

RECEIVED
NOV 30 2011
Dept. of Building Inspections
City of Portland Maine
NAT.

Approved

Fire: _____
Ele.: _____
Bldg.: _____

Approved with Conditions

- See attached letter or requirement

Inspector's Signature _____

Date Approved _____

Signature of Installer _____

Installation Instructions

for use by heating contractor

VIESSMANN®

Vitodens 200-W, WB2B Series

Models 45, 60

Wall-mounted, gas-fired condensing boiler

For operation with natural gas and liquid propane gas

Heating input 60 to 212 MBH

17 to 62 kW

Please file in Service Binder



VITODENS 200-W®

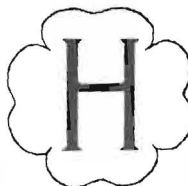
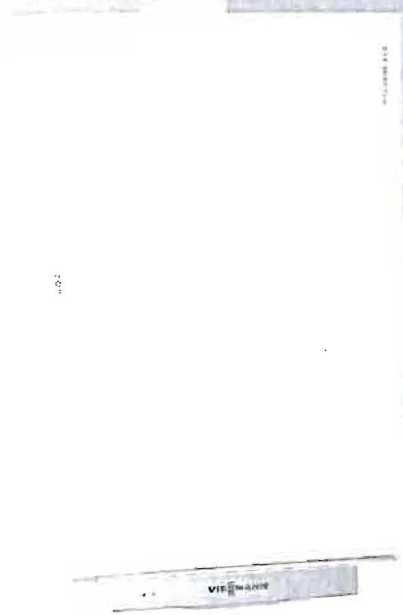

IMPORTANT

Read and save these instructions for future reference.

Before placing boiler in its installation location, ensure all necessary accessories are installed.

CAUTION
 The boiler must be installed in such a way that gas ignition system components are protected from water (spraying, splashing, etc.) during boiler operation and service.

Minimum Clearances

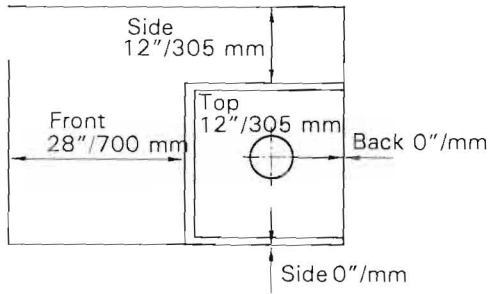

Fig. 2 Recommended min. service clearances

Note:
 The Vitodens 200-W, WB2B boiler has passed the zero inches vent clearance to combustibles testing requirements dictated by the boiler Harmonized Standard ANSI Z21.13. CSA 4.9.2007 and therefore is listed for zero clearance to combustibles when vented with a single-wall special venting system (AL-29-4C material) or UL/ULC-listed CPVC gas vent material. The zero inches vent clearance to combustibles for the Vitodens 200-W, WB2B boiler supercedes the clearance to combustibles listing that appears on the special venting system label.

Recommended minimum service clearances

For typical Vitodens installations, Viessmann recommends installing the boiler with the clearances shown in the illustration on the left.

The Vitodens 200-W, WB2B boiler is approved for closet and alcove installation with the following clearances to combustibles.

Table 1. Clearances

Top	Front	Rear	Left	Right	Vent pipe
0	0 AL, CL	0	0	0	0

AL = Alcove
 CL = Closet



See the Vitodens 200-W WB2B Venting System Installation Instructions for details.

Wall Mounting

Installing the wall mounting bracket

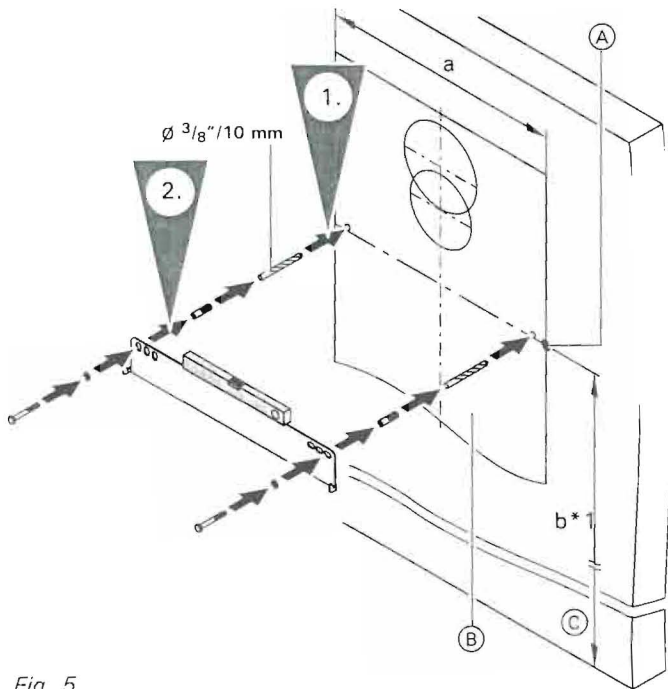

Fig. 5

Legend

- (A) Reference point for top of boiler
- (B) Mounting template
- (C) Finished floor level

Dimensions

- a 19" / 483 mm
- b 78" / 1975 mm

*1Recommendation

The Vitodens 200-W WB2B can be wall-mounted on

- a brick/concrete wall
- wood studs
- metal studs

Following are the installation instructions for the mounting bracket on each material. Skip to the installation instructions applicable to your installation requirements.

CAUTION

Whichever mounting method is used, ensure that the bracket is tightly and securely fastened to wall. Failure to secure boiler properly could cause boiler to loosen, posing a severe safety hazard.

Installation of mounting bracket on brick/concrete wall:

1. Drill holes ($\varnothing 3/8" / 10 \text{ mm}$), using mounting template supplied with the boiler.
2. Align wall mounting bracket and attach to wall with the screws and bolts supplied.

Wall Mounting *(continued)*

Installing the wall mounting bracket *(continued)*

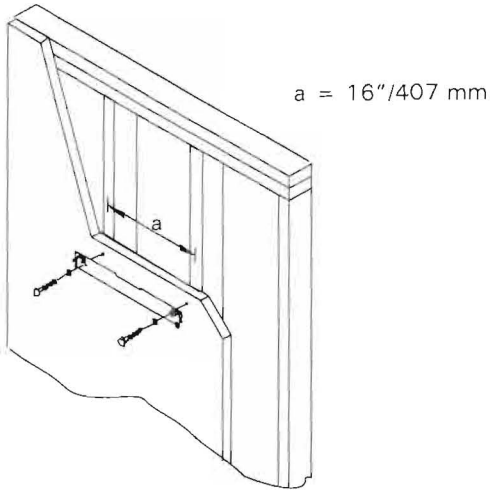

Fig. 6 General installation of mounting bracket

Installation of mounting bracket on wood and metal studs

To mount the Vitodens 200-W WB2B boiler on wood or metal studs, install mounting bracket on wall as shown in Fig. 6.

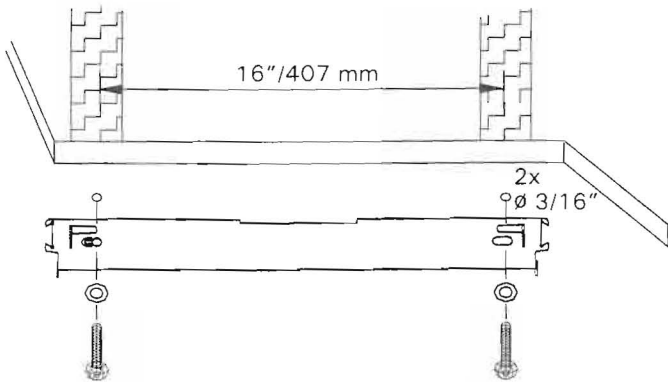

Fig. 7 Installation of mounting bracket on wood studs

Install mounting bracket on wood studs as per Fig. 7.
Drill $\frac{3}{16}$ " pilot holes to insert mounting bolts.
Ensure that holes are located in the center of each wood stud.

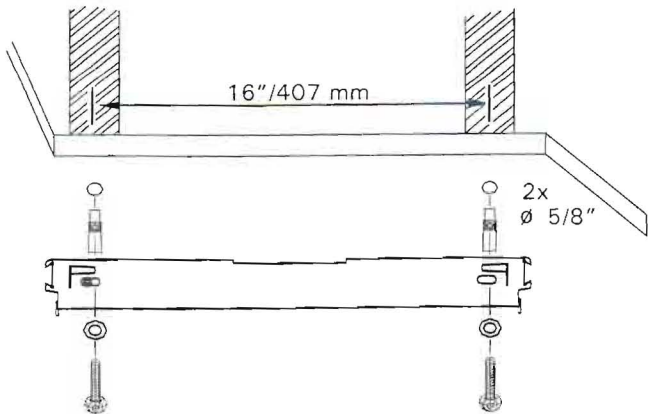
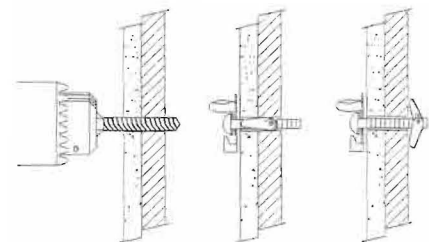

Fig. 8 Installation of mounting bracket on metal studs

Install mounting bracket on metal studs as per Fig. 8.
Drill $\frac{5}{8}$ " pilot holes to insert mounting bolts.
Ensure that holes are located in the center of each metal stud.
Secure mounting bracket with bolts to metal studs as shown below.



5418 909 v1.1

Wall Mounting *(continued)*

Mounting the boiler

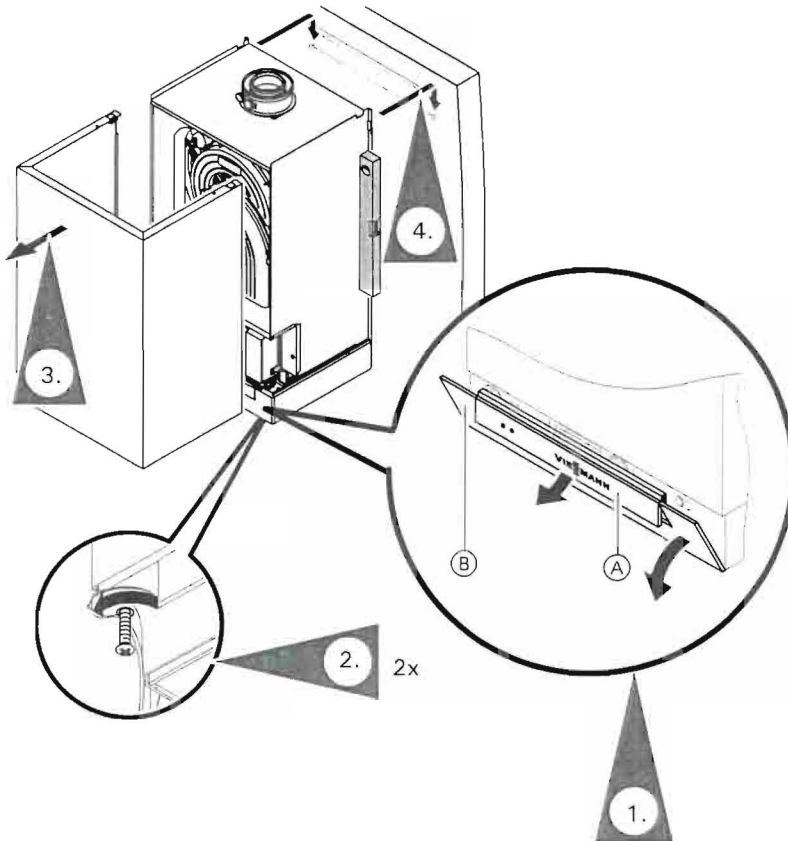

1. To open hinged cover, lift cover (A) and pivot control unit flap (B) down. All boiler controls are located behind the control unit flap.

2. Loosen the screws at the bottom of the boiler; do not remove completely.

3. Remove front enclosure panel (lift up and pull towards you).



For installation of the mounting bracket, see "Wall mounting" on page 13 of this manual.

4. Mount boiler onto the mounting bracket and connect boiler to the installation fittings.

Fig. 9