

LIGHTING & ELECTRICAL SYMBOLS			
⊙ <sub>W</sub>	Smoke detector wall mounted as required by code	⊙ <sub>S</sub>	Duplex receptacle (S for switched)
⊙ <sub>C</sub>	Smoke detector ceiling mounted as required by code	⊙ <sub>220</sub>	Receptacle 220 V
▲	CAT 5 - Cable TV / Data / Phone	⊙ <sub>F</sub>	Receptacle in floor
⊙ <sub>R</sub>	Recessed	⊙ <sub>GFI</sub>	Duplex receptacle-Ground Fault Interrupt
⊙ <sub>RD</sub>	Recessed Directional	⊙ <sub>WP</sub>	Duplex receptacle-weatherproof
⊙ <sub>CM</sub>	Ceiling mounted light fixture	⊙ <sub>JB</sub>	Junction Box for direct wire
⊙ <sub>TF</sub>	track fixture	⊙	Switch
⊙ <sub>WM</sub>	Wall mounted light fixture	⊙ <sub>3</sub>	3-way switch
⊙ <sub>FL</sub>	Floor lamp	⊙ <sub>D</sub>	Dimmer switch
⊙ <sub>TL</sub>	Table lamp	⊙ <sub>J</sub>	Jamb or motion sensor switch
x	Fluorescent strip x= length	⊙ <sub>E</sub>	Exhaust fan
		x	device in millwork
		x	undercabinet light
			COOO control point - switch name

NOTE: SEE SCHEDULE FOR DIMMED CIRCUITS.

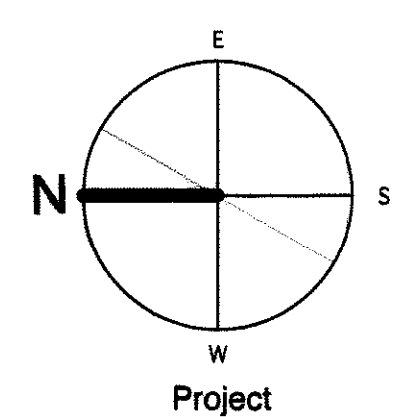
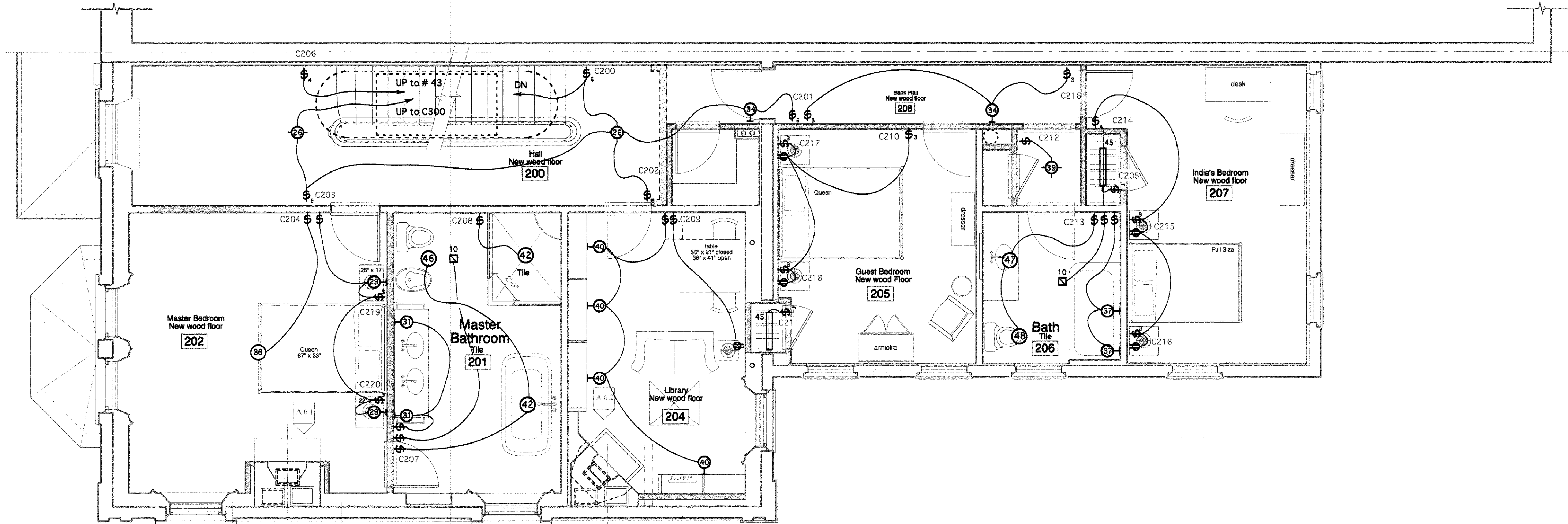

4 Entire Sheet

These drawings are the architect's instruments of service. A substantial amount of work to be done on the project is based on conversations between the Architect and Wright-Ryan Construction. If the drawing the Architect's involvement in interpretation of the documents and review of field conditions, I not be liable for problems with any aspect of the design during and after construction.

construction set 01/03/11

Second Floor Lighting and Specialty Outlet Plan

E1.2

Jenkins Residence

Drawn by: JPB/PAL/KSH Scale: 1/4" = 1'-0" Date: 11/22/10  
 Revisions: Job #: 20913  
 04/06/11

294 Spring Street  
 Portland, Maine

Landscape Architect:  
 James Doyle Design Associates  
 125 Greenman Lane  
 Greenwich, CT 06830

Structural Engineer:  
 Becker Structural Engineers Inc.  
 75 York Street  
 Portland, ME 04101

Van Dam Architecture and Design

65 West Street  
 Portland, Maine 04102  
 207-775-0443  
 FAX 775-2892  
 studio@vandamdesign.com