

LIGHTING & ELECTRICAL SYMBOLS			
⊙ <sub>w</sub>	Smoke detector wall mounted as required by code	⊙ <sub>S</sub>	Duplex receptacle (S for switched)
⊙ <sub>c</sub>	Smoke detector ceiling mounted as required by code	⊙ <sub>220</sub>	Receptacle 220 V
▲	CAT 5 - Cable TV / Data / Phone	⊙ <sub>F</sub>	Receptacle in floor
⊙ <sub>R</sub>	Recessed	⊙ <sub>GFI</sub>	Duplex receptacle-Ground Fault Interrupt
⊙ <sub>RD</sub>	Recessed Directional	⊙ <sub>WP</sub>	Duplex receptacle-weatherproof
⊙ <sub>CM</sub>	Ceiling mounted light fixture	⊙ <sub>JB</sub>	Junction Box for direct wire
—	track fixture	⊙	Switch
⊙ <sub>WM</sub>	Wall mounted light fixture	⊙ <sub>3</sub>	3-way switch
⊙ <sub>FL</sub>	Floor lamp	⊙ <sub>D</sub>	Dimmer switch
⊙ <sub>TL</sub>	Table lamp	⊙ <sub>J</sub>	Jamb or motion sensor switch
—	Fluorescent strip x= length	⊙ <sub>E</sub>	Exhaust fan
		⊙ <sub>M</sub>	device in millwork
		x	undercabinet light
			C000 control point - switch name

NOTE: SEE SCHEDULE FOR DIMMED CIRCUITS.

Van Dam Architecture and Design

66 West Street  
Portland, Maine 04102  
207-775-0443  
FAX 775-2892  
studio@vandamdesign.com

Landscape Architect:  
James Doyle Design Associates  
125 Greenman Hill  
Greenwich, CT 06830

Structural Engineer:  
Becker Structural Engineers Inc.  
75 York Street  
Portland, ME 04101

Jenkins Residence

294 Spring Street  
Portland, Maine

First Floor Lighting and  
Specialty Outlet Plan

Drawn by: JPB/PAL/KPH Scale: 1/4" = 1'-0" Date: 11/22/10  
Revisions: Job #: 20813  
04/06/11

E1.1

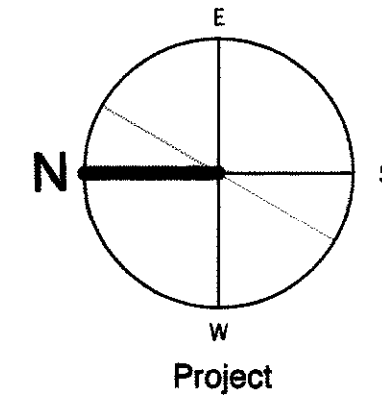
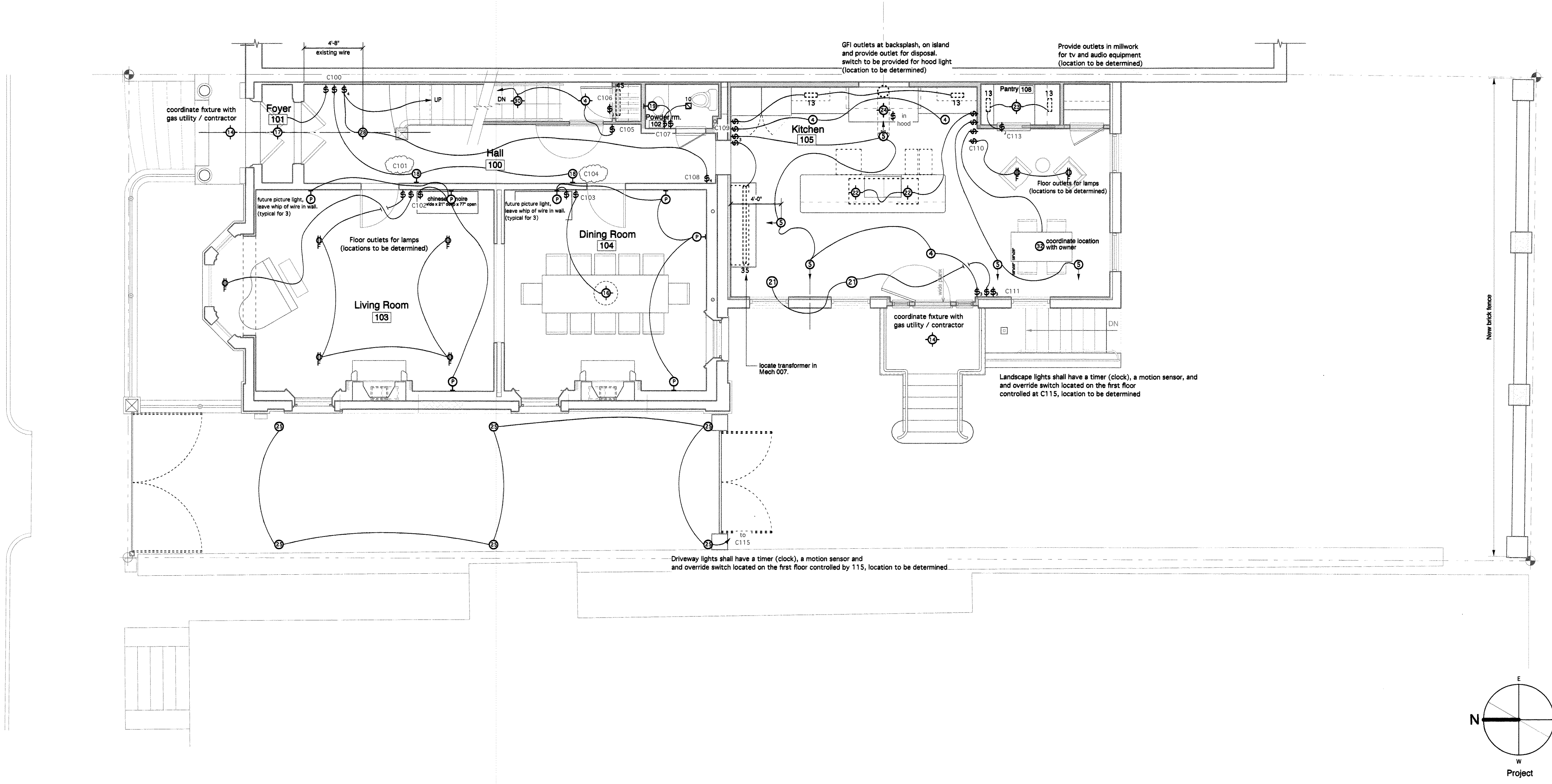

These drawings are the architect's instruments of service. A substantial amount of work to be done on the project is based on conversations between the Architect and Wright-Ryan Construction. If the drawings are used without the Architect's involvement in interpretation of the documents and review of field conditions, the Architect shall not be liable for problems with any aspect of the design during and after construction.

4 Entire Sheet  
construction set 01/03/11