

LIGHTING & ELECTRICAL SYMBOLS			
⊙ _W	Smoke detector wall mounted as required by code	⊕ _S	Duplex receptacle (S for switched)
⊙ _C	Smoke detector ceiling mounted as required by code	⊕ ₂₂₀	Receptacle 220 V
▲	CAT 5 - Cable TV / Data / Phone	⊕ _F	Receptacle in floor
⊙	Recessed	⊕ _{GFI}	Duplex receptacle-Ground Fault Interrupt
⊙➔	Recessed Directional	⊕ _{WP}	Duplex receptacle-weatherproof
⊙	Ceiling mounted light fixture	⊕	Junction Box for direct wire
⊙	track fixture	⊕	Switch
⊕	Wall mounted light fixture	⊕ ₃	3-way switch
⊕ _F	Floor lamp	⊕ _D	Dimmer switch
⊕ _T	Table lamp	⊕ _J	Jamb or motion sensor switch
x	Fluorescent strip x= length	⊕	Exhaust fan
		M	device in millwork
		x c c c c c c c c	undercabinet light
			0000 control point - switch name

NOTE: SEE SCHEDULE FOR DIMMED CIRCUITS.

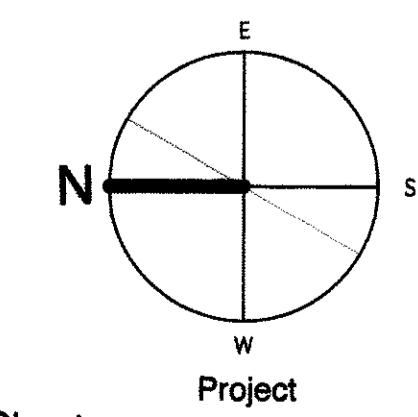
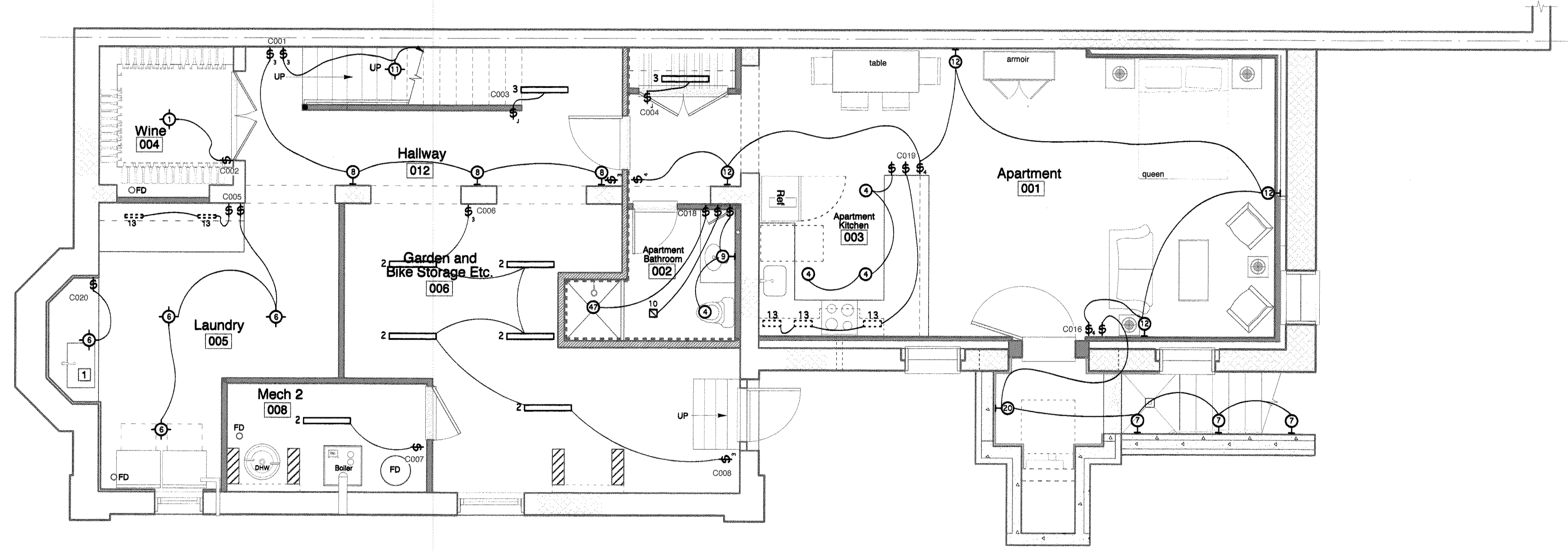

4 Entire Sheet

These drawings are the architect's instruments of service. A substantial amount of work to be done on the project is based on conversations between the Architect and Wright-Ryan Construction. If the drawings are used without the Architect's involvement in interpretation of the documents and review of field conditions, the Architect shall not be liable for problems with any aspect of the design during and after construction.

construction set 01/03/11

Basement Lighting and Specialty Outlet Plan

E1.0

Jenkins Residence

284 Spring Street
Portland, Maine

Landscape Architect:
James Doyle Design Associates
1000 Main Street
Greenwich, CT 06830

Structural Engineer:
Baker Structural Engineers Inc.
Portland, ME 04101

Van Dam Architecture and Design

66 West Street
Portland, Maine 04102
207-775-0443
FAX 775-2892
studio@vandamdesign.com

Drawn by: JPP/PV/KRH Scale: 1/8" = 1'-0" Date: 11/29/10
Revisions: Job #: 20913
A 04/06/11