

PERMIT ISSUED

City of Portland, Maine - Building or Use Permit Application
 389 Congress Street, 04101 Tel: (207) 874-8703, Fax: (207) 874-8716

Permit No: 03-1447	Issue Date: DEC 03 2003	CBL: 056 I001001
-----------------------	-----------------------------------	---------------------

Location of Construction: 306 Spring St	Owner Name: Medina Helio	Owner Address: 306 Spring St CITY OF PORTLAND	Phone: 775-9012
Business Name:	Contractor Name: Brewer, Bradley	Contractor Address: 30 Deer Run Bowdoin	Phone: 2076668932
Lessee/Buyer's Name	Phone:	Permit Type: Amendment to Single Family	Zone: <i>R6</i>

Past Use: Single Family	Proposed Use: Single Family w/amendment to # 03-1183	Permit Fee:	Cost of Work: \$0.00	CEO District: 3
-----------------------------------	--	--------------------	--------------------------------	---------------------------

FIRE DEPT: <input type="checkbox"/> Approved <input type="checkbox"/> Denied	INSPECTION: Use Group: <i>R3</i> Type: <i>SB</i> <i>BOA 11/24/03</i>
Signature:	Signature: <i>JMB 11/24/03</i>

Proposed Project Description:
Amend permit # 03-1183 to change roof from hip to shed style

PEDESTRIAN ACTIVITIES DISTRICT (P.A.D.)

Action: Approved Approved w/Conditions Denied

Signature: _____ Date: _____

Permit Taken By: jmb	Date Applied For: 11/24/2003	Zoning Approval
--------------------------------	--	------------------------

<ol style="list-style-type: none"> This permit application does not preclude the Applicant(s) from meeting applicable State and Federal Rules. Building permits do not include plumbing, septic or electrical work. Building permits are void if work is not started within six (6) months of the date of issuance. False information may invalidate a building permit and stop all work.. 	Special Zone or Reviews <input type="checkbox"/> Shoreland <input type="checkbox"/> Wetland <input type="checkbox"/> Flood Zone <input type="checkbox"/> Subdivision <input type="checkbox"/> Site Plan Maj <input type="checkbox"/> Minor <input type="checkbox"/> MM <input type="checkbox"/> Date: <i>JMB 11/24/03</i>	Zoning Appeal <input type="checkbox"/> Variance <input type="checkbox"/> Miscellaneous <input type="checkbox"/> Conditional Use <input type="checkbox"/> Interpretation <input type="checkbox"/> Approved <input type="checkbox"/> Denied Date: _____	Historic Preservation <input type="checkbox"/> Not in District or Landmark <input type="checkbox"/> Does Not Require Review <input checked="" type="checkbox"/> Requires Review <input checked="" type="checkbox"/> Approved <input type="checkbox"/> Approved w/Conditions <input type="checkbox"/> Denied To P.A. 11/24/03 Date: <i>D. Andrews 12/2/03</i>
	<i>Approved</i> <i>orig permit # 03-1183</i> <i>same conditions</i>		

CERTIFICATION

I hereby certify that I am the owner of record of the named property, or that the proposed work is authorized by the owner of record and that I have been authorized by the owner to make this application as his authorized agent and I agree to conform to all applicable laws of this jurisdiction. In addition, if a permit for work described in the application is issued, I certify that the code official's authorized representative shall have the authority to enter all areas covered by such permit at any reasonable hour to enforce the provision of the code(s) applicable to such permit.

SIGNATURE OF APPLICANT	ADDRESS	DATE	PHONE
RESPONSIBLE PERSON IN CHARGE OF WORK, TITLE		DATE	PHONE

All Purpose Building Permit Application

If you or the property owner owes real estate or personal property taxes or user charges on any property within the City, payment arrangements must be made before permits of any kind are accepted.

Location/Address of Construction: <u>306 Spring</u>		
Total Square Footage of Proposed Structure		Square Footage of Lot
Tax Assessor's Chart, Block & Lot Chart# <u>56</u> Block# <u>I</u> Lot# <u>1</u>	Owner: <u>Helio Medina</u>	Telephone:
Lessee/Buyer's Name (if Applicable)	Applicant name, address & telephone:	Cost Of Work: \$ <u>N/A</u> Fee: \$ <u>30.00</u>
Current use: <u>SF</u>		
If the location is currently vacant, what was prior use: _____		
Approximately how long has it been vacant: <u>SF</u>		
Proposed use: _____		
Project description: <u>Amend Permit # 031183 To change Roof to shed style</u>		
Contractor's name, address & telephone:		
Who should we contact when the permit is ready: <u>Brad Brewer</u>		
Mailing address:		
We will contact you by phone when the permit is ready. You must come in and pick up the permit and review the requirements before starting any work, with a Plan Reviewer. A stop work order will be issued and a \$100.00 fee if any work starts before the permit is picked up. PHONE: <u>666-8932</u>		

Owes

IF THE REQUIRED INFORMATION IS NOT INCLUDED IN THE SUBMISSIONS THE PERMIT WILL BE AUTOMATICALLY DENIED AT THE DISCRETION OF THE BUILDING/PLANNING DEPARTMENT, WE MAY REQUIRE ADDITIONAL INFORMATION IN ORDER TO APPROVE THIS PERMIT.

I hereby certify that I am the Owner of record of the named property, or that the owner of record authorizes the proposed work and that I have been authorized by the owner to make this application as his/her authorized agent. I agree to conform to all applicable laws of this jurisdiction. In addition, if a permit for work described in this application is issued, I certify that the Code Official's authorized representative shall have the authority to enter all areas covered by this permit at any reasonable hour to enforce the provisions of the codes applicable to this permit.

Signature of applicant:	Date:
-------------------------	-------

**This is NOT a permit, you may not commence ANY work until the permit is issued.
If you are in a Historic District you may be subject to additional permitting and fees with the Planning Department on the 4th floor of City Hall**

Home Owners Wanted this Shed Roof Design instead of the
 Hip Roof, to have Tapered Domes to get into the Berms

Approx 1 1/2" pitch on
 metal Roofing

6" Long →
 16 of in the
 Sheds of Home
 (18 total)

EXISTING
 Home

Also, I put
 Joist hangers on

Done with
 Berms

1 of 2

cannot
 modify

4 1/2" dia.
 Roof

4 1/2" dia.
 Roof

approx 1 1/2" pitch

2x4

2x4

PERMIT # 031183
 TAX # OSC - 1001001

Jane Burke
 874-8715

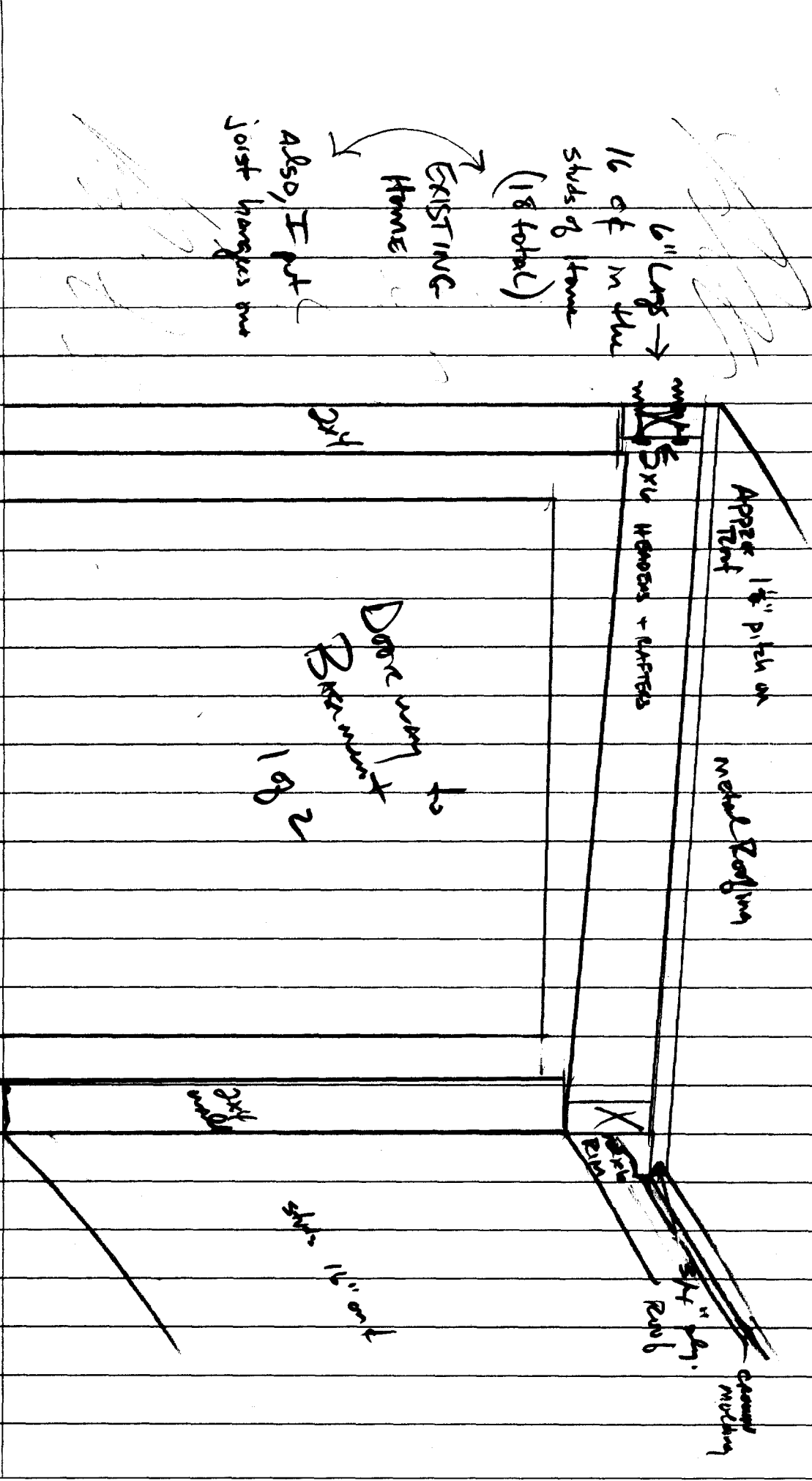

DISPLAY THIS CARD ON PRINCIPAL FRONTAGE OF WORK CITY OF PORTLAND

Please Read
Application And
Notes, If Any,
Attached

BUILDING INSPECTION

PERMIT ISSUED

PERMIT

Permit Number: 031447

DEC 03 2003

This is to certify that Medina Helio /Brewer, Brad
has permission to Amend permit # 03-1183 to change roof from hip to shed style
AT 306 Spring St 056 I001001

CITY OF PORTLAND

provided that the person or persons, firm or corporation accepting this permit shall comply with all of the provisions of the Statutes of Maine and of the ordinances of the City of Portland regulating the construction, maintenance and use of buildings and structures, and of the application on file in this department.

Apply to Public Works for street line and grade if nature of work requires such information.

Notification of inspection must be given and work on permit must be completed before this building or part thereof is closed or enclosed-in. **48 HOUR NOTICE IS REQUIRED.**

A certificate of occupancy must be procured by owner before this building or part thereof is occupied.

OTHER REQUIRED APPROVALS

Fire Dept. _____
Health Dept. _____
Appeal Board _____
Other _____
Department Name

Jamie Burke 12/3/03
Director - Building & Inspection Services

PENALTY FOR REMOVING THIS CARD