

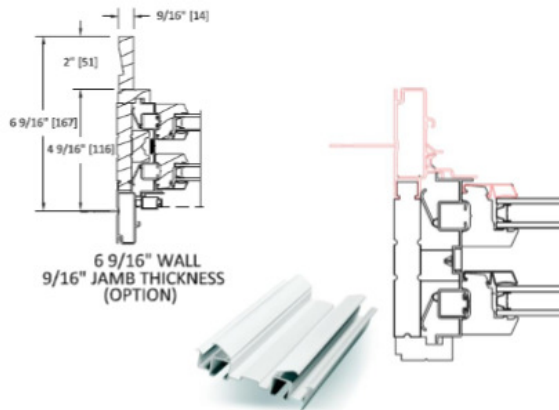

## W-2500™ Clad Double-Hung

### Frame

- AuraLast® Pine
- Jambs 4-9/16", 6-9/16" and 7-9/16"
- Jamb Liner – Compression
- Front View / Hidden Jamb Liner
- Screen Frames Match Cladding Color



AuraLast™





|           |  |
|-----------|--|
| QUOTE     | CW 40  |
| VER       | 1  |
| DESC      | Reviewed for Code Compliance<br>Permitting and Inspections |
| DATE      | 10/03/18<br><del>02/10/2018</del>                          |
| PAGE      | 1  |
| ID        | marshaj  |
| TERRITORY | X  |

PHONE: 800-246-9131 FAX: 877-893-7609  
 EMAIL: THDWOODWINDOWSUPPORT@JELD-WEN.COM  
 SOLD TO: 038108  
 THE HOME DEPOT  
 PO BOX 105524 DEPT 30  
 ATLANTA, GA 30348-5524

SHIP TO: 038615  
 THE HOME DEPOT #2401  
 245 RIVERSIDE STREET  
 PORTLAND, ME 04103

SHPCONT:TERRY CAL 207-761-0600 DEPT.30

| EXPIRE DATE | YOUR PO | SHIP VIA | P/C | TERMS |
|-------------|---------|----------|-----|-------|
| 12/02/2018  |         |          | ppd |       |

| LINE | DESCRIPTION | QTY | ORD | LIST PRICE | DIS % | NET PRICE | EXT PRICE |
|------|-------------|-----|-----|------------|-------|-----------|-----------|
|------|-------------|-----|-----|------------|-------|-----------|-----------|

To: STEVE  
 E-Mail: REP  
 Quote Number: 400230  
 Quote Header: HD2401-100318-WDH-STEVE

All prices are at list.

This quote has been processed with the information you provided. Please carefully review and confirm all specifications. If corrections are needed, please note the changes on the quote and/or drawings and return the entire quote back to thdwoodwindowsupport@jeld-wen.com.

For ordering purposes, please use the following SKU(s): 672979

Check with supplier when submitting orders for current lead times.

|   |                 |       |        |  |          |
|---|-----------------|-------|--------|--|----------|
| 1 | 3B2566 45CD3356 | 25.00 | 936.15 |  | 23403.75 |
|---|-----------------|-------|--------|--|----------|

W-4500 2.0 Clad Double Hung, Auralast Pine, Actual Frame  
 Size = 33 3/8 -in X 56 -in, Black Exterior, Primed Interior,  
 Nail Fin (Standard), Color Match Metal DripCap, 4 9/16 Jamb,  
 With-Plow White Jambliner, Standard Double Hung, White  
 Hardware, FSC Certified-Mix Credit PWC-CoC-000408, PG 35,  
 Insulated Low-E 180 Annealed Glass, Protective Film, Argon  
 Filled, Silver Spacer, Neat, 5/8" Putty SDL w/Perm Wood  
 Putty Int BAR, Black SDL, Light Bronze Shadow Bar, Colonial  
 All Lite(s) 3 Wide 2 High Top, 3 Wide 2 High Btm, BetterVue  
 Mesh Black Screen Half Screen, US National-WDMA/ASTM, One  
 Lock GlassThick=0.7095, Clear Opening:29.8w, 24.3h, 5 sf  
 [NFRC - U-fact:0.31 SHGC:.45 VLT:.51 CR:58 CPD

Continued On Next Page



**JELD WEN**  
WINDOWS & DOORS

QUOTE

|           |          |  |
|-----------|----------|--|
| QUOTE     | CW 40    |  |
| VER       | 1        |  |
| DESC      |          | Reviewed for Code Compliance<br>Permitting and Inspections                       |
| DATE      | 10/03/18 | 02/10/2018   |
| PAGE      |          | 2  |
| ID        | marshaj  |  |
| TERRITORY | X        |  |

PHONE: 800-246-9131 FAX: 877-893-7609  
 EMAIL: THDWOODWINDOWSUPPORT@JELD WEN.COM  
 SOLD TO: 038108  
 THE HOME DEPOT  
 PO BOX 105524 DEPT 30  
 ATLANTA, GA 30348-5524

SHIP TO: 038615  
 THE HOME DEPOT #2401  
 245 RIVERSIDE STREET  
 PORTLAND , ME 04103

SHPCONT:TERRY CAL 207-761-0600 DEPT.30

| EXPIRE DATE | YOUR PO | SHIP VIA | P/C | TERMS |
|-------------|---------|----------|-----|-------|
| 12/02/2018  |         |          | ppd |       |

| LINE | DESCRIPTION | QTY | ORD | LIST PRICE | DIS % | NET PRICE | EXT PRICE |
|------|-------------|-----|-----|------------|-------|-----------|-----------|
|------|-------------|-----|-----|------------|-------|-----------|-----------|

#:JEL-N-714-03229-00001]

Pcs 25.00

SUB-TOTAL 0.00  
 23,403.75

TOTAL IN USD 23,403.75

NOTE: When submitting a purchase order referencing the quote (placing an order), this constitutes acknowledgement that you have provided the applicable warranty to the purchaser and thoroughly reviewed the quote and accept that it is accurate to meet the needs of your customer (e.g. size, options, performance ratings to meeting code requirements, etc.).

TOTAL VOLUME: 234      TOTAL WEIGHT: 1,267      EQUIVALENTS: 75