

FLOOR PLAN @ BASEMENT
 1/4" = 1'-0"

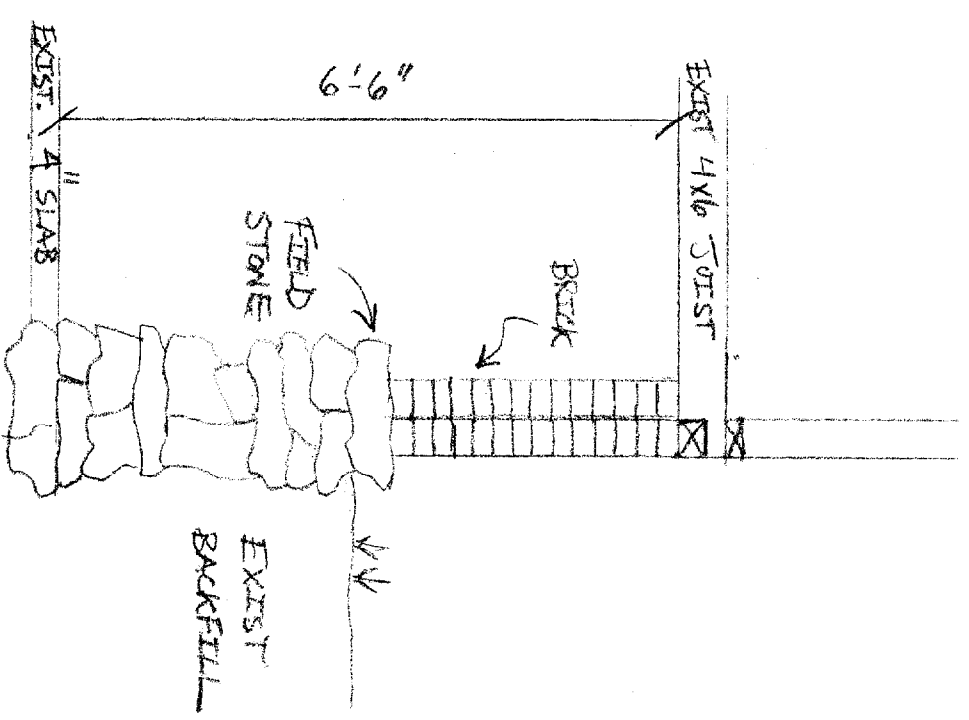

EXISTING FOUNDATION
 1/2" = 1'-0"

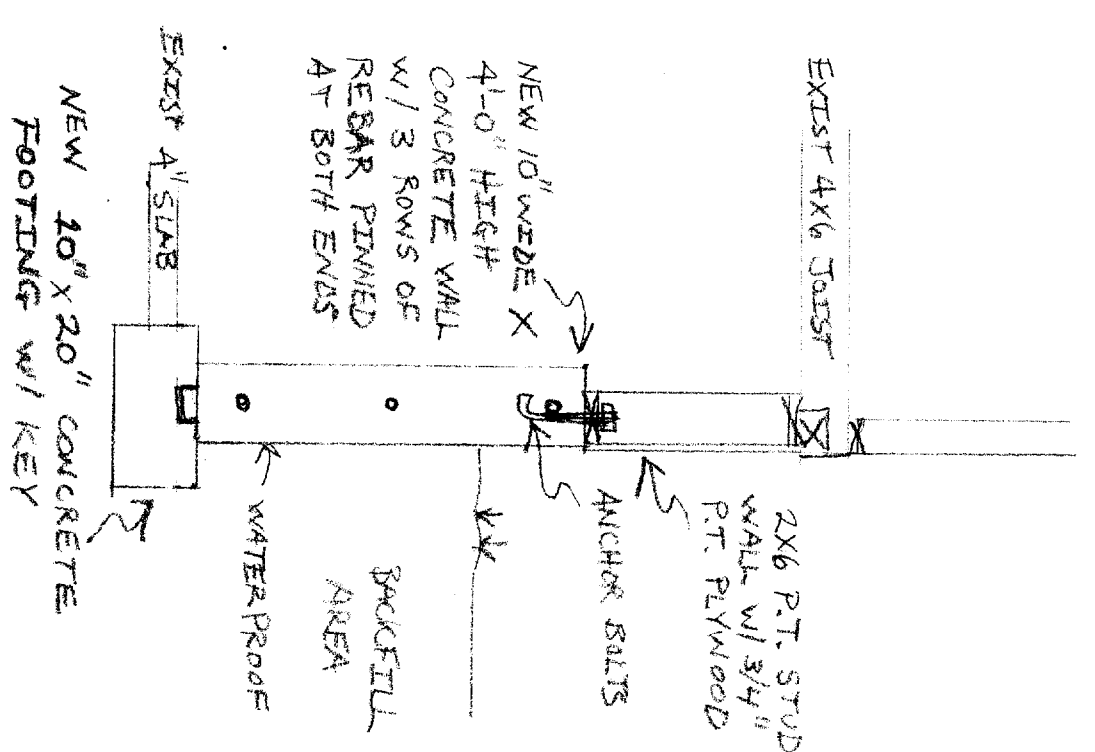

PROPOSED FOUNDATION
 1/2" = 1'-0"

PROPOSED REPAIRS TO
 COLLAPSING STONE FOUNDATION
 @ 52 SPRUCE STREET
 DATE: 4/6/04
 CONTACT: JEFF BARTLETT