

1 EXISTING FOUNDATION REMOVALS PLAN
 SD101 SCALE: 1/8"=1'-0"
 PLAN NORTH

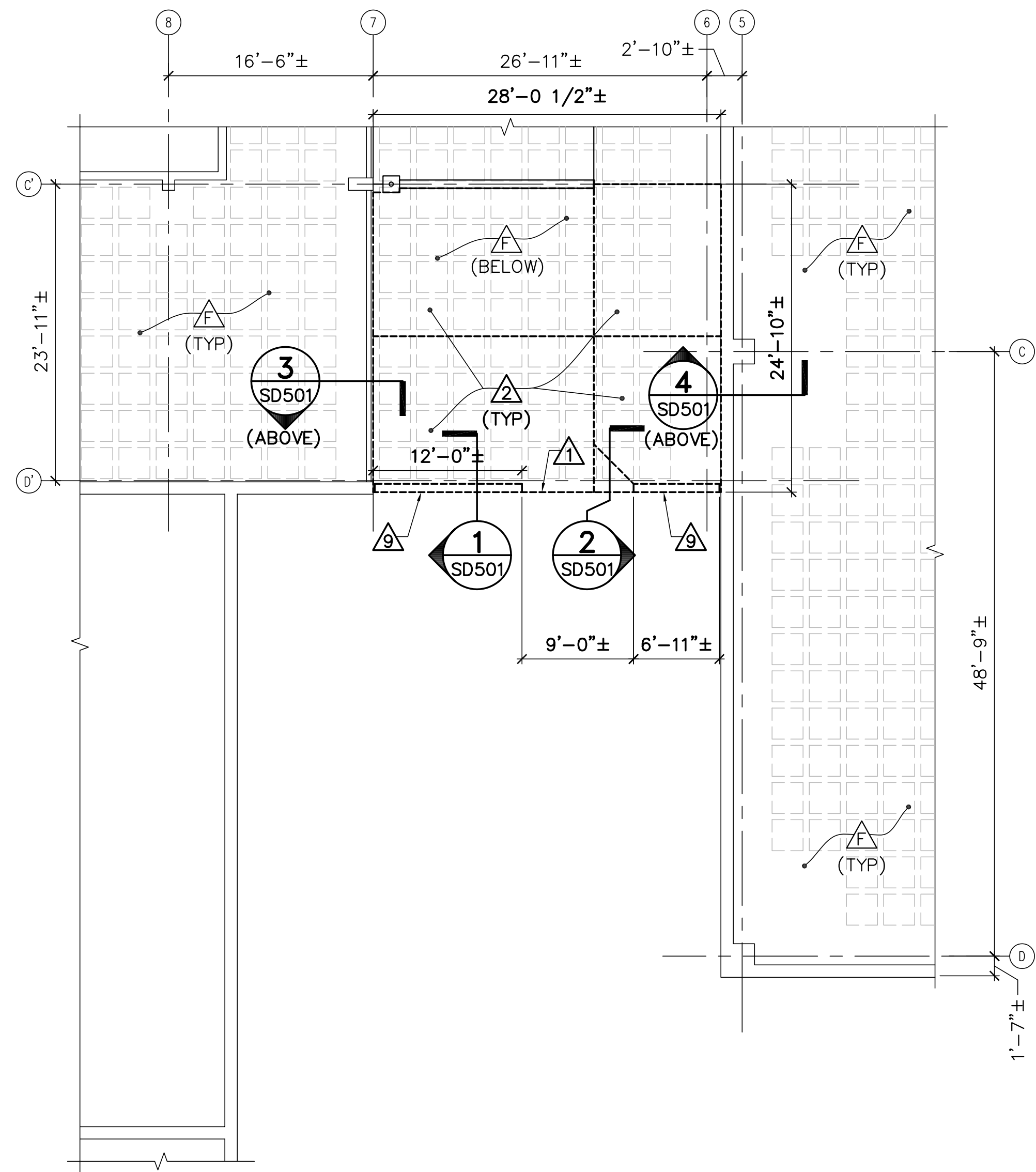

2 EXISTING 2ND FLOOR FRAMING REMOVALS PLAN
 SD101 SCALE: 1/8"=1'-0"
 PLAN NORTH

GENERAL SHEET NOTES:

1. PROVIDE TEMPORARY BARRICADES AND SIGNAGE AT EGRESS DOORS IMPACTED BY CONSTRUCTION. MAINTAIN UNTIL NEW PERMANENT EGRESS IS ESTABLISHED AND APPROVED BY OWNER.
2. PROVIDE TEMPORARY BARRICADES, FENCING, AND FALL PROTECTION MEASURES AS APPROVED BY OWNER AT EXISTING ROOF TERRACE ONCE THE ELEVATED WALKWAY IS REMOVED.
3. EXISTING BOTTOM OF FOOTINGS ARE APPROXIMATELY 4 TO 5 FEET BELOW GRADE.
4. PROVIDE WEATHER PROTECTION MEASURES FOR REMOVAL OF EXISTING CONCRETE TOPPING SLAB. MAINTAIN MEASURES UNTIL ADDITION IS COMPLETE.

EXISTING KEYNOTES: (THIS SHEET ONLY)

- A EXISTING CONTINUOUS 1'-0"± x 2'-0"± REINFORCED CONCRETE FOOTING.
- B EXISTING REINFORCED CONCRETE COLUMN FOOTING (SIZES VARY).
- C EXISTING REINFORCED CONCRETE FOUNDATION WALLS.
- D EXISTING REINFORCED CONCRETE TRENCH BELOW SLAB-ON-GRADE.
- E EXISTING 4"± THICK REINFORCED CONCRETE SLAB-ON-GRADE. TOP OF SLAB ELEVATION AS NOTED WITH KEYNOTE.
- F EXISTING REINFORCED CONCRETE 2-WAY WAFFLE SLAB.
- G EXISTING REINFORCED CONCRETE STAIRS.
- H EXISTING CONCRETE PIER BELOW GRADE.

REMOVALS KEYNOTES: (THIS SHEET ONLY)

- 1 REMOVE EXISTING METAL EXPANSION JOINT SYSTEM. SEE DETAIL 2/SD501.
- 2 REMOVE EXISTING 2-1/2"± THICK REINFORCED CONCRETE TOPPING SLAB.
- 3 SAWCUT AND REMOVE EXISTING 1'-0"± WIDE x 2'-0"± LONG REINFORCED CONCRETE PIER TO 1'-6"± BELOW FINISH GRADE.
- 4 REMOVE EXISTING REINFORCED CONCRETE STOOP, 8"± CONCRETE WALLS, 6"± CONCRETE SLAB, AND 1'-0"± x 2'-0"± CONCRETE FOOTING.
- 5 REMOVE EXISTING REINFORCED CONCRETE PLANTER FOUNDATION WALLS AND FOOTING.
- 6 REMOVE EXISTING 1'-0"± x 3'-0"± x 3'-0"± REINFORCED CONCRETE FOOTING.
- 7 REMOVE EXISTING 1'-0"± THICK x 2'-0"± WIDE CONTINUOUS REINFORCED CONCRETE FOOTING.
- 8 REMOVE EXISTING 1'-0"± WIDE REINFORCED CONCRETE FOUNDATION WALL.
- 9 SAWCUT AND REMOVE EXISTING 8"± WIDE x 3'-0"± HIGH REINFORCED CONCRETE RAMP WALL. SEE DETAIL 1/SD501.

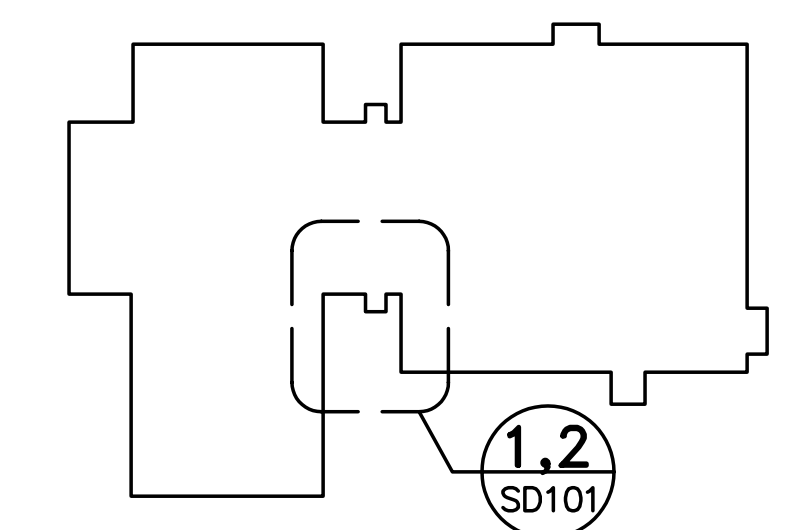

KEY PLAN
 NOT TO SCALE
 PLAN NORTH

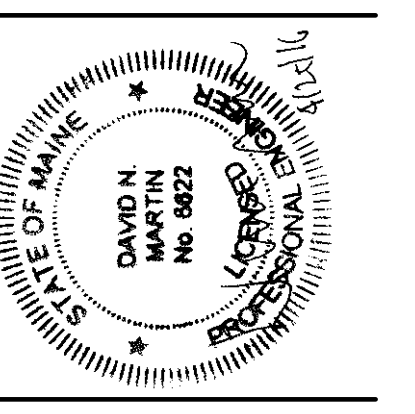
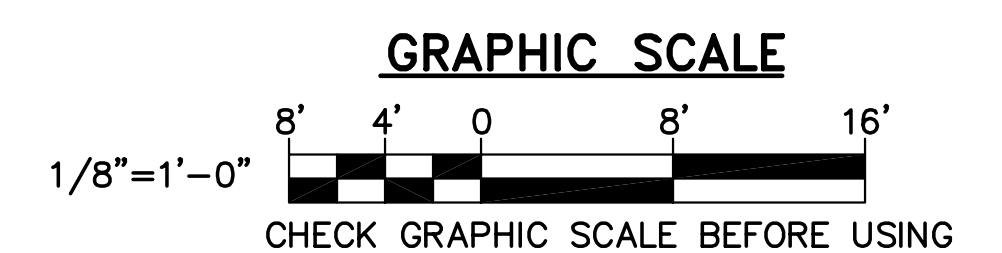

DESIGNED BY: WFG
 DRAWN BY: MJC
 CHECKED BY: DNM
 PROJECT: 21602.06

**REICHE ELEMENTARY SCHOOL
 PORTLAND SCHOOL DEPARTMENT**
 353 Cumberland Avenue
 Portland, ME 04102

**REICHE ELEMENTARY
 ELEVATOR ADDITION**
 166 Brackett Street
 Portland, ME 04102

**EXISTING FOUNDATION
 AND 2ND FLOOR FRAMING
 REMOVALS PLAN**

SCALE: AS NOTED
 DATE: 04-26-2016

DWG.: **SD101**

SHEET: **6** OF **40**