

DISPLAY THIS CARD ON PRINCIPAL FRONTAGE OF WORK

CITY OF PORTLAND

BUILDING INSPECTION

PERMIT

Permit Number: 090309

Please Read
Application And
Notes, If Any.
AttachedThis is to certify that City Of Portland/Jaime Parkerhas permission to Build gazebo (wooden arbor) for schoolyard greening project.AT 132 Brackett St

CE 056 E001001

provided that the person or persons, firm or corporation accepting this permit shall comply with all of the provisions of the Statutes of Maine and of the Ordinances of the City of Portland regulating the construction, maintenance and use of buildings and structures, and of the application on-file in this department.

Apply to Public Works for street line and grade if nature of work requires such information.

Notification of inspection must be given and written permission procured before this building or part thereof is lathed or otherwise red-in. 24 HOURS NOTICE IS REQUIRED.

A certificate of occupancy must be procured by owner before this building or part thereof is occupied.

OTHER REQUIRED APPROVALS

Fire Dept. CAPT. Keith Fautreaux

Health Dept. _____

Appeal Board _____

Other _____

Department Name

Director - Building & Inspection Services

PENALTY FOR REMOVING THIS CARD

City of Portland, Maine - Building or Use Permit Application

389 Congress Street, 04101 Tel: (207) 874-8703, Fax: (207) 874-8716

Permit No: 09-0309	Issue Date:	CBL: 056 E001001
-----------------------	-------------	---------------------

Location of Construction: 132 Brackett St	Owner Name: City Of Portland	Owner Address: 389 Congress St	Phone:
Business Name:	Contractor Name: Jaime Parker	Contractor Address: 305 Commercial Street Portland	Phone: 2077752411
Lessee/Buyer's Name	Phone:	Permit Type: Institutional	Zone: R-5

Past Use: Institutional / Reiche School	Proposed Use: Reiche School / Build gazebo (wooden arbor) for schoolyard greening project.	Permit Fee: \$0.00	Cost of Work: \$0.00	CEO District: 2
Proposed Project Description: Build gazebo (wooden arbor) for schoolyard greening project.		FIRE DEPT: <input checked="" type="checkbox"/> Approved <input type="checkbox"/> Denied	INSPECTION: Use Group: U Type: SB TBC 2003 Signature: <i>[Signature]</i>	
		PEDESTRIAN ACTIVITIES DISTRICT (P.A.D.) Action: <input type="checkbox"/> Approved <input type="checkbox"/> Approved w/Conditions <input type="checkbox"/> Denied Signature: _____ Date: _____		

Permit Taken By: gg	Date Applied For: 04/13/2009	Zoning Approval		
<ol style="list-style-type: none"> This permit application does not preclude the Applicant(s) from meeting applicable State and Federal Rules. Building permits do not include plumbing, septic or electrical work. Building permits are void if work is not started within six (6) months of the date of issuance. False information may invalidate a building permit and stop all work.. 		Special Zone or Reviews <input type="checkbox"/> Shoreland <input type="checkbox"/> Wetland <input type="checkbox"/> Flood Zone <input type="checkbox"/> Subdivision <input checked="" type="checkbox"/> Site Plan Exemption 7225 - 0101 Maj <input type="checkbox"/> Minor <input type="checkbox"/> MM <input type="checkbox"/> OK w/condition Date: 4/29/09 ABR	Zoning Appeal <input type="checkbox"/> Variance <input type="checkbox"/> Miscellaneous <input type="checkbox"/> Conditional Use <input type="checkbox"/> Interpretation <input type="checkbox"/> Approved <input type="checkbox"/> Denied Date: _____	Historic Preservation Y3 <input type="checkbox"/> Not in District or Landmark <input type="checkbox"/> Does Not Require Review <input type="checkbox"/> Requires Review <input checked="" type="checkbox"/> Approved <input type="checkbox"/> Approved w/Conditions <input type="checkbox"/> Denied Date: 4/29/09 D. Andrews

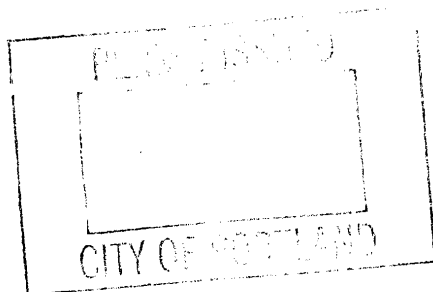

CERTIFICATION

I hereby certify that I am the owner of record of the named property, or that the proposed work is authorized by the owner of record and that I have been authorized by the owner to make this application as his authorized agent and I agree to conform to all applicable laws of this jurisdiction. In addition, if a permit for work described in the application is issued, I certify that the code official's authorized representative shall have the authority to enter all areas covered by such permit at any reasonable hour to enforce the provision of the code(s) applicable to such permit.

SIGNATURE OF APPLICANT	ADDRESS	DATE	PHONE
RESPONSIBLE PERSON IN CHARGE OF WORK, TITLE		DATE	PHONE

City of Portland, Maine - Building or Use Permit

389 Congress Street, 04101 Tel: (207) 874-8703, Fax: (207) 874-8716

Permit No: 09-0309	Date Applied For: 04/13/2009	CBL: 056 E001001
-----------------------	---------------------------------	---------------------

Location of Construction: 132 Brackett St	Owner Name: City Of Portland	Owner Address: 389 Congress St	Phone:
Business Name:	Contractor Name: Jaime Parker	Contractor Address: 305 Commercial Street Portland	Phone (207) 775-2411
Lessee/Buyer's Name	Phone:	Permit Type: Institutional	

Proposed Use: Reiche School / Build gazebo (wooden arbor) for schoolyard greening project.	Proposed Project Description: Build gazebo (wooden arbor) for schoolyard greening project.
---	---

Dept: Historic	Status: Approved	Reviewer: Deborah Andrews	Approval Date: 04/29/2009
Note:			Ok to Issue: <input checked="" type="checkbox"/>
Dept: Zoning	Status: Approved with Conditions	Reviewer: Ann Machado	Approval Date: 04/29/2009
Note:			Ok to Issue: <input checked="" type="checkbox"/>
1) ANY exterior work requires a separate review and approval thru Historic Preservation. This property is located within an Historic District.			
2) This permit is being approved on the basis of plans submitted. Any deviations shall require a separate approval before starting that work.			
Dept: Building	Status: Approved	Reviewer: Tammy Munson	Approval Date: 05/08/2009
Note:			Ok to Issue: <input checked="" type="checkbox"/>
Dept: Fire	Status: Approved	Reviewer: Capt Keith Gautreau	Approval Date: 04/29/2009
Note:			Ok to Issue: <input checked="" type="checkbox"/>

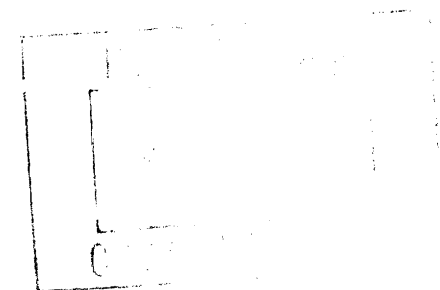



General Building Permit Application

If you or the property owner owes real estate or personal property taxes or user charges on any property within the City, payment arrangements must be made before permits of any kind are accepted.

Location/Address of Construction: <u>166 Brackett St (132)</u>		
Total Square Footage of Proposed Structure/Area <u>430 SF</u>		Square Footage of Lot <u>city block</u>
Tax Assessor's Chart, Block & Lot Chart# Block# Lot# <u>56 E 001 001</u> <u>45 E - 031001</u>	Applicant * must be owner , Lessee or Buyer* Name <u>Reiche School</u> <u>Marcia Gendron</u> Address <u>166 Brackett St</u> City, State & Zip <u>Portland ME 04102</u>	Telephone: <u>874-8175</u>
Lessee/DBA (If Applicable) <u>NIA</u>	Owner (if different from Applicant) Name Address City, State & Zip	Cost Of Work: \$ <u>NIA-City</u> C of O Fee: \$ <u>waived per</u> Total Fee: \$ <u>Tammy</u>
Current legal use (i.e. single family) <u>school</u> If vacant, what was the previous use? _____ Proposed Specific use: <u>school garden</u> Is property part of a subdivision? <u>no</u> If yes, please name _____ Project description: <u>Gazebo - wooden arbor</u> <u>Reiche School</u>		
Contractor's name: <u>Jaime Parker</u> Address: <u>305 Commercial St</u> City, State & Zip: <u>Portland ME 04101</u> Telephone: <u>775-2411</u> Who should we contact when the permit is ready: <u>Marcia Gendron</u> Telephone: <u>874-8175</u> Mailing address: <u>Reiche School 166 Brackett St 04102</u>		

Please submit all of the information outlined on the applicable Checklist. Failure to do so will result in the automatic denial of your permit.

In order to be sure the City fully understands the full scope of the project, the Planning and Development Department may request additional information prior to the issuance of a permit. For further information or to download copies of this form and other applications visit the Inspections Division on-line at www.portlandmaine.gov, or stop by the Inspections Division office, room 315 City Hall or call 874-8703.

I hereby certify that I am the Owner of record of the named property, or that the owner of record authorizes the proposed work and that I have been authorized by the owner to make this application as his/her authorized agent. I agree to conform to all applicable laws of this jurisdiction. In addition, if a permit for work described in this application is issued, I certify that the Code Official's authorized representative shall have the authority to enter all areas covered by this permit at any reasonable hour to enforce the provisions of the codes applicable to this permit.

Signature: [Signature] Date: April 10 - 2009

This is not a permit; you may not commence ANY work until the permit is issued.

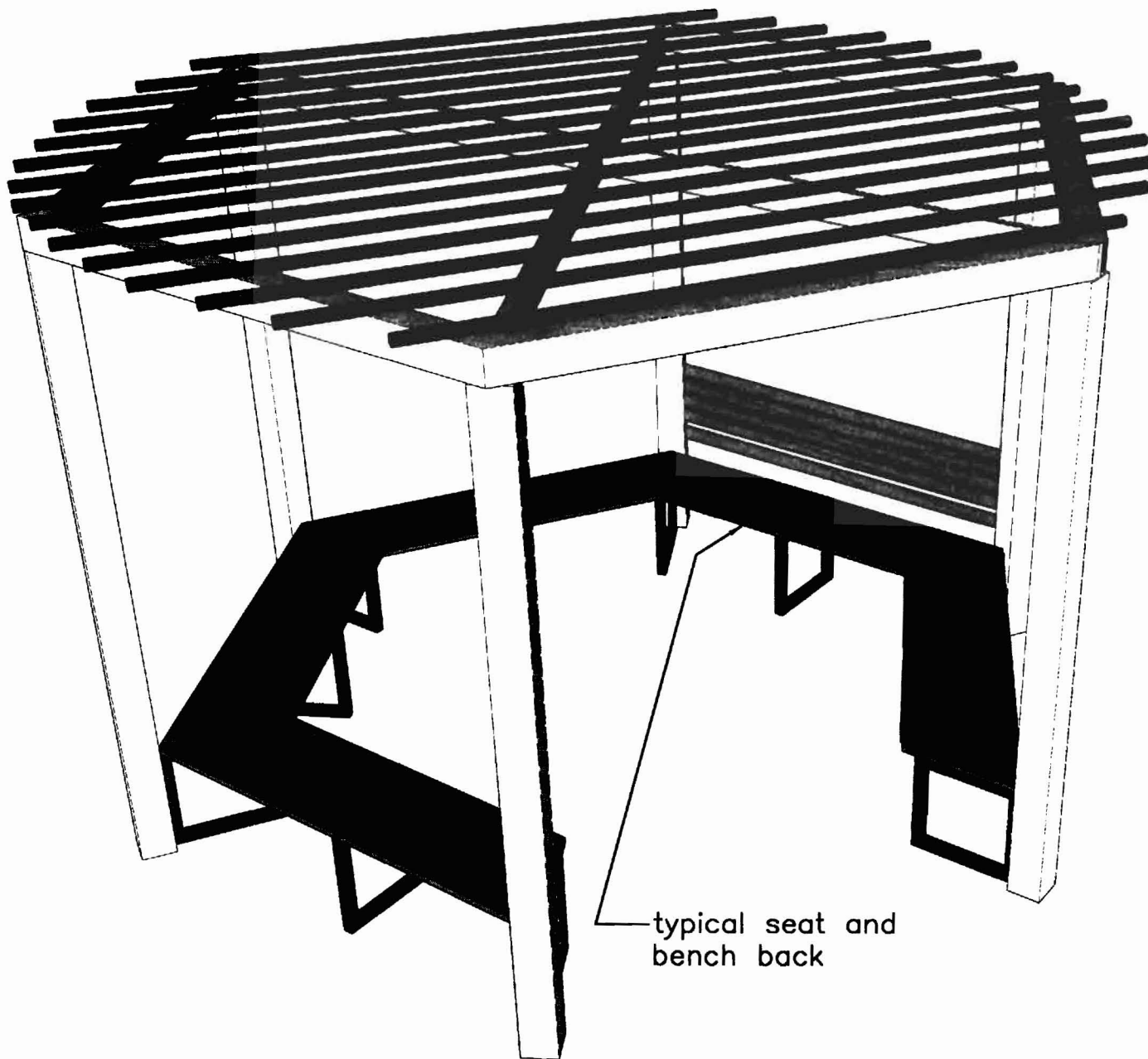

typical seat and
bench back

charlotte maloney
landscape architecture

57 Spruce St.
Portland, ME 04102
207.828.5337
cmaloney@gwi.net

REICHE ELEMENTARY SCHOOL
Portland, Maine

Schoolyard Greening Project - Phase Two

Date:	25FEB09
Project #:	170408
Drawn By:	cmm
Scale:	N.T.S.

SHEET TITLE

Gazebo
Perspective

landscape architecture

57 Spruce St
Portland, ME 04103
207.828.5333
cmaloney@gwi.ne

REICHE ELEMENTARY SCHOOL
Portland, Maine

Schoolyard Greening Project - Phase Two

Date:	25FEB09
Project #:	170408
Drawn By:	cmm
Scale:	N.T.S.

SHEET TITLE

Gazebo
Section/Elevation

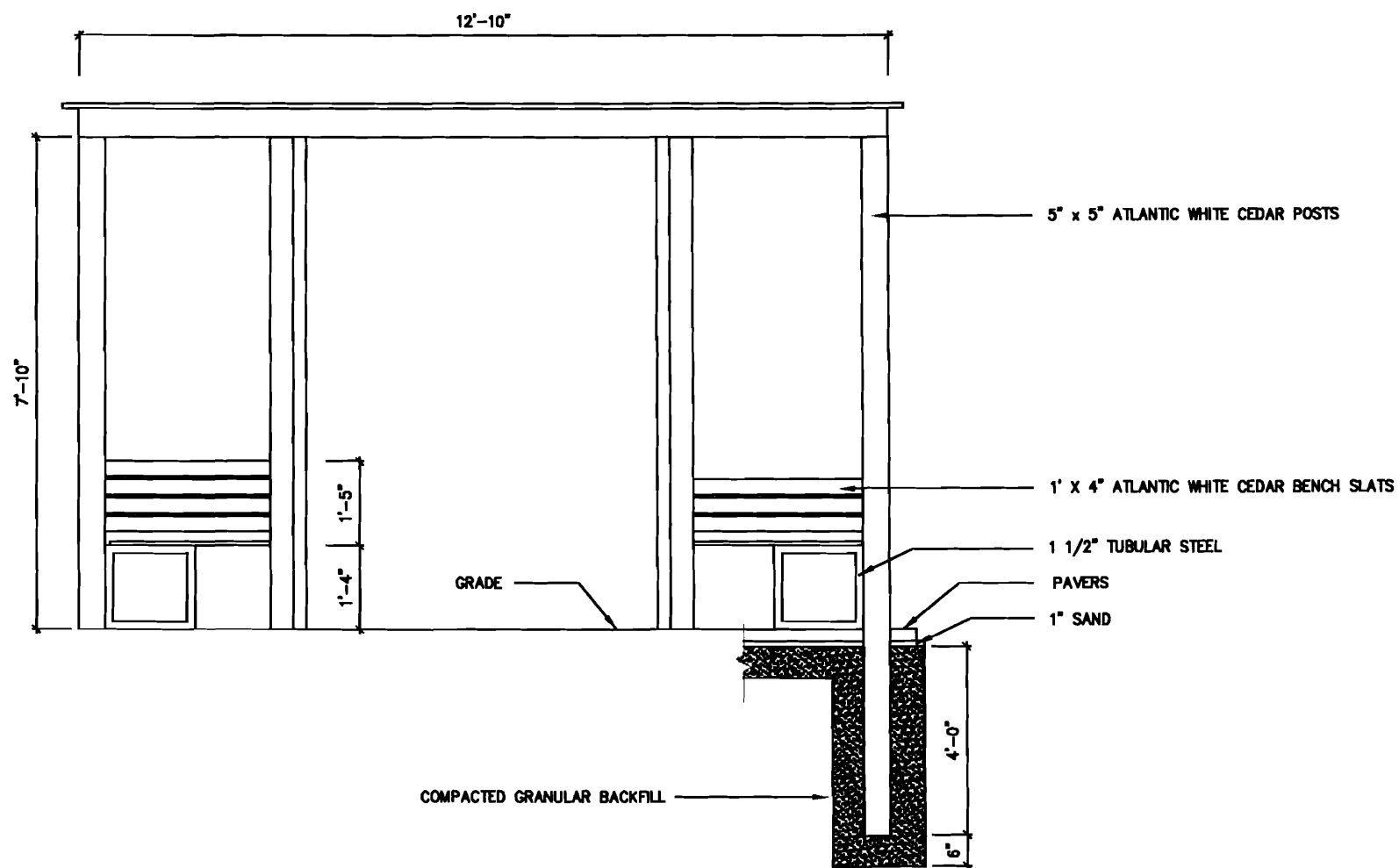

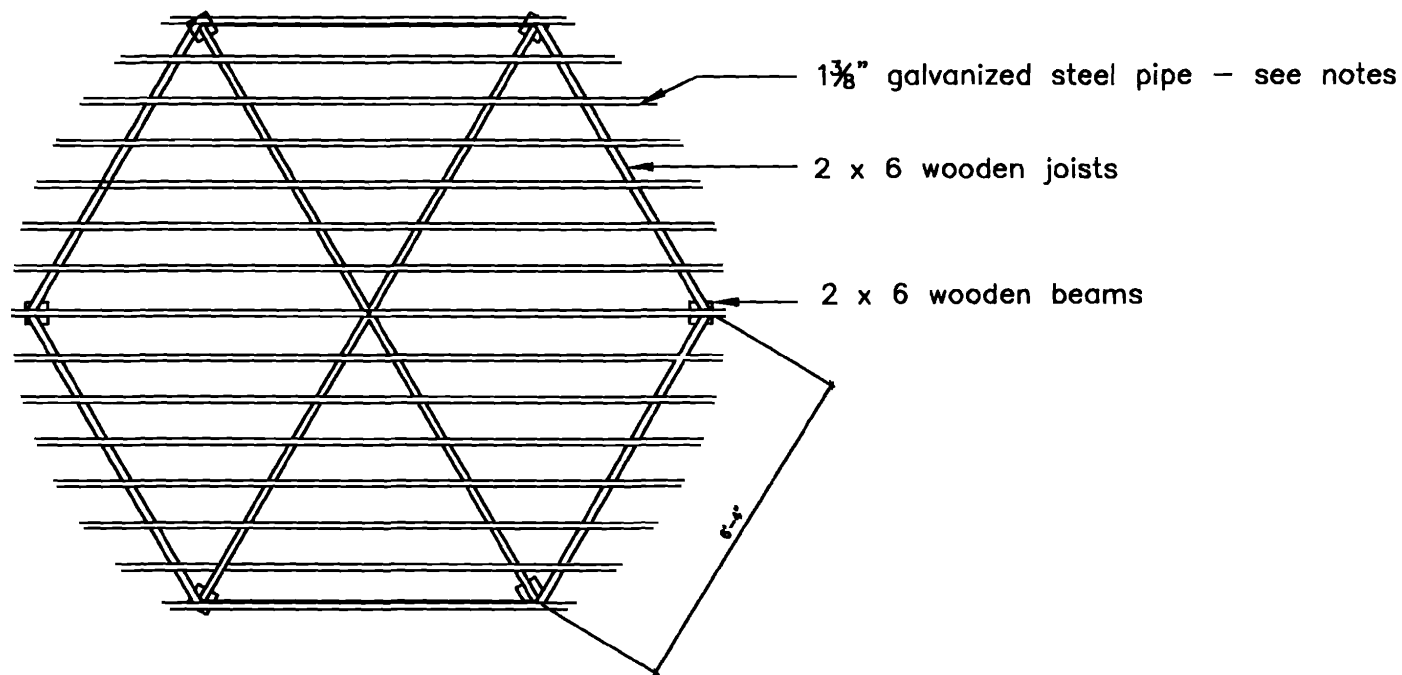

NOTES:

1. Pipe perimeter form a circle of radius 6'-8"; overhangs from beams will vary.
2. Pipe is from the site and is to be reused. Welds required on pieces over 10' long.
Place welded seams on top of joists.
3. Sand pipes and apply three coats of Sherwin Williams System 4000 industrial paint. Colors: TBA
4. Joists and beams are kiln dried Douglas Fir
5. All fastners for wood to be hot-dipped galvanized steel
6. Contractor to determine method of attaching steel pipes to beams and joists

landscape architecture

57 Spruce St
Portland, ME 04101
207.828.5333
cmaloney@gwi.ne

REICHE ELEMENTARY SCHOOL
Portland, Maine

Schoolyard Greening Project - Phase Two

Date:	25FEB09
Project #:	170408
Drawn By:	cmm
Scale:	N.T.S.

SHEET TITLE

Plan View of
Gazebo Top

No. 56

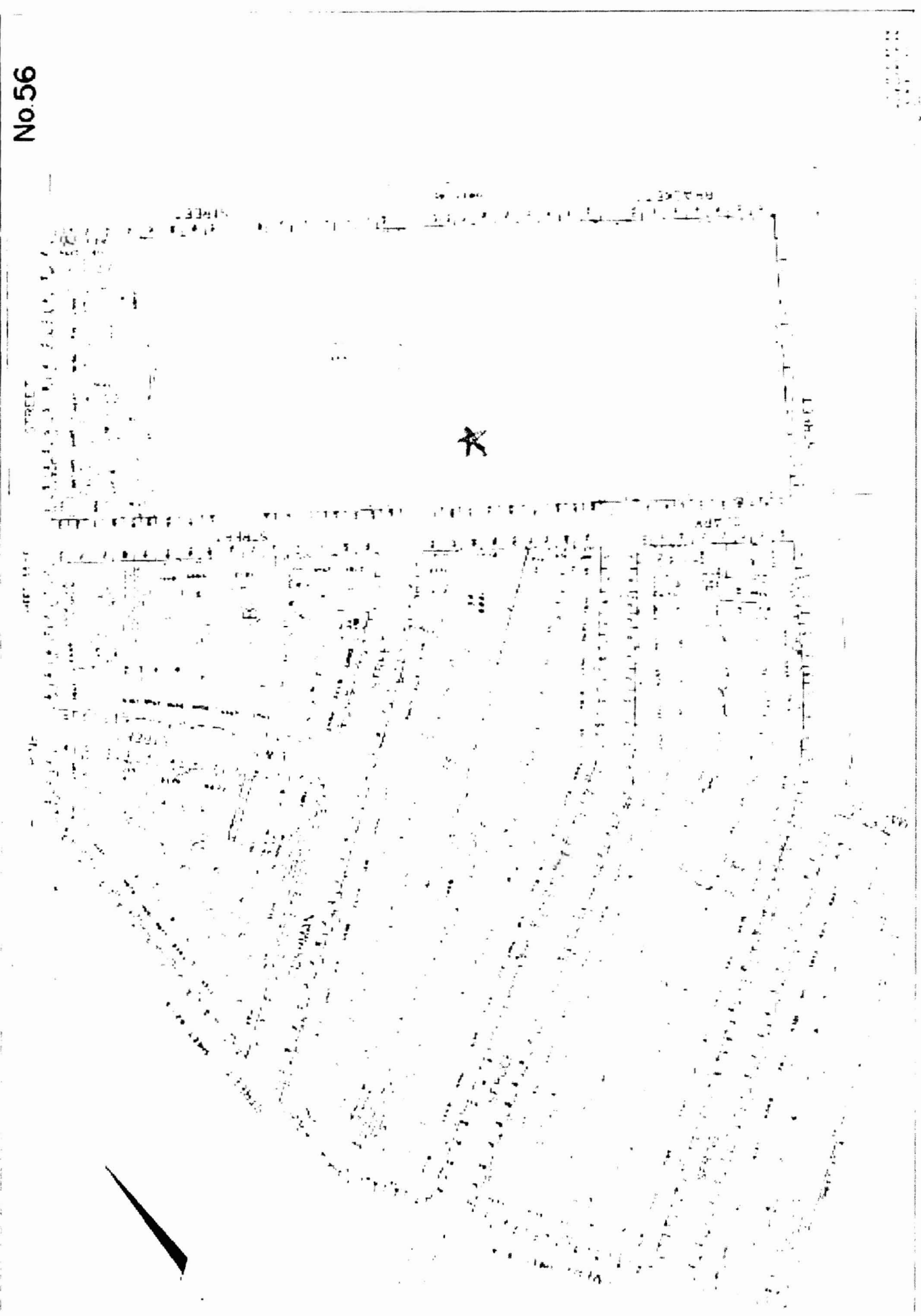

1111 1111 1111

2008-0101



APPLICATION FOR EXEMPTION FROM SITE PLAN REVIEW

Reiche School Marcia Gendron
Applicant

6.25.08
Application Date

166 Brackett
Applicant's Mailing Address

Reiche Outdoor Classroom
Project Name/Description

874-8175
Consultant/Agent/Phone Number

166 Brackett
Address of Proposed Site

CBL: 56 E 001
~~45 E 031001~~

Description of Proposed Development:

Outside teaching/learning area consisting of hardscape and plantings. Wooden arbor to be installed later.

Please Attach Sketch/Plan of Proposal/Development

Criteria for Exemptions:
See Section 14-523 (4) on back side of form

- a) Within Existing Structures; No New Buildings, Demolitions or Additions
- b) Footprint Increase Less Than 500 Sq. Ft.
- c) No New Curb Cuts, Driveways, Parking Areas
- d) Curbs and Sidewalks in Sound Condition/Comply with ADA
- e) No Additional Parking/ No Traffic Increase
- f) No Stormwater Problems
- g) Sufficient Property Screening
- h) Adequate Utilities

Applicant's Assessment (Yes, No, N/A)	Planning Office Use Only
✓ arbor to be installed later	OK
✓	✓
✓	✓
✓	✓
✓	✓
✓	✓
✓	✓
✓	✓

Planning Division Use Only

Exemption Granted Partial Exemption _____ Exemption Denied _____

Planner's Signature: Barbara Barkhoff

Date: July 3, 2008

White - Planning Office

Pink - Inspections

Yellow - Applicant

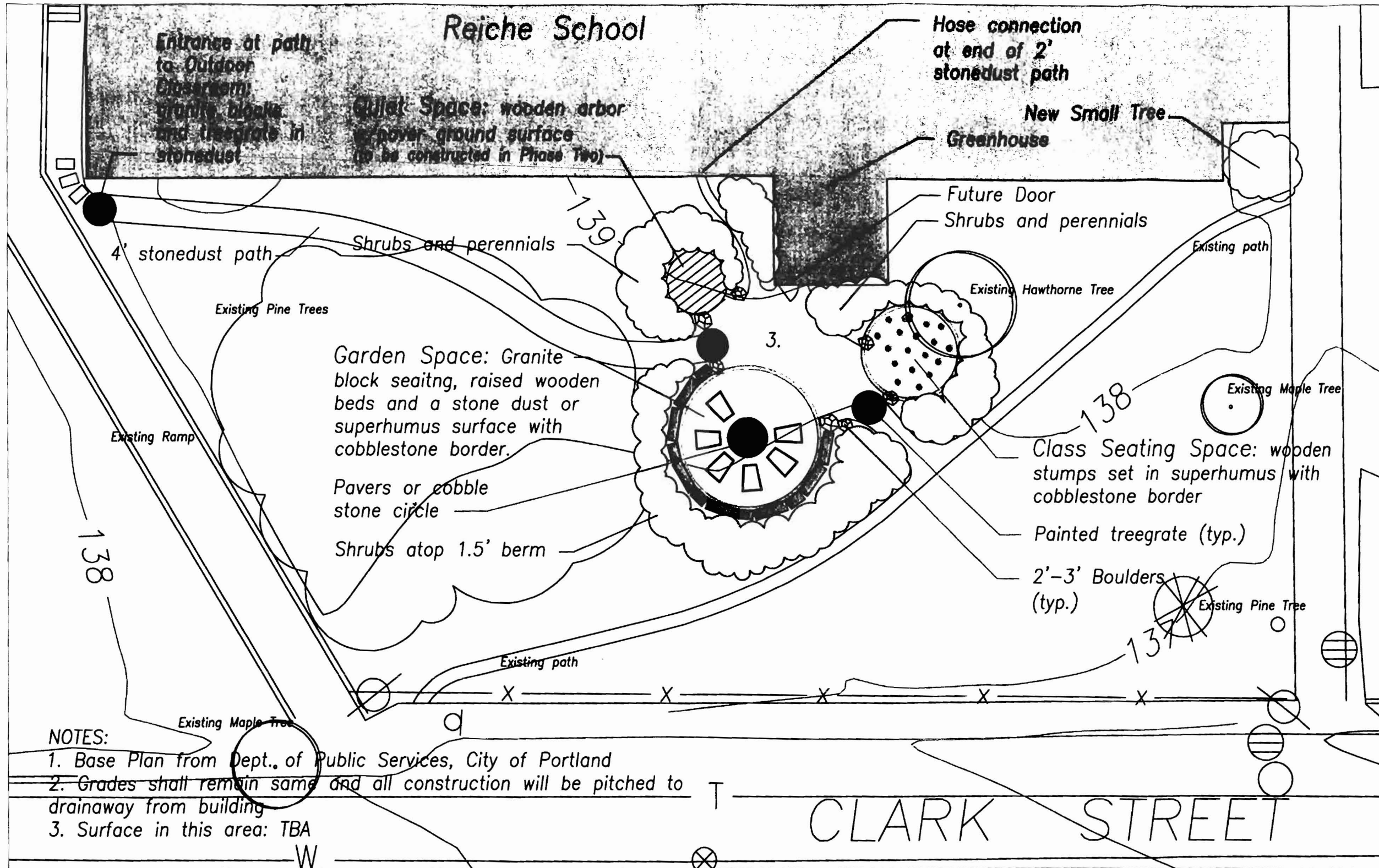

RS
 lot size - 232,550
 rear yard - 20' - 70' g. max
 side yard 5' - ok.
 lot coverage 40% - 53,020
 ok.

70+ feet
 to Clark St
 ROW line

- NOTES:
1. Base Plan from Dept. of Public Services, City of Portland
 2. Grades shall remain same and all construction will be pitched to drainaway from building
 3. Surface in this area: TBA

Reiche Schoolyard Greening Site Plan
 Phase One

1" = 20'

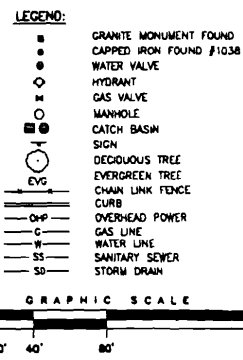
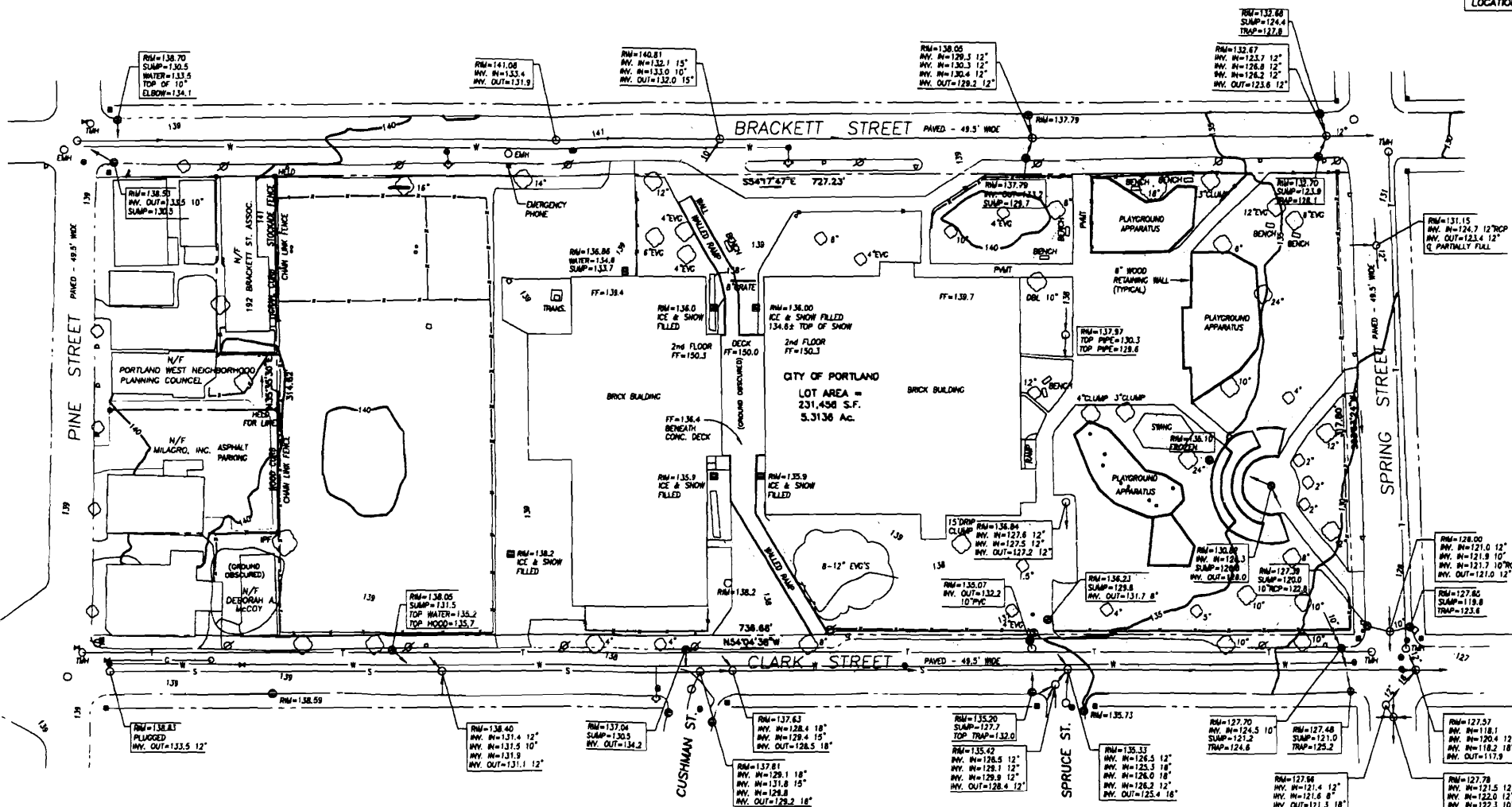
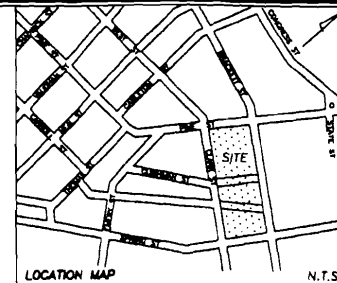
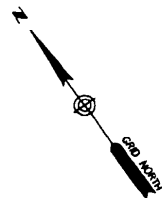

BENCH MARK:
BRASS PLUG IN 6" GRANITE MONUMENT IN CONCRETE RAMP AT THE NORTHWEST CORNER OF CLARK AND SPRING STREETS ELEVATION=127.91'.

UTILITY NOTES:
THE UNDERGROUND UTILITIES SHOWN HAVE BEEN LOCATED FROM FIELD SURVEY INFORMATION AND EXISTING DRAWINGS. THE SURVEYOR MAKES NO GUARANTEE THAT THE UNDERGROUND UTILITIES SHOWN COMPRISE ALL SUCH UTILITIES IN THE AREA, EITHER IN SERVICE OR ABANDONED. THE SURVEYOR FURTHER DOES NOT WARRANT THAT THE UNDERGROUND UTILITIES SHOWN ARE IN THE EXACT LOCATION INDICATED ALTHOUGH HE DOES CERTIFY THAT THEY ARE LOCATED AS ACCURATELY AS POSSIBLE FROM INFORMATION AVAILABLE. THE SURVEYOR HAS NOT PHYSICALLY LOCATED THE UNDERGROUND UTILITIES.

PLAN REFERENCE:
STANDARD BOUNDARY SURVEY ON PINE AND BRACKETT STREETS FOR RICHARD RANAGHAN DATED MARCH 29, 1989 BY OWEN HASKELL, INC.

- NOTES:**
1. STREET LINES ESTABLISHED FROM EXISTING MONUMENTATION AND CITY DATA.
 2. BEARINGS BASED ON GRID NORTH PER COORDINATES PROVIDED BY CITY ENGINEERING DEPARTMENT.
 3. TOPOGRAPHY PROVIDED BY THE CITY OF PORTLAND FROM AERIAL SURVEY. UTILITY LOCATION AND STRUCTURE ELEVATIONS FROM FIELD SURVEY BY THIS FIRM.
 4. ENTIRE SITE IS SNOW AND ICE COVERED OBSCURING GROUND DETAILS.

CERTIFICATION:
OWEN HASKELL, INC. HEREBY CERTIFIES THAT THIS PLAN IS BASED ON, AND THE RESULT OF AN ON THE GROUND FIELD SURVEY AND THAT TO THE BEST OF OUR KNOWLEDGE, INFORMATION AND BELIEF, IT CONFORMS TO THE BOARD OF LICENSURE FOR PROFESSIONAL LAND SURVEYORS STANDARDS FOR A CATEGORY 1, CONDITION II, SURVEY WITH THE FOLLOWING EXCEPTIONS:
NO DEED DESCRIPTION; NO REPORT; NO MARKERS SET

DATE _____ JOHN W. SWAN, PLS #1038

REV. 1 | 02-27-01 | BENCHES, RAMPS, WALKS, TREE IDENTIFICATION

STANDARD BOUNDARY & TOPOGRAPHIC SURVEY
AT
REICHE SCHOOL
PINE ST., BRACKETT ST., SPRING ST. & CLARK ST.
PORTLAND, MAINE
MADE FOR
PORTLAND PARKS & RECREATION DEPT.

OWEN HASKELL, INC.
18 CUMPS ST., PORTLAND, ME 04101 (207) 774-0424
PROFESSIONAL LAND SURVEYORS

Drawn By: JMW	Date: FEB. 2, 2001	Job No.: 2000-239P
Traced By: JLW	Scale: 1" = 40'	Drawn No.: 1
Check By: ECB		
Book No.: 917		