

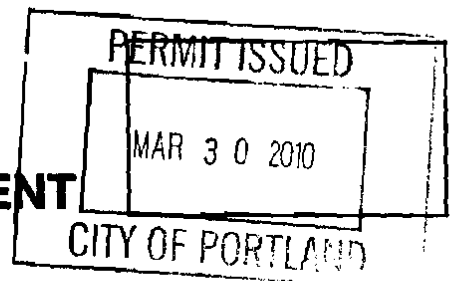

FILL IN AND SIGN WITH INK

**APPLICATION FOR PERMIT
HEATING OR POWER EQUIPMENT**

To the INSPECTOR OF BUILDINGS, PORTLAND, ME.

The undersigned hereby applies for a permit to install the following heating, cooking or power equipment in accordance with the Laws of Maine, the Building Code of the City of Portland, and the following specifications:

Location / CBL 722 Congress ^{SSD6} Use of Building Coffee Shop Date 3/3/10
Name and address of owner of appliance Yond Peon

Installer's name and address David Dubois 139 Glenwood Ave
Portland ME 04103 Telephone 3218837

Location of appliance:

- ☐ Basement ☒ Floor
☐ Attic ☐ Roof

Type of Fuel:

- ☐ Gas ☐ Oil ☐ Solid

Appliance Name: LinnaU.L. Approved ☒ Yes ☐ No

Will appliance be installed in accordance with the manufacture's
installation instructions? ☒ Yes ☐ No

IF NO Explain: _____

The Type of License of Installer:

- ☐ Master Plumber # _____
☐ Solid Fuel # _____
☐ Oil # _____
☒ Gas # PLT-3595
☐ Other _____

Type of Chimney:

- ☐ Masonry Lined
Factory built _____
☐ Metal
Factory Built U.L. Listing # _____

☒ Direct Vent

UL# _____

Type of Fuel Tank☐ Oil 3 2010

Dept. of Building Inspections
City of Portland-Maine

Size of Tank 100Number of Tanks 2Distance from Tank to Center of Flame 100 feet.Cost of Work: \$ 2600Permit Fee: \$ 150**Approved**

Fire: _____

Ele.: _____

Bldg.: _____

Signature of Installer [Signature]**Approved with Conditions**

- ☐ See attached letter or requirement

Inspector's Signature _____

Date Approved _____

White - Inspection

Yellow - File

Pink - Applicant's

Gold - Assessor's Copy

City of Portland, Maine - Building or Use Permit Application

389 Congress Street, 04101 Tel: (207) 874-8703, Fax: (207) 874-8716

Permit No: 10-0201	Issue Date:	CBL: 055 D006001
-----------------------	-------------	---------------------

Location of Construction: 722 CONGRESS ST	Owner Name: SARGENT COLIN W & NANCY	Owner Address: 722 CONGRESS ST	Phone:
Business Name:	Contractor Name: David DiBiase	Contractor Address: 139 Glenwood Ave Portland	Phone: 2073218837
Lessee/Buyer's Name	Phone:	Permit Type: HVAC	Zone: B-2b

Past Use: Commercial "Coffee Shop" (#09-1275)	Proposed Use: Commercial "Coffee Shop" - install a Rinnai heater	Permit Fee: \$50.00	Cost of Work: \$2,600.00	CEO District: 2
		FIRE DEPT: <input type="checkbox"/> Approved <input checked="" type="checkbox"/> Denied <i>N/A</i>	INSPECTION: Use Group: Type: <i>HVAC</i> <i>State Gas Pgs</i>	

Proposed Project Description: install a Rinnai heater	Signature: <i>[Signature]</i>	Signature: <i>[Signature]</i>
PEDESTRIAN ACTIVITIES DISTRICT (P.A.D.)		
Action: <input type="checkbox"/> Approved <input type="checkbox"/> Approved w/Conditions <input checked="" type="checkbox"/> Denied	Signature: Date:	

Permit Taken By: Idobson	Date Applied For: 03/03/2010	Zoning Approval
-----------------------------	---------------------------------	-----------------

1. This permit application does not preclude the Applicant(s) from meeting applicable State and Federal Rules.
2. Building permits do not include plumbing, septic or electrical work.
3. Building permits are void if work is not started within six (6) months of the date of issuance. False information may invalidate a building permit and stop all work..

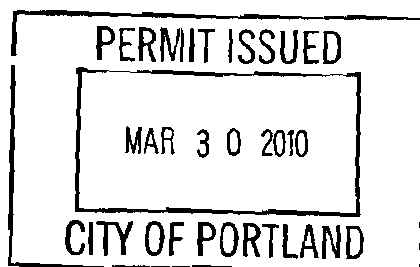

Special Zone or Reviews <input type="checkbox"/> Shoreland <input type="checkbox"/> Wetland <input type="checkbox"/> Flood Zone <input type="checkbox"/> Subdivision <input type="checkbox"/> Site Plan Maj <input type="checkbox"/> Minor <input type="checkbox"/> MM <input type="checkbox"/> <i>OK w/conditions</i> Date: 3/3/10 <i>AFM</i>	Zoning Appeal <input type="checkbox"/> Variance <input type="checkbox"/> Miscellaneous <input type="checkbox"/> Conditional Use <input type="checkbox"/> Interpretation <input type="checkbox"/> Approved <input type="checkbox"/> Denied Date:	Historic Preservation <input type="checkbox"/> Not in District or Landmark <input type="checkbox"/> Does Not Require Review <input type="checkbox"/> Requires Review <input type="checkbox"/> Approved <input checked="" type="checkbox"/> Approved w/Conditions <input type="checkbox"/> Denied <i>Any exterior work requires a separate review & approval</i> <i>D. Andrews</i> <i>3/8/2010</i>
-------------------------------------------------------------------------------------------------------------------------------------------------------------------------------------------------------------------------------------------------------------------------------------------------------------------------------------------------------------------------------	-----------------------------------------------------------------------------------------------------------------------------------------------------------------------------------------------------------------------------------------------------------------------------	-----------------------------------------------------------------------------------------------------------------------------------------------------------------------------------------------------------------------------------------------------------------------------------------------------------------------------------------------------------------------------------------------------------------------------------------

CERTIFICATION

I hereby certify that I am the owner of record of the named property, or that the proposed work is authorized by the owner of record and that I have been authorized by the owner to make this application as his authorized agent and I agree to conform to all applicable laws of this jurisdiction. In addition, if a permit for work described in the application is issued, I certify that the code official's authorized representative shall have the authority to enter all areas covered by such permit at any reasonable hour to enforce the provision of the code(s) applicable to such permit.

SIGNATURE OF APPLICANT	ADDRESS	DATE	PHONE
RESPONSIBLE PERSON IN CHARGE OF WORK, TITLE		DATE	PHONE

City of Portland, Maine - Building or Use Permit

389 Congress Street, 04101 Tel: (207) 874-8703, Fax: (207) 874-8716

Permit No:	Date Applied For:	CBL:
10-0201	03/03/2010	055 D006001

Location of Construction: 722 CONGRESS ST	Owner Name: SARGENT COLIN W & NANCY	Owner Address: 722 CONGRESS ST	Phone:
Business Name:	Contractor Name: David DiBiase	Contractor Address: 139 Glenwood Ave Portland	Phone (207) 321-8837
Lessee/Buyer's Name	Phone:	Permit Type: HVAC	

Proposed Use: Commercial "Coffee Shop" - install a Rinnai heater	Proposed Project Description: install a Rinnai heater
---------------------------------------------------------------------	----------------------------------------------------------

Dept: Historic Status: Approved with Conditions Reviewer: Deborah Andrews Approval Date: 03/03/2010
Note: Ok to Issue: ☒

- 1) * Rinnai vent to be located as close to the ground as possible to limit visibility.

Dept: Zoning Status: Approved with Conditions Reviewer: Ann Machado Approval Date: 03/03/2010
Note: Ok to Issue: ☒

- 1) ANY exterior work requires a separate review and approval thru Historic Preservation. This property is located within an Historic District.

Dept: Building Status: Approved with Conditions Reviewer: Tammy Munson Approval Date: 03/08/2010
Note: Ok to Issue: ☒

- 1) The installation must comply with the State of Maine Gas Regulations.

Owner's Operation and Installation Manual for the

ES38 (RHFE-1004RFA)

Energysaver®

Gas Direct Vent Wall Furnace

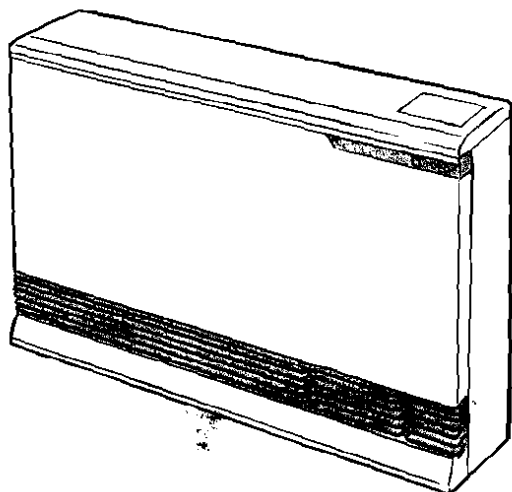

Table of Contents	2
Safety Information	3
Operating Instructions	6
Care and Maintenance ...	10
Fault Codes	12
Installation Instructions...	14
Parts List	31
Consumer Support	42

WARNING: If the information in these instructions is not followed exactly, a fire or explosion may result causing property damage, personal injury or loss of life.

- Do not store or use gasoline or other flammable vapors and liquids in the vicinity of this or any other appliance.
- **WHAT TO DO IF YOU SMELL GAS**
 - Do not try to light any appliance.
 - Do not touch any electrical switch; do not use any phone in your building.
 - Immediately call your gas supplier from a neighbor's phone. Follow the gas supplier's instructions.
 - If you cannot reach your gas supplier, call the fire department.
- Installation and service must be performed by a qualified installer, service agency or the gas supplier.

INSTALLER: Leave this manual with the appliance.
CONSUMER: Retain this manual for future reference.

Register your product at www.rinnairegistration.com
or call 1-866-RINNAI1 (746-6241)

Rinnai®

Gas Connection

! WARNING

When connecting the gas valve or other gas components in the gas line, use a backup wrench to ensure the connection is gas tight.

- The gas supply line shall be gas tight, sized and so installed as to provide a supply of a gas sufficient to meet the maximum demand of the heater without loss of pressure.
- A shut off valve and appliance connector valve should be installed in the upstream of the gas line to permit servicing.
- Flexible pipe and any appliance connector valve used for gas piping shall be types approved by nationally recognized agencies.
- Any compound used on the threaded joint of the gas piping shall be a type which resists the action of liquefied petroleum gas (propane / LPG).
- After completion of gas pipe connections all joints including the heater must be checked for gas tightness by means of leak detector solution, soap and water, or an equivalent nonflammable solution, as applicable. (Since some leak test solutions, including soap and water, may cause corrosion or stress cracking, the piping shall be rinsed with water after testing, unless it has been determined that the leak test solution is non-corrosive.)
- Check the gas supply pressure immediately upstream at a location provided by the gas company. Supplied gas pressure must be within the limits shown in the Specifications section.
- Refer to an approved pipe sizing chart if in doubt about the size of the gas line.
- Install manual gas cut-off valve so that it can be accessed for easy operation. Do not conceal manual cut-off valve behind back spacer.
- An elbow is supplied to attach to the gas line if needed.

Clearances to Combustibles

When determining where to install the appliance the clearances to combustibles shown in the figure must be followed. Also refer to the Safety Behaviors and Practices section. The clearance to combustibles from the top is zero.

Rinnai recommends 10" (250 mm) clearance on both sides for servicing.

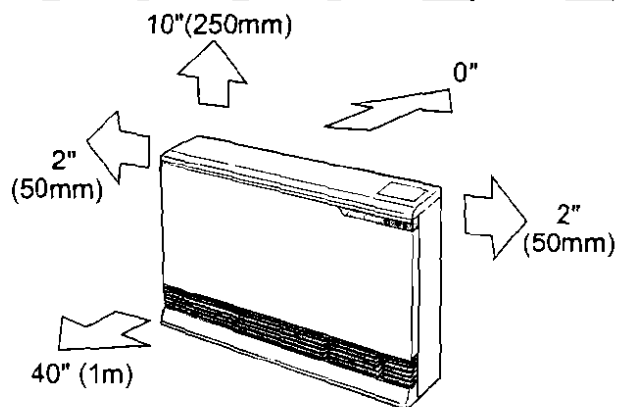

Flue Manifold Installation

4. Install the Terminal

Check that the terminal seal is in place. For weatherboard walls, add the second seal next to the terminal seal to compensate for weather board angle.

From the outside insert the terminal into the sleeve with the marking "TOP" at the top. The left hand side locking tie should be marked "LEFT".

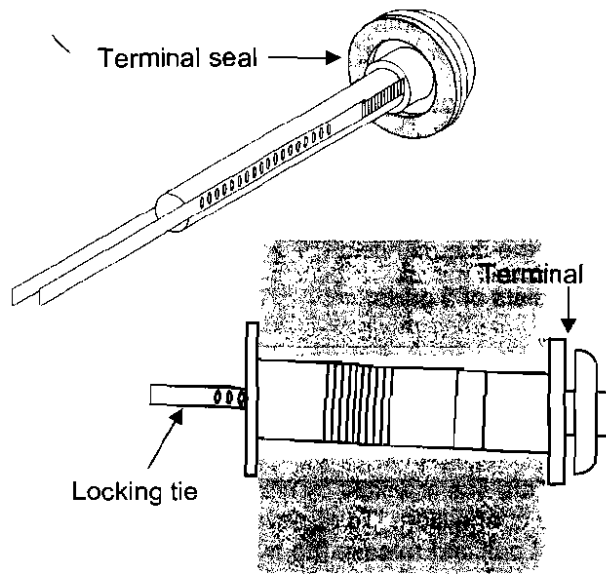

6. Lock the ties

Pulling hard on the left and right hand ties, clip the ties over the notches inside the sleeve. You should be able to pull the ties 2 or 3 notches past the starting point. Cut the ties, leaving about 3/4 inch (20 mm) past the notch. Bend the ties back into the sleeve and parallel to the wall.

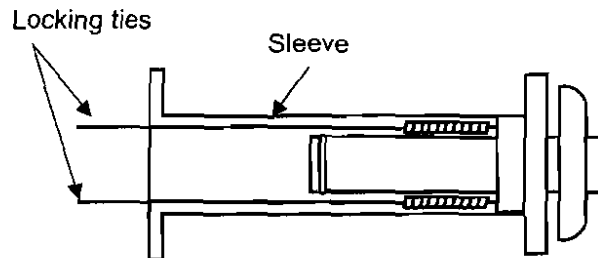

7. Insert Inside Connection Assembly

Push the assembly into the terminal tube, ensuring that the seal is in place on the inner tube.

Attach the inside connection with 3 screws. The inner connection can still be turned to install the screws.

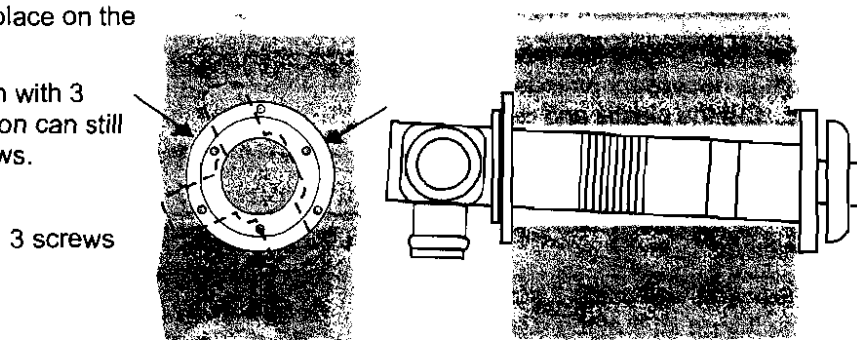

8 PKG Spaces Required
12 PKG Spaces Shown

RECEIVED
NOV 16 2009
Dept. of Building Inspections
City of Portland Maine

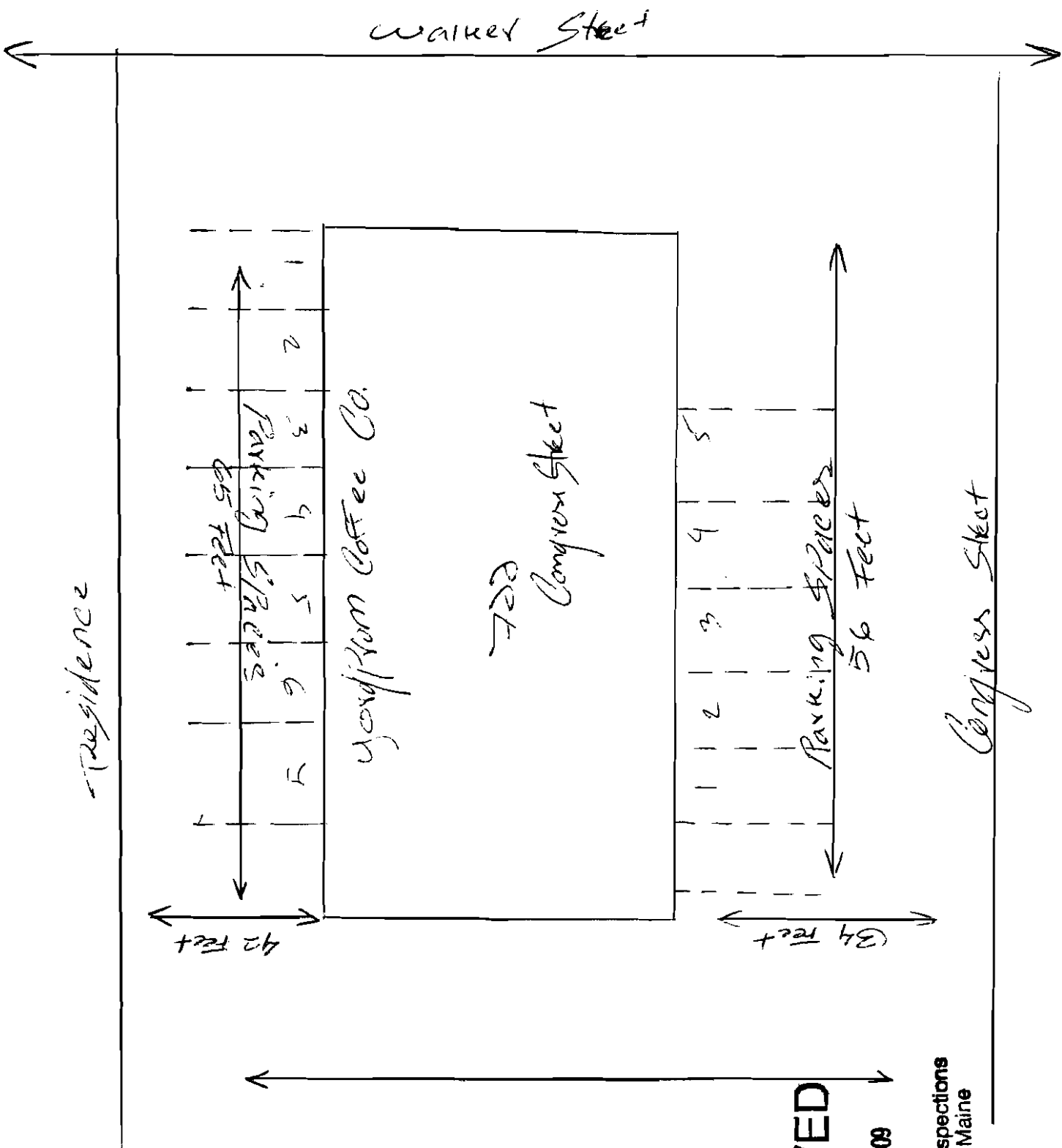

$$1347 \div 150 = 7.56 \text{ g}$$

8 kg 50g

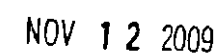

Dept. of Building Inspections
- City of Portland Maine

722 CONGRESS ST. : EXISTING FLOOR PLAN

$$1/4'' = 11 \frac{1}{2}''$$

10 (29 | 09)

Additional parking lots.

L E L A N D H U L S T
ARCHITECTURAL SERVICES

278 Spring Street / Portland, Maine 04102 / (207) 773-2543