

# City of Portland, Maine - Building or Use Permit Application

389 Congress Street, 04101 Tel: (207) 874-8703, Fax: (207) 874-8716

<b>PERMIT ISSUED</b> Permit No: 03-0115 Issue Date: FEB 21 2003		CBL: 055 D006001
Location of Construction: 722 Congress St	Owner Name: Wilson Francis C Trust	Owner Address: 722 Congress St
Business Name:	Contractor Name: The Signery	Contractor Address: 299 Forest Avenue Portland
Lessee/Buyer's Name	Phone:	Permit Type: Signs - Permanent
		Zone: B2b

Past Use: Office space	Proposed Use: Office space; move sign from one building facade to another; see permit 03-0090 for original sign permit.	Permit Fee: \$30.00	Cost of Work: \$1,000.00	CEO District: 3
Proposed Project Description: Relocate approved signage to different building facade.		FIRE DEPT: <input type="checkbox"/> Approved <input type="checkbox"/> Denied	INSPECTION: Use Group: U Type:	
		Signature:	Signature:	
		PEDESTRIAN ACTIVITIES DISTRICT (P.A.D.)		
		Action: <input type="checkbox"/> Approved <input type="checkbox"/> Approved w/Conditions <input type="checkbox"/> Denied		
		Signature: Date:		

Permit Taken By: gg	Date Applied For: 02/13/2003	<b>Zoning Approval</b>		
1. This permit application does <del>not</del> preclude the Applicant(s) from meeting applicable State and Federal Rules. 2. Building permits do not include plumbing, septic or electrical work. 3. Building permits are void if work is not started within six (6) months of the date of issuance. False information may invalidate a building permit and stop all work..		Special Zone or Reviews <input type="checkbox"/> Shoreland <input type="checkbox"/> Wetland <input type="checkbox"/> Flood Zone <input type="checkbox"/> Subdivision <input type="checkbox"/> Site Plan Maj <input type="checkbox"/> Minor <input type="checkbox"/> MM <input type="checkbox"/> Date: 2/19/03	Zoning Appeal <input type="checkbox"/> Variance <input type="checkbox"/> Miscellaneous <input type="checkbox"/> Conditional Use <input type="checkbox"/> Interpretation <input type="checkbox"/> Approved <input type="checkbox"/> Denied Date:	Historic Preservation <input checked="" type="checkbox"/> Not in District or Landmark <input type="checkbox"/> Does Not Require Review <input type="checkbox"/> Requires Review <input type="checkbox"/> Approved <input type="checkbox"/> Approved w/Conditions <input type="checkbox"/> Denied Date:

## CERTIFICATION

I hereby certify that I am the owner of record of the named property, or that the proposed work is authorized by the owner of record and that I have been authorized by the owner to make this application as his authorized agent and I agree to conform to all applicable laws of this jurisdiction. In addition, if a permit for work described in the application is issued, I certify that the code official's authorized representative shall have the authority to enter all areas covered by such permit at any reasonable hour to enforce the provision of the code(s) applicable to such permit.

SIGNATURE OF APPLICANT

ADDRESS

DATE

PHONE

RESPONSIBLE PERSON IN CHARGE OF WORK, TITLE

DATE

PHONE

**City of Portland, Maine - Building or Use Permit**

389 Congress Street, 04101 Tel: (207) 874-8703, Fax: (207) 874-8716

<b>Permit No:</b> 03-0115	<b>Date Applied For:</b> 02/13/2003	<b>CBL:</b> 055 D006001
------------------------------	--	----------------------------

<b>Location of Construction:</b> 722 Congress St	<b>Owner Name:</b> Wilson Francis C Trust	<b>Owner Address:</b> 722 Congress St	<b>Phone:</b> ( ) 879-7700
<b>Business Name:</b>	<b>Contractor Name:</b> The Signery	<b>Contractor Address:</b> 299 Forest Avenue Portland	<b>Phone</b> (207) 879-7700
<b>Lessee/Buyer's Name</b>	<b>Phone:</b>	<b>Permit Type:</b> Signs - Permanent	

<b>Proposed Use:</b> Office space; move sign from one building facade to another; see permit 03-0090 for original sign permit.	<b>Proposed Project Description:</b> Relocate approved signage to different building facade.
---	---

**Dept:** Zoning      **Status:** Approved with Conditions      **Reviewer:** Marge Schmuckal      **Approval Date:** 02/18/2003  
**Note:** **Ok to Issue:** ☒

- 1) It is understood that this permit is ONLY for the relocation of the 2' x 10' sign. There will be a separate application with all the appropriate submittals for any awning.

**Dept:** Building      **Status:** Approved      **Reviewer:** Mike Nugent      **Approval Date:** 02/18/2003  
**Note:** **Ok to Issue:** ☒

# DISPLAY THIS CARD ON PRINCIPAL FRONTAGE OF WORK

## CITY OF PORTLAND

Please Read  
Application And  
Notes, If Any,  
Attached

### BUILDING DEPARTMENT

## PERMIT

Permit Number: 030115

This is to certify that Wilson Francis C Trust/The Sundry  
has permission to Relocate approved signage to different building facade.  
AT 722 Congress St Call 555 D006001

provided that the person or persons, firm or corporation accepting this permit shall comply with all of the provisions of the Statutes of Maine and of the ordinances of the City of Portland regulating the construction, maintenance and use of buildings and structures, and of the application on file in this department.

Apply to Public Works for street line and grade if nature of work requires such information.

Notification of inspection must be given and written permission procured before this building or part thereof is altered or closed-in.  
HOURS NOTICE IS REQUIRED.

A certificate of occupancy must be procured by owner before this building or part thereof is occupied.

#### OTHER REQUIRED APPROVALS

Fire Dept. \_\_\_\_\_  
Health Dept. \_\_\_\_\_  
Appeal Board \_\_\_\_\_  
Other \_\_\_\_\_

Department Name

*Alvin J. Campbell* 2/19/23  
Director - Building & Inspection Services

**PENALTY FOR REMOVING THIS CARD**

2/13/03

To whom it may concern:

A sign permit was issued to us  
2/11/03 for 2 signs. Since we applied,  
we have moved into the building, and  
find that we need an awning over  
the door to protect people who are  
entering from rain + snow, so we  
would now like to install the sign

facing Congress st. over to the left of  
the door on the existing flat surface  
as on the drawing. There will be no changes to  
the size of either sign + the Waller st. sign position  
is unchanged. Thank!

— Colin + Nancy Sargent.

**THIS IS NOT A PERMIT/CONSTRUCTION MAY NOT COMMENCE UNTIL THE  
PERMIT IS ISSUED**

## Signage Application

If you or the property owner owes real estate or personal property taxes or user charges on any property within the City, payment arrangements must be made before permits of any kind are accepted.

Location/Address of Construction: <u>722 Congress St.</u>		
Total Square Footage of Proposed Structure <u>2 20 sq. ft signs</u>	Square Footage of Lot <u>7200</u>	
Tax Assessor's Chart, Block & Lot Chart# <u>55</u> Block# <u>D</u> Lot# <u>6</u>	Owner: <u>Colin + Nancy Sargent</u>	Telephone:
Lessee/Buyer's Name (if Applicable)	Applicant name, address & telephone: <u>Colin Sargent</u> <u>722 Congress</u> <u>775 4339</u>	Total s.f. of signage <u>    </u> x 1.00 per s.f. \$ <u>    </u> , plus \$30.00 base fee Fee: \$
Current use: <u>Sales office</u>		
If the location is currently vacant, what was prior use: <u>Allen Business Forms</u>		
Approximately how long has it been vacant: <u>6 mos.</u>		
Proposed use: <u>amendment to permit # 030090</u>		
Project description: <u>slide approved front sign to left side of building, add <del>awning over</del> background dark green</u>		
Contractor's name, address & telephone:		
Who should we contact when the permit is ready: <u>The Signery</u>		
Mailing address: <u>879-7700</u>		
We will contact you by phone when the permit is ready. You must come in and pick up the permit and review the requirements before starting any work with a Plan Reviewer. A stop work order will be issued and a \$50.00 fee if any work starts before the permit is picked up. Phone:		

**IF THE REQUIRED INFORMATION IS NOT INCLUDED IN THE SUBMISSIONS THE PERMIT WILL BE AUTOMATICALLY DENIED AT THE DISCRETION OF THE BUILDING/PLANNING DEPARTMENT, WE MAY REQUIRE ADDITIONAL INFORMATION IN ORDER TO APPROVE THIS PERMIT.**

I hereby certify that I am the Owner of record of the named property, or that the owner of record authorizes the proposed work and that I have been authorized by the owner to make this application as his/her authorized agent. I agree to conform to all applicable laws of this jurisdiction. In addition, if a permit for work described in this application is issued, I certify that the Code Official's authorized representative shall have the authority to enter all areas covered by this permit at any reasonable hour to enforce the provisions of the codes applicable to this permit.

Signature of applicant: <u>Colin Sargent</u>	Date: <u>13 FEB 03</u>
--	------------------------

**This is NOT a permit, you may not commence ANY work until the permit is issued.**  
**If you are in a Historic District you may be subject to additional permitting and fees with the**  
**Planning Department on the 4th floor of City Hall**

# SIGNAGE PRE-APPLICATION

PLEASE ANSWER ALL QUESTIONS

ADDRESS: 722 Congress

ZONE: B2b

OWNER: Colin + Nancy Sargent

APPLICANT: " "

ASSESSOR NO.

PLEASE CIRCLE APPROPRIATE ANSWER

SINGLE TENANT LOT? YES NO

MULTI-TENANT LOT? YES NO

FREESTANDING SIGN? (ex. Pole Sign) YES NO

DIMENSIONS 10 HEIGHT 3

MORE THAN ONE SIGN?

YES NO

DIMENSIONS HEIGHT

SIGN ATTACHED TO BLDG.? YES NO

DIMENSIONS

MORE THAN ONE SIGN? YES NO

DIMENSIONS

AWNING: YES NO IS AWNING BACKLIT? YES NO HEIGHT OFF SIDEWALK 10'

IS THERE ANY MESSAGE, TRADEMARK OR SYMBOL ON IT? NO

LIST ALL EXISTING SIGNAGE AND THEIR DIMENSIONS:

\*\*\* TENANT BLDG. FRONTAGE (IN FEET): 90' of Congress; 46' off walker  
\*\*\* REQUIRED INFORMATION

AREA FOR COMPUTATION

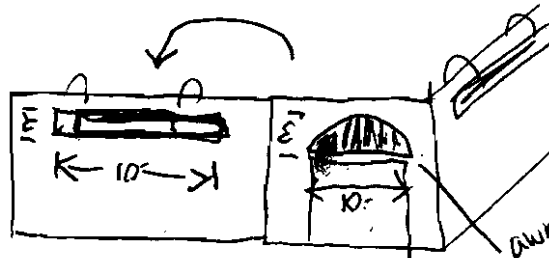

Amendment: Sign slides to center of left side of bldg.  
Backgrounds of signs: dark green

awning 10' x 3' with no writing

NOT backlit

\* see photos and sketch Permit # 03-0090 \*

YOU SHALL PROVIDE:

A SITE SKETCH AND BUILDING SKETCH SHOWING EXACTLY WHERE EXISTING AND NEW SIGNAGE IS LOCATED MUST BE PROVIDED. SKETCHES AND/OR PICTURES OF PROPOSED ARE ALSO REQUIRED.

SIGNATURE OF APPLICANT:

DATE:

# City of Portland, Maine - Building or Use Permit Application

389 Congress Street, 04101 Tel: (207) 874-8703, Fax: (207) 874-8716

<div style="border: 2px solid black; padding: 5px; text-align: center;"> <b>PERMIT ISSUED</b>  <b>FEB 11 2003</b>  <b>CITY OF PORTLAND</b> </div>		<b>Permit No:</b> 03-0090	<b>CBL:</b> 055 D006001
<b>Location of Construction:</b> 722 Congress St	<b>Owner Name:</b> Wilson Francis C Trust	<b>Owner Address:</b> 722 Congress St	<b>Phone:</b> 2078797700
<b>Business Name:</b> n/a	<b>Contractor Name:</b> The Signery	<b>Contractor Address:</b> 299 Forest Avenue Portland	<b>Phone:</b> 2078797700
<b>Lessee/Buyer's Name:</b> n/a	<b>Phone:</b> n/a	<b>Permit Type:</b> Signs - Permanent	<b>Zone:</b> B2b

<b>Past Use:</b> Commercial / Portland Magazine	<b>Proposed Use:</b> Portland Magazine; Erect two identical signs 10' x 2' <i>legal's office use confirmed</i>	<b>Permit Fee:</b> \$70.00	<b>Cost of Work:</b> \$0.00	<b>CEO District:</b> 3
<b>Proposed Project Description:</b> Erect two identical sign 10' x 2'		<b>FIRE DEPT:</b> <input type="checkbox"/> Approved <input type="checkbox"/> Denied	<b>INSPECTION:</b> Use Group: <i>B</i> Type: <i>NA</i> <i>2/10/03</i> <i>[Signature]</i>	
		<b>Signature:</b>	<b>Signature:</b>	
<b>PEDESTRIAN ACTIVITIES DISTRICT (P.A.D.)</b> Action: <input type="checkbox"/> Approved <input type="checkbox"/> Approved w/Conditions <input type="checkbox"/> Denied Signature: _____ Date: _____				

<b>Permit Taken By:</b> gg	<b>Date Applied For:</b> 02/05/2003	<b>Zoning Approval</b>		
1. This permit application does not preclude the Applicant(s) from meeting applicable State and Federal Rules. 2. Building permits do not include plumbing, septic or electrical work. 3. Building permits are void if work is not started within six (6) months of the date of issuance. False information may invalidate a building permit and stop all work..		<b>Special Zone or Reviews</b> <input type="checkbox"/> Shoreland <input type="checkbox"/> Wetland <input type="checkbox"/> Flood Zone <input type="checkbox"/> Subdivision <input type="checkbox"/> Site Plan Maj <input type="checkbox"/> Minor <input type="checkbox"/> MM <input type="checkbox"/> <i>OK with conditions</i> Date: <i>3/2/03</i>	<b>Zoning Appeal</b> <input type="checkbox"/> Variance <input type="checkbox"/> Miscellaneous <input type="checkbox"/> Conditional Use <input type="checkbox"/> Interpretation <input type="checkbox"/> Approved <input type="checkbox"/> Denied Date: _____	<b>Historic Preservation</b> <input checked="" type="checkbox"/> Not in District or Landmark <input type="checkbox"/> Does Not Require Review <input type="checkbox"/> Requires Review <input type="checkbox"/> Approved <input type="checkbox"/> Approved w/Conditions <input type="checkbox"/> Denied Date: <i>3</i>

## CERTIFICATION

I hereby certify that I am the owner of record of the named property, or that the proposed work is authorized by the owner of record and that I have been authorized by the owner to make this application as his authorized agent and I agree to conform to all applicable laws of this jurisdiction. In addition, if a permit for work described in the application is issued, I certify that the code official's authorized representative shall have the authority to enter all areas covered by such permit at any reasonable hour to enforce the provision of the code(s) applicable to such permit.

SIGNATURE OF APPLICANT

ADDRESS

DATE

PHONE

# City of Portland, Maine - Building or Use Permit

389 Congress Street, 04101 Tel: (207) 874-8703, Fax: (207) 874-8716

Permit No: 03-0090	Date Applied For: 02/05/2003	CBL: 055 D006001
-----------------------	---------------------------------	---------------------

Location of Construction: 722 Congress St	Owner Name: Wilson Francis C Trust	Owner Address: 722 Congress St	Phone:
Business Name: n/a	Contractor Name: The Signery	Contractor Address: 299 Forest Avenue Portland	Phone (207) 879-7700
Lessee/Buyer's Name n/a	Phone: n/a	Permit Type: Signs - Permanent	

Proposed Use: Portland Magazine; Erect two identical signs 10' x 2'	Proposed Project Description: Erect two identical sign 10' x 2'
--	--

Dept: Zoning      Status: Approved      Reviewer: Marge Schmuckal      Approval Date: 02/07/2003  
Note:      Ok to Issue: ☒

Dept: Building      Status: Approved      Reviewer: Mike Nugent      Approval Date: 02/10/2003  
Note:      Ok to Issue: ☒



# DISPLAY THIS CARD ON PRINCIPAL FRONTAGE OF WORK

## CITY OF PORTLAND

Please Read  
Application And  
Notes, If Any,  
Attached

### CONSTRUCTION

## PERMIT

Permit Number: 030090

This is to certify that Wilson Francis C Trust/The Society

has permission to Erect two identical sign 10' x 10'

AT 722 Congress St

Call 555 D006001

provided that the person or persons, firm or corporation accepting this permit shall comply with all of the provisions of the Statutes of Maine and of the ordinances of the City of Portland regulating the construction, maintenance and use of buildings and structures, and of the application on file in this department.

Apply to Public Works for street line and grade if nature of work requires such information.

Notification of inspection must be given and when permission procured before this building or part thereof is altered or occupied. **FOUR HOUR NOTICE IS REQUIRED.**

A certificate of occupancy must be procured by owner before this building or part thereof is occupied.

#### OTHER REQUIRED APPROVALS

Fire Dept. \_\_\_\_\_

Health Dept. \_\_\_\_\_

Appeal Board \_\_\_\_\_

Other \_\_\_\_\_

Department Name \_\_\_\_\_

*William J. ...*  
Director - Building & Inspection Services

**PENALTY FOR REMOVING THIS CARD**

<b>ACORD INSURANCE BINDER</b>				DATE 02/03/03	
THIS BINDER IS A TEMPORARY INSURANCE CONTRACT, SUBJECT TO THE CONDITIONS SHOWN ON THE REVERSE SIDE OF THIS FORM.					
PRODUCER		PHONE (A/C No. Ext) 800-531-8826 FAX (A/C No.) 210 498-0344	COMPANY Hartford Casualty Insura		BINDER # 65SBAPU7415
USAA General Agency COMMERCIAL BROK/SPCL RISK 9800 Fredericksburg Rd. San Antonio, TX 78284-9836		DATE EFFECTIVE TIME		DATE EXPIRATION TIME	
		02/06/03 12:01 X AM PM		02/06/04 X 12:01 AM NOON	
CODE:		THIS BINDER IS ISSUED TO EXTEND COVERAGE IN THE ABOVE NAMED COMPANY PER EXPIRING POLICY #:			
AGENCY CUSTOMER ID 197823		DESCRIPTION OF OPERATIONS/VEHICLES/PROPERTY (Including Location)			
INSURED COLIN W SARGENT AND NANCY D SARGENT AND SARGENT PUBLISHING, 294 SPRING ST PORTLAND, ME 04102-3714		Loc#1: 722 CONGRESS STREET, PORTLAND, ME 04102-3714			

COVERAGES		LIMITS		
TYPE OF INSURANCE	COVERAGE/FORMS	DEDUCTIBLE	AMOUNT	
PROPERTY CAUSES OF LOSS <input type="checkbox"/> BASIC <input type="checkbox"/> BROAD <input checked="" type="checkbox"/> SPEC	Building Business Property	250 250	\$125,000 \$20,000	
GENERAL LIABILITY <input type="checkbox"/> COMMERCIAL GENERAL LIABILITY <input type="checkbox"/> CLAIMS MADE <input checked="" type="checkbox"/> OCCUR	RETRO DATE FOR CLAIMS MADE:	EACH OCCURRENCE	\$1,000,000	
		DAMAGE TO RENTED PREMISES	\$300,000	
		MED EXP (Any one person)	\$10,000	
		PERSONAL & ADV INJURY	\$1,000,000	
		GENERAL AGGREGATE	\$2,000,000	
		PRODUCTS - COMP/OP AGG	\$2,000,000	
AUTOMOBILE LIABILITY <input type="checkbox"/> ANY AUTO <input type="checkbox"/> ALL OWNED AUTOS <input type="checkbox"/> SCHEDULED AUTOS <input type="checkbox"/> HIRED AUTOS <input type="checkbox"/> NON-OWNED AUTOS	RETRO DATE FOR CLAIMS MADE:	COMBINED SINGLE LIMIT	\$	
		BODILY INJURY (Per person)	\$	
		BODILY INJURY (Per accident)	\$	
		PROPERTY DAMAGE	\$	
		MEDICAL PAYMENTS	\$	
		PERSONAL INJURY PROT	\$	
		UNINSURED MOTORIST	\$	
			\$	
AUTO PHYSICAL DAMAGE DEDUCTIBLE <input type="checkbox"/> COLLISION: <input type="checkbox"/> OTHER THAN COL:		<input type="checkbox"/> ALL VEHICLES <input type="checkbox"/> SCHEDULED VEHICLES	ACTUAL CASH VALUE	
			STATED AMOUNT	\$
		OTHER		
GARAGE LIABILITY <input type="checkbox"/> ANY AUTO	RETRO DATE FOR CLAIMS MADE:	AUTO ONLY - EA ACCIDENT	\$	
		OTHER THAN AUTO ONLY:		
		EACH ACCIDENT	\$	
		AGGREGATE	\$	
EXCESS LIABILITY <input type="checkbox"/> UMBRELLA FORM <input type="checkbox"/> OTHER THAN UMBRELLA FORM	RETRO DATE FOR CLAIMS MADE:	EACH OCCURRENCE	\$	
		AGGREGATE	\$	
		SELF-INSURED RETENTION	\$	
		WC STATUTORY LIMITS		
WORKER'S COMPENSATION AND EMPLOYER'S LIABILITY	RETRO DATE FOR CLAIMS MADE:	E.L. EACH ACCIDENT	\$	
		E.L. DISEASE - EA EMPLOYEE	\$	
		E.L. DISEASE - POLICY LIMIT	\$	
		FEE'S	\$	
SPECIAL CONDITIONS/OTHER COVERAGES	** Continued from Property Section ** (See attached Spec Conditions/Other Covs page.)		TAXES	\$
			ESTIMATED TOTAL PREMIUM	\$

NAME & ADDRESS		<input checked="" type="checkbox"/> MORTGAGEE <input type="checkbox"/> ADDITIONAL INSURED	
Millard S. Peabody, Trustee PO Box 1453 South Hampton NY 11969		<input type="checkbox"/> LOSS PAYEE	
		LOAN #	
		AUTHORIZED REPRESENTATIVE <i>Armand J. Manta</i>	

## SPECIAL CONDITIONS/OTHER COVERAGES (Cont. from page 1)

### Commercial Property Location Specific Coverages

Location: 1

Building #1: PUBLISHING OFFICE

Coverage: Building Valuation: Replacement Cost Deductible Type:  
Flat

### Optional Coverage(s):

Coverage: HARTFORD SUPER STRETCH

Coverage: Hartford Building Stretch

10'

2'

(2) Framed Wooden Signs  
w/ Gold Leafed Dimensional Copy  
24x120

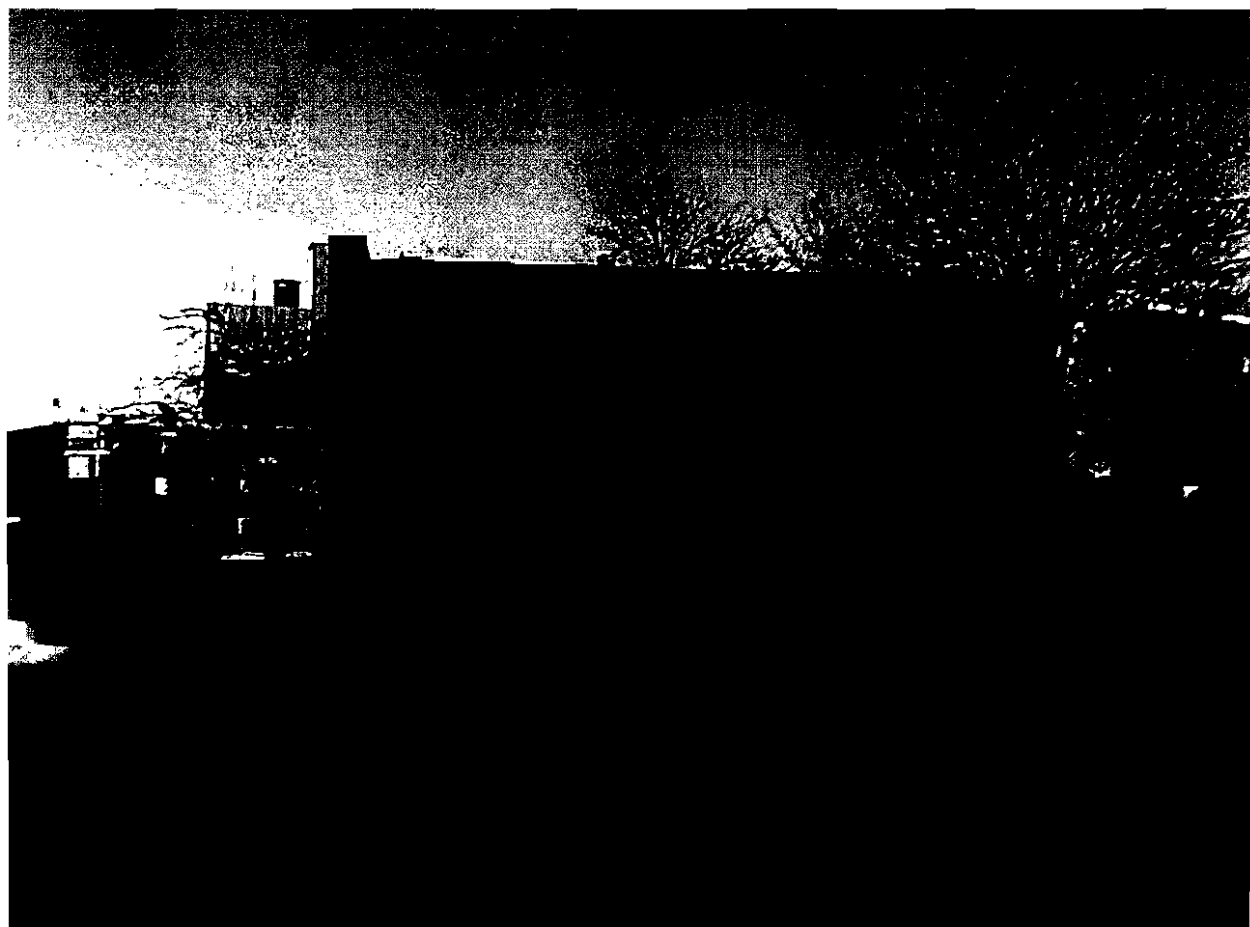

# SIGNAGE PRE-APPLICATION

PLEASE ANSWER ALL QUESTIONS

ADDRESS: 722 Congress St.

ZONE: B2b

OWNER: Colin + Nancy Sargent

APPLICANT: Colin Sargent

ASSESSOR NO. \_\_\_\_\_

PLEASE CIRCLE APPROPRIATE ANSWER

SINGLE TENANT LOT? ☒ YES ☐ NO

MULTI-TENANT LOT? ☐ YES ☒ NO

FREESTANDING SIGN? (ex. Pole Sign) ☐ YES ☒ NO

DIMENSIONS 2' x 10' HEIGHT \_\_\_\_\_

MORE THAN ONE SIGN? ☒ YES ☐ NO

DIMENSIONS \_\_\_\_\_ HEIGHT \_\_\_\_\_

SIGN ATTACHED TO BLDG.? ☒ YES ☐ NO

DIMENSIONS \_\_\_\_\_

MORE THAN ONE SIGN? ☒ YES ☐ NO

DIMENSIONS 2' x 10' (2)

AWNING: YES ☒ NO ☐ IS AWNING BACKLIT? YES ☐ NO ☐

IS THERE ANY MESSAGE, TRADEMARK OR SYMBOL ON IT?

HEIGHT OFF SIDEWALK \_\_\_\_\_

ONE ON CONGRESS ST SIDE, ONE ON WALKER ST SIDE

LIST ALL EXISTING SIGNAGE AND THEIR DIMENSIONS:

None

\*\*\* TENANT BLDG. FRONTAGE (IN FEET): 45' x 2' = 90'

\*\*\* REQUIRED INFORMATION

23' x 2' = 46'

AREA FOR COMPUTATION

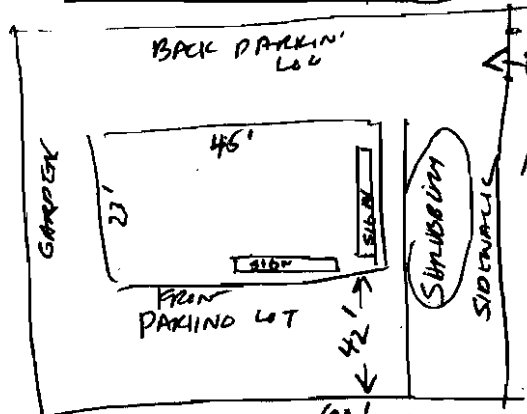

Photo  
Encl.

YOU SHALL PROVIDE:

**A SITE SKETCH AND BUILDING SKETCH SHOWING EXACTLY WHERE EXISTING AND NEW SIGNAGE IS LOCATED MUST BE PROVIDED. SKETCHES AND/OR PICTURES OF PROPOSED ARE ALSO REQUIRED.**

SIGNATURE OF APPLICANT: Colin Sargent

DATE: 5 Feb 03

THIS IS NOT A PERMIT/CONSTRUCTION MAY NOT COMMENCE UNTIL THE  
PERMIT IS ISSUED

## Signage Application

If you or the property owner owes real estate or personal property taxes or user charges on any property within the City, payment arrangements must be made before permits of any kind are accepted.

Location/Address of Construction: <u>722 Congress Street</u>		
Total Square Footage of Proposed Structure <u>1150 cws Two 20sq.ft. signs</u>		Square Footage of Lot <u>7200 sq.ft.</u>
Tax Assessor's Chart, Block & Lot Chart# <u>55</u> Block# <u>D</u> Lot# <u>6</u>	Owner: <u>Colin + Nancy Sargent</u>	Telephone: <u>207 775 4339</u>
Lessee/Buyer's Name (if Applicable) <u>Colin + Nancy Sargent</u>	Applicant name, address & telephone: <u>Colin Sargent</u> <u>294 Spring St.</u> <u>Portland, ME 04102</u>	Total s.f. of signage <u>40</u> x 1.00 per s.f. \$ <u>40</u> , plus \$30.00 base fee Fee: \$ <u>70.00</u>
Current use: <u>Just purchased for Portland Magazine</u>		
If the location is currently vacant, what was prior use: <u>Allen Business Forms, then Antique Store</u>		
Approximately how long has it been vacant: <u>6 months</u>		
Proposed use: <u>Portland Magazine offices / MARKETING</u>		
Project description: <u>Two signs, identical, 10' wide x 2' high, erected on side of building as shown.</u>		
Contractor's name, address & telephone: <u>The Signery, 879-7700</u>		
Who should we contact when the permit is ready: <u>The Signery, Forest Ave.</u>		
Mailing address: <u>299 Forest Ave.</u> <u>Portland, ME 04101</u>		
We will contact you by phone when the permit is ready. You must come in and pick up the permit and review the requirements before starting any work with a Plan Reviewer. A stop work order will be issued and a \$50.00 fee if any work starts before the permit is picked up. Phone:		

IF THE REQUIRED INFORMATION IS NOT INCLUDED IN THE SUBMISSIONS THE PERMIT WILL BE AUTOMATICALLY DENIED AT THE DISCRETION OF THE BUILDING/PLANNING DEPARTMENT, WE MAY REQUIRE ADDITIONAL INFORMATION IN ORDER TO APPROVE THIS PERMIT.

I hereby certify that I am the Owner of record of the named property, or that the owner of record authorizes the proposed work and that I have been authorized by the owner to make this application as his/her authorized agent. I agree to conform to all applicable laws of this jurisdiction. In addition, if a permit for work described in this application is issued, I certify that the Code Official's authorized representative shall have the authority to enter all areas covered by this permit at any reasonable hour to enforce the provisions of the codes applicable to this permit.

Signature of applicant: <u>Colin Sargent</u>	Date: <u>5 Feb 03</u>
--	-----------------------

This is NOT a permit, you may not commence ANY work until the permit is issued.  
If you are in a Historic District you may be subject to additional permitting and fees with the  
Planning Department on the 4th floor of City Hall



# CITY OF PORTLAND, MAINE

## Department of Building Inspections

2/5 20 03

Received from

Colin Sargent

Location of Work

722 Congress St.

Cost of Construction

\$ —

Permit Fee

\$ 70.00

Building (IL) ☐

Plumbing (IS) ☐

Electrical (I2) ☐

Site Plan (U2) ☐

Other

Sign

CBL

055-D-006

Check #:

1176

Total Collected \$

70.00

## THIS IS NOT A PERMIT

No work is to be started until PERMIT CARD is actually posted upon the premises. Acceptance of fee is no guarantee that permit will be granted. PRESERVE THIS RECEIPT. In case permit cannot be granted the amount of the fee will be refunded upon return of the receipt less \$10.00 or 10% whichever is greater.

WHITE - Applicant's Copy

YELLOW - Office Copy

PINK - Permit Copy