

- PC 1 = 6'-11 5/8" LONG
- PC 2 = 3'-11 5/8" LONG
- PC 2 = 3'-3 5/8" LONG
- PC 11 = 3'-1 5/8" LONG
- PC 25 = 3'-1 5/8" LONG
- PC 3 = - SEE FLANS (MO. 1 1/4")
- PC 8 = - SEE FLANS (MO. 1 1/4")
- PC 9 = - SEE FLANS (MO. 1 1/4")
- PC 10 = - SEE FLANS (MO. 1 1/4")
- PC 11 = - SEE FLANS (MO. 1 1/4")
- PC 15 = - SEE FLANS (MO. 1 1/4")
- PC 16 = - SEE FLANS (MO. 1 1/4")
- PC 20 = - SEE FLANS (MO. 1 1/4")

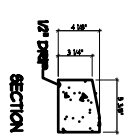

- PC 3 = 6'-3 5/8" LONG
- PC 4 = 3'-3 5/8" LONG
- PC 5 = 2'-1 5/8" LONG
- PC 10 = 2'-11 5/8" LONG
- PC 26 = 4'-11 5/8" LONG

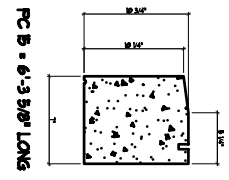

PC 6 = 6'-3 5/8" LONG

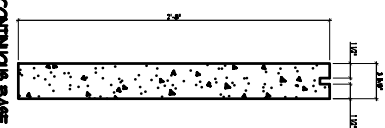

PC 21 = CONTINUOUS BASE
SEE PLANS TO DETERMINE LENGTHS

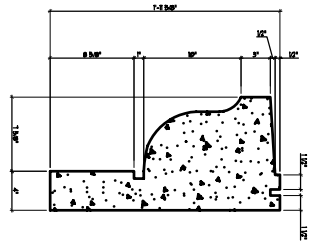

PC 6 = CONTINUOUS FASCIA
SEE PLANS TO DETERMINE LENGTHS

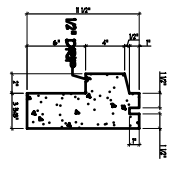

PC 1 = CONTINUOUS CORNICE
SEE PLANS TO DETERMINE LENGTHS

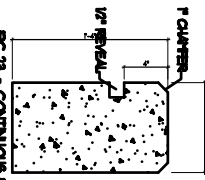

PC 23 = CONTINUOUS PLANTER WALL FACING
SEE PLANS TO DETERMINE LENGTHS

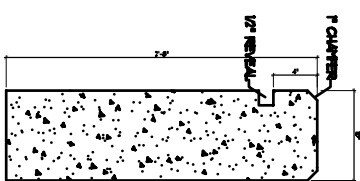

PC 21 = CONTINUOUS PLANTER WALL FACING
SEE PLANS TO DETERMINE LENGTHS

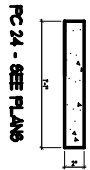

PC 24 = SEE PLANS