

SOUTH ELEVATION/ STAIR SECTION

DRAWING TITLE:

PROJECT NAME:
PAGE BAMPTON RESIDENCE
PORTLAND MAINE

THIS DRAWING IS THE PROPERTY OF LINDA BRALEY AND IS NOT TO BE COPIED OR REPRODUCED IN PART OR WHOLE. © 2016 LINDA BRALEY

DATE OF ISSUE
SEPT 20, 2016
DESCRIPTION
CONCEPTUAL
SCALE
1/4" = 1'-0"
PROJECT NUMBER
2016-0700

A300

WINDOW SCHEDULE								
#	Type	Rough Opening		Egress	Type	Glass Type	Head Height	Comments
		Width	Height					
112	A	2' - 0"	3' - 2"	Yes	CA	IG Low E II with Argon	6' - 8"	ALIGN HEAD WITH ADJ 1ST FL WINDOWS
216	B	2' - 3"	4' - 2"	Yes	CA	IG Low E II with Argon	7' - 1 1/4"	ALIGN HEAD WITH ADJ 2ND FL WINDOWS
EX								

DOOR SCHEDULE						
Door Number	Width	Height	Details			Comments
			Head	Jamb	Sill	
001A	2' - 6"	6' - 0"				VERIFY HEIGHT WILL CLEAR SLOPED CLG
102A	2' - 6"	6' - 8"				
104A	3' - 0"	6' - 8"				REUSE EXISTING 15 LITE DOOR LEAF IN NEW POCKET DOOR OPENING
104B	2' - 9 1/2"	6' - 9 1/2"				15 LIGHT DOOR, SIM TO EXIST POCKET DOOR LEAF
104C	2' - 9 1/2"	6' - 9 1/2"				WOOD SCREEN DOOR
201A	2' - 6"	6' - 0"				VERIFY HEIGHT WILL CLEAR SLOPED CLG
202A	2' - 6"	6' - 0"				VERIFY HEIGHT WILL CLEAR SLOPED CLG
203A	1' - 6"	6' - 8"				
205A	2' - 6"	6' - 8"				REUSE SALVAGED DOOR
205B	2' - 6"	6' - 8"				REUSE SALVAGED DOOR
206A	2' - 6"	6' - 8"				REUSE SALVAGED DOOR
206B	2' - 6"	6' - 0"				VERIFY HEIGHT WILL CLEAR SLOPED CLG

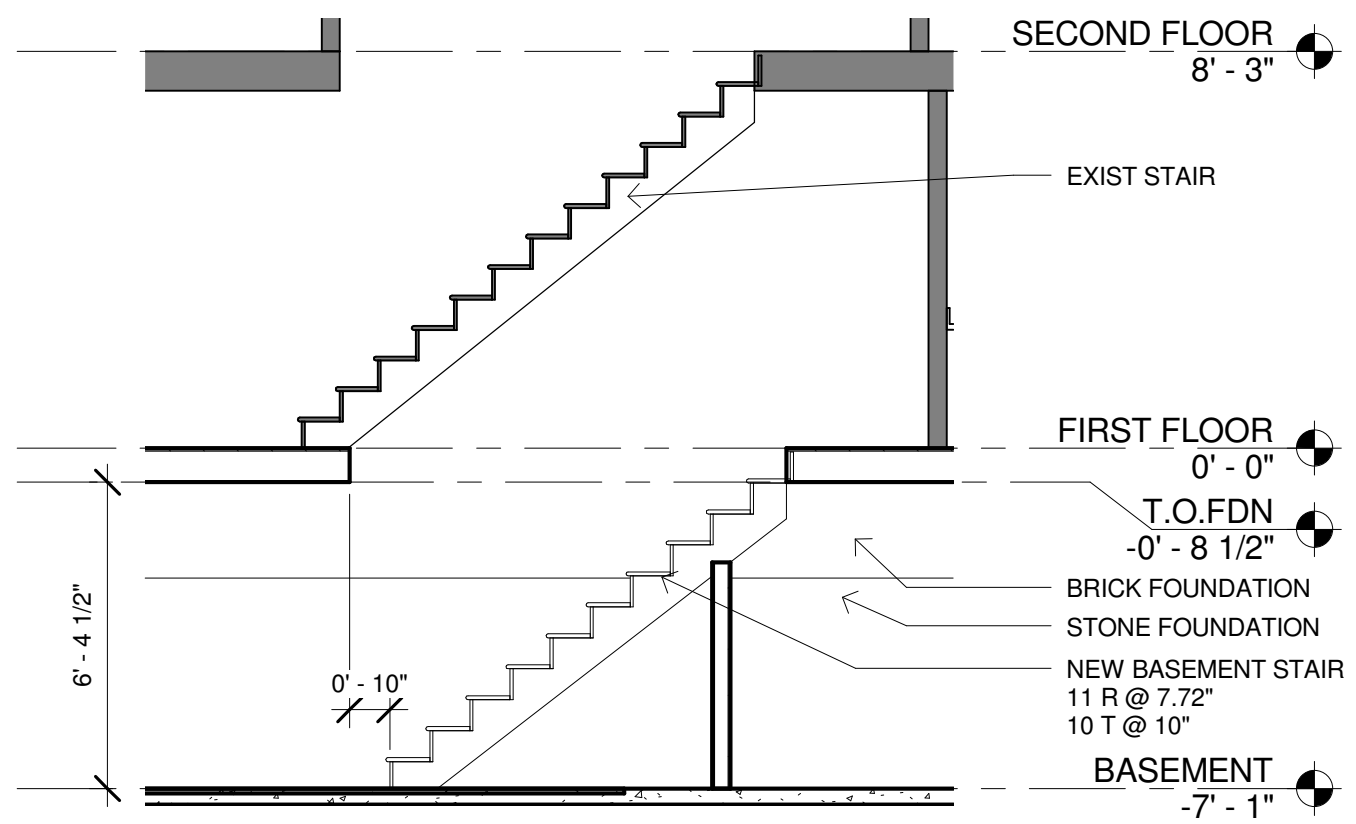

2 STAIR SECTION
A300 1/4" = 1'-0"



1 EXT SOUTH ELEV
A300 1/4" = 1'-0"