

DISPLAY THIS CARD ON PRINCIPAL FRONTAGE OF WORK

CITY OF PORTLAND

BUILDING INSPECTION

PERMIT

Permit Number: 060089

Please Read Application And Notes, If Any, Attached

Scanned

This is to certify that V S H REALTY INC /CRM Construction Services, Inc.

has permission to add 2nd floor for storage only -exterior stairs with inside dumb waiter

AT 49 PINE ST

CBL 055 B043001

provided that the person or persons, firm or corporation accepting this permit shall comply with all of the provisions of the Statutes of Maine and of the Ordinances of the City of Portland regulating the construction, maintenance and use of buildings and structures, and of the application on file in this department.

Apply to Public Works for street line and grade if nature of work requires such information.

Notification of inspection must be given and written permission procured before this building or part thereof is lathed or otherwise closed-in. 24 HOUR NOTICE IS REQUIRED.

A certificate of occupancy must be procured by owner before this building or part thereof is occupied.

OTHER REQUIRED APPROVALS

Fire Dept. _____

Health Dept. _____

Appeal Board _____

Other _____

Department Name

Director - Building & Inspection Services

PENALTY FOR REMOVING THIS CARD

City of Portland, Maine - Building or Use Permit Application

389 Congress Street, 04101 Tel: (207) 874-8703, Fax: (207) 874-8716

Permit No: 06-0089	Issue Date:	CBL: 055 B043001
-----------------------	-------------	---------------------

Location of Construction: 49 PINE ST	Owner Name: V S H REALTY INC	Owner Address: 777 DEDHAM ST # V0546	Phone:
Business Name:	Contractor Name: CRM Construction, Services, Inc.	Contractor Address: 94 Washington Street Auburn	Phone 2077840287
Lessee/Buyer's Name	Phone:	Permit Type: Alterations - Commercial	Zone: B1

Past Use: Commercial	Proposed Use: Commercial/ add 2nd floor for storage only -exterior stairs with inside dumb waiter	Permit Fee: \$156.00	Cost of Work: \$15,000.00	CEO District: 2
Proposed Project Description: add 2nd floor for storage only -exterior stairs with inside dumb waiter		FIRE DEPT: <input type="checkbox"/> Approved <input type="checkbox"/> Denied	INSPECTION: Use Group: Type:	
		Signature: Signature:		
PEDESTRIAN ACTIVITIES DISTRICT (P.A.D.) Action: <input type="checkbox"/> Approved <input type="checkbox"/> Approved w/Conditions <input type="checkbox"/> Denied Signature: Date:				

DENIED

Permit Taken By: Idobson	Date Applied For: 01/17/2006	Zoning Approval
-----------------------------	---------------------------------	------------------------

1. This permit application does not preclude the Applicant(s) from meeting applicable State and Federal Rules. 2. Building permits do not include plumbing, septic or electrical work. 3. Building permits are void if work is not started within six (6) months of the date of issuance. False information may invalidate a building permit and stop all work..	Special Zone or Reviews <input type="checkbox"/> Shoreland <input type="checkbox"/> Wetland <input type="checkbox"/> Flood Zone <input type="checkbox"/> Subdivision <input type="checkbox"/> Site Plan Maj <input type="checkbox"/> Minor <input type="checkbox"/> MM <input type="checkbox"/> Date:	Zoning Appeal <input type="checkbox"/> Variance <input type="checkbox"/> Miscellaneous <input type="checkbox"/> Conditional Use <input type="checkbox"/> Interpretation <input type="checkbox"/> Approved <input type="checkbox"/> Denied Date:	Historic Preservation ya. <input type="checkbox"/> Not in District or Landmark <input type="checkbox"/> Does Not Require Review <input type="checkbox"/> Requires Review <input type="checkbox"/> Approved <input type="checkbox"/> Approved w/Conditions <input type="checkbox"/> Denied Date:
--	---	---	--

CERTIFICATION

I hereby certify that I am the owner of record of the named property, or that the proposed work is authorized by the owner of record and that I have been authorized by the owner to make this application as his authorized agent and I agree to conform to all applicable laws of this jurisdiction. In addition, if a permit for work described in the application is issued, I certify that the code official's authorized representative shall have the authority to enter all areas covered by such permit at any reasonable hour to enforce the provision of the code(s) applicable to such permit.

SIGNATURE OF APPLICANT ADDRESS DATE PHONE

RESPONSIBLE PERSON IN CHARGE OF WORK, TITLE DATE PHONE

City of Portland, Maine - Building or Use Permit Application

389 Congress Street, 04101 Tel: (207) 874-8703, Fax: (207) 874-8716

Permit No: 06-0089	Issue Date:	CBL: 055 B043001
------------------------------	--------------------	----------------------------

Location of Construction: 49 PINE ST	Owner Name: V S H REALTY INC	Owner Address: 777 DEDHAM ST # V0546	Phone:
Business Name:	Contractor Name: CRM Construction, Services, Inc.	Contractor Address: 94 Washington Street Auburn	Phone: 2077840287
Lessee/Buyer's Name	Phone:	Permit Type: Alterations - Commercial	Zone: B1

Past Use: Commercial	Proposed Use: Commercial/ add 2nd floor for storage only -exterior stairs with inside dumb waiter	Permit Fee: \$156.00	Cost of Work: \$15,000.00	CEO District: 2
Proposed Project Description: add 2nd floor for storage only -exterior stairs with inside dumb waiter		FIRE DEPT: <input type="checkbox"/> Approved <input type="checkbox"/> Denied	INSPECTION: Use Group: Type:	
		Signature:	Signature:	

PEDESTRIAN ACTIVITIES DISTRICT (P.A.D.)	
Action: <input type="checkbox"/> Approved	<input type="checkbox"/> Approved w/Conditions <input type="checkbox"/> Denied
Signature:	Date:

Permit Taken By: ldobson	Date Applied For: 01/17/2006	Zoning Approval	
------------------------------------	--	------------------------	--

<ol style="list-style-type: none"> This permit application does not preclude the Applicant(s) from meeting applicable State and Federal Rules. Building permits do not include plumbing, septic or electrical work. Building permits are void if work is not started within six (6) months of the date of issuance. False information may invalidate a building permit and stop all work.. 	Special Zone or Reviews <input type="checkbox"/> Shoreland <input type="checkbox"/> Wetland <input type="checkbox"/> Flood Zone <input type="checkbox"/> Subdivision <input type="checkbox"/> Site Plan Maj <input type="checkbox"/> Minor <input type="checkbox"/> MM <input type="checkbox"/> Date:	Zoning Appeal <input type="checkbox"/> Variance <input type="checkbox"/> Miscellaneous <input type="checkbox"/> Conditional Use <input type="checkbox"/> Interpretation <input type="checkbox"/> Approved <input type="checkbox"/> Denied Date:	Historic Preservation ya. <input type="checkbox"/> Not in District or Landmark <input type="checkbox"/> Does Not Require Review <input type="checkbox"/> Requires Review <input type="checkbox"/> Approved <input type="checkbox"/> Approved w/Conditions <input type="checkbox"/> Denied Date:
---	---	---	--

CERTIFICATION

I hereby certify that I am the owner of record of the named property, or that the proposed work is authorized by the owner of record and that I have been authorized by the owner to make this application as his authorized agent and I agree to conform to all applicable laws of this jurisdiction. In addition, if a permit for work described in the application is issued, I certify that the code official's authorized representative shall have the authority to enter all areas covered by such permit at any reasonable hour to enforce the provision of the code(s) applicable to such permit.

SIGNATURE OF APPLICANT	ADDRESS	DATE	PHONE
RESPONSIBLE PERSON IN CHARGE OF WORK, TITLE		DATE	PHONE



General Building Permit Application

If you or the property owner owes real estate or personal property taxes or user charges on any property within the City, payment arrangements must be made before permits of any kind are accepted.

Location/Address of Construction: <u>49 Pine St.</u>		
Total Square Footage of Proposed Structure <u>350 sq' +/-</u>		Square Footage of Lot <u>9602 sq'</u>
Tax Assessor's Chart, Block & Lot Chart# Block# Lot# <u>055 0043 001</u>	Owner: <u>USA Realty Inc.</u> <u>777 DEDHAM ST</u> <u># 40546</u> <u>CANTON MA. 02041</u>	Telephone: <u>217-650 7860</u>
Lessee/Buyer's Name (If Applicable)	Applicant name, address & telephone: <u>C.R.M. Construction</u> <u>94 Washington North</u> <u>Auburn, Maine 04210</u>	Cost Of Work: \$ <u>15,000.⁰⁰</u> Fee: \$ <u>156.⁰⁰</u> C of O Fee: \$ <u>156.⁰⁰</u>
Current Specific use: <u>Commercial - Store + gas station</u> Proposed Specific use: <u>Same - Storage</u>		
Project description: <u>ADD 2nd Floor for storage only - Exterior stairs with inside dumbwaiter - lights + heat only.</u>		
Contractor's name, address & telephone:		
Who should we contact when the permit is ready: <u>Bob Morin</u>		CRM Construction Services Inc. 94 Washington Street Auburn, ME 04210 (207) 784-0287
Mailing address: _____ Phone: <u>650-7860</u>		

Please submit all of the information outlined in the Commercial Application Checklist. Failure to do so will result in the automatic denial of your permit.

In order to be sure the City fully understands the full scope of the project, the Planning and Development Department may request additional information prior to the issuance of a permit. For further information visit us on-line @ www.portlandmaine.gov, stop by the Building Inspections office, room 315 City Hall or call 874-8700.

I hereby certify that I am the Owner of record of the named property, or that the owner of record authorizes the proposed work and that I have been authorized by the owner to make this application as his/her authorized agent. I agree to conform to all applicable laws of this jurisdiction. In addition, if a permit for work described in this application is issued, I certify that the Code Official's authorized representative shall have the authority to enter all areas covered by this permit at any reasonable hour to enforce the provisions of the codes applicable to this permit.

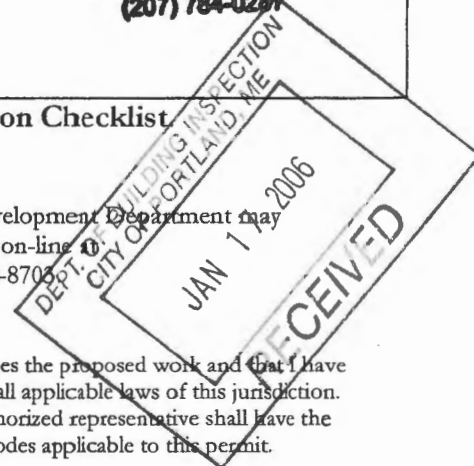

Signature of applicant: <u>Robert Morin</u>	Date: _____
---	-------------

This is not a permit; you may not commence ANY work until the permit is issued.

Cumberland Farms Pine Street

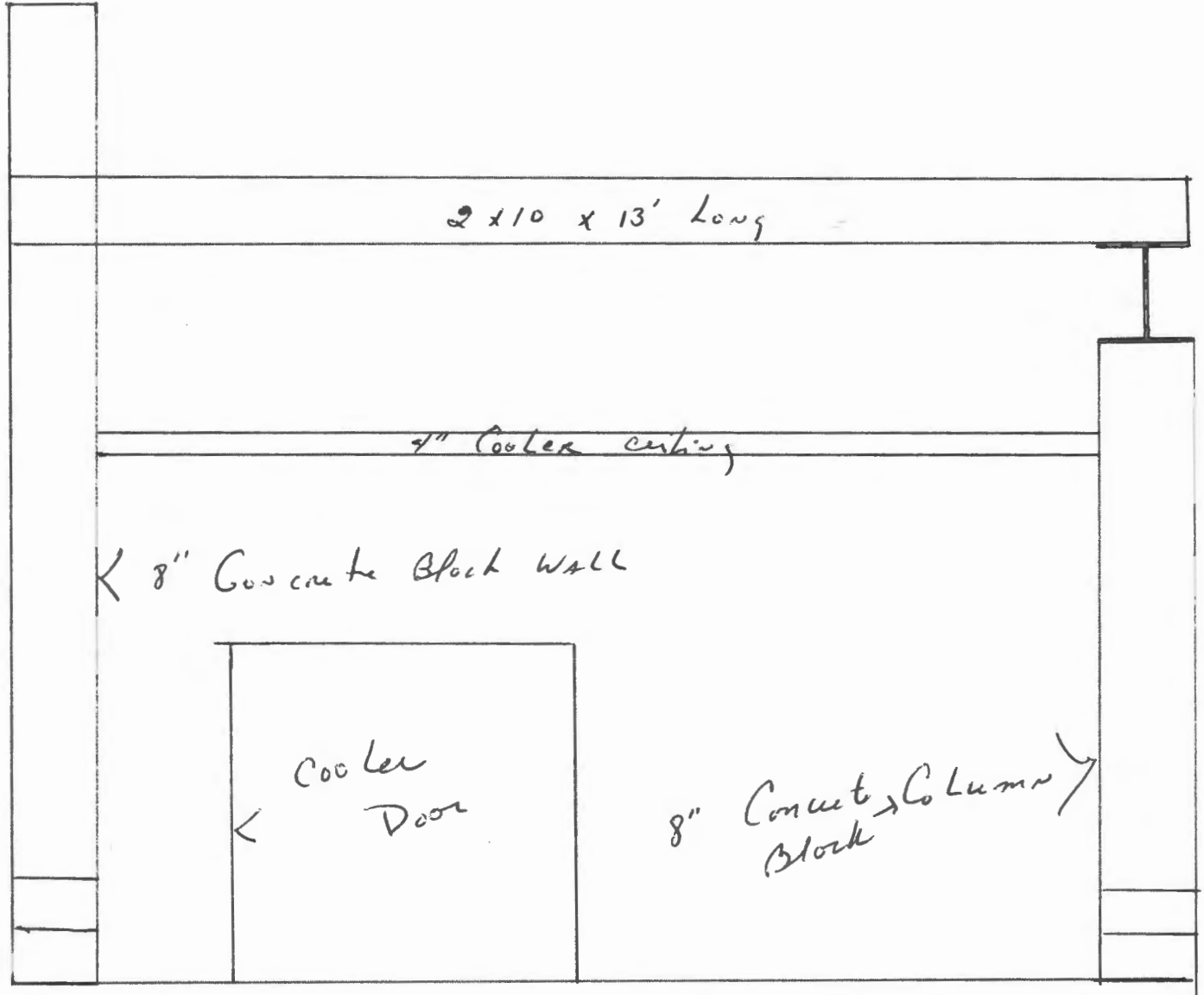

Existing Building

8" Concrete Block
PARAPET wall.

4" Roof Insulation

5/8" Plywood

Steel Beam

TYPICAL
2 "110" 10C
16

Inside Cooler

8" Concrete Block wall

8" Concrete Block wall

Existing Cooler + Building

metal roof

PRE-ENGINEERED TRUSSES

1/2" Extension
ply wood

R-19
Insulation

R-11

vinyl siding

5/8" plywood

2" x 12" x 16' 8" oc

2" x 12" Sistered to Existing 2" x 10"

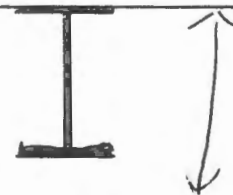

Cantilevered
2 x 10
3'

NEW Construction

8" Concrete Block
PARAPET WALL.

4" Roof Insulation

5/8" Plywood

ADD 2" x 12" to each 2' x 10"

Steel Beam

Typical
2" x 10"
16' OC

Inside Cooler

8" Concrete Block Wall

8" Concrete Block wall

NEW

SECTIONAL Cooler + Building

Site Plan

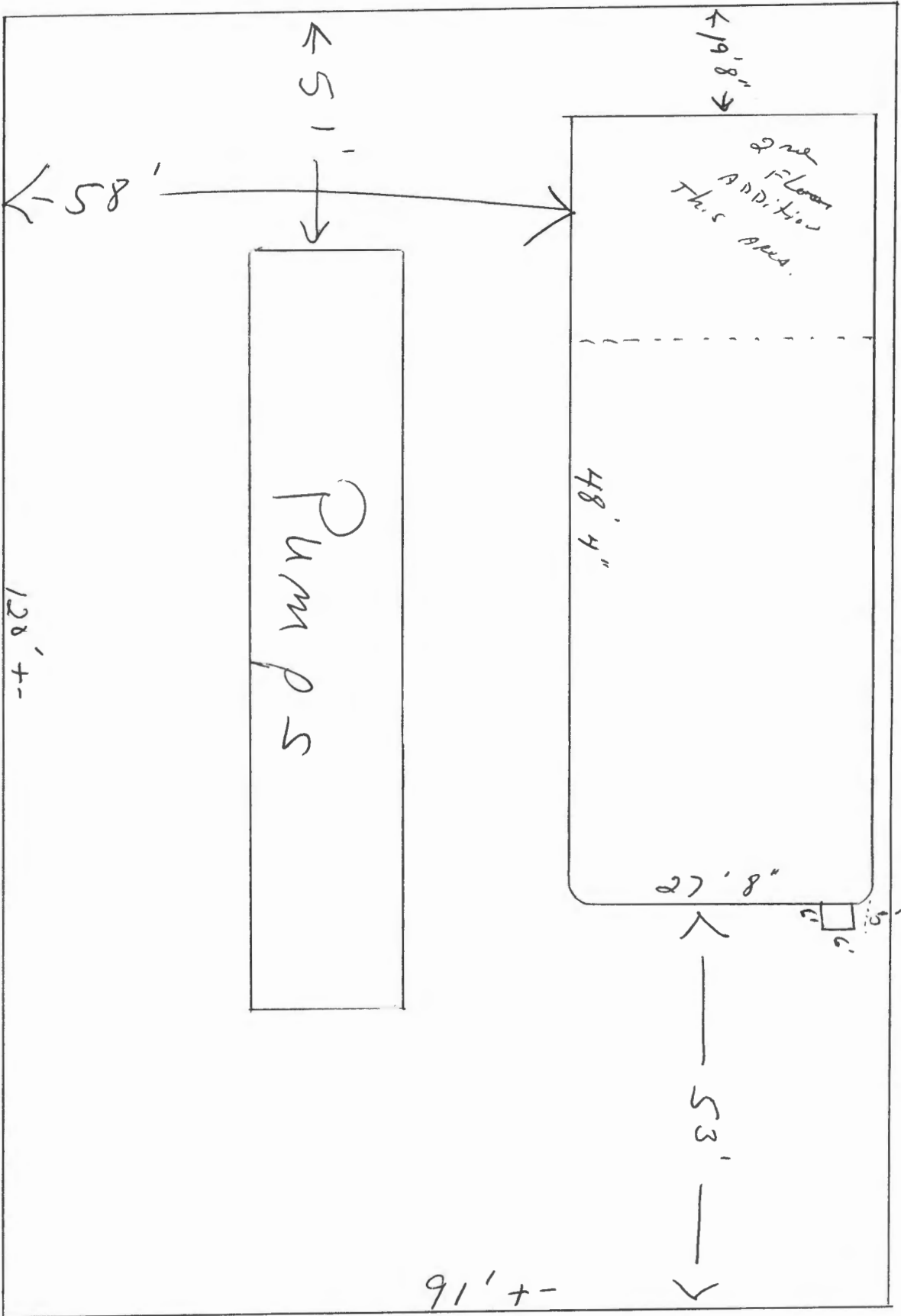

Pine Street

Brackett Street