

project name

Butler Payson
pine st.
state st.
portland, me

avesta housing

goduti/thomas architects

44 oak st.

portland, maine 04101

ph. 207-775-3184

fax 207-774-0486



SWIFTCURRENT
Engineering Services
10 Forest Falls Dr. Unit 4b
Yarmouth, ME 04096
Tel: (207) 847-9280

ISSUED FOR PERMIT

revisions

date

Feb. 6, 2015

sheet title

ELECTRICAL FLOOR PLAN -
BASEMENT

scale: as shown

drawn by:JMD checked by:TDM

project number

NOTES:

1. SEE E0.0 FOR LEGEND, ABBREVIATIONS AND GENERAL NOTES.
2. REPLACE EXISTING CORRIDOR LIGHTS IN PLACE WITH NEW FIXTURES. REWIRE TO EXISTING CIRCUITS AND CONTROLS.

KEYED NOTES:

- 1 INTERCOM CONTROL PANEL FOR FOR HEARING IMPAIRED UNITS. EXISTING INTERCOM SYSTEM TO BE RETAINED FOR OTHER 37 UNITS. TELEPHONE BASED INTERCOM SYSTEM WITH TTY INTERFACE TO BE PROVIDED FOR THE (2) HEARING IMPAIRED UNITS.

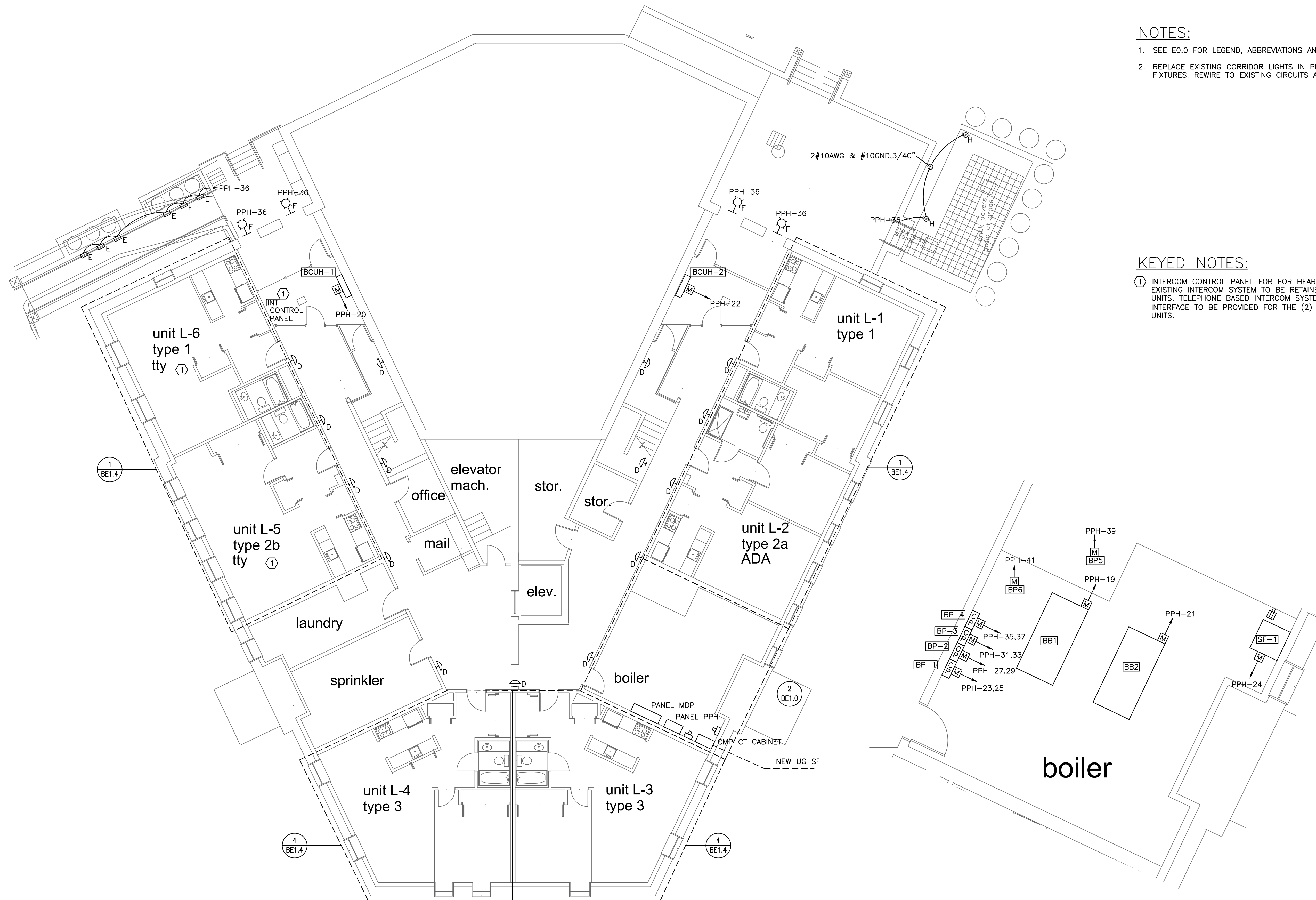

1 ELECTRICAL POWER & SYSTEMS PLAN - BASEMENT
SCALE: 1/8"=1'

1 ELECTRICAL DETAIL - BOILER ROOM
SCALE: 1/4"=1'

BE1.0