

← 55' →

← 40' 2" →

← 11' 9" →

24' 10" Office

Workspace
+
Modular storage
(some shelving, cabinets
for storage of limited
materials + tools)

↑
45' 9"
↓

↑
58'
↓

Closest

← 7' 4" →

Office ↑
19' 5"
↓

one
step
down

Iron
Railing

← 5' 8" →

Bathroom

↑
6"
↓

↑
4'
↓

← 5' 3" →

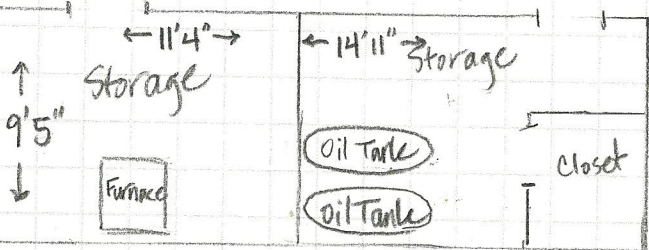

Garage Door

Main
Entry

1/4 inch = 2 feet

173 Neal Street

Interior - Floor Plan: Existing, no changes planned

Floor at main entry
is higher than ground
level (about 15").
There is a secure
iron railing along
this area.