

DISPLAY THIS CARD ON PRINCIPAL FRONTAGE OF WORK



CITY OF PORTLAND BUILDING PERMIT

This is to certify that ROBERT BLAIK

Located At 166 NEAL STREET

Job ID: 2011-06-1505-SIGN

CBL: 054 - - F - 040 - 001 - - - - -

has permission to INSTALL A 2 SQ FT SIGN ATTACHED TO THE BUILDING
provided that the person or persons, firm or corporation accepting this permit shall comply with all of the provisions of the Statues of Maine and of the Ordinances of the City of Portland regulating the construction, maintenance and use of the buildings and structures, and of the application on file in the department.

Notification of inspection and written permission procured before this building or part thereof is lathed or otherwise closed-in. 48 HOUR NOTICE IS REQUIRED.

A final inspection must be completed by owner before this building or part thereof is occupied. If a certificate of occupancy is required, it must be

N/A

Fire Prevention Officer

Mary Schmitt 7/8/14

Code Enforcement Officer / Plan Reviewer

**THIS CARD MUST BE POSTED ON THE STREET SIDE OF THE PROPERTY
PENALTY FOR REMOVING THIS CARD**

BUILDING PERMIT INSPECTION PROCEDURES

Please call 874-8703 or 874-8693 (ONLY)

or email: buildinginspections@portlandmaine.gov

With the issuance of this permit, the owner, builder or their designee is required to provide adequate notice to the city of Portland Inspections Services for the following inspections. Appointments must be requested 48 to 72 hours in advance of the required inspection. The inspection date will need to be confirmed by this office.

- **Please read the conditions of approval that is attached to this permit!! Contact this office if you have any questions.**
- **Permits expire in 6 months. If the project is not started or ceases for 6 months.**
- **If the inspection requirements are not followed as stated below additional fees may be incurred due to the issuance of a "Stop Work Order" and subsequent release to continue.**

The project cannot move to the next phase prior to the required inspection and approval to continue, REGARDLESS OF THE NOTICE OF CIRCUMSTANCES.

IF THE PERMIT REQUIRES A CERTIFICATE OF OCCUPANCY, IT MUST BE PAID FOR AND ISSUED TO THE OWNER OR DESIGNEE BEFORE THE SPACE MAY BE OCCUPIED.



Strengthening a Remarkable City. Building a Community for Life • www.portlandmaine.gov

Director of Planning and Urban Development
Penny St. Louis

Job ID: 2011-06-1505-SIGN

Located At: 166 NEAL STREET



CBL: 054 - - F - 040 - 001 - - - -

Conditions of Approval:

1. This property is located within a Historic District.
2. This 2 square foot sign is the maximum allowed for the approved home occupation.
3. This sign is exempt from Building Codes review by Ordinance.

City of Portland, Maine - Building or Use Permit Application

389 Congress Street, 04101 Tel: (207) 874-8703, FAX: (207) 8716

Job No: 2011-06-1505-SIGN	Date Applied: 6/17/2011	CBL: 054 - - F - 040 - 001 - - - - -	
Location of Construction: 166 NEAL ST	Owner Name: ROBERT BLAIK	Owner Address: 166 NEAL ST PORTLAND, ME - MAINE 04102	Phone: 329-8637
Business Name:	Contractor Name: The Sign Shop	Contractor Address: 27 Fountain ST GARDNER MAINE 04345	Phone: (207) 582-2542
Lessee/Buyer's Name:	Phone:	Permit Type: sign	Zone: R-6
Past Use: Two Family with a home occupation in the owner's unit (therapist) see permit #2011-04-930	Proposed Use: Same: Two Family with a home occupation in owner's unit - to install a 2 sq ft sign for the home occupation	Cost of Work:	CEO District:
		Fire Dept: <input type="checkbox"/> Approved <input type="checkbox"/> Denied <input checked="" type="checkbox"/> N/A	Inspection: Use Group: Type: <i>N/A</i>
		Signature: 	Signature: 
Proposed Project Description: Install sign for Home Occ		Pedestrian Activities District (P.A.D.)	
Permit Taken By: Lannie		Zoning Approval	

<p>1. This permit application does not preclude the Applicant(s) from meeting applicable State and Federal Rules.</p> <p>2. Building Permits do not include plumbing, septic or electrical work.</p> <p>3. Building permits are void if work is not started within six (6) months of the date of issuance. False informatin may invalidate a building permit and stop all work.</p>	<p>Special Zone or Reviews</p> <p><input type="checkbox"/> Shoreland</p> <p><input type="checkbox"/> Wetlands</p> <p><input type="checkbox"/> Flood Zone</p> <p><input type="checkbox"/> Subdivision</p> <p><input type="checkbox"/> Site Plan</p> <p><input type="checkbox"/> Maj <input type="checkbox"/> Min <input type="checkbox"/> MM</p> <p>Date: <i>OK with conditions 6/23/11</i></p>	<p>Zoning Appeal</p> <p><input type="checkbox"/> Variance</p> <p><input type="checkbox"/> Miscellaneous</p> <p><input type="checkbox"/> Conditional Use</p> <p><input type="checkbox"/> Interpretation</p> <p><input type="checkbox"/> Approved</p> <p><input type="checkbox"/> Denied</p> <p>Date:</p>	<p>Historic Preservation</p> <p><i>with</i></p> <p><input type="checkbox"/> Not in Dist or Landmark</p> <p><input type="checkbox"/> Does not Require Review</p> <p><input checked="" type="checkbox"/> Requires Review</p> <p><input checked="" type="checkbox"/> Approved</p> <p><input type="checkbox"/> Approved w/Conditions</p> <p><input type="checkbox"/> Denied</p> <p>Date: <i>7/5/11</i></p> <p><i>D. Andrews</i></p>
	CERTIFICATION		

I hereby certify that I am the owner of record of the named property, or that the proposed work is authorized by the owner of record and that I have been authorized by the owner to make this application as his authorized agent and I agree to conform to all applicable laws of this jurisdiction. In addition, if a permit for work described in the application is issued, I certify that the code official's authorized representative shall have the authority to enter all areas covered by such permit at any reasonable hour to enforce the provision of the code(s) applicable to such permit.

SIGNATURE OF APPLICANT	ADDRESS	DATE	PHONE
RESPONSIBLE PERSON IN CHARGE OF WORK, TITLE		DATE	PHON



Signage/Awning Permit Application

If you or the property owner owes real estate or personal property taxes or user charges on any property within the City, payment arrangements must be made before permits of any kind are accepted.

Location/Address of Construction: <u>166 Neal Street</u>		
Tax Assessor's Chart, Block & Lot Chart# <u>54</u> Block# <u>F</u> Lot# <u>40</u>	Owner: <u>ROBERT BLAIK</u>	Telephone: <u>207-324-8637</u>
Lessee/Buyer's Name (If Applicable) <u>N/A. Mail to - Thomas Coward 17 Woodbury St South Portland ME 04106</u>	Contractor name, address & telephone: <u>The Sign Shop Mark Felder 27 Fountain St. Gardiner ME 582-2542</u>	Total s.f. of signage x \$2.00 Per s.f. plus \$30.00/ \$65.00 For H.D. signage= Total Fee: \$ _____ Awning Fee= cost of work _____ Total Fee: \$ _____
Who should we contact when the permit is ready: <u>THOMAS COWARD</u> phone: <u>207-324-8637</u>		
Tenant/allocated building space frontage (feet): Length: _____ Height: _____ Lot Frontage (feet) _____ Single Tenant or Multi Tenant Lot _____		<u>2 Sq Ft P-S</u>
Current Specific use: <u>Residence (2 family) w/ Home Occupation</u> If vacant, what was prior use: _____ Proposed Use: <u>Residence with Home Occupation</u>		<u>HP \$75.00</u> <u>2x2 = 4.00</u>
Information on proposed sign(s): Freestanding (e.g., pole) sign? Yes _____ No <u>X</u> Dimensions proposed: _____ Height from grade: _____ Bldg. wall sign? (attached to bldg) Yes <u>X</u> No _____ Dimensions proposed: <u>16.9x16.9"</u> _____		<u>30.00</u>
Proposed awning? Yes _____ No <u>X</u> Is awning backlit? Yes _____ No <u>N/A</u> Height of awning: <u>N/A</u> Length of awning: <u>N/A</u> Depth: <u>N/A</u> Is there any communication, message, trademark or symbol on it? Yes _____ No _____ If yes, total s.f. of panels w/communications, message, trademark or symbol: _____		<u>75.00</u>
Information on existing and previously permitted sign(s): <u>N/A.</u> Freestanding (e.g., pole) sign? Yes _____ No _____ Dimensions: _____ Bldg. wall sign? (attached to bldg) Yes _____ No _____ Dimensions: _____ Awning? Yes _____ No _____ Sq. ft. area of awning w/communication: _____		<u>109.00</u>

RECEIVED

JUN 17 2011

Dept. of Building Inspections
City of Portland, Maine

2 Dr with HO in owners unit #2011-04 930

Please submit all of the information outlined in the Sign/Awning Application Checklist. Failure to do so may result in the automatic denial of your permit.

In order to be sure the City fully understands the full scope of the project, the Planning and Development Department may request additional information prior to the issuance of a permit. For further information visit us on-line at www.portlandmaine.gov, stop by the Building Inspections office, room 315 City Hall or call 874-8703.

I hereby certify that I am the Owner of record of the named property, or that the owner of record authorizes the proposed work and that I have been authorized by the owner to make this application as his/her authorized agent. I agree to conform to all applicable laws of this jurisdiction. In addition, if a permit for work described in this application is issued, I certify that the Code Official's authorized representative shall have the authority to enter all areas covered by this permit at any reasonable hour to enforce the provisions of the codes applicable to this permit.

Signature of applicant:

Thomas S. Coward, Attorney for Applicant
Date: 6/17/2011

This is not a permit; you may not commence ANY work until the permit is issued.



☒ = Proposed sign Location

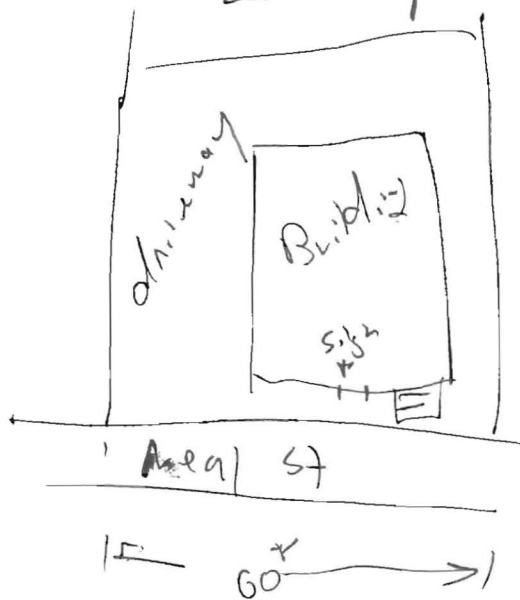

207-553-1331

Deborah

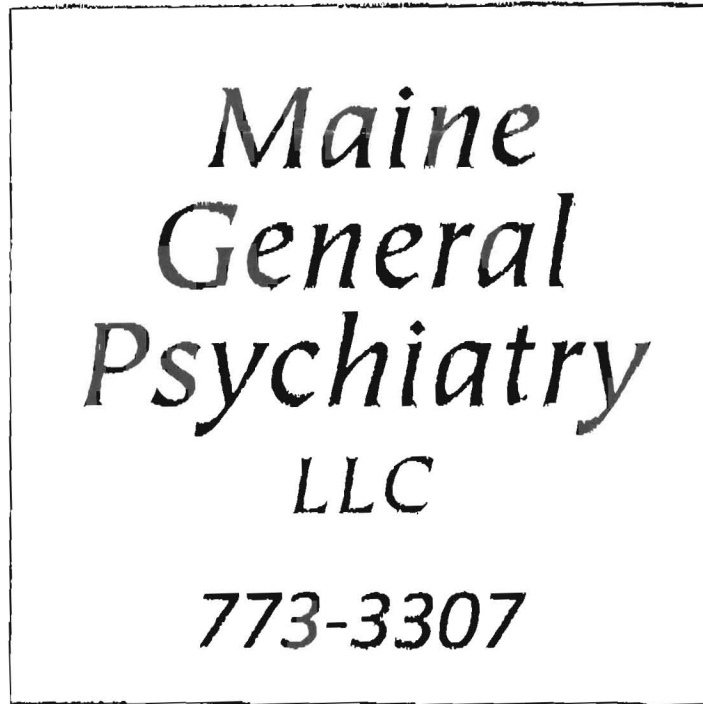

Single

MDO/PLY DOUBLE SIDED SIGN

16.9" X 16.9" = 1.98 sq ft

= 285.61 # ÷ 144 = 1.98 #

BACKGROUND COLOR : BLACK

LETTERING AND OUTLINE : GOLD COLOR

* Also, to be included, within
the four (4) borders, will be
the contours of the STATE OF MAINE

Sincerely
Bob



CITY OF PORTLAND, MAINE

Department of Building Inspections

Original Receipt

July 17 2011

Received from Tribus Enterprises

Location of Work 166 Abel

Cost of Construction \$ _____ Building Fee: _____

Permit Fee \$ _____ Site Fee: _____

Certificate of Occupancy Fee: _____

Total: _____

Building (IL) _____ Plumbing (I5) _____ Electrical (I2) _____ Site Plan (U2) _____

Other _____

CBL: 054 F40

HP 3000
400

Check #: 4619 Total Collected \$ 1090.0

**No work is to be started until permit issued.
Please keep original receipt for your records.**

Taken by: [Signature]

WHITE - Applicant's Copy
YELLOW - Office Copy
PINK - Permit Copy