

← BRAMHALL STREET →

↑ CONGRESS STREET ↓

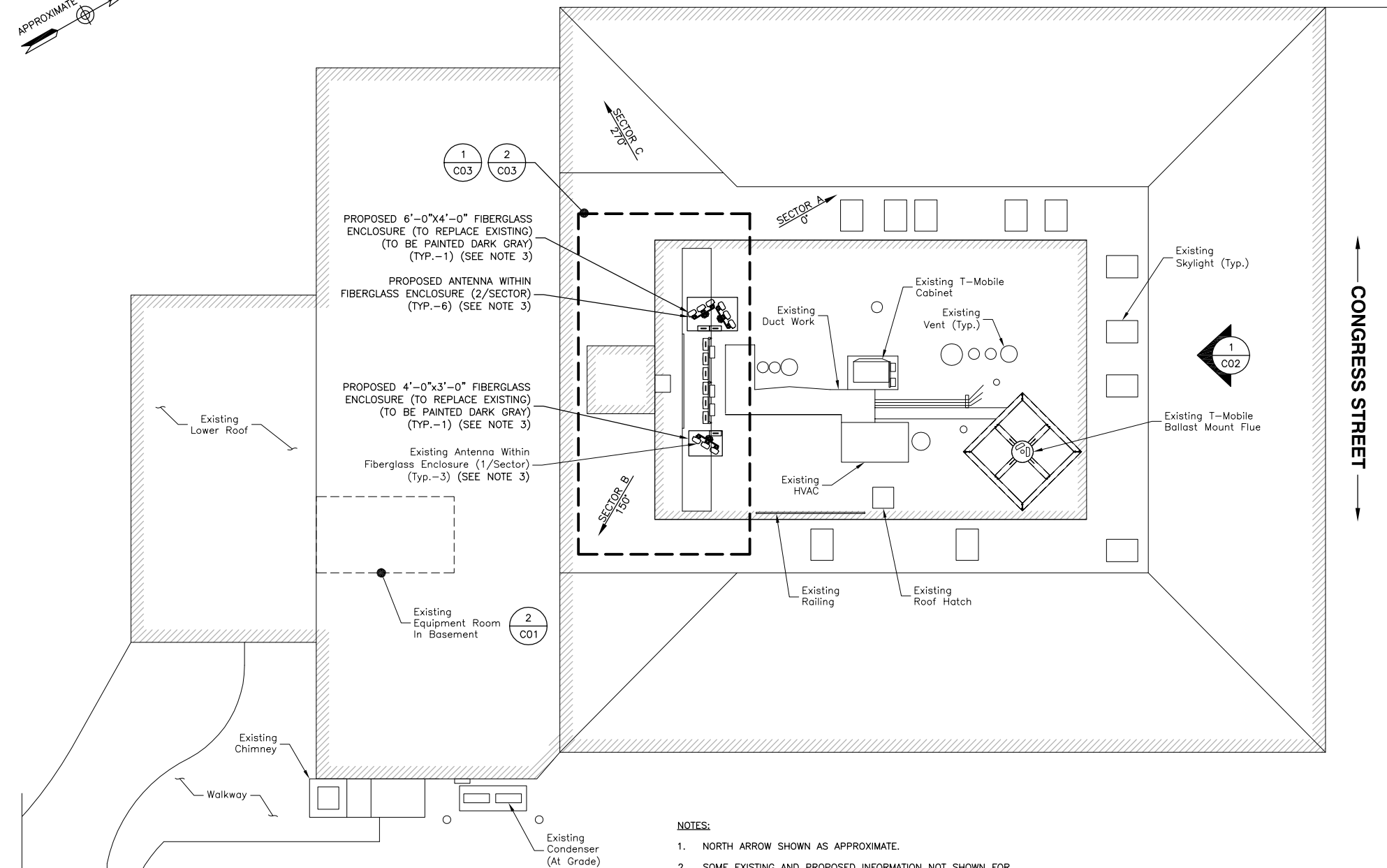

- NOTES:**
1. NORTH ARROW SHOWN AS APPROXIMATE.
 2. SOME EXISTING AND PROPOSED INFORMATION NOT SHOWN FOR CLARITY.
 3. ALL PROPOSED EQUIPMENT AND ANTENNA INSTALLATION PENDING STRUCTURAL ANALYSIS AND DESIGN.
 4. PROPOSED FIBERGLASS TO BE PAINTED TO MATCH FINAL FIBERGLASS DESIGN BY FIBERGLASS MANUFACTURER.

PROPOSED ROOF PLAN 1
 SCALE: 1/16"=1' FOR 11"x17"
 1/8"=1' FOR 22"x34"
 0' 4' 8' 16'

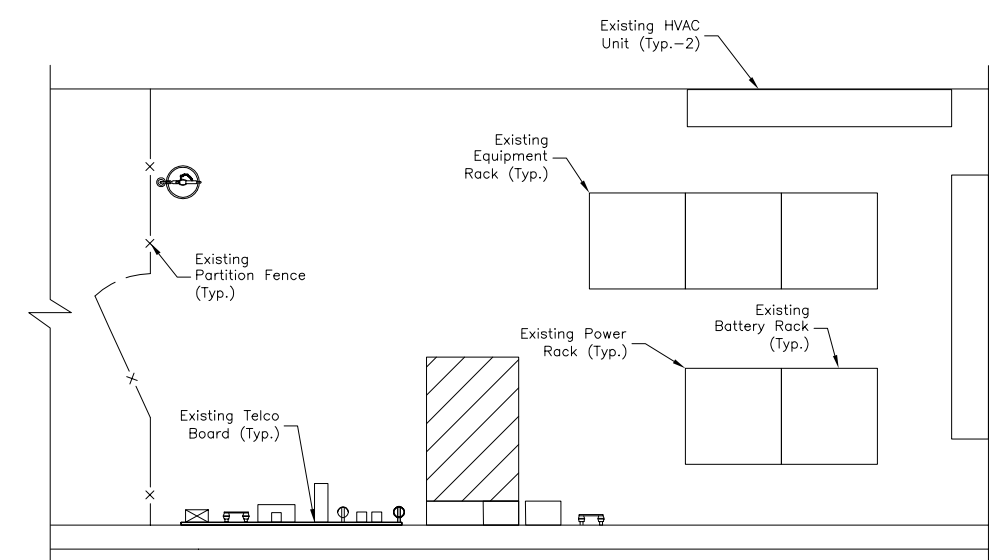

- NOTES:**
1. SOME EXISTING AND PROPOSED INFORMATION NOT SHOWN FOR CLARITY.
 2. THERE SHALL BE NO PROPOSED EQUIPMENT AS PART OF THE CURRENT SCOPE OF WORK.

EQUIPMENT ROOM PLAN 2
 SCALE: 1/4"=1' FOR 11"x17"
 1/2"=1' FOR 22"x34"
 0' 1' 2' 4'

Dewberry
 Dewberry Engineers Inc.
 280 SUMMER ST.
 10TH FLOOR
 BOSTON, MA 02210
 PHONE: 617.695.3400
 FAX: 617.695.3310

SAI
 27 NORTHWESTERN DRIVE
 SALEM, NH 03079

HOLT HALL
SITE NO. ME5091 LTE 3C/4C
 794 CONGRESS STREET
 PORTLAND, ME 04102

at&t
 Mobility
 550 COCHITUATE ROAD
 SUITES 13 & 14
 FRAMINGHAM, MA 01701

0	12/22/18	ISSUED FOR REVIEW	JG	CDH	BBR
NO.	DATE	REVISIONS	BY	CHK	APP'D
SCALE: AS SHOWN		DESIGNED BY: CDH	DRAWN BY: JG		

AT&T MOBILITY
 FRAMINGHAM, MA 01701

GROUNDING DETAILS

DEWBERRY NO.	DRAWING NUMBER	REV
50019239/50066401	E01	0