



550 COCHITUATE ROAD
SUITES 13 & 14
FRAMINGHAM, MA 01701



22 KEEWAYDIN DRIVE
SALEM, NH 03079

HOLT HALL
SITE NO.: ME2980

CONSTRUCTION DRAWINGS

0 03/15/13 FOR CONSTRUCTION
A 03/12/13 FOR COMMENT



Dewberry Engineers Inc.
280 SUMMER STREET
10TH FLOOR
BOSTON, MA 02210
PHONE: 617.695.3400
FAX: 617.695.3310

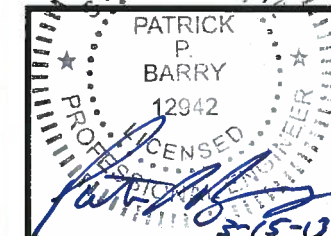

DRAWN BY: MR

REVIEWED BY: DAS

CHECKED BY: PPB

PROJECT NUMBER: 50003936

JOB NUMBER: 50048548

SITE ADDRESS

794 CONGRESS STREET
PORTLAND, ME 04102

SHEET TITLE

PROPOSED BASEMENT PLAN

SHEET NUMBER

C-3

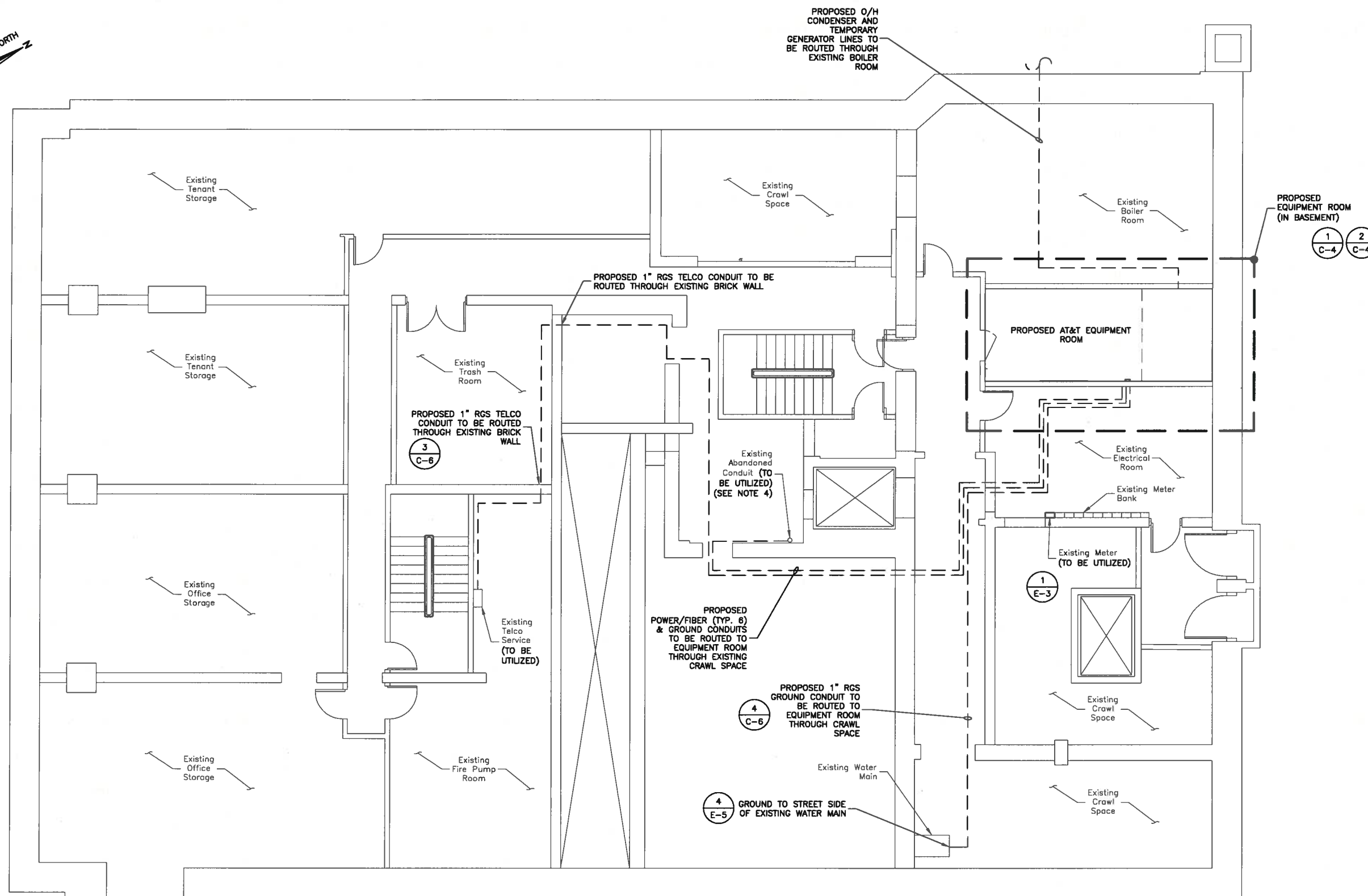

PROPOSED BASEMENT PLAN 1

SCALE: 3/32"=1' FOR 11"x17"
3/16"=1' FOR 22"x34"



NOTES:

1. NORTH ARROW SHOWN AS APPROXIMATE.
2. SOME EXISTING AND PROPOSED INFORMATION NOT SHOWN FOR CLARITY.
3. PLAN BASED ON OBSERVATIONS MADE DURING SITE VISIT BY DEWBERRY ENGINEERS INC. ON 05-30-12.
4. EXISTING CABLE FEED TO EXISTING YAGI ANTENNA TO BE UTILIZED FOR PROPOSED CABLING.
5. EXISTING ELECTRICAL, & UTILITY FEATURES, & MISCELLANEOUS ITEMS TO BE REMOVED FROM EQUIPMENT AREA.
6. ROUTING SHOWN IS APPROXIMATE. VERIFY ALL ROUTING WITH BUILDING OWNER AND CM PRIOR TO CONSTRUCTION.
7. ALL PENETRATIONS INTO FIRE RATED WALLS SHALL MAINTAIN FIRE RATING AND BE SEALED ACCORDINGLY.