

Project Title  
**Maine Heart Surgical Associates  
 New Office Building**  
 Portland, Maine

HA Project No. 04180  
 Key Plan

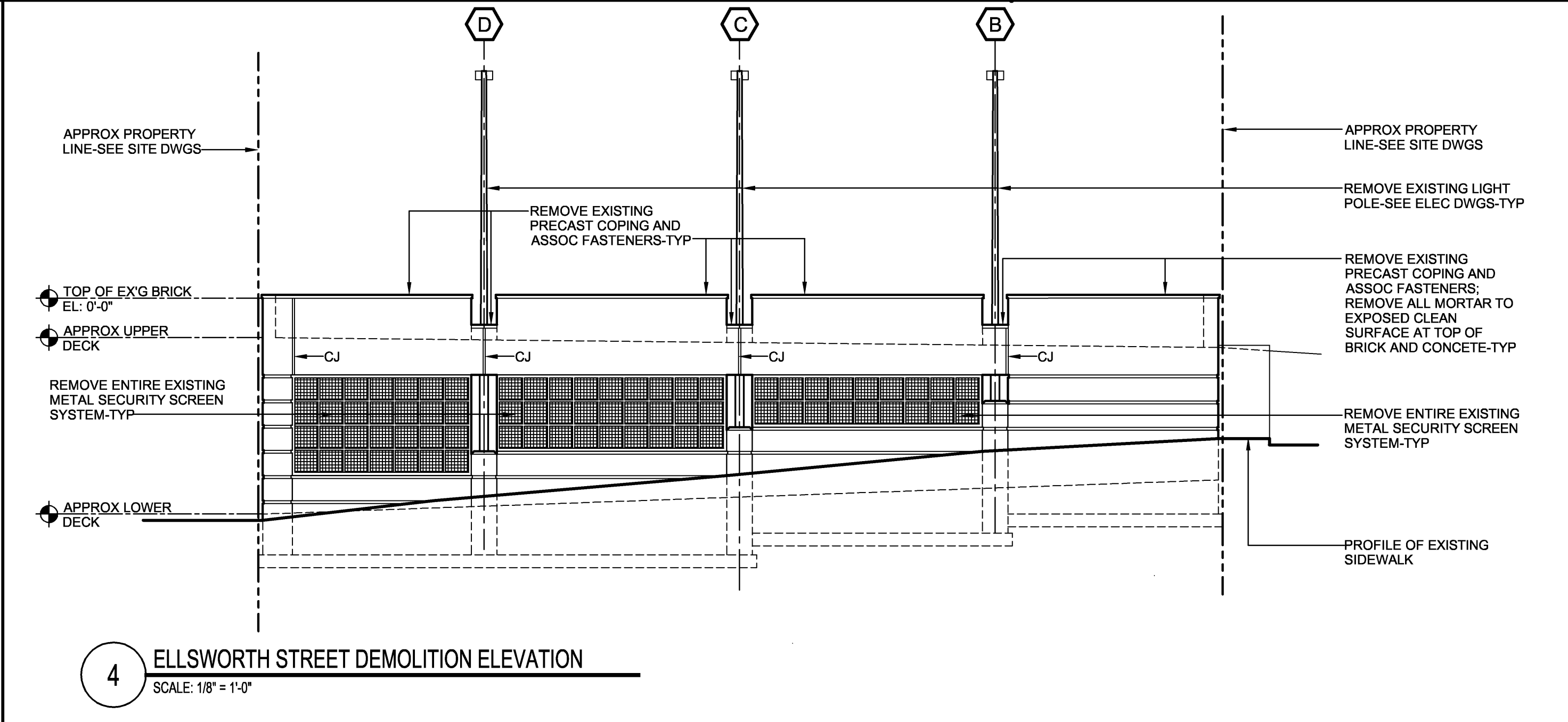

- GENERAL DEMOLITION NOTES**
- CONTRACTOR TO VERIFY ALL FIELD CONDITIONS PRIOR TO COMMENCEMENT OF CONSTRUCTION. FIELD CONDITIONS NOT AGREEING WITH CONSTRUCTION DOCUMENTS SHALL BE BROUGHT TO THE ARCHITECT'S ATTENTION PRIOR TO THE BEGINNING OF WORK.
  - CONTRACTOR SHALL NOT SCALE DRAWINGS. DISCREPANCIES BETWEEN EXISTING CONDITIONS AND DRAWINGS SHALL BE REPORTED TO THE ARCHITECT FOR CLARIFICATION PRIOR TO THE COMMENCEMENT OF CONSTRUCTION. NOTED DIMENSIONS TAKE PRECEDENCE OVER SCALE.
  - REMOVE SEALANT FROM ALL EXISTING EXTERIOR MASONRY CONTROL JOINTS. PREPARE SURFACES FOR NEW CONTROL JOINT MATERIAL.
  - ALL SURFACES DAMAGED BY CONSTRUCTION SHALL BE REPAIRED, PATCHED OR REFINISHED TO MATCH THEIR ADJACENT MATERIALS, AND/OR REPLACED EQUAL TO ORIGINAL STATE PRIOR TO THE COMMENCEMENT OF WORK, UNLESS OTHERWISE INDICATED ON DRAWINGS.
  - COORDINATE ALL CONCRETE REMOVAL WITH STRUCTURAL DRAWINGS.

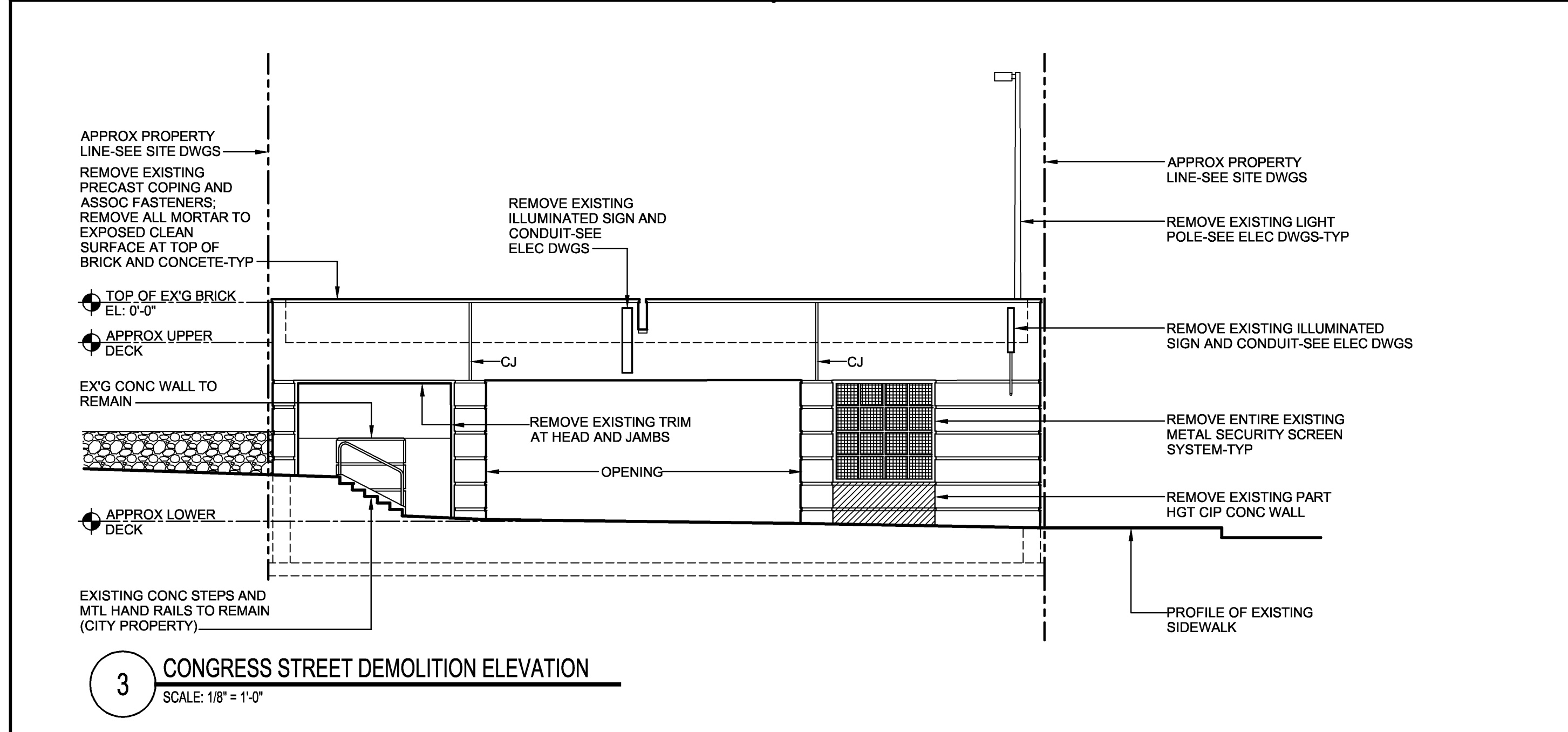
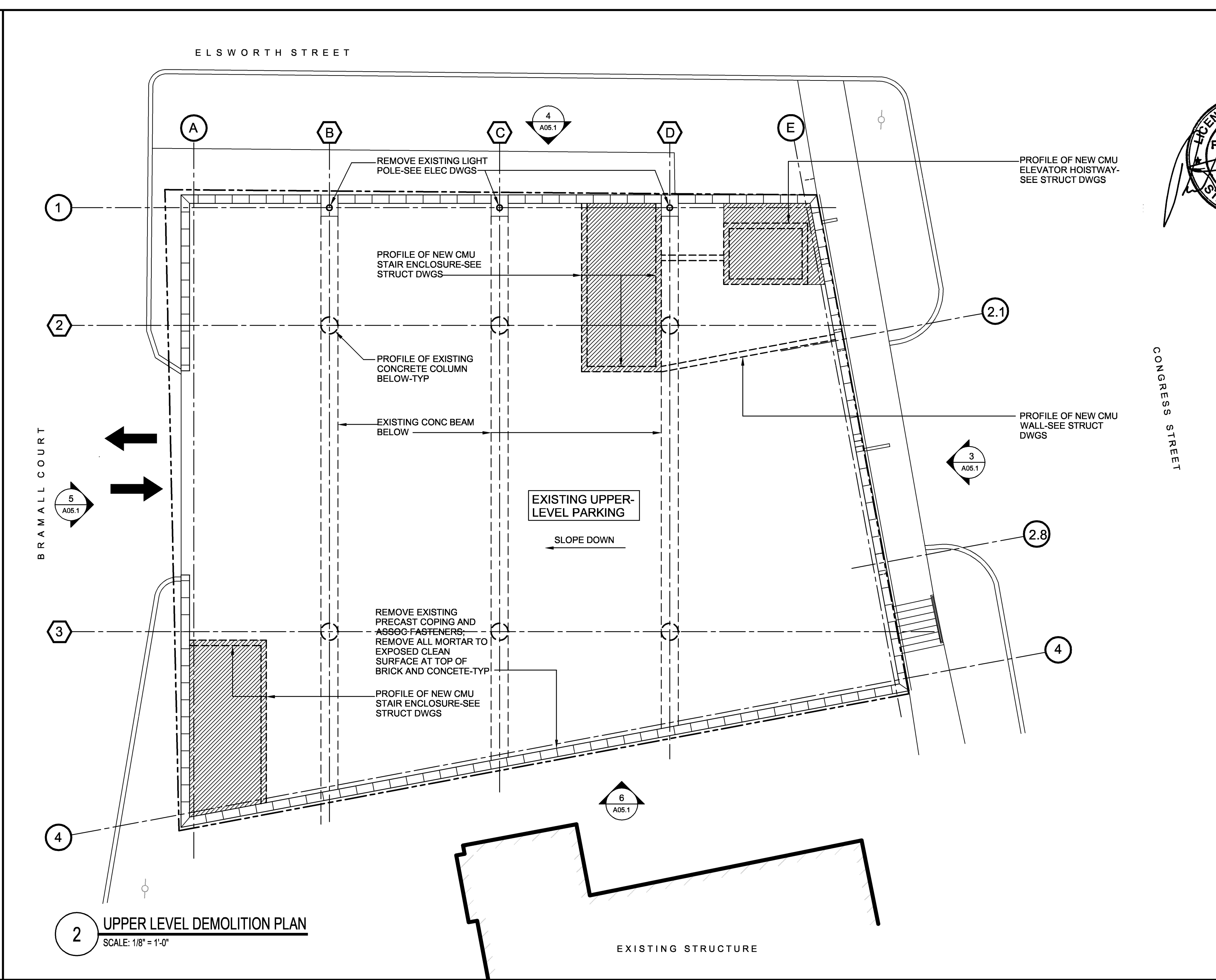
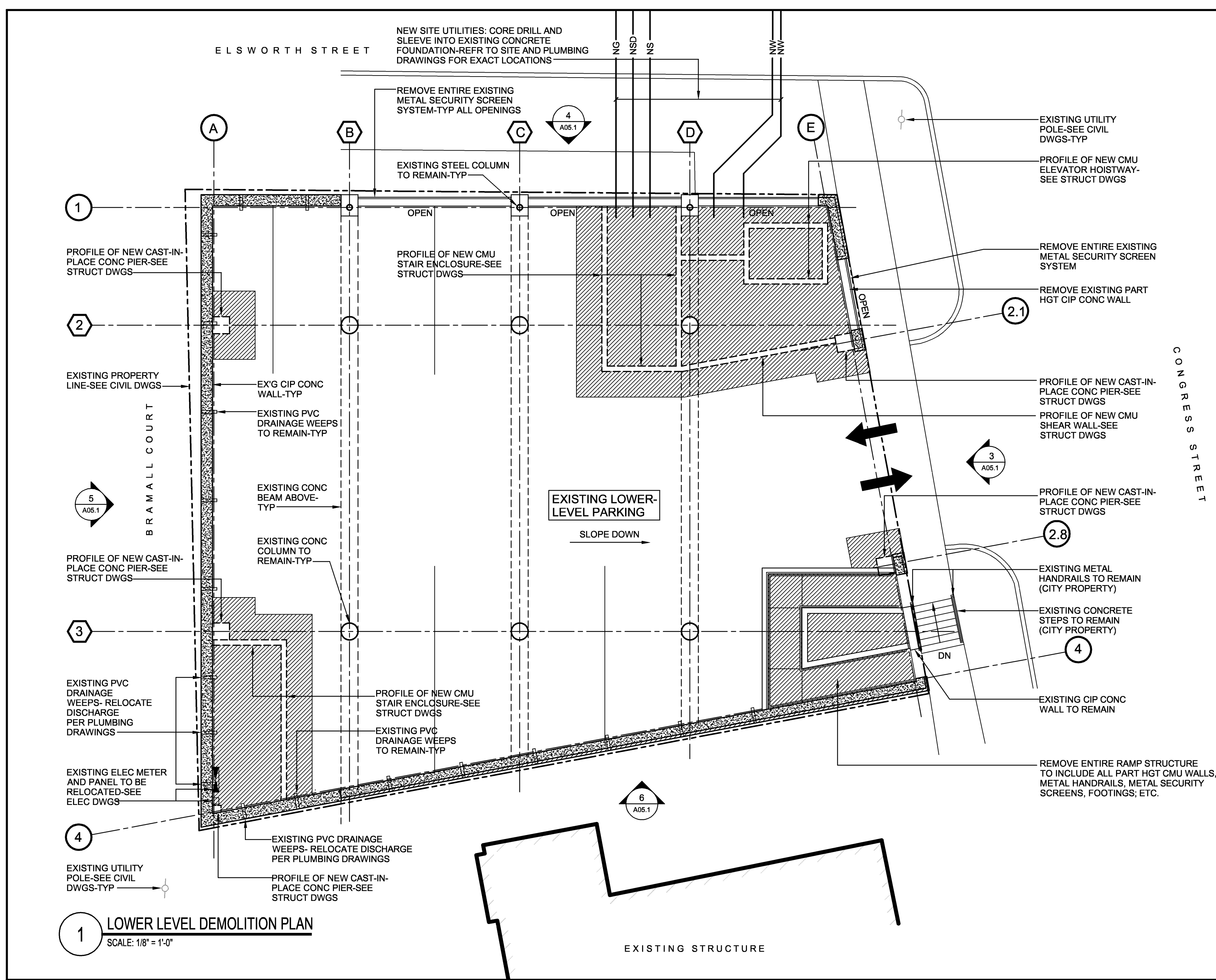
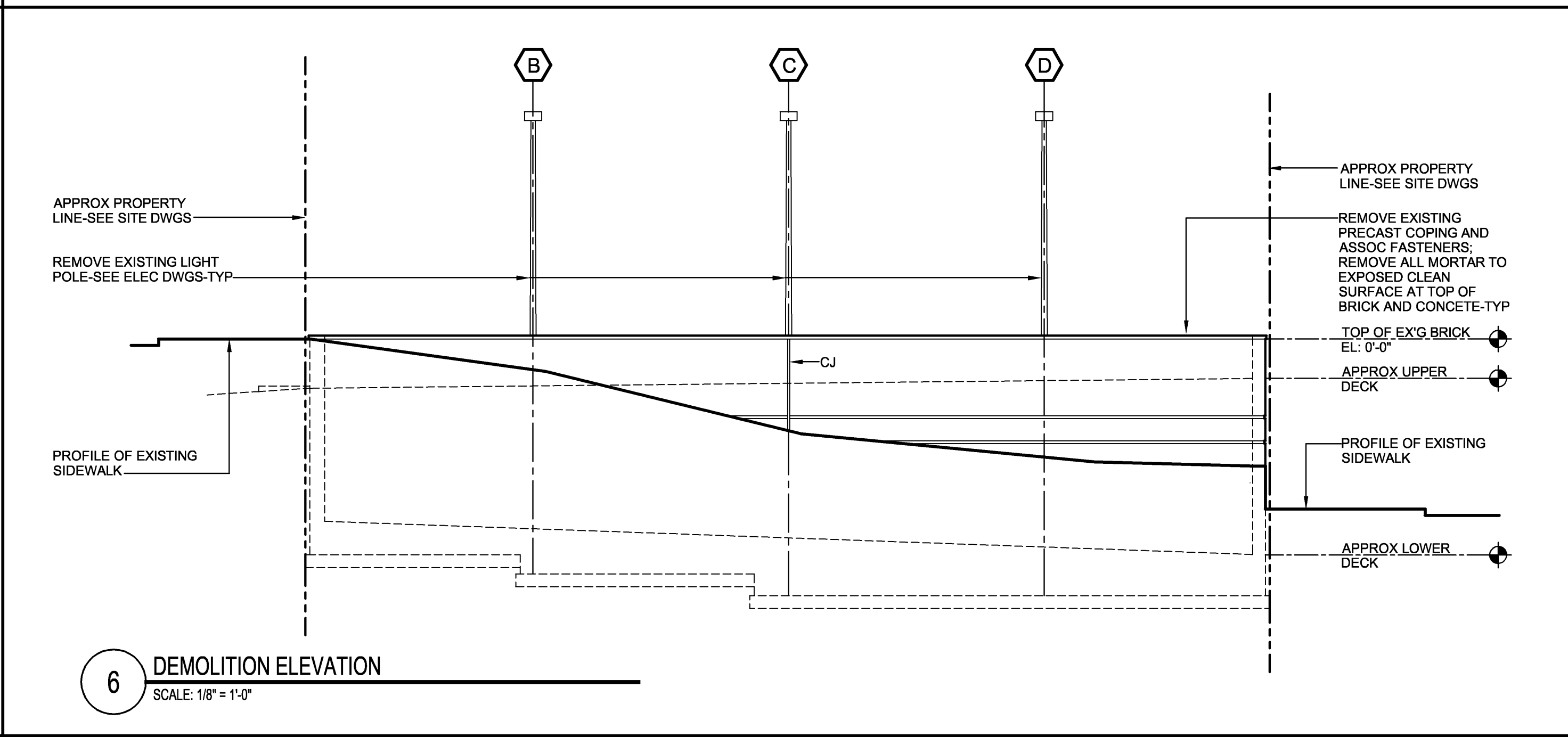
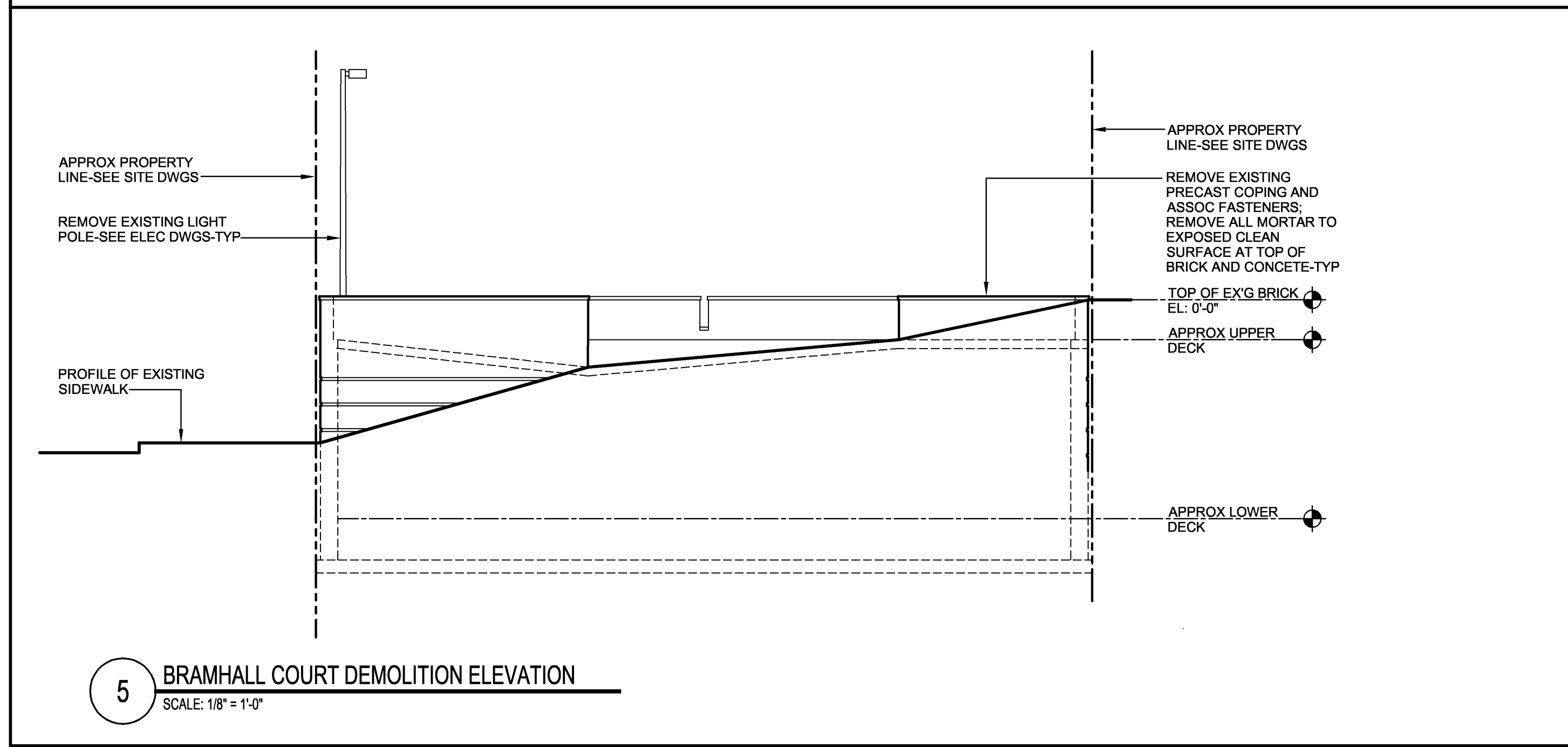

- GRAPHIC LEGEND:**
- APPROXIMATE AREA OF EXISTING CONCRETE SLAB OR WALL REMOVAL. COORDINATE W/ STRUCTURAL DRAWINGS
  - APPROXIMATE LOCATION OF NEW CMU WALLS
  - EXISTING COLUMN GRID LOCATION
  - NEW COLUMN GRID LOCATION

04-28-05	ISSUED FOR BID
Mark	Date Description
Issue Dates	

Drawing Status
----------------

Drawing Title  
**Demolition Plans and Elevations**

PA/PE: PSC Drawn By: FSP  
 Drawing Number  
**A05.1**