

- NOTES:**
1. Typical floor slab is 3 1/4" lightweight concrete on 3"x20 ga composite metal deck. Total thickness 6 1/2". Reinforce with #3@12" e.w. Provide additional #4 x 8'-0" long @ 12" o.c. over all girders and at all slab edges. Top of steel El. is 6 1/2" below top of slab elevation shown unless otherwise noted thus (10"), indicating change from typical steel elevation.
 2. Weight of structural steel associated w/ exterior wall lintels, relieving angles, hanger assemblies, etc. should be estimated as 50#/ft. of this floor level around building perimeter north of grid line 5. Also, carry contingencies for Richmond 3/4" Peerless wedge inserts @ 2'-0" o.c. around slab perimeter north of grid line 5.
 3. In shaded area, T.O.S. El. 142'-6 1/2" (T.O.C. El. 143'-0 1/2"). See Arch. Drawgs for drain locations and details of tapered rigid insulation, waterproofing membrane, and paver system for exterior terraces.
 4. Contractor shall coordinate openings and sleeves through slabs for electrical conduit to avoid conflicts with steel framing.
 5. All infill framing shown on plan, without size indicated, shall be W10x12, Typ.
 6. All steel framing, including infill framing, shall have 3/4"x4 x 8" beaded studs @ 12" o.c., min, Typ.

SGH
Simpson Gumpertz & Heger Inc.
 Consulting Engineers
 Boston, MA 41 Sejan Street, Telephone: (781) 907 9000
 Building 1, Suite 500 Fax: (781) 907 9009
 Waltham, MA 02453
 San Francisco, CA 222 Sutter Street, Telephone: (415) 498 3700
 Suite 300 San Francisco, CA Fax: (415) 498 3550
 94108-4445
 Washington, DC 1365 Piccard Drive, Telephone: (301) 417 0999
 Suite 220 Rockville, MD Fax: (301) 417 9825
 20850

FOR PERMIT ONLY - NOT FOR CONSTRUCTION

PERMIT 09/24/04 PERMIT SET - NOT FOR CONSTRUCTION
 Issue Log

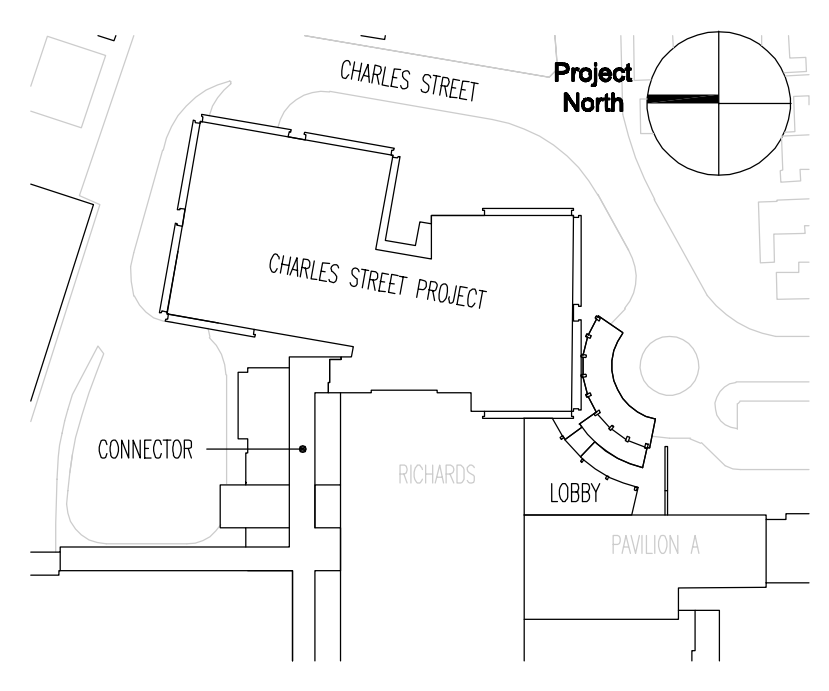

TRO
 ARCHITECTURE
 PLANNING
 ENGINEERING
 INTERIOR DESIGN
 The Ritchie Organization
 80 Bridge Street
 Newton, MA 02458-1134
 617-969-9400

Maine Medical Center
 Charles Street Project
 Portland, Maine MMC Project No. 21841

Drawing Title
GROUND FLOOR FRAMING PLAN

Commission No. 4673 Date Issued
 Scale AS NOTED Sheet Number
 Drawn By KMG/SK
 Approved By JHT/JMT
 Date: 11/20/00/20684.00/1
 Copyright © 2004 The Ritchie Organization

S20G