

Notes:  
 1. Where concrete wall spans over existing footings of Richards Building, provide 2" of compressible material between bottom of new wall & top of existing footing to prevent adding load to existing footings.

3 FOUNDATION WALL SECTION ALONG GRID LINE J.6  
 1/2" = 1'-0"

4 SECTION  
 1/2" = 1'-0"

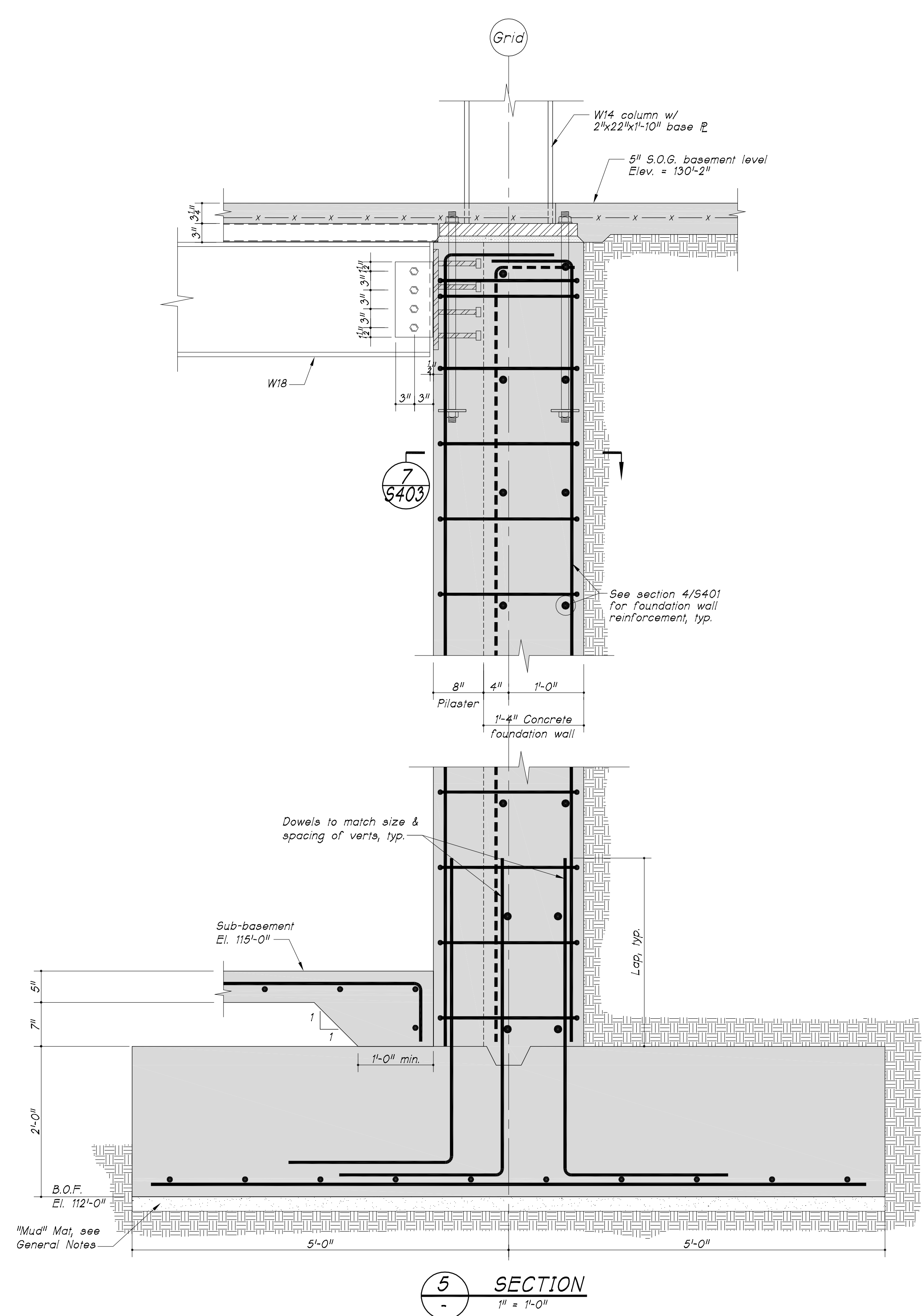

5 SECTION  
 1/2" = 1'-0"

General Notes:

**SGH**  
**Simpson Gumpertz & Heger Inc.**  
 Consulting Engineers  
 Boston, MA 41 Seay Street, Building 1, Suite 500, Waltham, MA 02453  
 San Francisco, CA 222 Sutter Street, Suite 300, San Francisco, CA 94108-4445  
 Washington, DC 1355 Piccard Drive, Suite 220, Rockville, MD 20850  
 Telephone: (781) 907-9000, Fax: (781) 907-9009  
 Telephone: (415) 498-3700, Fax: (415) 498-3550  
 Telephone: (301) 417-0999, Fax: (301) 417-9825

**FOR PERMIT ONLY - NOT FOR CONSTRUCTION**

PERMIT: 09/24/04 PERMIT SET - NOT FOR CONSTRUCTION  
 Issue Log

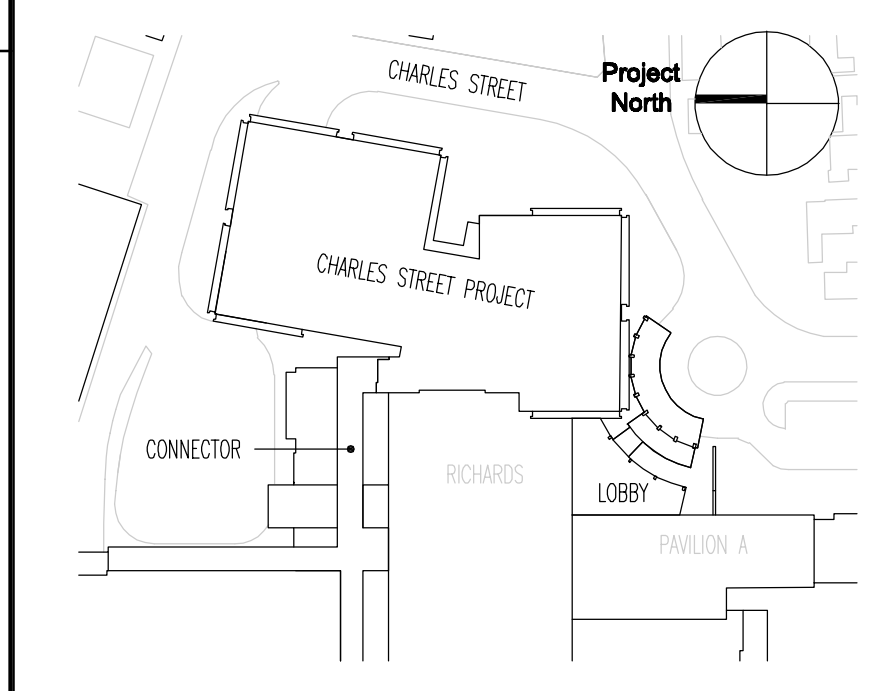

Key Plan

**TRO**  
 ARCHITECTURE  
 PLANNING  
 ENGINEERING  
 INTERIOR DESIGN  
 The Ritchie Organization  
 80 Bridge Street  
 Newton, MA 02458-1134  
 617-869-9400

**Maine Medical Center**  
 Charles Street Project  
 Portland, Maine MMC Project No. 21841

Drawing Title  
**FOUNDATION SECTIONS**  
 (SHEET 1 OF 3)

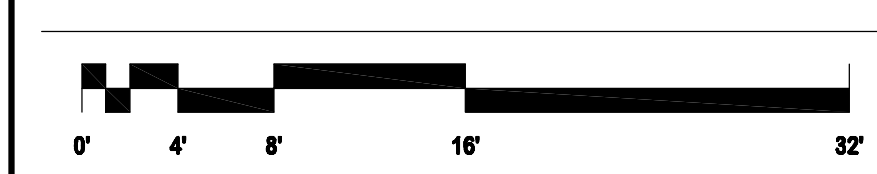

Commission No.	4673	Date Issued	
Scale	AS NOTED	Sheet Number	
Drawn By	KMG/SK		
Approved By	JHT/JMT		
File Name	L:\2000\20684.00\		

**S401**

Copyright © 2004 The Ritchie Organization