

General Notes:

**SGH**  
**Simpson Gumpertz & Heger Inc.**  
 Consulting Engineers  
 Boston, MA 41 Seay Street, Building 1, Suite 500, Waltham, MA 02453  
 San Francisco, CA 222 Sutter Street, Suite 300, San Francisco, CA 94108-4443  
 Washington, DC 1335 Piccard Drive, Suite 220, Rockville, MD 20850  
 Telephone: (781) 907 9000  
 Facsimile: (781) 907 9009  
 Telephone: (415) 495 3700  
 Facsimile: (415) 495 3550  
 Telephone: (301) 417 0999  
 Facsimile: (301) 417 9825

**FOR PERMIT ONLY - NOT FOR CONSTRUCTION**

PERMIT: 09/24/04 PERMIT SET - NOT FOR CONSTRUCTION  
 Issue Log

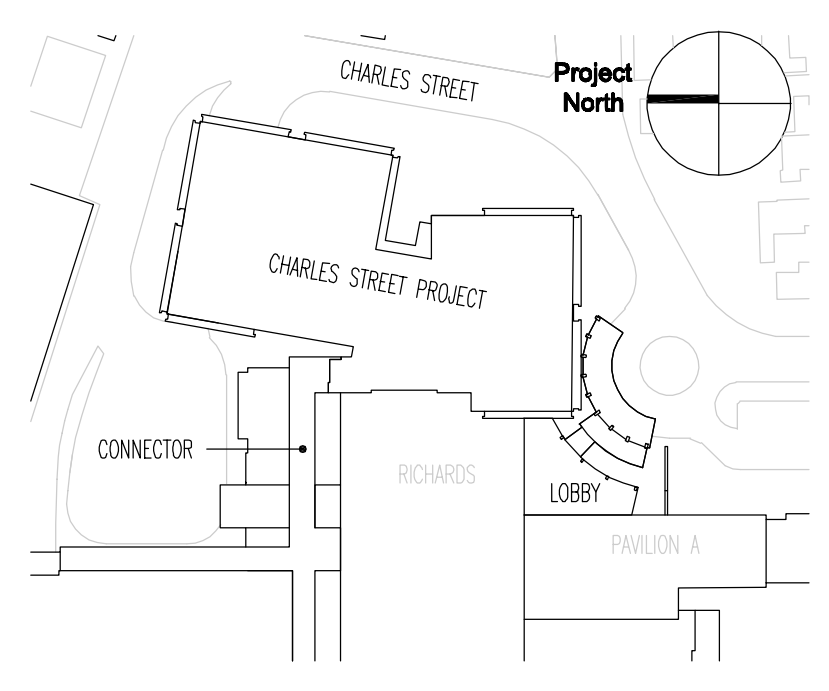

**TRO**  
 ARCHITECTURE  
 PLANNING  
 ENGINEERING  
 INTERIOR DESIGN  
 The Ritchie Organization  
 80 Bridge Street  
 Newton, MA 02458-1134  
 617-869-9400

**Maine Medical Center**  
 Charles Street Project  
 Portland, Maine MMC Project No. 21841

Drawing Title  
**EXTERIOR WALL SECTIONS**

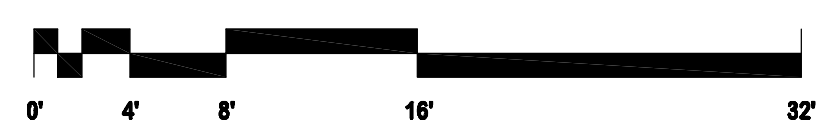

Commission No. 4673 Date Issued  
 Scale AS NOTED Sheet Number  
 Drawn By KMG/JSK  
 Approved By JHT/JMT  
 Filename L:\2000\20684.00\.  
 Copyright © 2004 The Ritchie Organization  
**S302**