

- Notes:
1. Alternate #3. Two (2) additional floors above mechanical floor level. Design of the two future floors to be identical to fourth floor.
 2. All spread and strip footings shall be placed on "mu" mat. See General Notes.

1 TRANSVERSE BUILDING SECTION AT GRID LINE 5
1/4" = 1'-0"

General Notes:

SGH
Simpson Gumpertz & Heger Inc.
Consulting Engineers

Boston, MA 41 Seay Street, Building 1, Suite 500, Waltham, MA 02453
San Francisco, CA 222 Sutter Street, Suite 300, San Francisco, CA 94108-4445
Washington, DC 1335 Piccard Drive, Suite 220, Rockville, MD 20850

Telephone: (781) 907 9000
Facsimile: (781) 907 9009
Telephone: (415) 406 3700
Facsimile: (415) 406 3550
Telephone: (301) 417 0999
Facsimile: (301) 417 9825

FOR PERMIT ONLY - NOT FOR CONSTRUCTION

PERMIT: 09/24/04 PERMIT SET - NOT FOR CONSTRUCTION
Issue Log

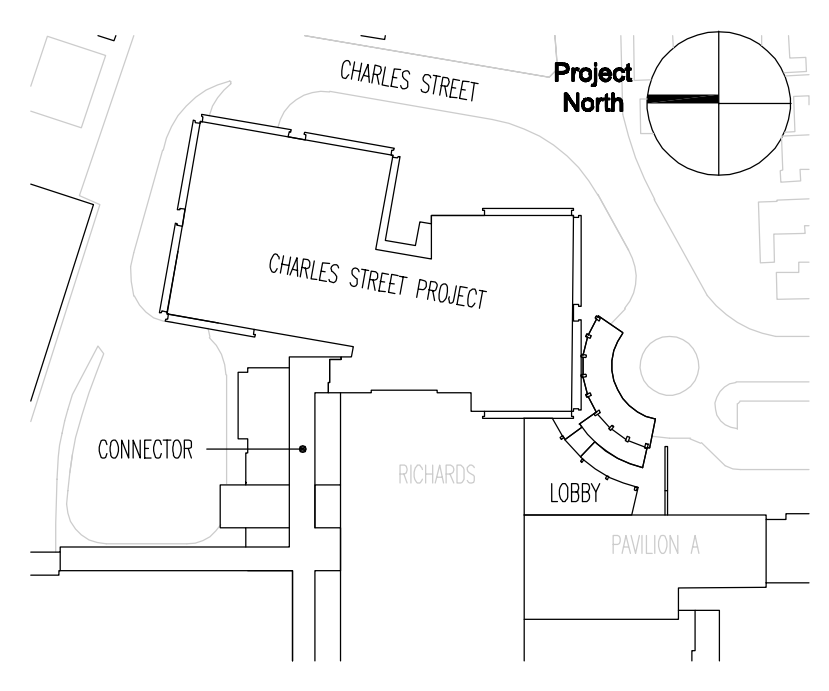

Key Plan

TRO
ARCHITECTURE
PLANNING
ENGINEERING
INTERIOR DESIGN

The Ritchie Organization
80 Bridge Street
Newton, MA 02459-1134
617-869-9400

Maine Medical Center
Charles Street Project
Portland, Maine MMC Project No. 21841

Drawing Title
TRANSVERSE BUILDING SECTION

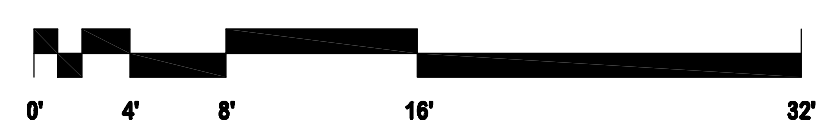

Commission No.	4673	Date Issued	
Scale	AS NOTED	Sheet Number	
Drawn By	KMG/SK		
Approved By	JHT/JMT		
File Name	L:\2000\20684.00\		
Copyright	© 2004	The Ritchie Organization	

S301