

NOTES:

1. Typical floor slab is 3 1/4" lightweight concrete on 3"x20 ga. composite metal deck. Total thickness 6 1/4". Reinforce with #3@12" e.w. Provide additional #4 x 8'-0" long @ 12" o.c. over all girders and at all slab edges. Top of steel E.I. is 6 1/4" below top of slab elevation shown unless otherwise noted thus (10"), indicating change from typical steel elevation.

SGH
Simpson Gumpertz & Heger Inc.
 Consulting Engineers

Boston, MA 41 Seay Street, Building 1, Suite 500
 Telephone: (781) 907 9000
 Facsimile: (781) 907 9009

San Francisco, CA 222 Sutter Street, Suite 300
 Telephone: (415) 498 3700
 Facsimile: (415) 498 3550

Washington, DC 1365 Piccard Drive, Suite 220
 Telephone: (301) 417 0999
 Facsimile: (301) 417 9825

FOR PERMIT ONLY - NOT FOR CONSTRUCTION

PERMIT 09/24/04 PERMIT SET - NOT FOR CONSTRUCTION
 Issue Log

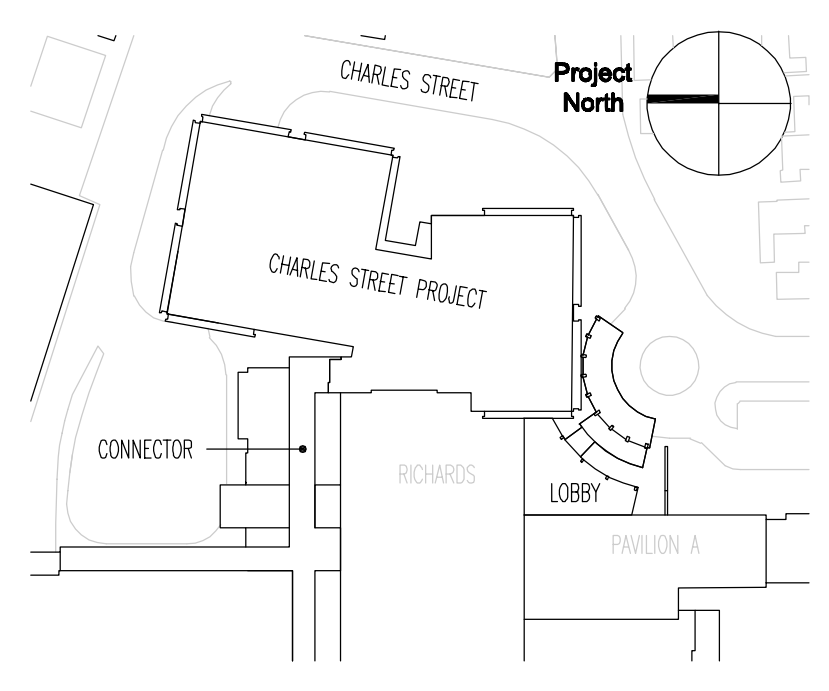

TRO
 ARCHITECTURE
 PLANNING
 ENGINEERING
 INTERIOR DESIGN

The Ritchie Organization
 80 Bridge Street
 Newton, MA 02458-1134
 617-869-9400

Maine Medical Center
 Charles Street Project
 Portland, Maine MMC Project No. 21841

Drawing Title
FIFTH/MECHANICAL FLOOR INTERSTITIAL FRAMING PLAN

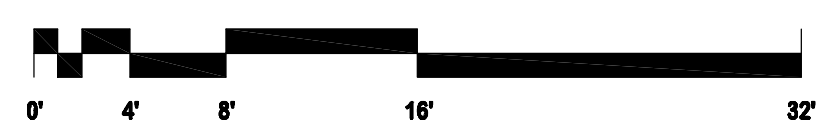

Commission No.	4673	Date Issued	
Scale	AS NOTED	Sheet Number	
Drawn By	KMG/SK		
Approved By	JMT/JMT		
File Name	L:\2000\20684.00\		

S205B