

General Notes:

- GENERAL NOTES:**
- FA1. ALL ELECTRICAL DRAWINGS FOR EXACT QUANTITY OF FIRE ALARM DEVICES.
 - FA2. WIRING AND EQUIPMENT SHALL BE OF EQUIVED BY THE MANUFACTURER'S MARKING.
 - FA3. ALL FIRE ALARM WIRING SHALL BE RUN IN CONDUIT.
 - FA4. FIRE ALARM WIRING SHALL MEET EXISTING FACILITY FIRE ALARM CODES.
 - FA5. ELECTRICAL CONDUITS SHALL BE APPROXIMATELY 1/2" ABOVE ALL FLOOR SYSTEMS FROM CEILING OF WORKS/MECHANICAL ROOMS AS REQUIRED.
 - FA6. FIRE ALARM SYSTEM WIRING SHALL BE CLASS B.
 - FA7. FIRE ALARM SYSTEM SHALL PROVIDE ALL NECESSARY WIRING AND SOFTWARE FOR A COMPLETE AND OPERATIONAL FIRE ALARM SYSTEM.
 - FA8. FIRE ALARM SYSTEM WIRING SHALL BE MADE ON SIGNAL.
 - FA9. FIRE ALARM WIRING TERMINATIONS SHALL BE MADE ON SIGNAL.
 - FA10. FIRE ALARM WIRING SHALL BE MADE ON SIGNAL.
 - FA11. REFER TO IBC DRAWINGS FOR PERSON DUCT SIGNAL DETECTOR INSTALLATION ON FLOOR TO BE PROVIDED AS REQUIRED TO DETECTOR INDICATED ON ELECTRICAL DRAWING.
 - FA12. LOCAL DETECTOR WIRING OF EACH SIGNALER USED SHALL BE MADE TO DETECTOR WIRING SIGNALER PER DETAIL ON DRAWING SHEET.
 - FA13. NOTIFICATION APPLIANCE CIRCUITS SHALL BE PROTECTED FROM THE SHORT CIRCUIT BY THE DETECTOR CIRCUIT PER DETAIL ON DRAWING SHEET.
 - FA14. THE SIGNALS FROM THE CONTROL PANEL SHALL BE RUN IN CONDUIT TO THE DETECTOR CIRCUIT PER DETAIL ON DRAWING SHEET. MAXIMUM LENGTH BETWEEN MAIN SIGNAL WIRING SHALL BE 100'-0" UNLESS OTHERWISE NOTED.
 - FA15. FIRE-CD CABLE INSTALLED WITHIN A 1/2" CONDUIT.

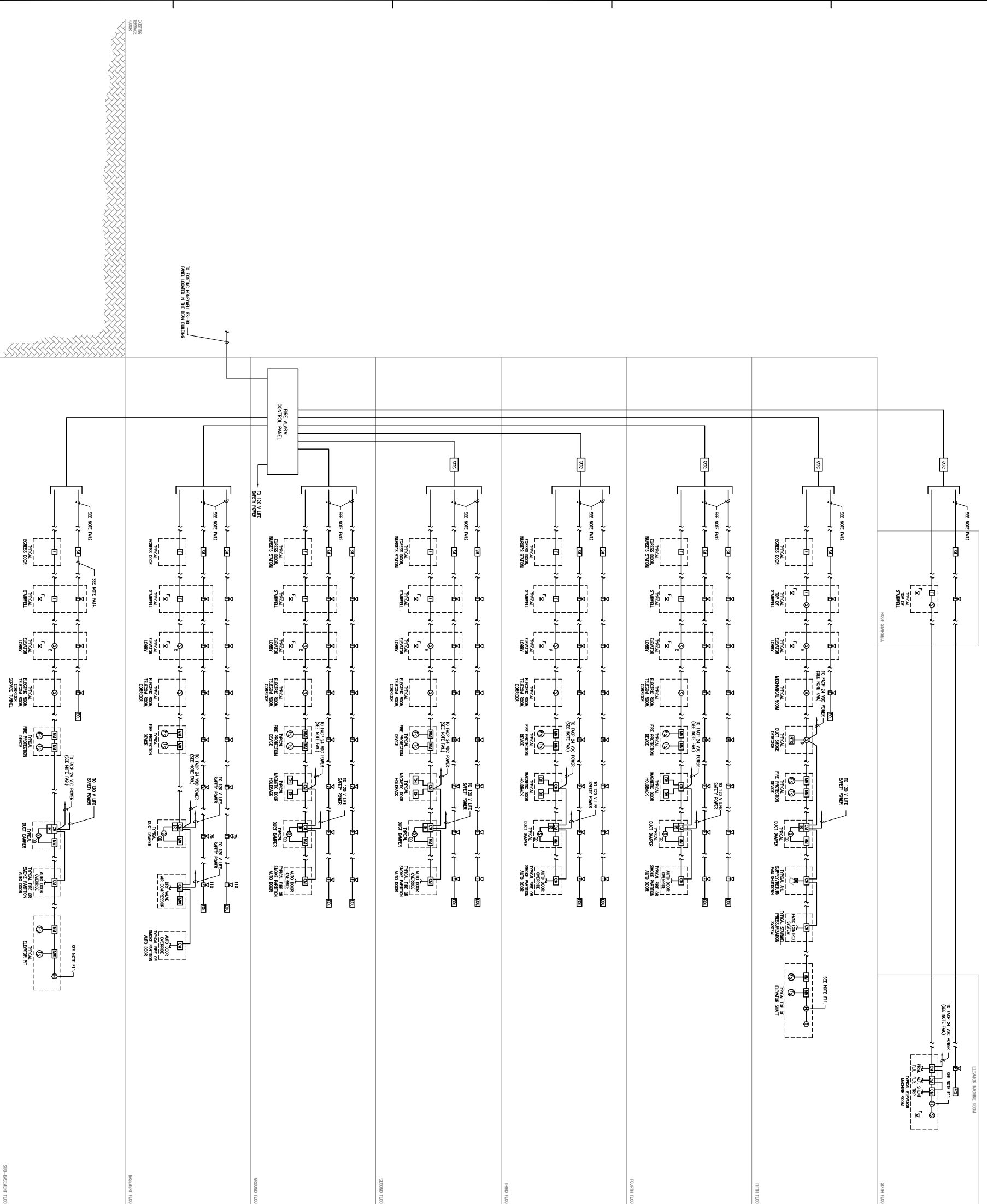

ISSUE DATE: 09/24/24
 FOR PERMIT ONLY
 NOT FOR CONSTRUCTION

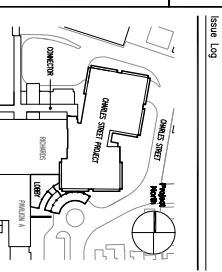

PRO
 ARCHITECTURE
 PLANNING
 ENGINEERING
 INTERIORS
 THE DESIGN GROUP
 1000 N. GARDEN STREET
 PORTLAND, ME 04108-4200
 TEL: (207) 774-2200
 WWW.PROARCHITECTURE.COM

Maine Medical Center
 Charles Street Project
 Portland, Maine
 MMC Project No. 21841

ELECTRICAL FIRE ALARM RISER DIAGRAM

Commission No. 4272
 Scale: 1/8" = 1'-0"
 Date: 09/24/24
 Project: 2024-0000

E630