

General Notes:

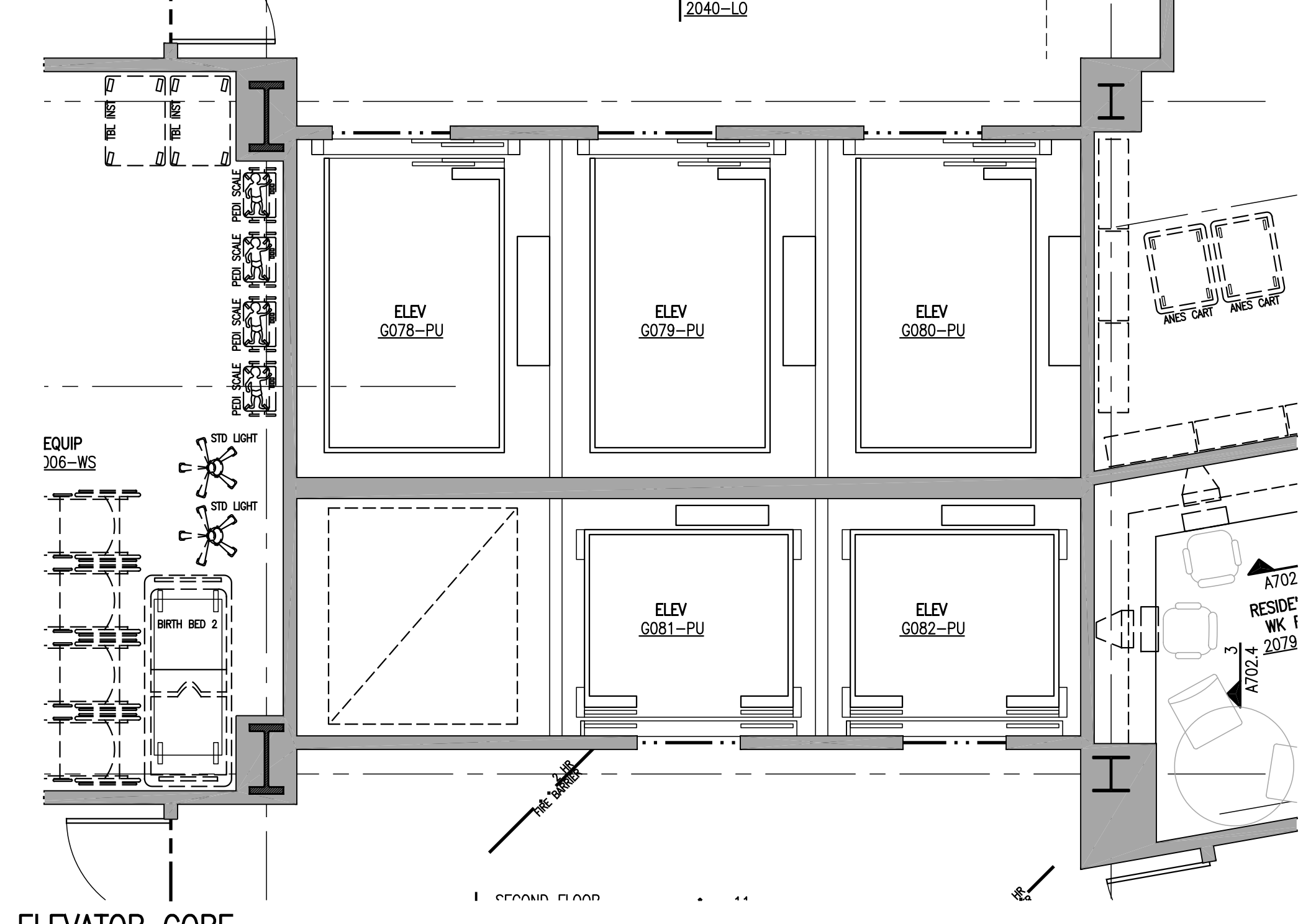

E1 ELEVATOR CORE SECOND FLOOR PLAN  
SCALE: 1/4" = 1'-0"

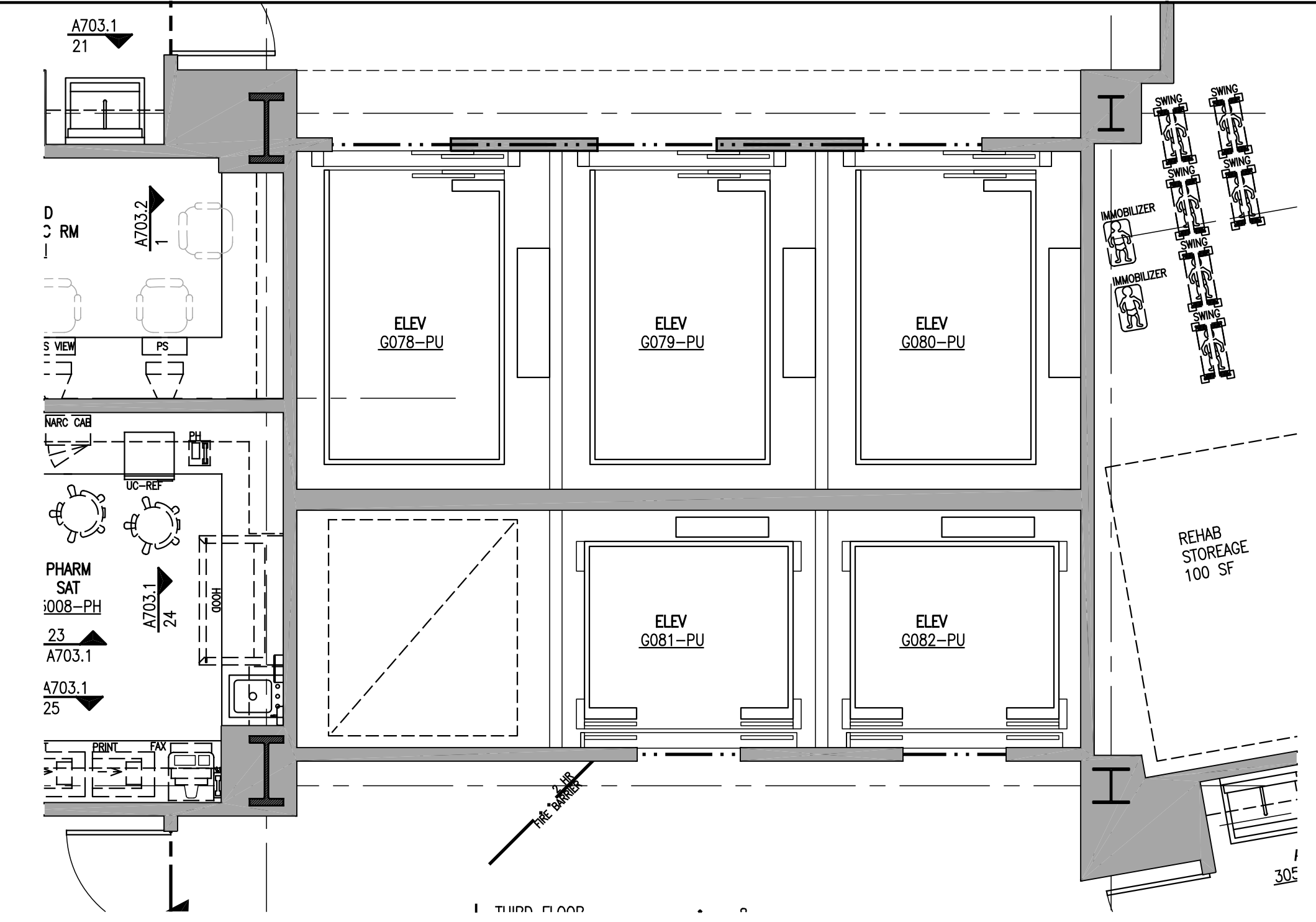

E2 ELEVATOR CORE THIRD FLOOR PLAN  
SCALE: 1/4" = 1'-0"

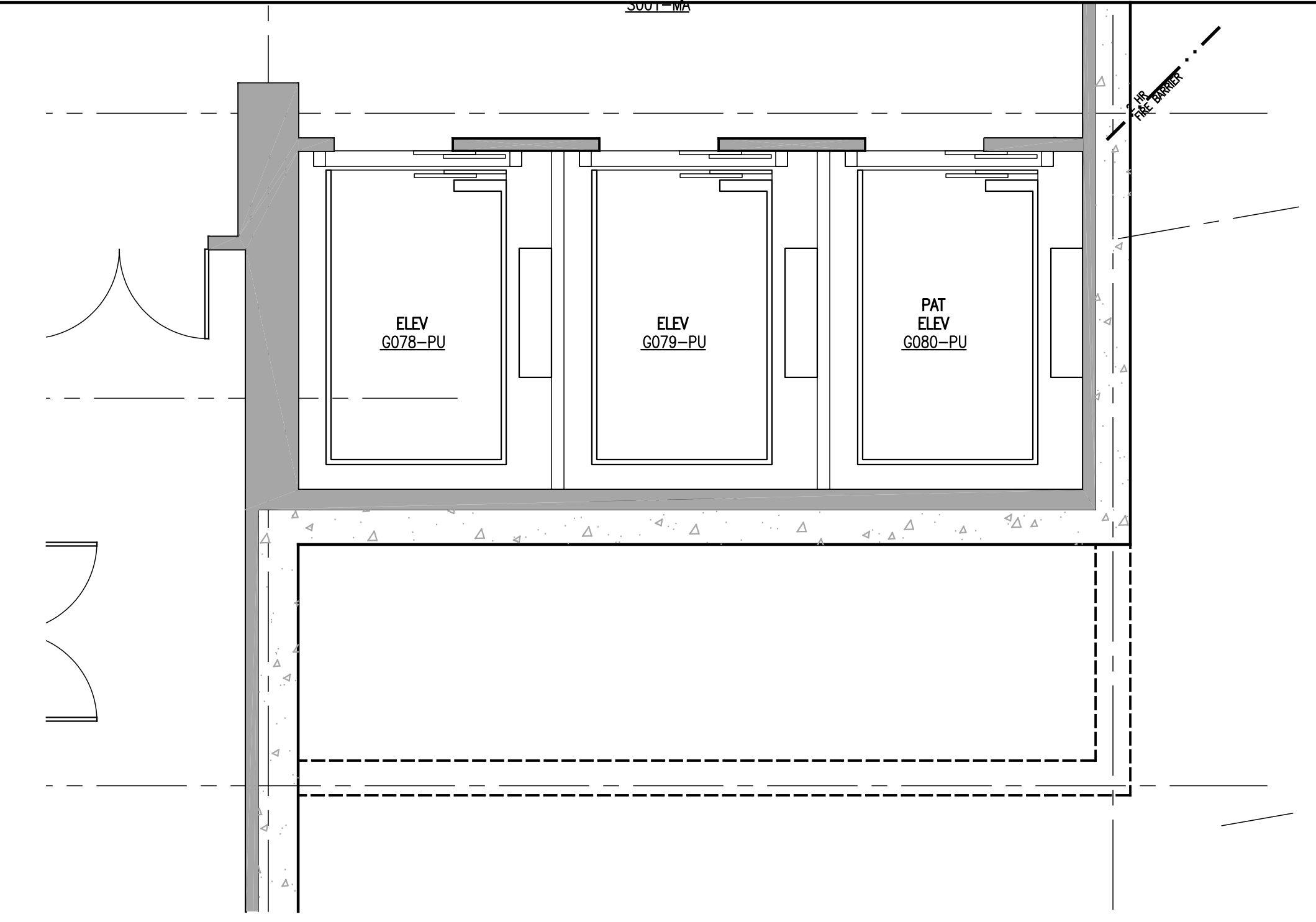

C2 ELEVATOR CORE SUB BASEMENT FLOOR PLAN  
SCALE: 1/4" = 1'-0"

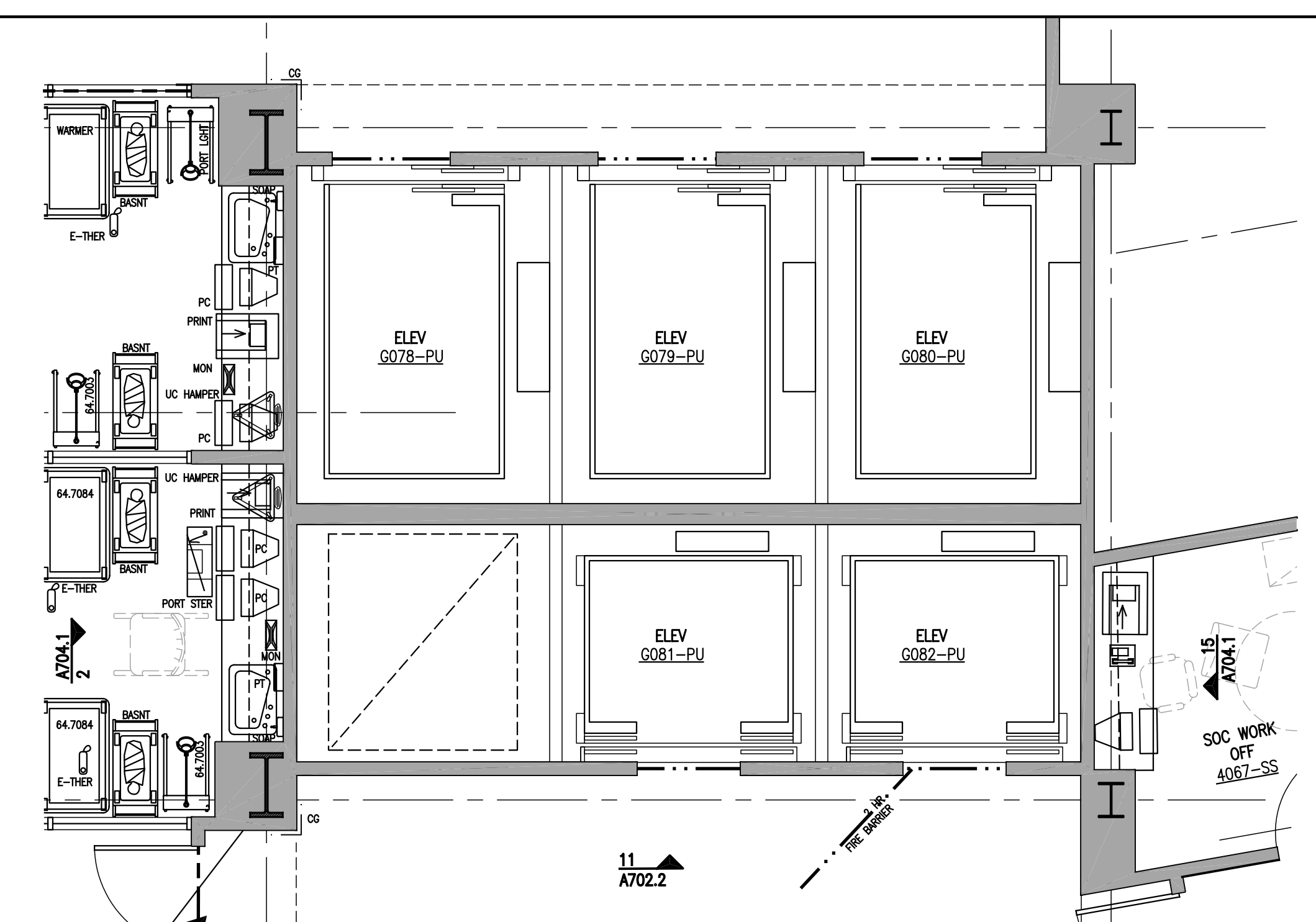

E3 ELEVATOR CORE FOURTH FLOOR PLAN  
SCALE: 1/4" = 1'-0"

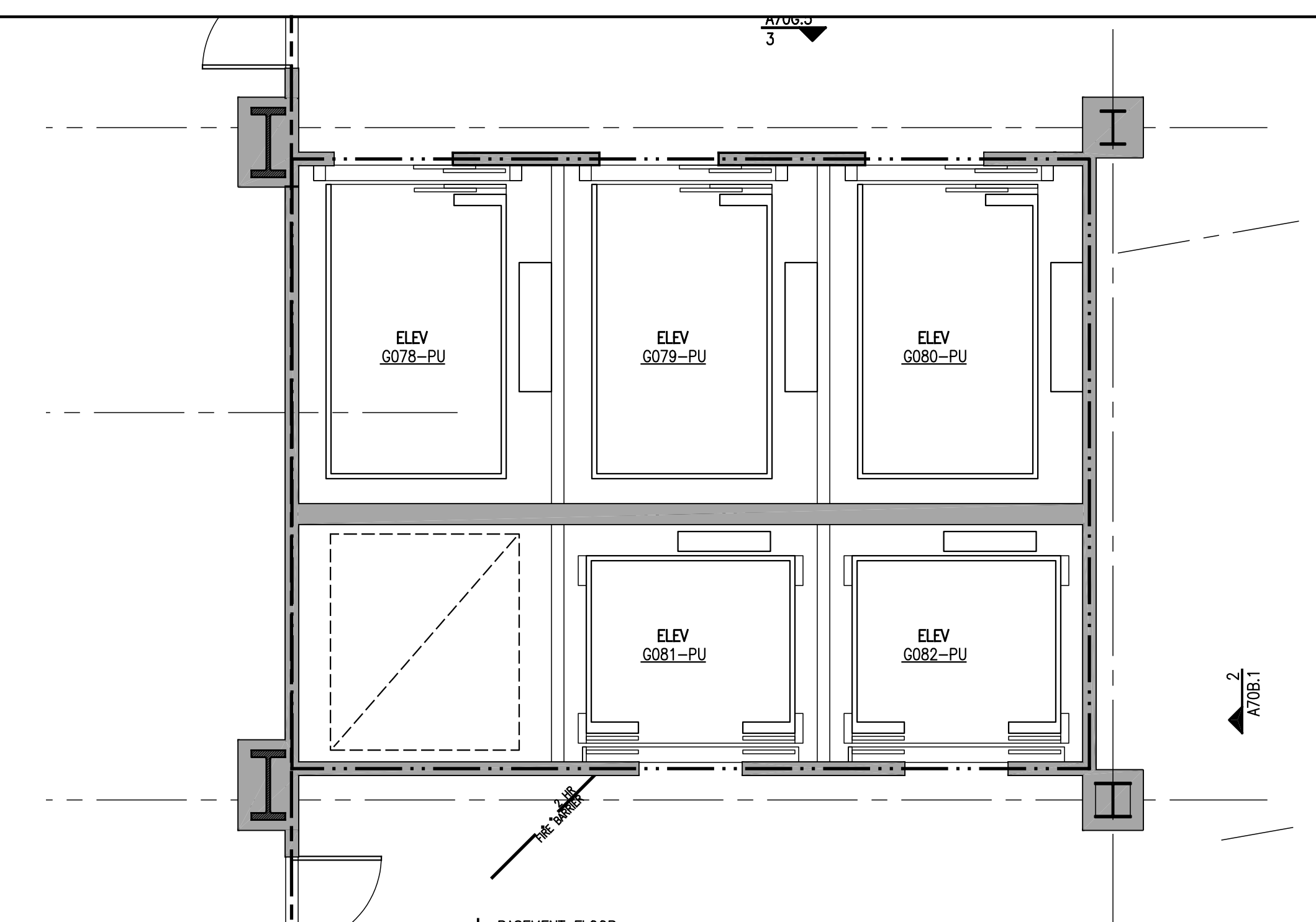

C3 ELEVATOR CORE BASEMENT FLOOR PLAN  
SCALE: 1/4" = 1'-0"

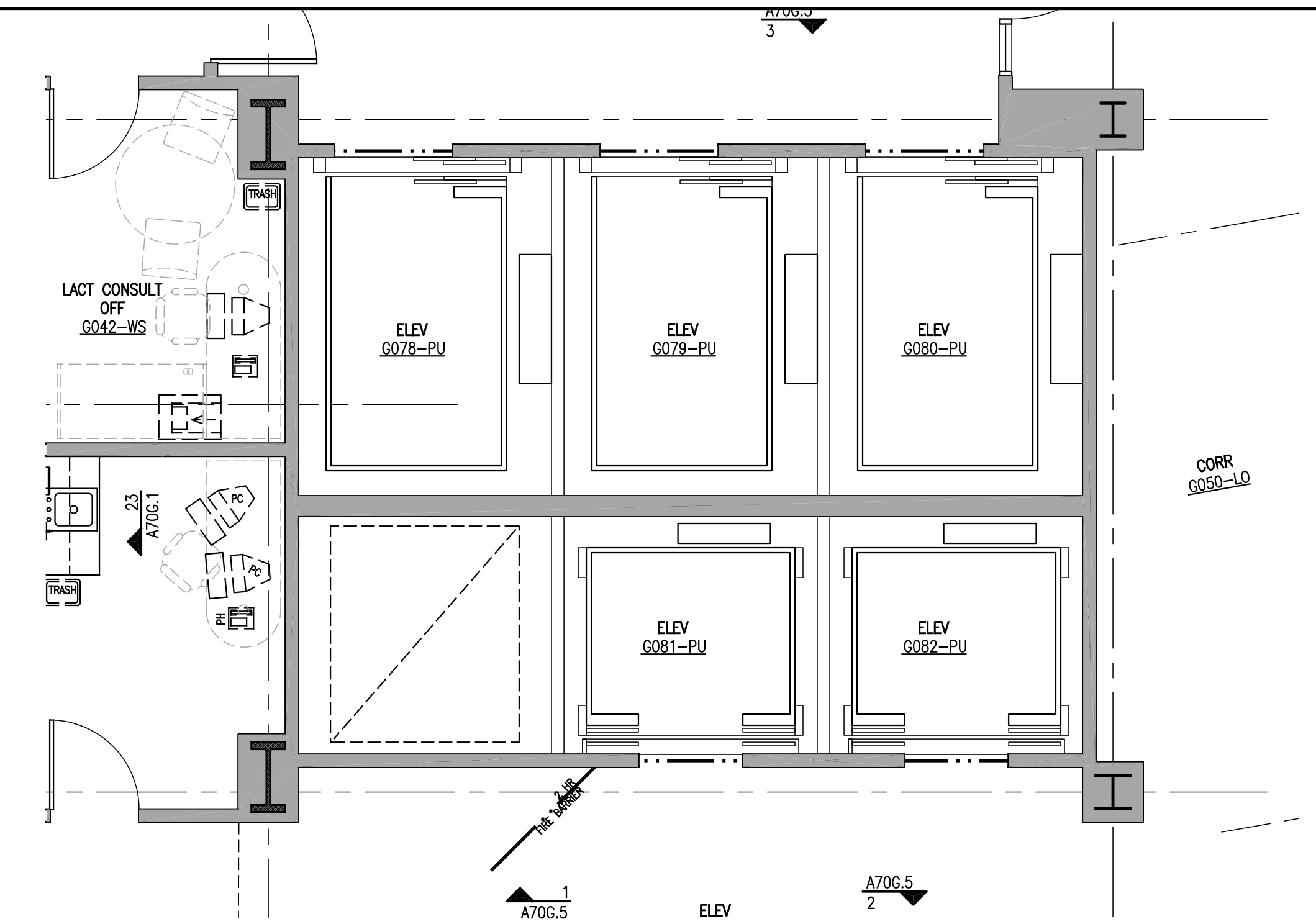

C4 ELEVATOR CORE GROUND FLOOR PLAN  
SCALE: 1/4" = 1'-0"

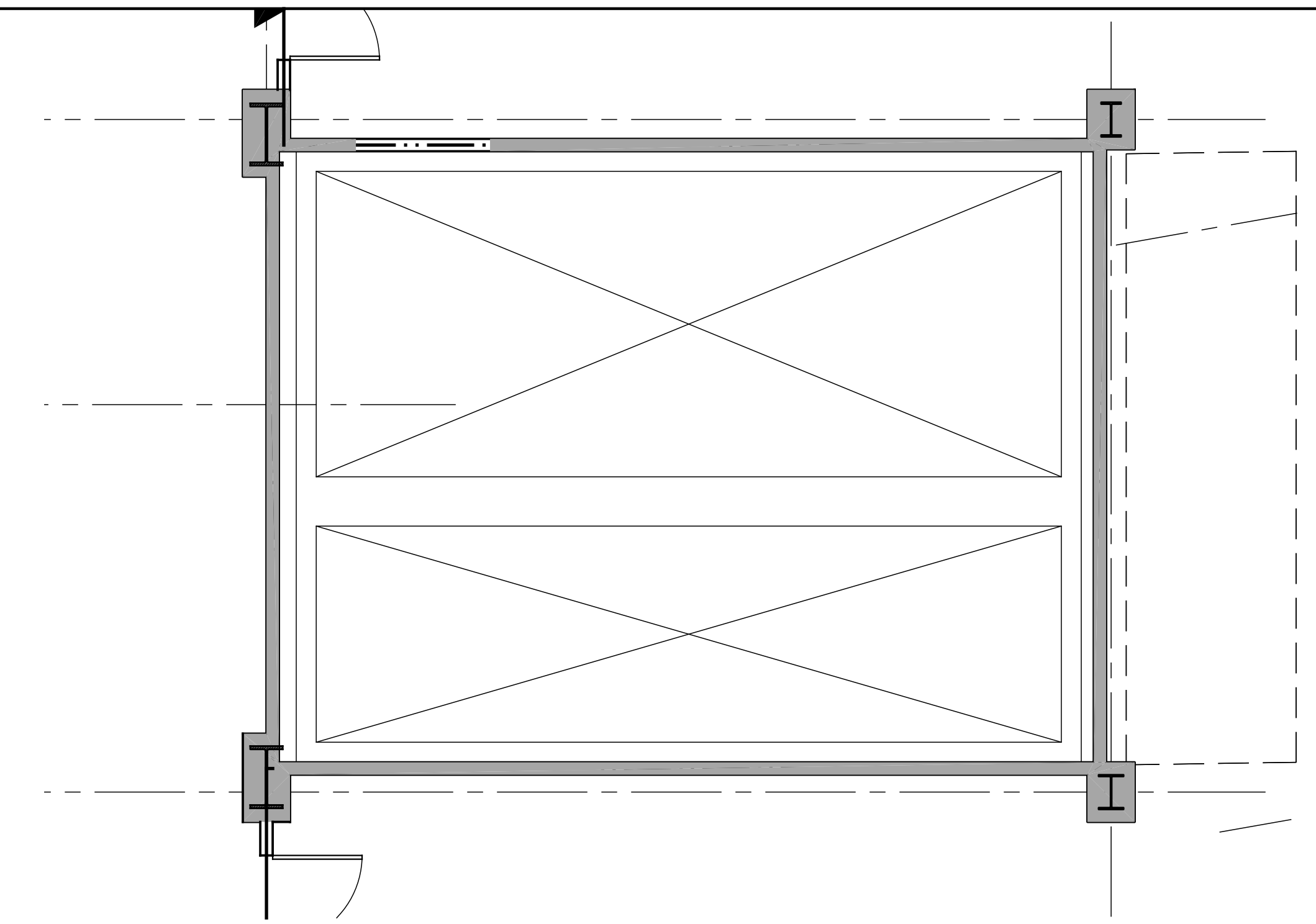

E4 ELEVATOR CORE FIFTH FLOOR PLAN  
SCALE: 1/4" = 1'-0"

MARK	ISSUE DATE	DESCRIPTION
<b>FOR PERMIT ONLY NOT FOR CONSTRUCTION</b>		
PERMIT	09/24/04	PERMIT SET - NOT FOR CONSTRUCTION
Issue Log		

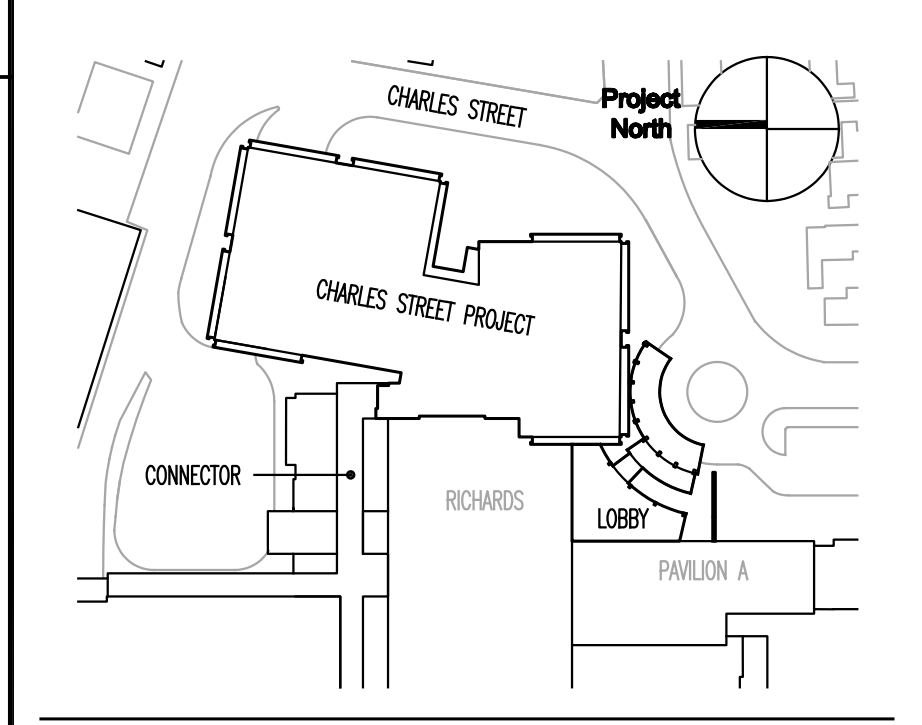

Key Plan

**TRO**  
ARCHITECTURE  
PLANNING  
ENGINEERING  
INTERIOR DESIGN

The Ritchie Organization  
80 Bridge Street  
Newton, MA 02459-1194  
617-552-6100

**Maine Medical Center**  
Charles Street Project  
Portland, Maine MMC Project No. 21841

Drawing Title  
**ENLARGED ELEVATOR PLANS**

Commission No.	4673	Date Issued	
Scale	AS NOTED	Sheet Number	
Drawn By			
Approved By			
Filename	4673AS45.dwg		
Copyright	© 2004	The Ritchie Organization	

**A545**