

**F3** SUB-BASEMENT DEMOLITION PLAN  
SCALE: 1/8" = 1'-0"

- General Notes:
- 1) FOR GENERAL DEMOLITION NOTES, REFER TO GENERAL NOTES ON DRAWING 0202.
  - 2) FOR PARTIAL DEMOLITION DUE TO MECHANICAL TIE-INS AT THE MAIN BUILDING AND SOUTH WING, SEE MECH DWGS.
  - 3) FOR SITE DEMOLITION AND SALVAGED ITEMS, REFER TO CIVIL DRAWINGS.
  - 4) FOR ELECTRICAL AND PLUMBING DEMOLITION, REFER TO ELECTRICAL AND PLUMBING DEMOLITION DWGS.

- KEYED NOTES FOR REMOVAL:**
- 1 REMOVE AND RELOCATE EXISTING MEP EQUIPMENT IN THIS ROOM TO ALLOW ACCESS OF CORRIDOR - SEE MEP DWGS
  - 2 REMOVE WALL TO ALLOW FOR RAISED DOOR OPENING
  - 3 EXISTING TRANSFORMER COORDINATE WITH ELECTRICAL
  - 4 DEMOLISH EXISTING ELECTRICAL VAULT IN ITS ENTIRETY, RELOCATE UTILITY LINES SEE ELECTRICAL
  - 5 EXISTING E.O. STAFF LOUNGE TO BE RELOCATED IN CHARLES ST. BUILDING THIS PHASE
  - 6 PROVIDE STRUCTURAL SUPPORT FOR NEW WALL OPENINGS

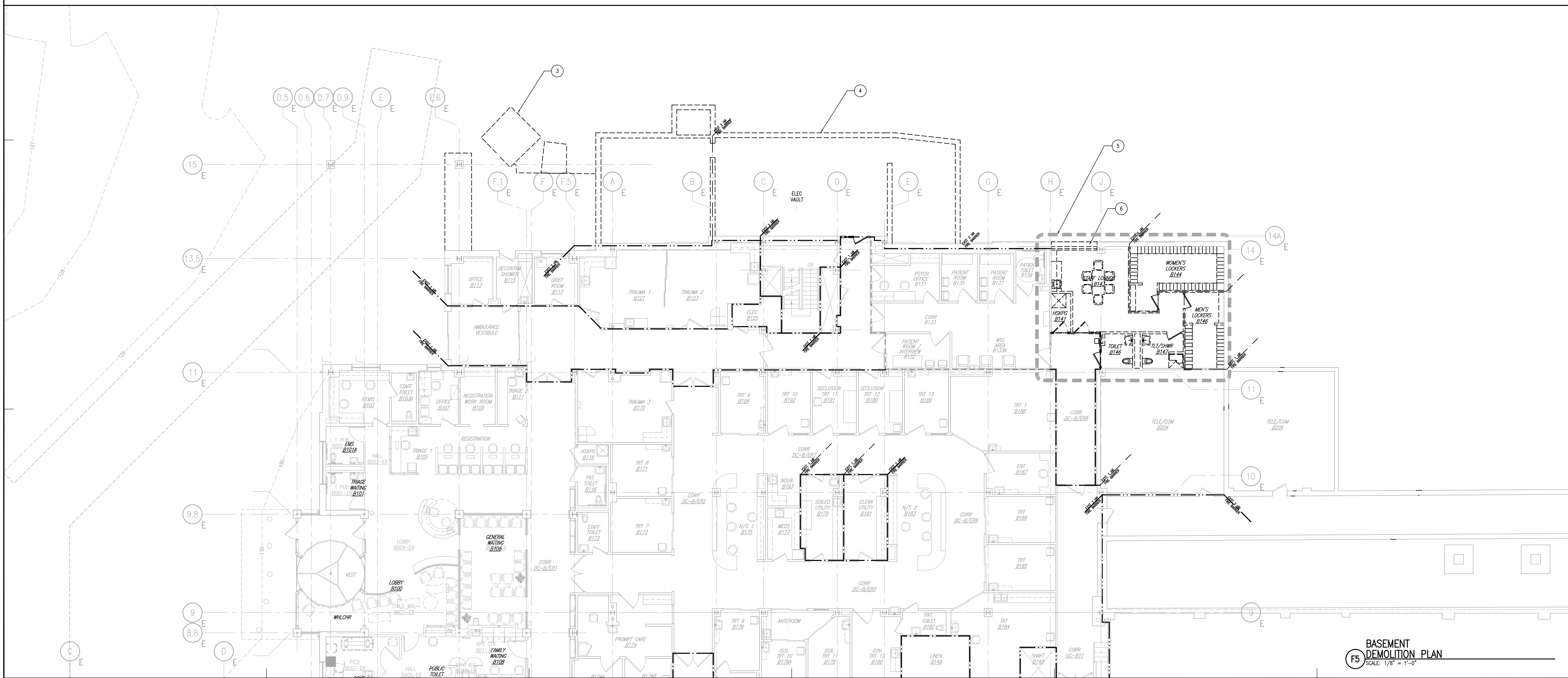

**F5** BASEMENT DEMOLITION PLAN  
SCALE: 1/8" = 1'-0"

MARK	ISSUE DATE	DESCRIPTION
<b>FOR PERMIT ONLY NOT FOR CONSTRUCTION</b>		
PERMIT	09/24/04	PERMIT SET - NOT FOR CONSTRUCTION
Issue Log		

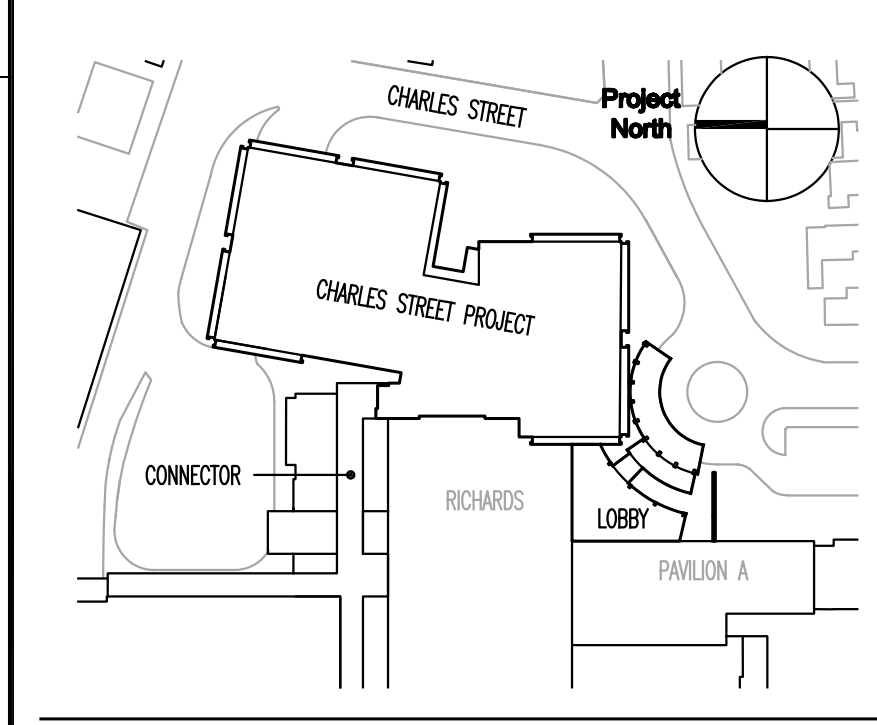

**TRO**  
ARCHITECTURE  
PLANNING  
ENGINEERING  
INTERIOR DESIGN  
The Ritchie Organization  
80 Bridge Street  
Newton, MA 02459-1194  
617-552-9100

**Maine Medical Center**  
Charles Street Project  
Portland, Maine MMC Project No. 21841

Drawing Title  
**BASEMENT AND SUB-BASEMENT DEMOLITION PLANS**

0' 4' 8' 16' 32'

Commission No.	4673	Date Issued	
Scale	1/8" = 1'-0"	Sheet Number	
Drawn By	JW	Approved By	JW
File Name	4673A100.dwg		
Copyright	© 2004	The Ritchie Organization	

**A100**