

Lawrence E. Bartlett

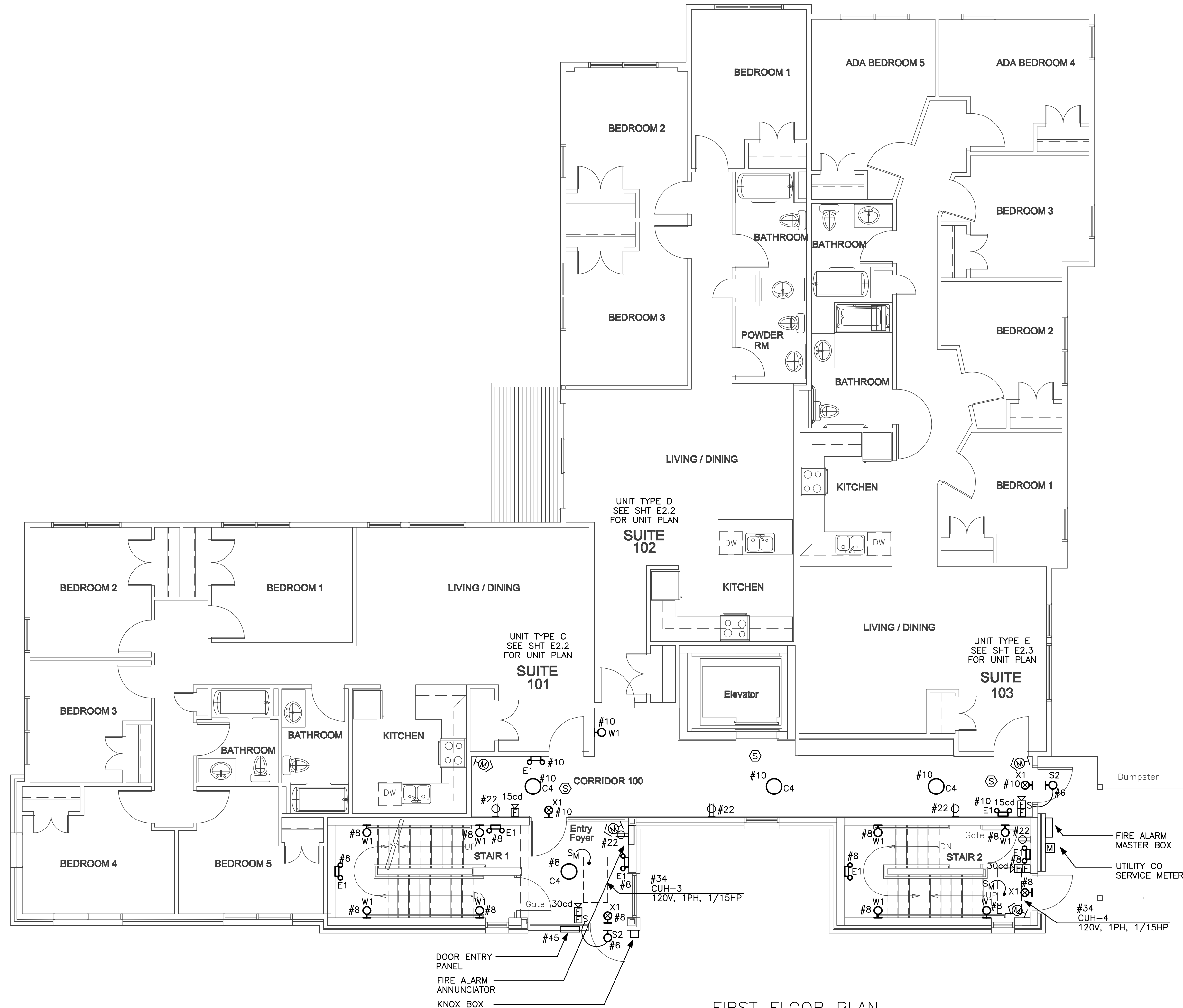

FIRST FLOOR PLAN

3/16" = 1'-0"
ROUTE CIRCUIT HP #6 THROUGH TIME SWITCH
IN MECH. ROOM G06

Crescent Heights
Apartment Suites
Portland, Maine

Owner
Crescent Heights LLC

Architect
Winton Scott Architects

Landscape / Civil Engineer
DeLuca-Hoffman
Associates, Inc.

Structural Engineer
Becker Structural Eng.

Mechanical Engineer
Mechanical Systems Eng.

Lighting / Electrical Engineer
Bartlett Design

BUILDING PLANS
FIRST FLOOR
PLAN

E1.2
Scale: 3/16" = 1'-0"
MARCH 17, 2009