

SIZE	REMARKS
A 4'-0" X 7'-0"	PARTITION
B 5'-0" X 7'-0"	PARTITION
C 6'-0" X 7'-0"	PARTITION
D 7'-0" X 7'-0"	PARTITION
E 8'-0" X 7'-0"	PARTITION
F 9'-0" X 7'-0"	PARTITION
G 10'-0" X 7'-0"	PARTITION
H 11'-0" X 7'-0"	PARTITION
I 12'-0" X 7'-0"	PARTITION
J 13'-0" X 7'-0"	PARTITION
K 14'-0" X 7'-0"	PARTITION
L 15'-0" X 7'-0"	PARTITION
M 16'-0" X 7'-0"	PARTITION
N 17'-0" X 7'-0"	PARTITION
O 18'-0" X 7'-0"	PARTITION
P 19'-0" X 7'-0"	PARTITION
Q 20'-0" X 7'-0"	PARTITION
R 21'-0" X 7'-0"	PARTITION
S 22'-0" X 7'-0"	PARTITION
T 23'-0" X 7'-0"	PARTITION
U 24'-0" X 7'-0"	PARTITION
V 25'-0" X 7'-0"	PARTITION
W 26'-0" X 7'-0"	PARTITION
X 27'-0" X 7'-0"	PARTITION
Y 28'-0" X 7'-0"	PARTITION
Z 29'-0" X 7'-0"	PARTITION

LETTER	DESCRIPTION
W	WOOD
M	METAL
G	GLASS
F	FABRIC
A	ALUMINUM
S	STEEL
C	CONCRETE
I	INSULATION
V	VENTILATION
L	LEAD
W	WATER
O	OPENING
D	DOOR
W	WINDOW
F	FLOOR
C	CEILING
W	WALL
F	FLOOR FINISH
C	CEILING FINISH
W	WALL FINISH
F	FLOOR FINISH
C	CEILING FINISH
W	WALL FINISH

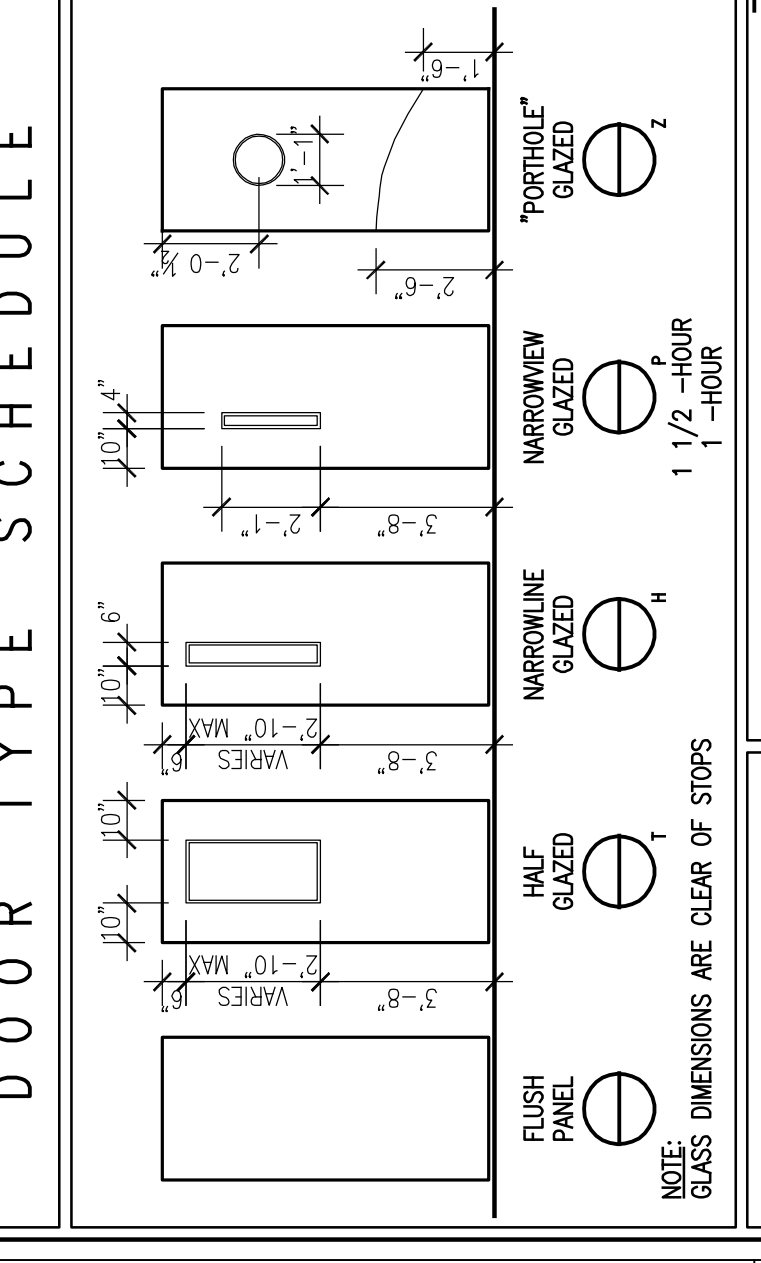

GENERAL NOTES

- 1) ALL DOORS TO BE AS FOLLOWS:
 a) INTERIOR WOOD DOORS TO BE 1 3/4" UNLESS OTHERWISE NOTED.
 b) EXTERIOR/INTERIOR HOLLOW METAL DOORS TO BE 1 3/4" THICKNESS.
 c) DOORS ENCLOSED OR IN 2 HOUR FIRE RATED PARTITIONS TO BE ENCLOSED IN 2 HOUR FIRE RATED PARTITION.
 d) DOORS TO STAIRWAYS OR IN SHEDS WITH 1 HOUR FIRE RATED ENCLOSURES TO BE LABELED FOR 1 HOUR FIRE RATED PARTITION.
 e) DOORS IN 1 HOUR FIRE RATED PARTITIONS TO BE LABELED FOR 1 HOUR FIRE RATED PARTITION.
 f) DOORS IN 3 HOUR FIRE RATED PARTITIONS TO BE LABELED FOR 3 HOUR FIRE RATED PARTITION.
 g) DOORS IN 4 HOUR FIRE RATED PARTITIONS TO BE LABELED FOR 4 HOUR FIRE RATED PARTITION.
 h) DOORS IN 6 HOUR FIRE RATED PARTITIONS TO BE LABELED FOR 6 HOUR FIRE RATED PARTITION.
 i) DOORS IN 8 HOUR FIRE RATED PARTITIONS TO BE LABELED FOR 8 HOUR FIRE RATED PARTITION.
 j) DOORS IN 12 HOUR FIRE RATED PARTITIONS TO BE LABELED FOR 12 HOUR FIRE RATED PARTITION.
 k) DOORS IN 18 HOUR FIRE RATED PARTITIONS TO BE LABELED FOR 18 HOUR FIRE RATED PARTITION.
 l) DOORS IN 24 HOUR FIRE RATED PARTITIONS TO BE LABELED FOR 24 HOUR FIRE RATED PARTITION.
 m) DOORS IN 3 HOUR FIRE RATED PARTITIONS TO BE LABELED FOR 3 HOUR FIRE RATED PARTITION.
 n) DOORS IN 4 HOUR FIRE RATED PARTITIONS TO BE LABELED FOR 4 HOUR FIRE RATED PARTITION.
 o) DOORS IN 6 HOUR FIRE RATED PARTITIONS TO BE LABELED FOR 6 HOUR FIRE RATED PARTITION.
 p) DOORS IN 8 HOUR FIRE RATED PARTITIONS TO BE LABELED FOR 8 HOUR FIRE RATED PARTITION.
 q) DOORS IN 12 HOUR FIRE RATED PARTITIONS TO BE LABELED FOR 12 HOUR FIRE RATED PARTITION.
 r) DOORS IN 18 HOUR FIRE RATED PARTITIONS TO BE LABELED FOR 18 HOUR FIRE RATED PARTITION.
 s) DOORS IN 24 HOUR FIRE RATED PARTITIONS TO BE LABELED FOR 24 HOUR FIRE RATED PARTITION.
 t) DOORS IN 3 HOUR FIRE RATED PARTITIONS TO BE LABELED FOR 3 HOUR FIRE RATED PARTITION.
 u) DOORS IN 4 HOUR FIRE RATED PARTITIONS TO BE LABELED FOR 4 HOUR FIRE RATED PARTITION.
 v) DOORS IN 6 HOUR FIRE RATED PARTITIONS TO BE LABELED FOR 6 HOUR FIRE RATED PARTITION.
 w) DOORS IN 8 HOUR FIRE RATED PARTITIONS TO BE LABELED FOR 8 HOUR FIRE RATED PARTITION.
 x) DOORS IN 12 HOUR FIRE RATED PARTITIONS TO BE LABELED FOR 12 HOUR FIRE RATED PARTITION.
 y) DOORS IN 18 HOUR FIRE RATED PARTITIONS TO BE LABELED FOR 18 HOUR FIRE RATED PARTITION.
 z) DOORS IN 24 HOUR FIRE RATED PARTITIONS TO BE LABELED FOR 24 HOUR FIRE RATED PARTITION.

ISSUE LOG



TRO
 ARCHITECTURE
 PLANNING
 ENGINEERING
 INTERIOR DESIGN
 The Fibria Organization
 Newton, MA 02459-1124
 617-552-4000

Meine Medical Center
 ED Pediatric Exam Renovation
 Portland, Maine

DOOR SCHEDULE & DETAILS

Contract No. 1622 Date Issued JUNE 22, 2021
 AS NOTED Sheet Number
 Drawn By
 Approved By
 Revision

A530

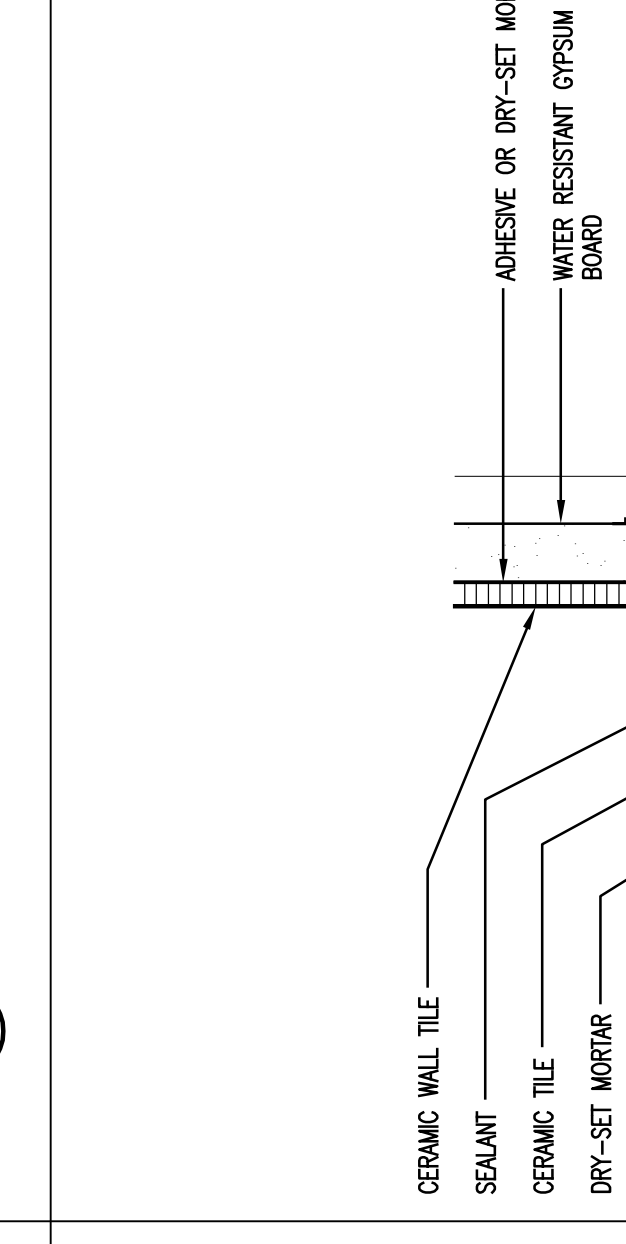
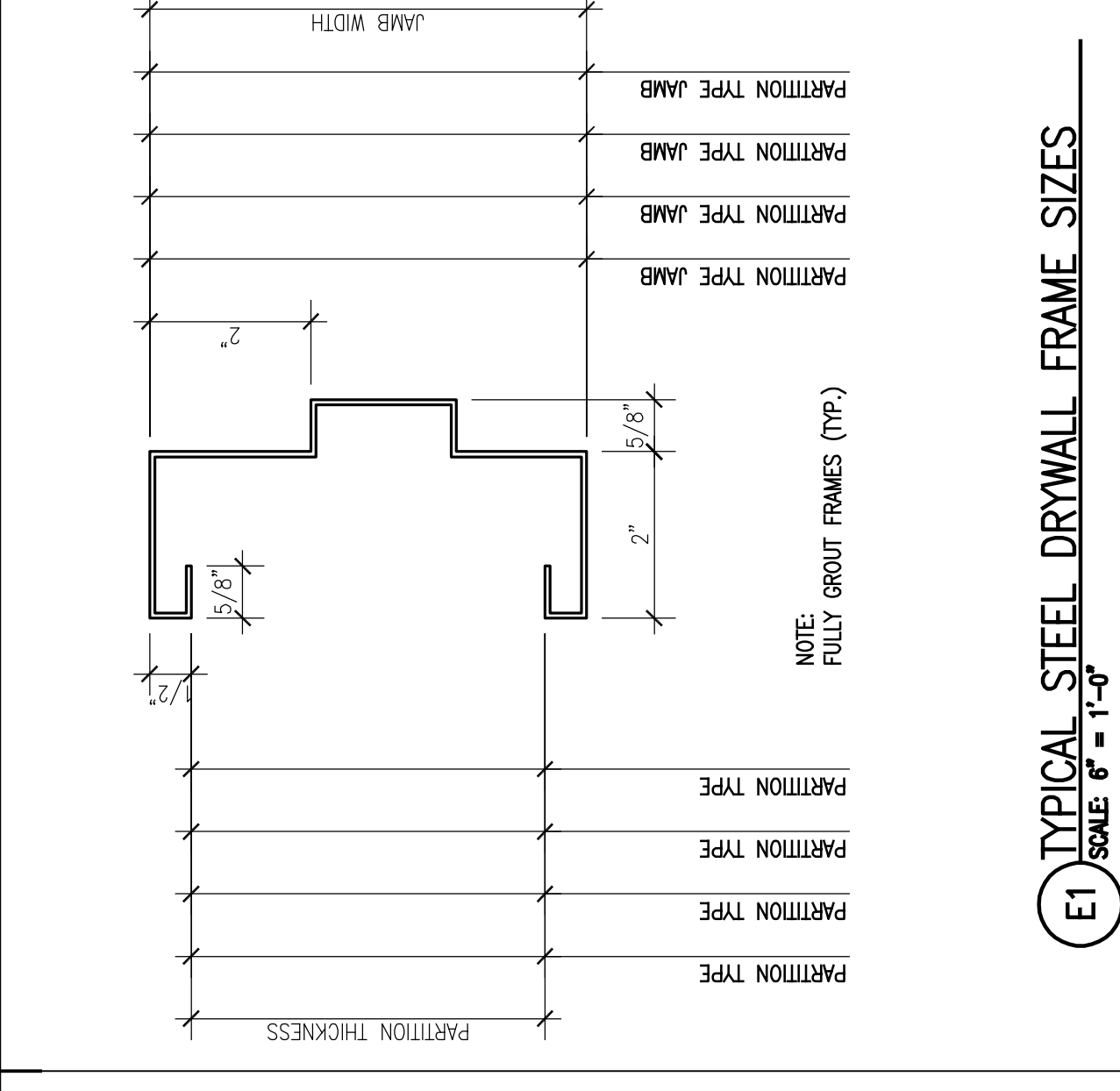

GENERAL NOTES

- 1) ALL DOORS TO BE AS FOLLOWS:
 a) INTERIOR WOOD DOORS TO BE 1 3/4" UNLESS OTHERWISE NOTED.
 b) EXTERIOR/INTERIOR HOLLOW METAL DOORS TO BE 1 3/4" THICKNESS.
 c) DOORS ENCLOSED OR IN 2 HOUR FIRE RATED PARTITIONS TO BE ENCLOSED IN 2 HOUR FIRE RATED PARTITION.
 d) DOORS TO STAIRWAYS OR IN SHEDS WITH 1 HOUR FIRE RATED ENCLOSURES TO BE LABELED FOR 1 HOUR FIRE RATED PARTITION.
 e) DOORS IN 1 HOUR FIRE RATED PARTITIONS TO BE LABELED FOR 1 HOUR FIRE RATED PARTITION.
 f) DOORS IN 3 HOUR FIRE RATED PARTITIONS TO BE LABELED FOR 3 HOUR FIRE RATED PARTITION.
 g) DOORS IN 4 HOUR FIRE RATED PARTITIONS TO BE LABELED FOR 4 HOUR FIRE RATED PARTITION.
 h) DOORS IN 6 HOUR FIRE RATED PARTITIONS TO BE LABELED FOR 6 HOUR FIRE RATED PARTITION.
 i) DOORS IN 8 HOUR FIRE RATED PARTITIONS TO BE LABELED FOR 8 HOUR FIRE RATED PARTITION.
 j) DOORS IN 12 HOUR FIRE RATED PARTITIONS TO BE LABELED FOR 12 HOUR FIRE RATED PARTITION.
 k) DOORS IN 18 HOUR FIRE RATED PARTITIONS TO BE LABELED FOR 18 HOUR FIRE RATED PARTITION.
 l) DOORS IN 24 HOUR FIRE RATED PARTITIONS TO BE LABELED FOR 24 HOUR FIRE RATED PARTITION.
 m) DOORS IN 3 HOUR FIRE RATED PARTITIONS TO BE LABELED FOR 3 HOUR FIRE RATED PARTITION.
 n) DOORS IN 4 HOUR FIRE RATED PARTITIONS TO BE LABELED FOR 4 HOUR FIRE RATED PARTITION.
 o) DOORS IN 6 HOUR FIRE RATED PARTITIONS TO BE LABELED FOR 6 HOUR FIRE RATED PARTITION.
 p) DOORS IN 8 HOUR FIRE RATED PARTITIONS TO BE LABELED FOR 8 HOUR FIRE RATED PARTITION.
 q) DOORS IN 12 HOUR FIRE RATED PARTITIONS TO BE LABELED FOR 12 HOUR FIRE RATED PARTITION.
 r) DOORS IN 18 HOUR FIRE RATED PARTITIONS TO BE LABELED FOR 18 HOUR FIRE RATED PARTITION.
 s) DOORS IN 24 HOUR FIRE RATED PARTITIONS TO BE LABELED FOR 24 HOUR FIRE RATED PARTITION.
 t) DOORS IN 3 HOUR FIRE RATED PARTITIONS TO BE LABELED FOR 3 HOUR FIRE RATED PARTITION.
 u) DOORS IN 4 HOUR FIRE RATED PARTITIONS TO BE LABELED FOR 4 HOUR FIRE RATED PARTITION.
 v) DOORS IN 6 HOUR FIRE RATED PARTITIONS TO BE LABELED FOR 6 HOUR FIRE RATED PARTITION.
 w) DOORS IN 8 HOUR FIRE RATED PARTITIONS TO BE LABELED FOR 8 HOUR FIRE RATED PARTITION.
 x) DOORS IN 12 HOUR FIRE RATED PARTITIONS TO BE LABELED FOR 12 HOUR FIRE RATED PARTITION.
 y) DOORS IN 18 HOUR FIRE RATED PARTITIONS TO BE LABELED FOR 18 HOUR FIRE RATED PARTITION.
 z) DOORS IN 24 HOUR FIRE RATED PARTITIONS TO BE LABELED FOR 24 HOUR FIRE RATED PARTITION.

ISSUE LOG

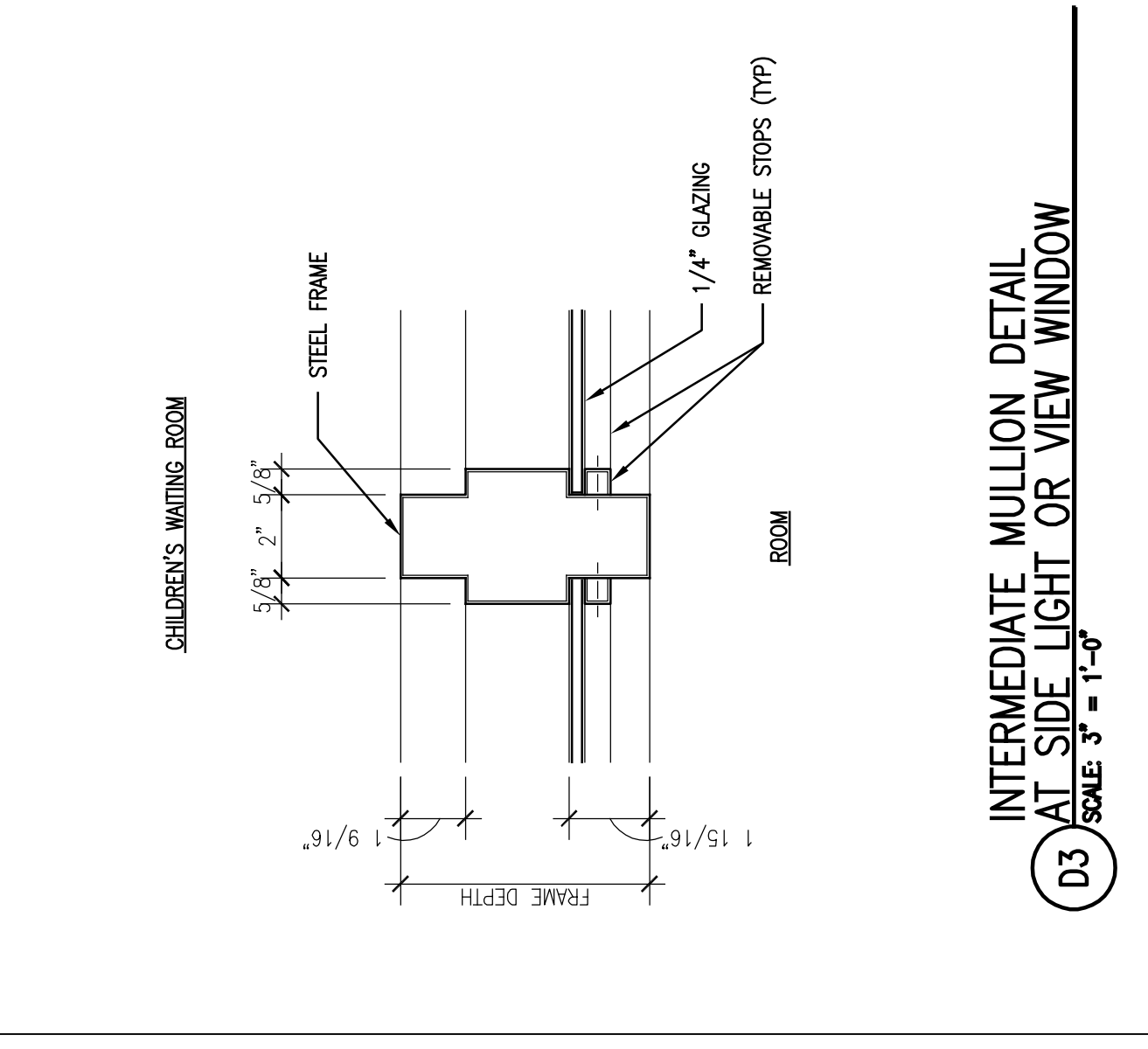
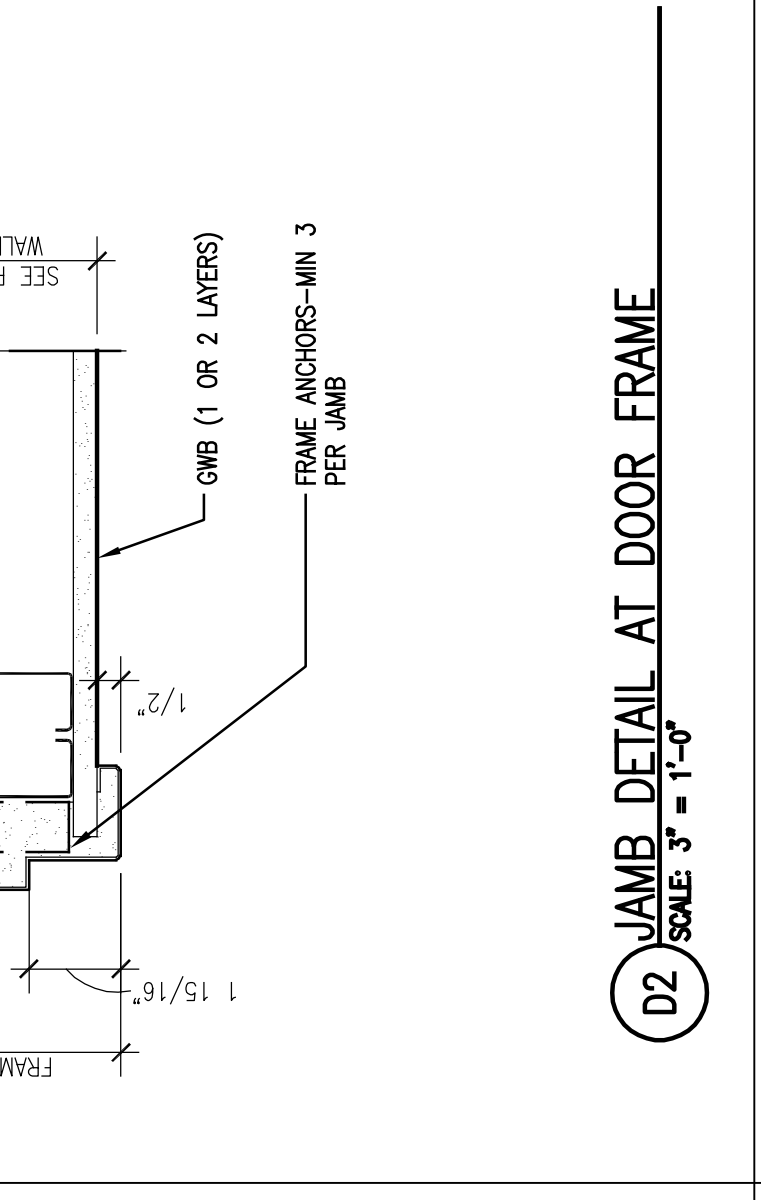
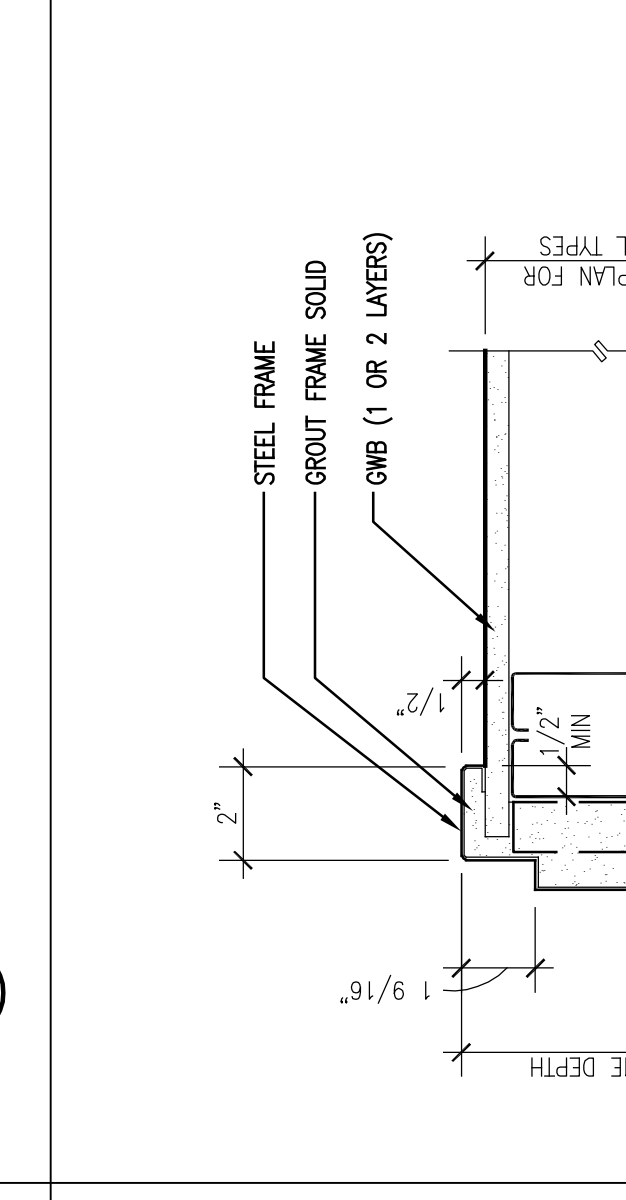
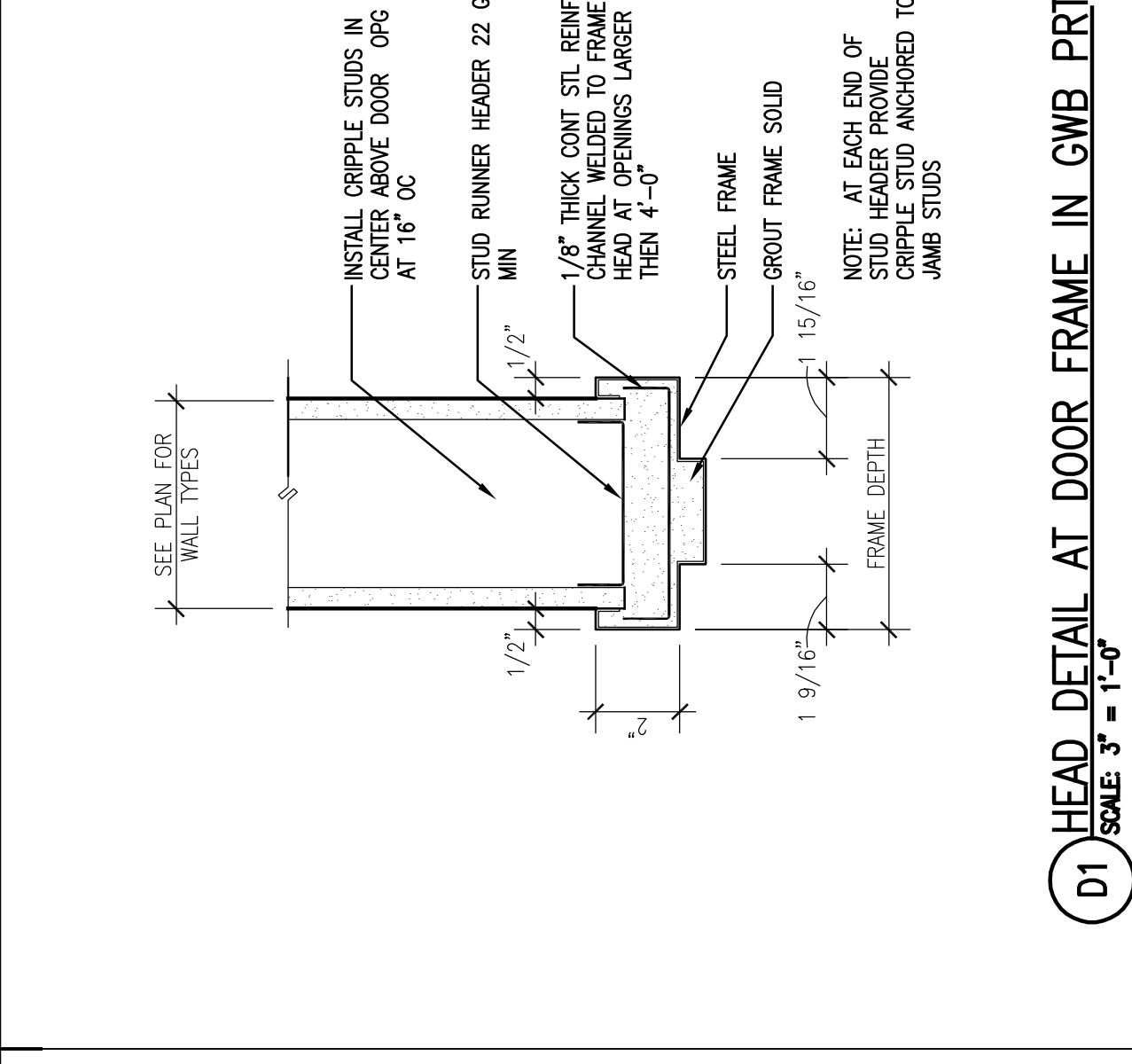
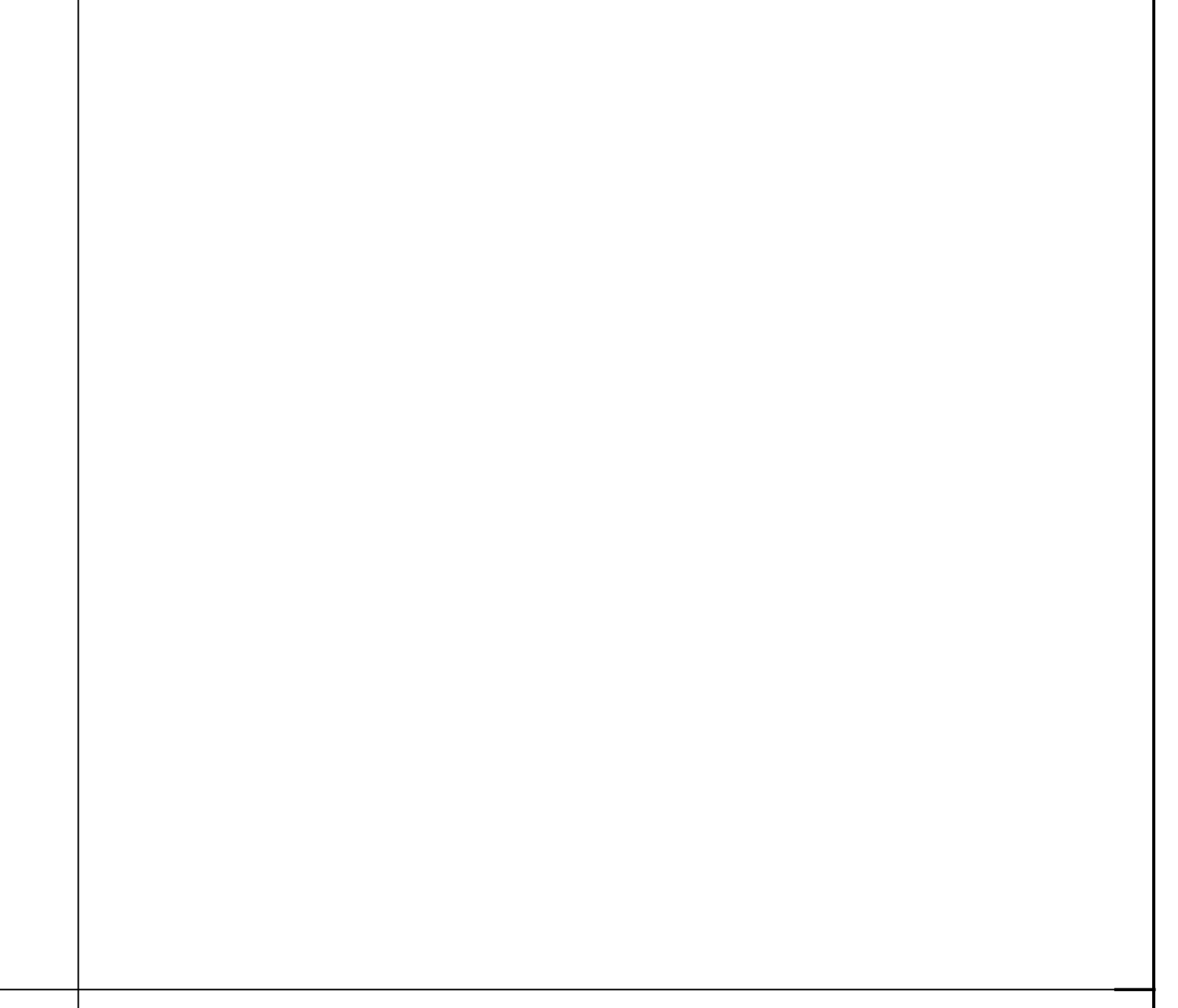

ISSUE LOG

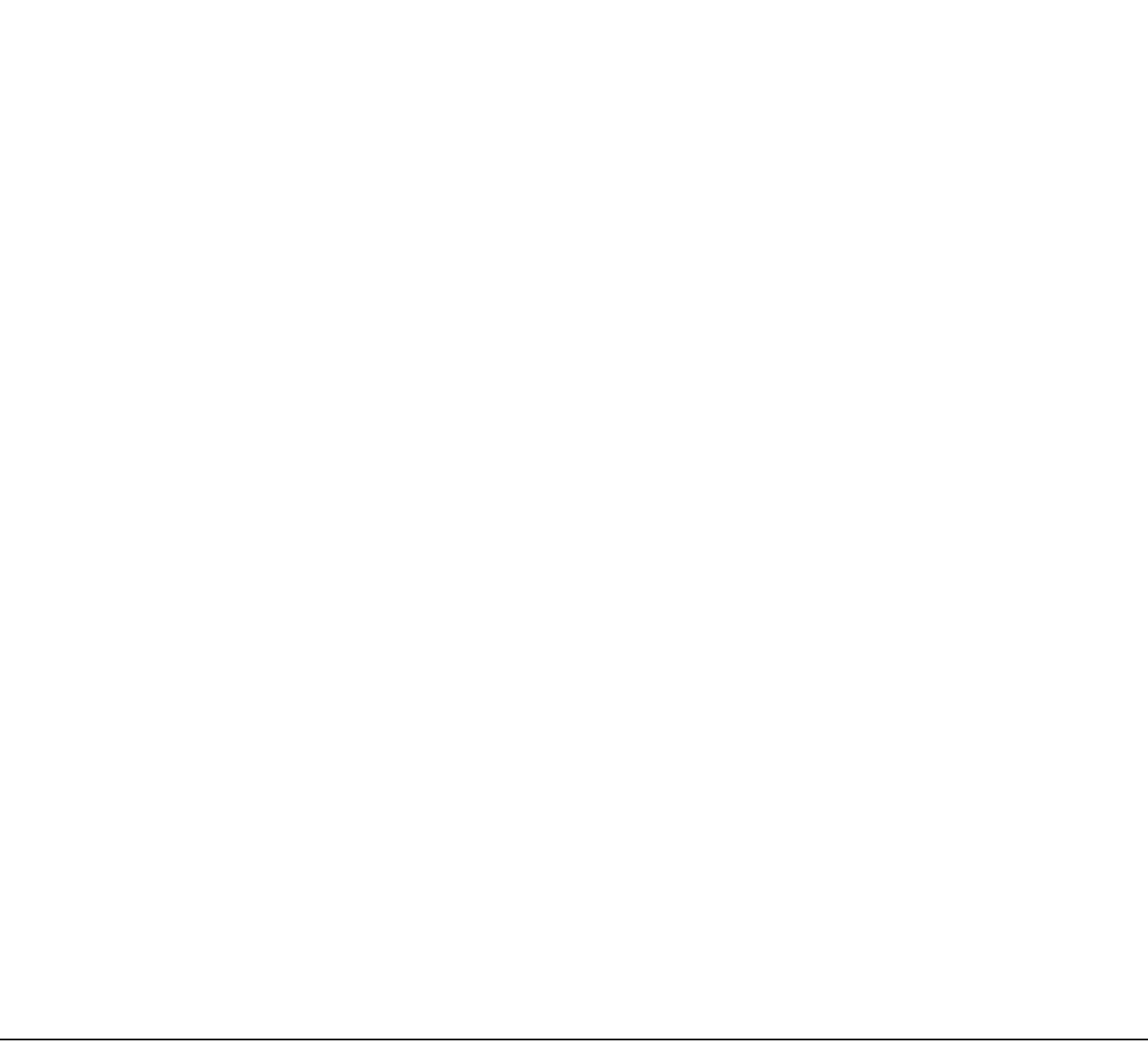
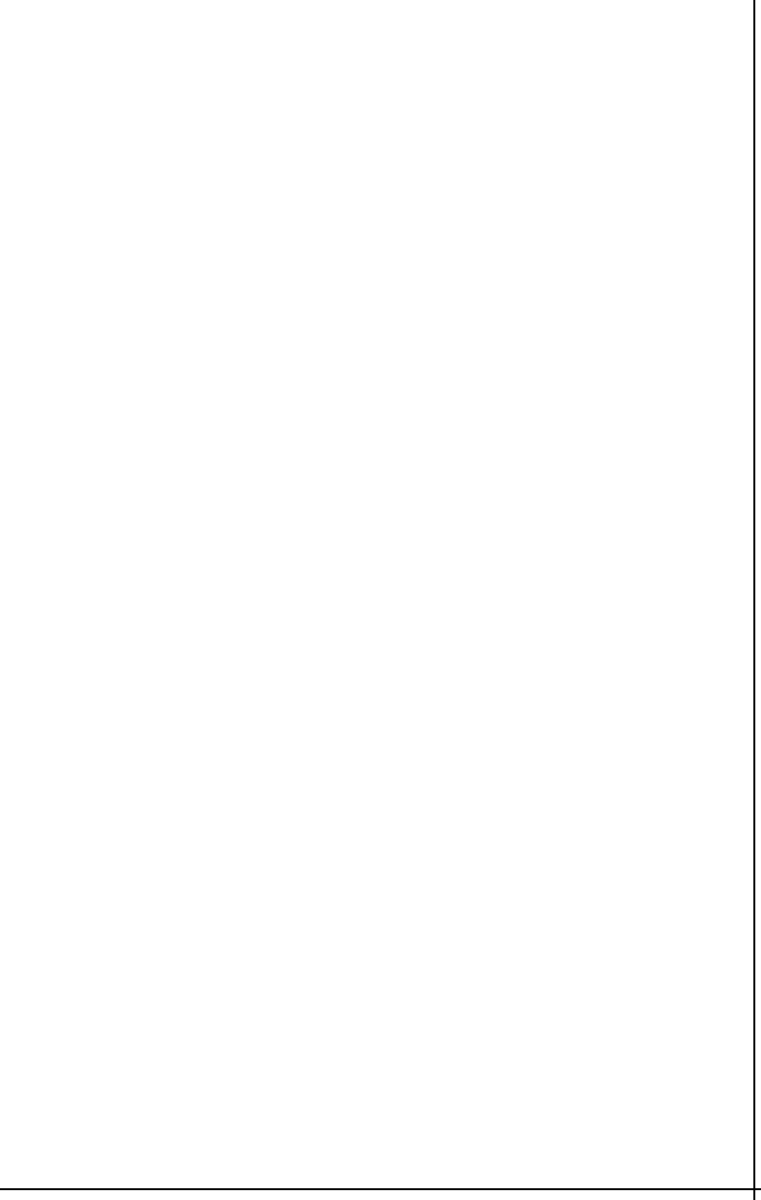
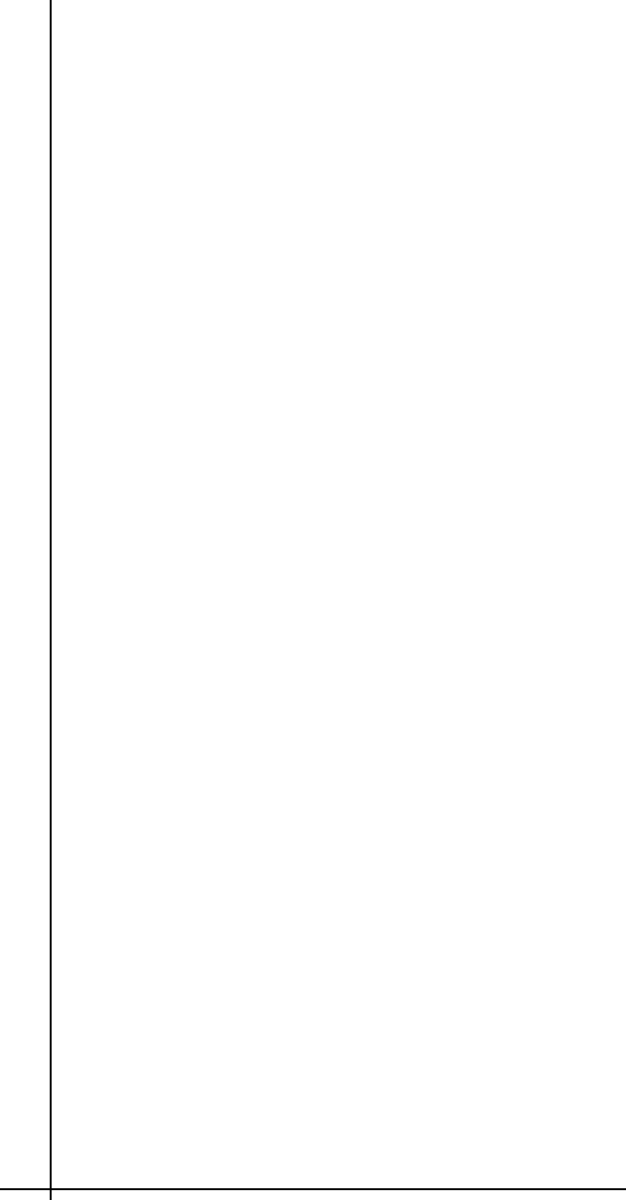
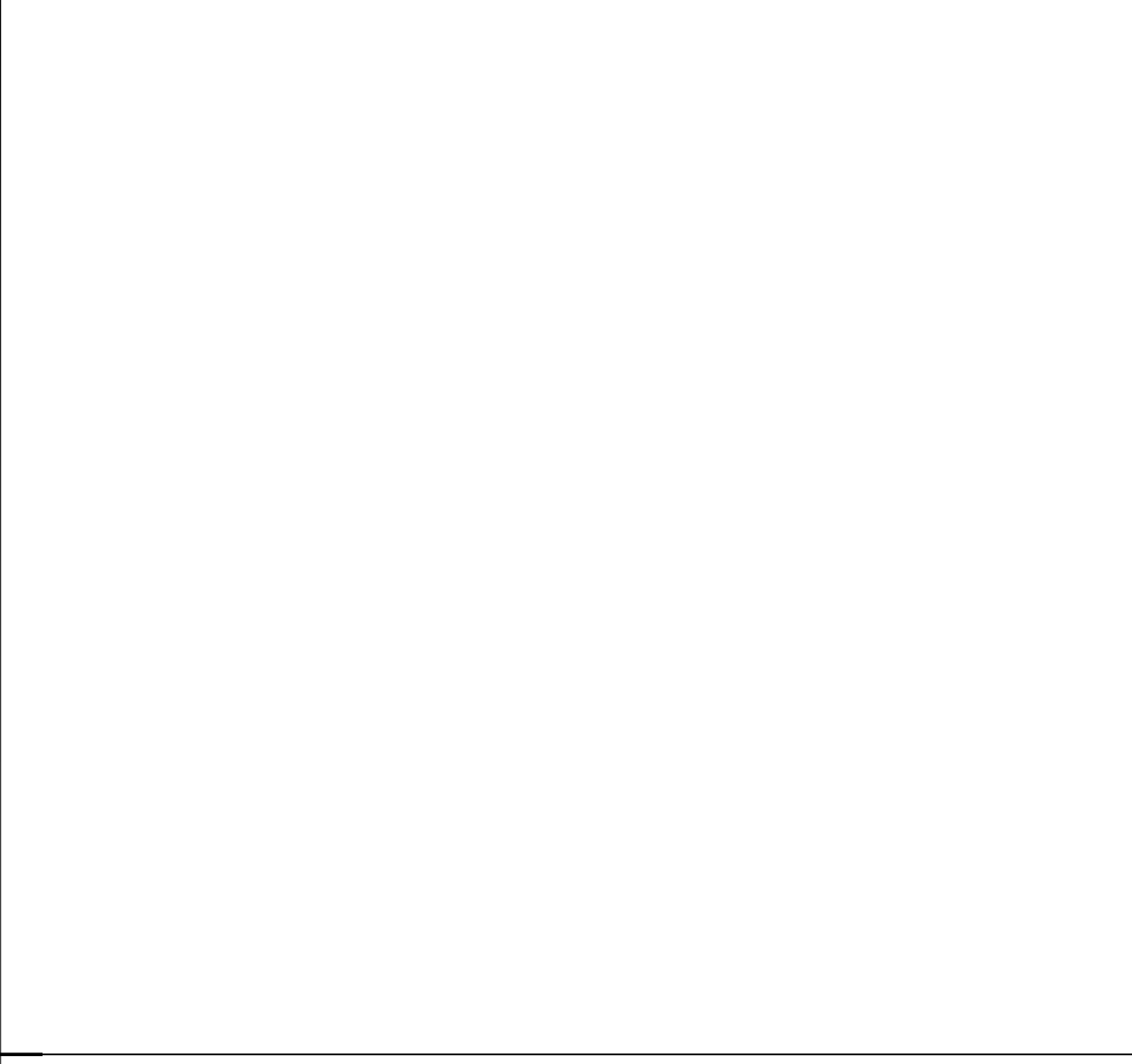
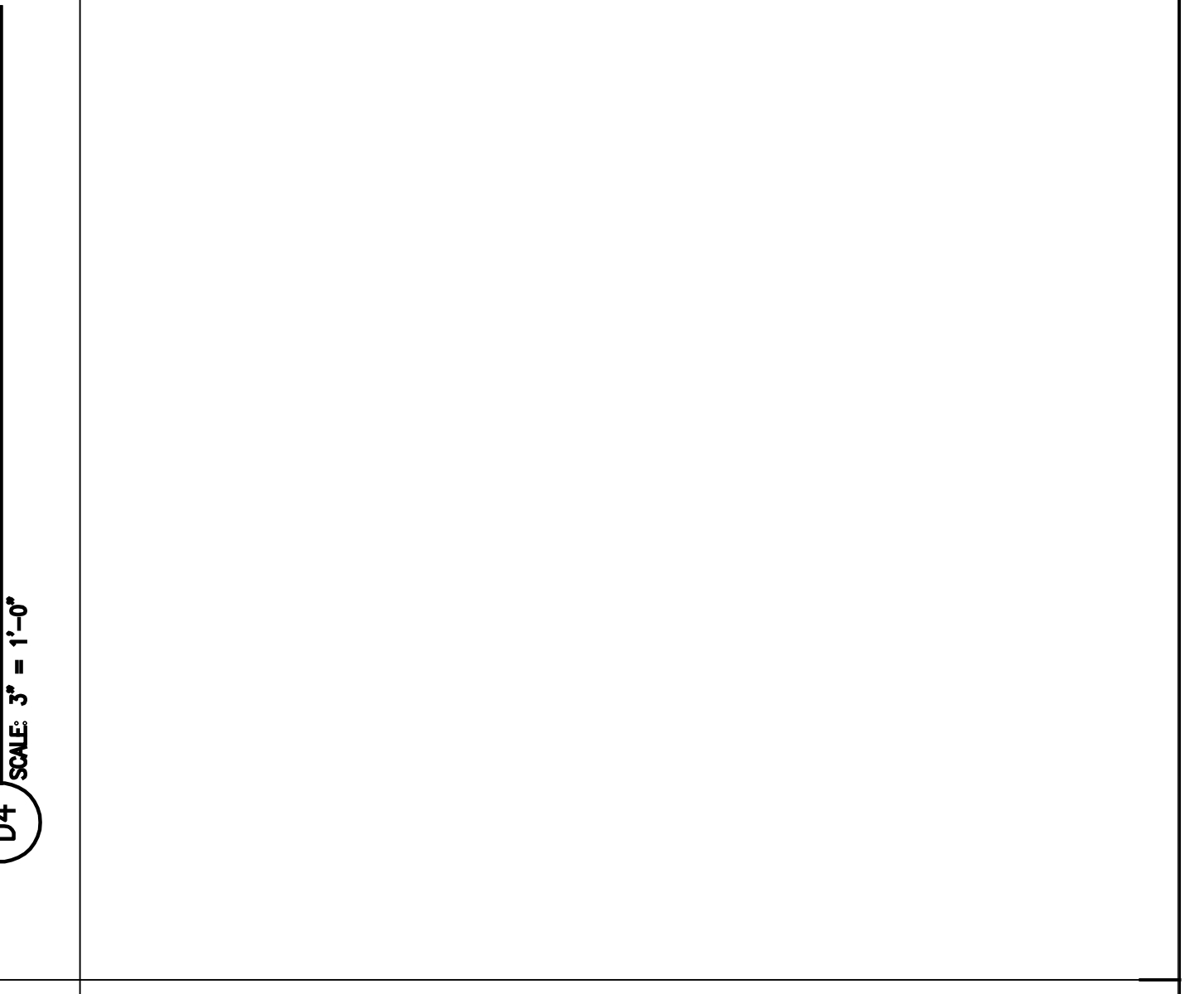
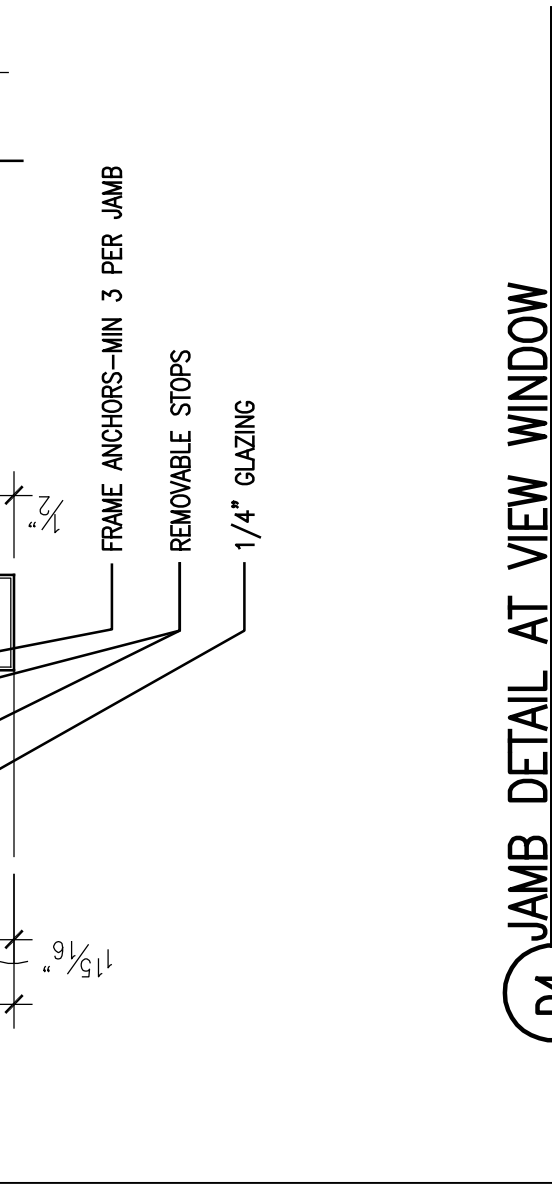
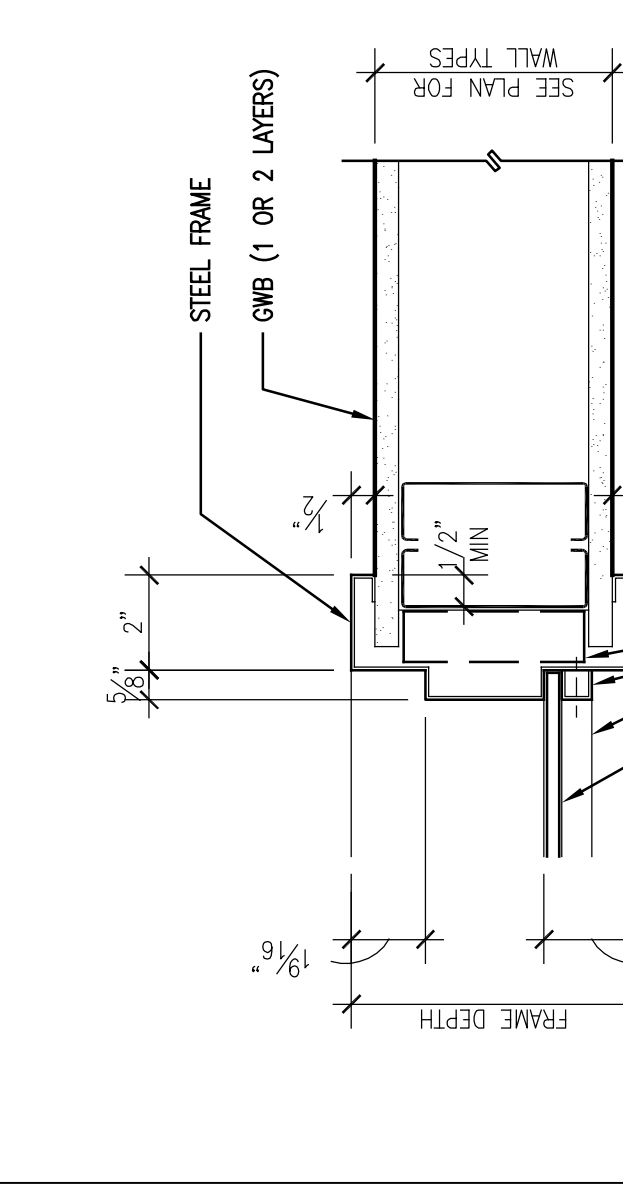

ISSUE LOG

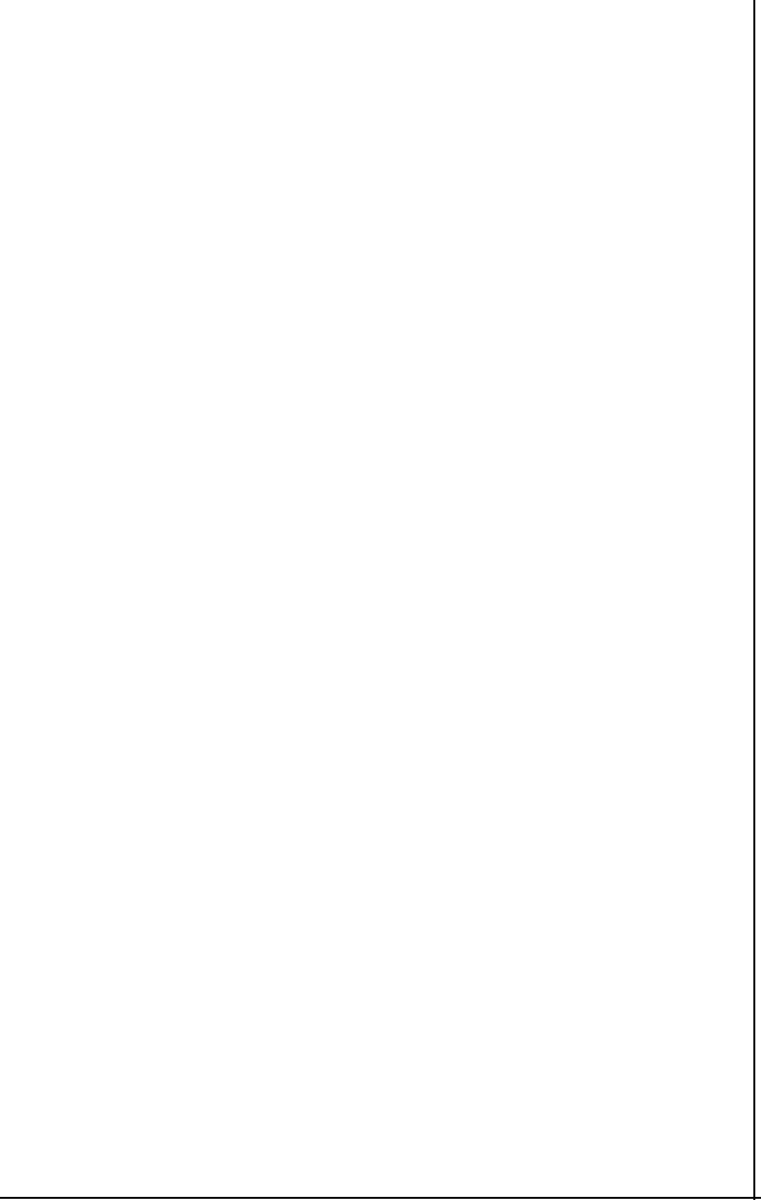
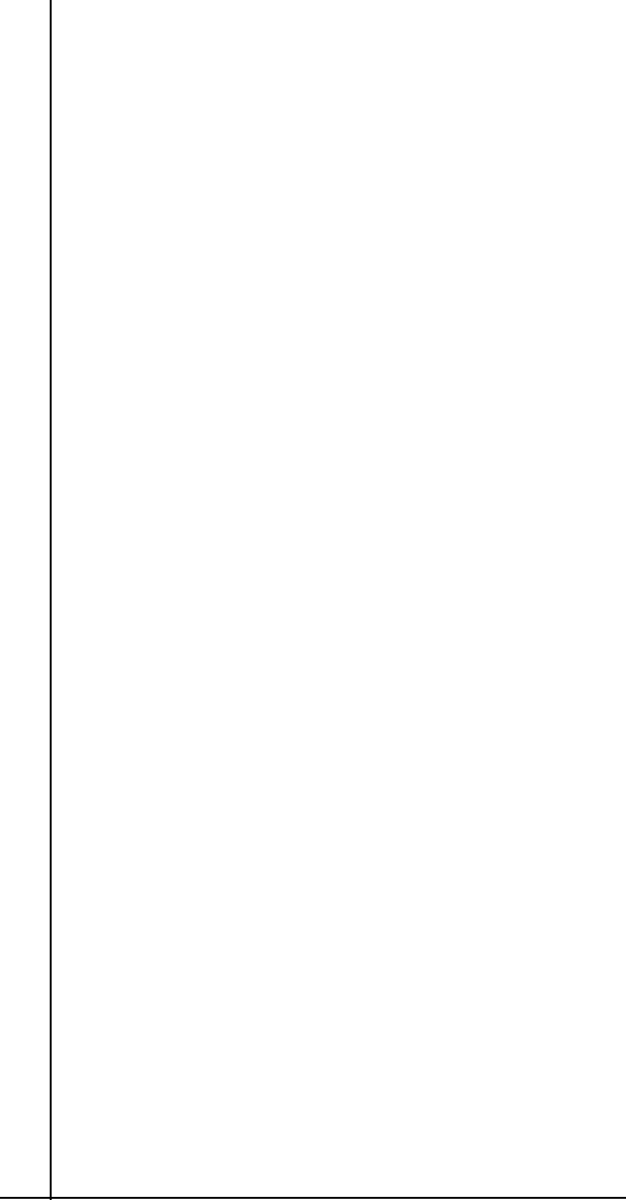
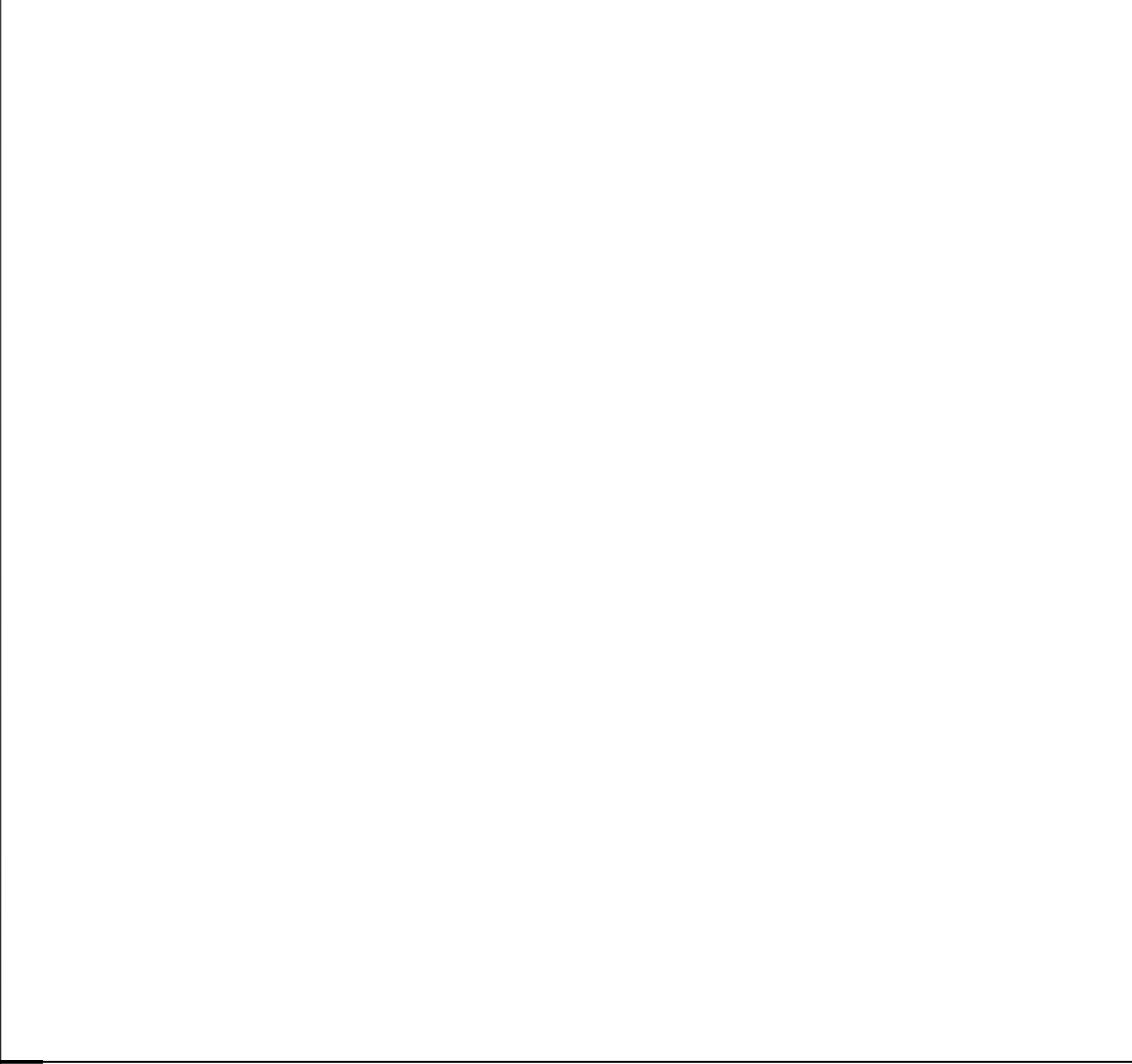
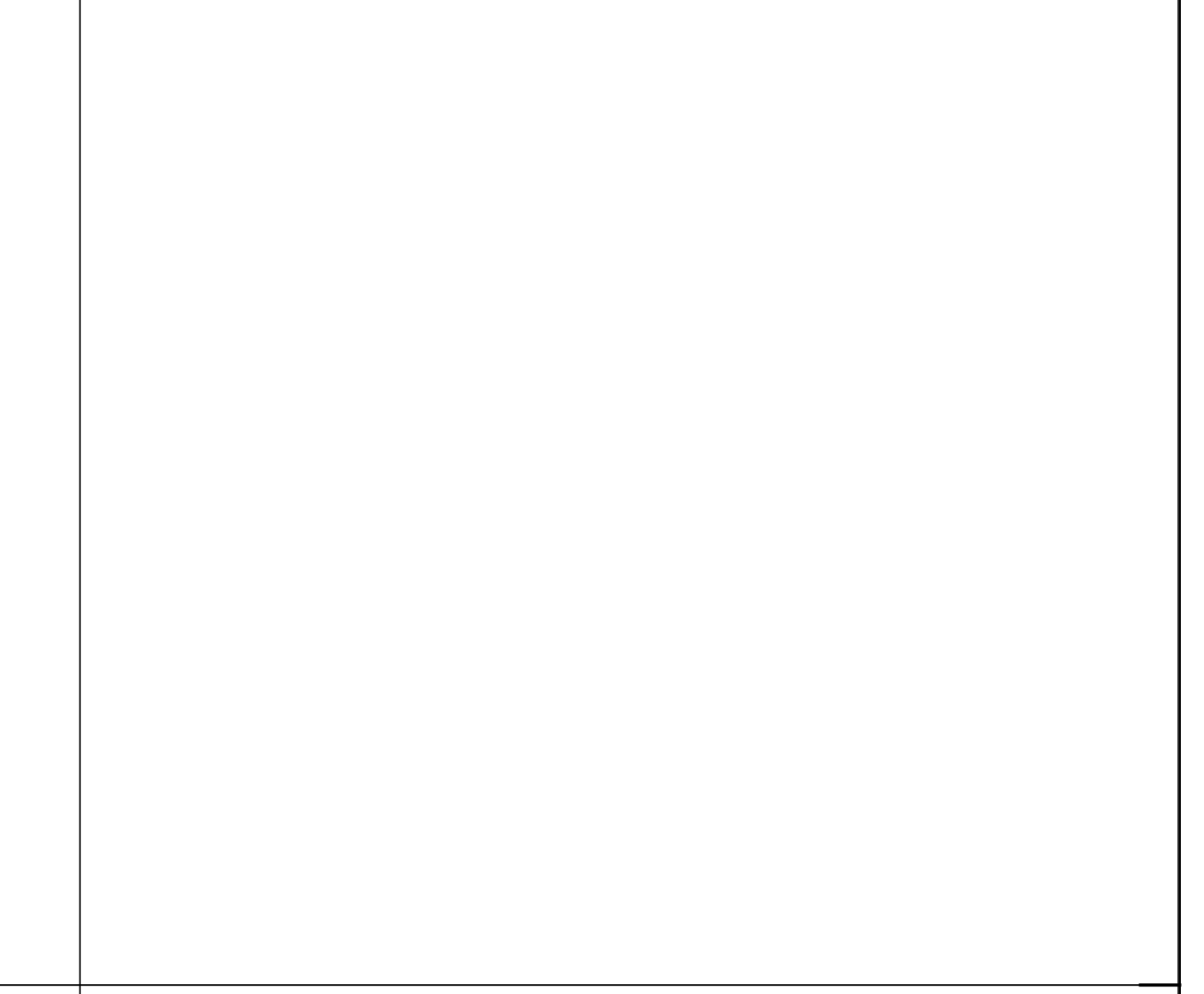

ISSUE LOG

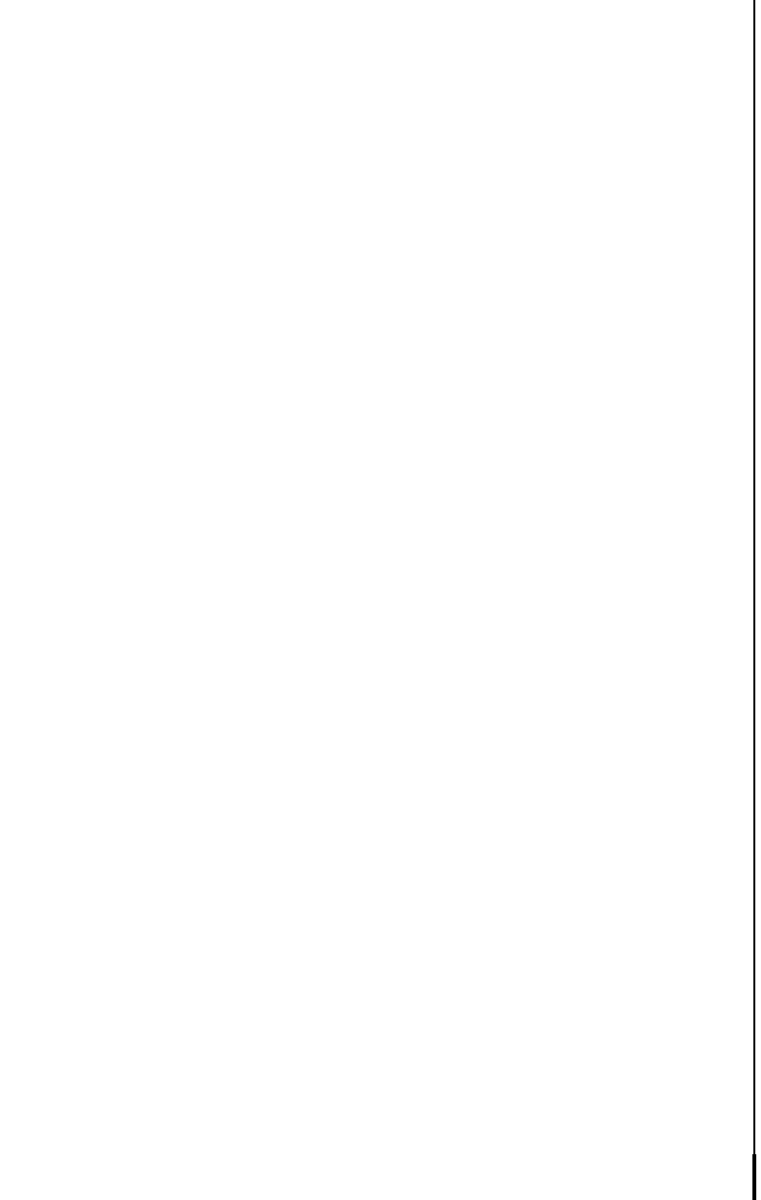
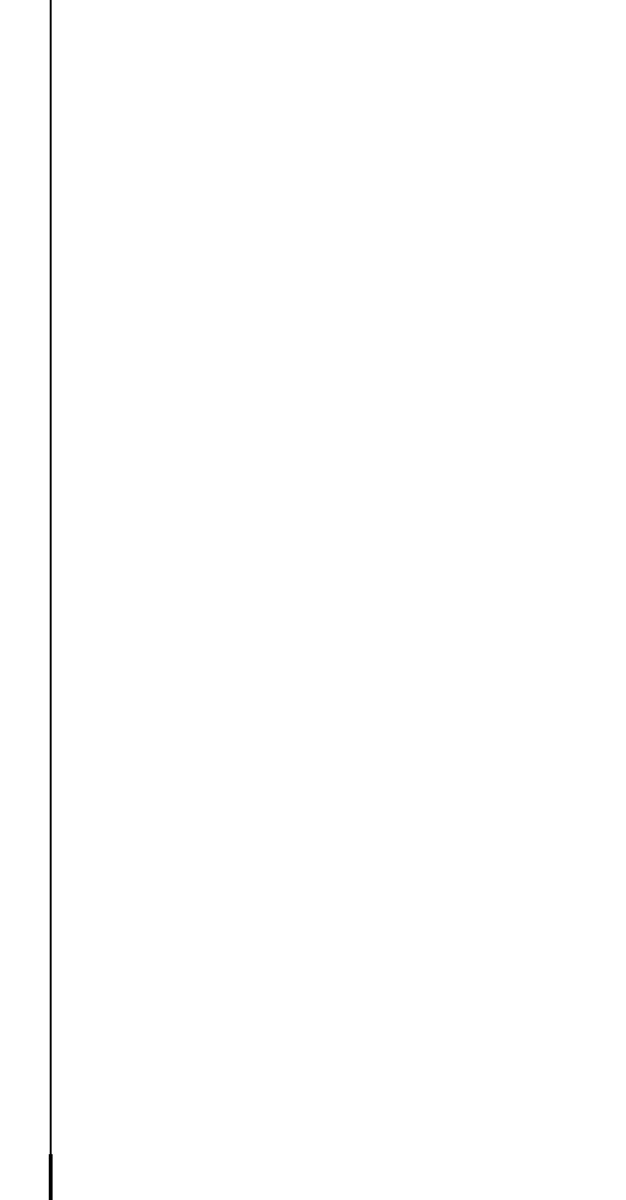

ISSUE LOG

