



# Maine Medical Center

PORTLAND CAMPUS

Environmental Graphics & Wayfinding

**Exterior Sign System**

City of Portland Submittal

22 April 2008



ENVIRONMENTAL GRAPHICS

**Gamble Design LLC**

154 Maplewood Avenue

Portsmouth NH 03801

☎ 603.427.1300

ARCHITECTURE/INTERIOR DESIGN

**TRO|Jung Brannen**

22 Boston Wharf Road

Boston MA 02210

☎ 617.502.3400

SITE/LANDSCAPE

**Sebago Technics**

1 Chabot Street

Westbrook ME 04092

☎ 207.856.0277

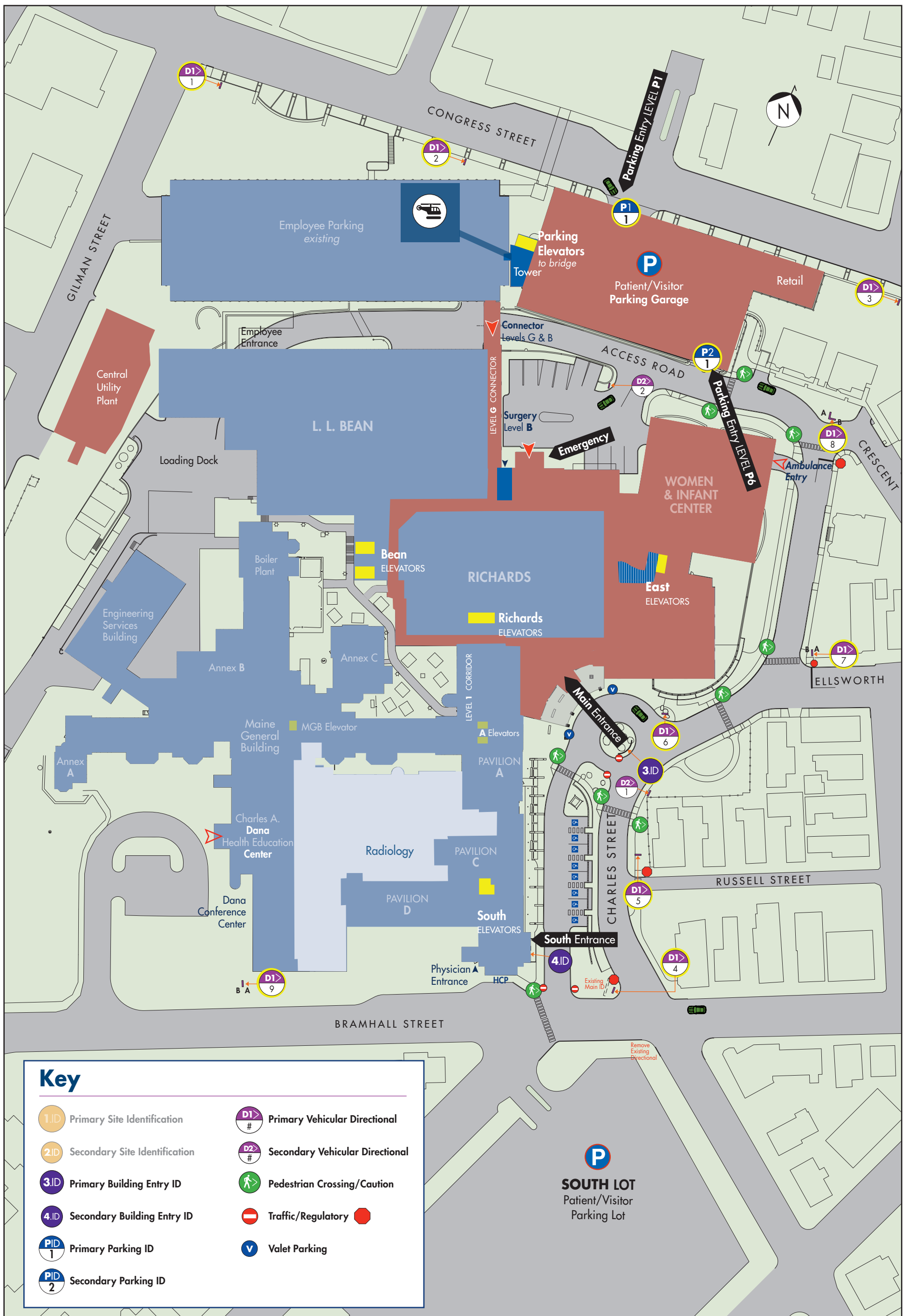

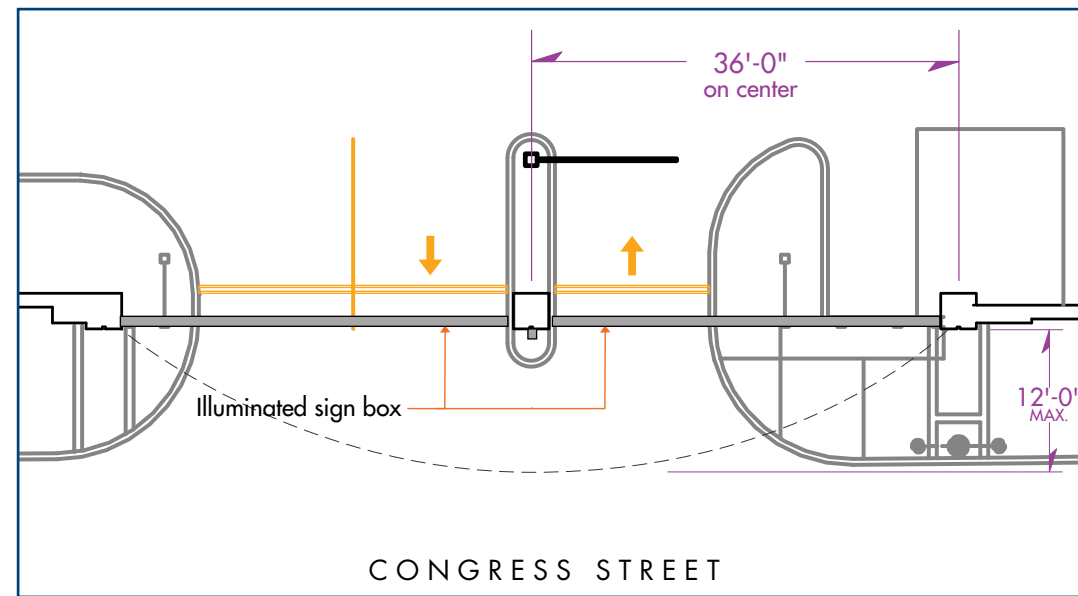

Plan View

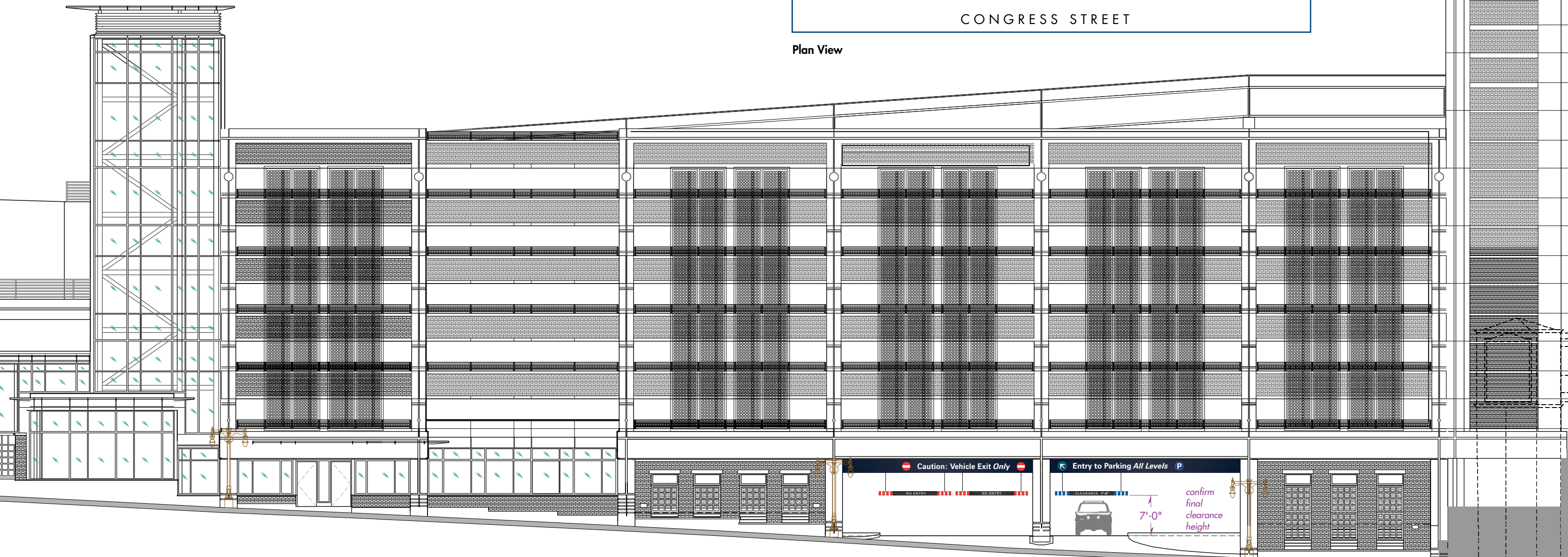

**P1** Parking Garage Entry ID 1 Congress Street suspended/illuminated  
 A Scale: 1/16" = 1'-0"





**1** Parking Garage Entry ID view eastward up Congress Street  
Scale: relative to image



**Sign Box typical**

1/8" aluminum armature with internal structural supports; paint color: "Dark Blue Metallic" MPC# \_\_\_\_\_ to match exterior directional signs with 1/4" clear "push-thru" graphics in colors shown. Sign box internally illuminated by high-output fluorescents and suspension mounted flush to precast structure above. Clearance bars in colors shown fabricated from 8" dia. acrylic tubing or equal and suspended at final height TBD.

**P1** Parking Garage Entry ID view across Congress Street  
**B** Scale: relative to image



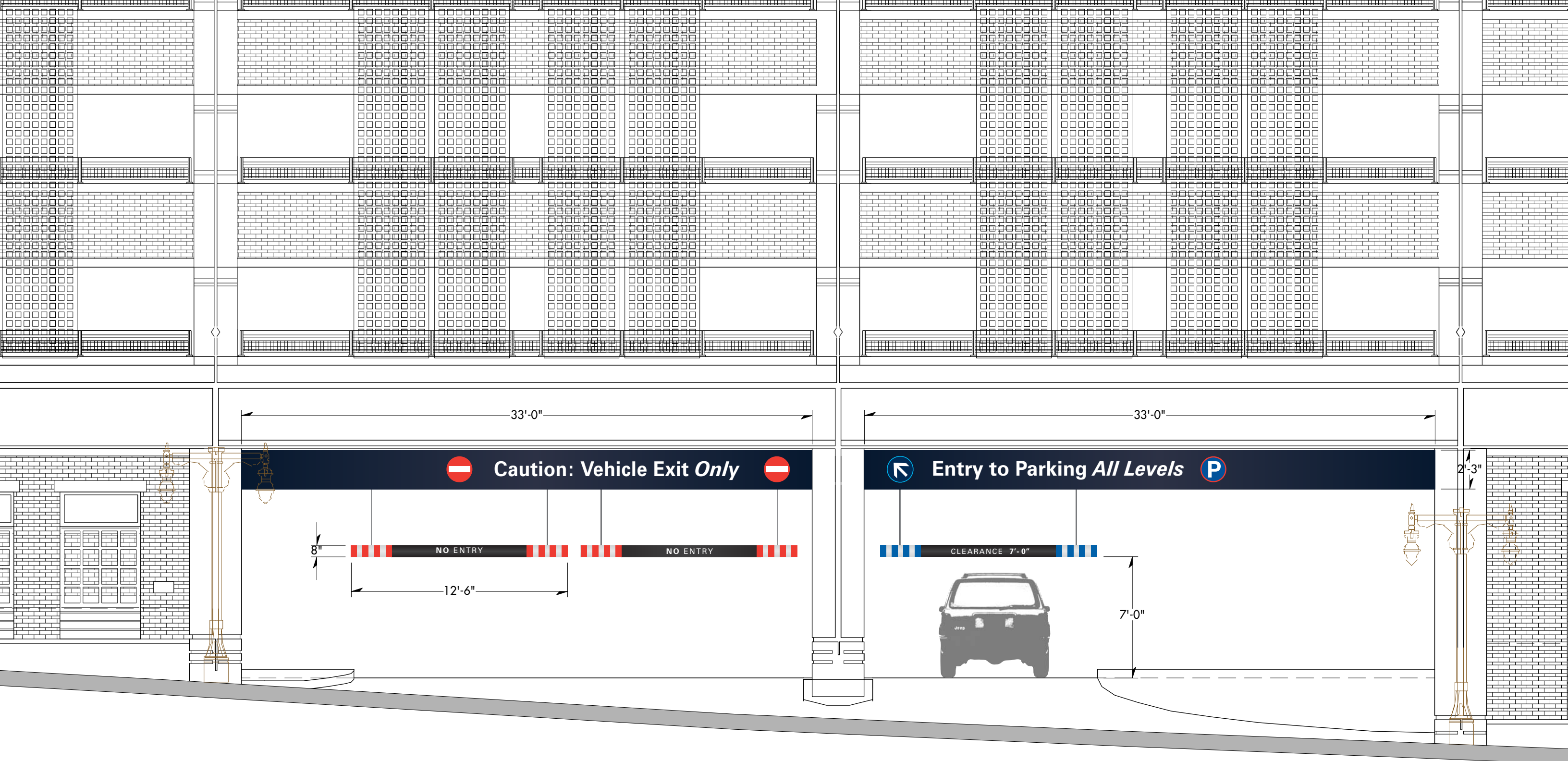

**P1** Parking Garage Entry ID 1 Congress Street dimensions/detail  
**C** Scale: 3/16" = 1'-0"

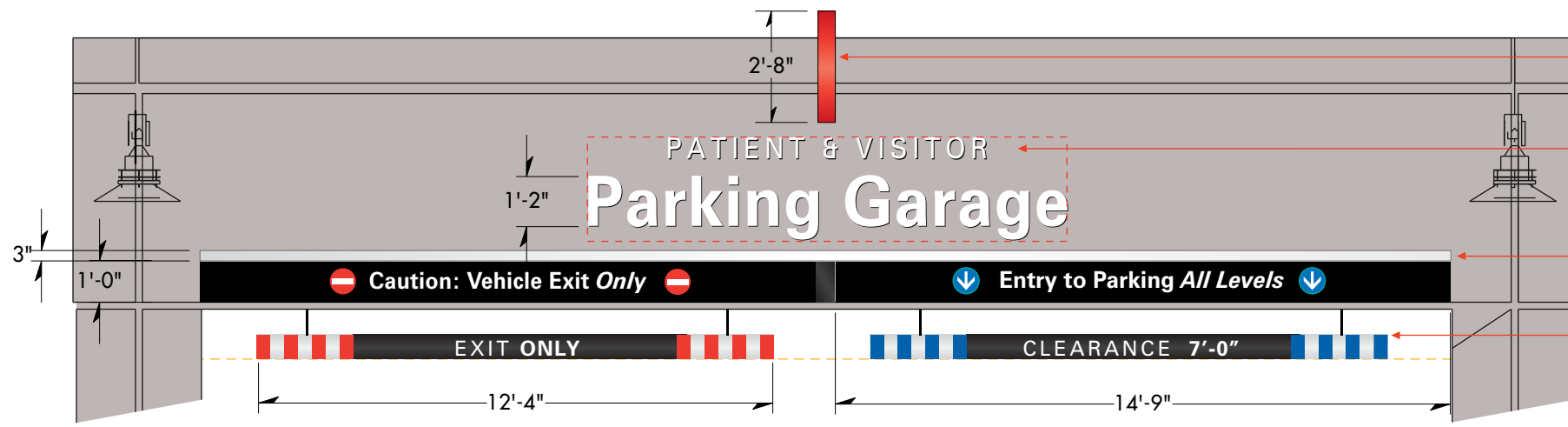

Design Layout no MMC identity  
Scale: 1/4" = 1'-0"

**Projecting "P"**  
Internally illuminated disk sign projects from fascia

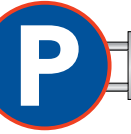

**Dimensional Graphics**  
1" deep dimensional graphics flush mounted to precast fascia;  
paint color: "Satin Aluminum"

**Sign Panels w/Arc**  
Painted sign panels with vinyl graphics mount flush over garage entry;  
fabricated aluminum "arc" band over panels (projects approx. 3") paint  
color: "Satin Aluminum"; separates panels from dimensional graphics above.

**Clearance Bar typical**  
7" diameter painted acrylic tubing  
or equal suspends from precast  
structure above; Verify drop height

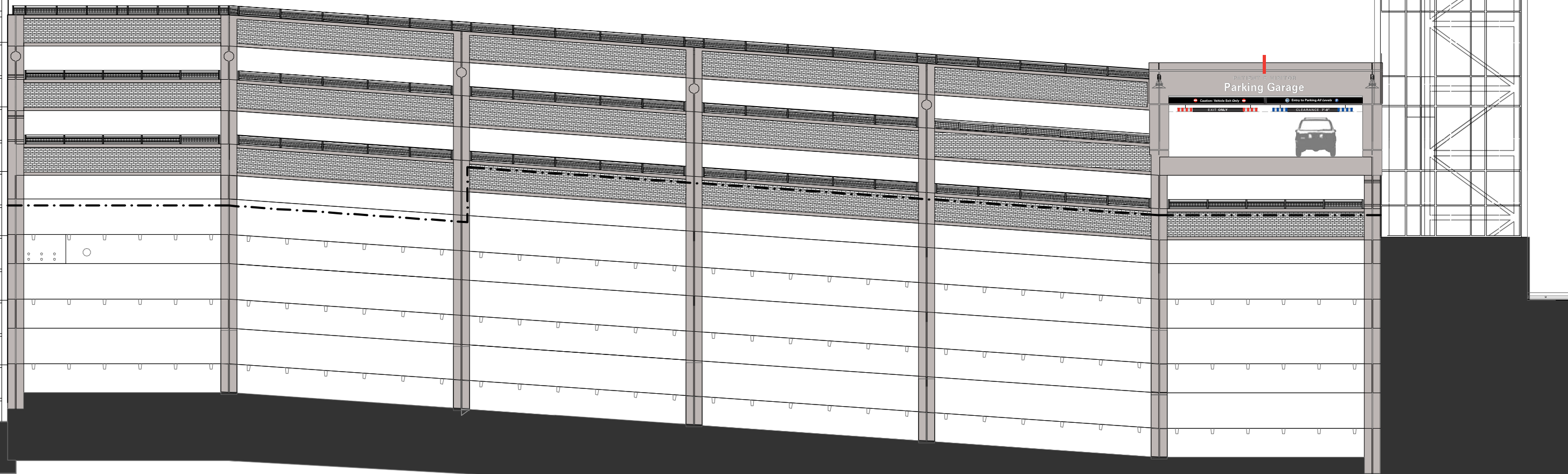

**P2** Parking Garage Secondary Entry ID South Elevation dimensional graphics w/illuminated disk  
1 Scale: 1/16" = 1'-0"



**Projecting Sign**  
 Parking symbol disk projects from concrete column; internally-illuminated/double-sided

**Dimensional Graphics**  
 Non-illuminated dimensional graphics/panels flush mounted to concrete fascia.

**Sign Panel**  
 Sign panels with vinyl graphics mount flush over parking garage entry; 3" arc band above panels; color: "Satin Aluminum"

**Clearance Bar** *typical*  
 Painted plastic tube with vinyl graphics suspended from ceiling; graphic layout shown on dwg. #P2.1; clearance height TBD

**Level ID**  
 Painted sign panel with vinyl graphics

**P2** Secondary Parking Garage Entry ID on internal Access Road *projecting/dimensional*  
 1 Scale: relative to image



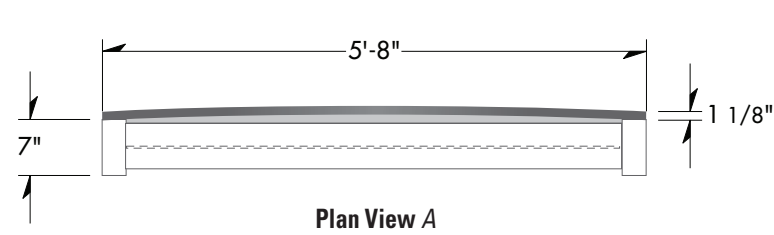

Side View

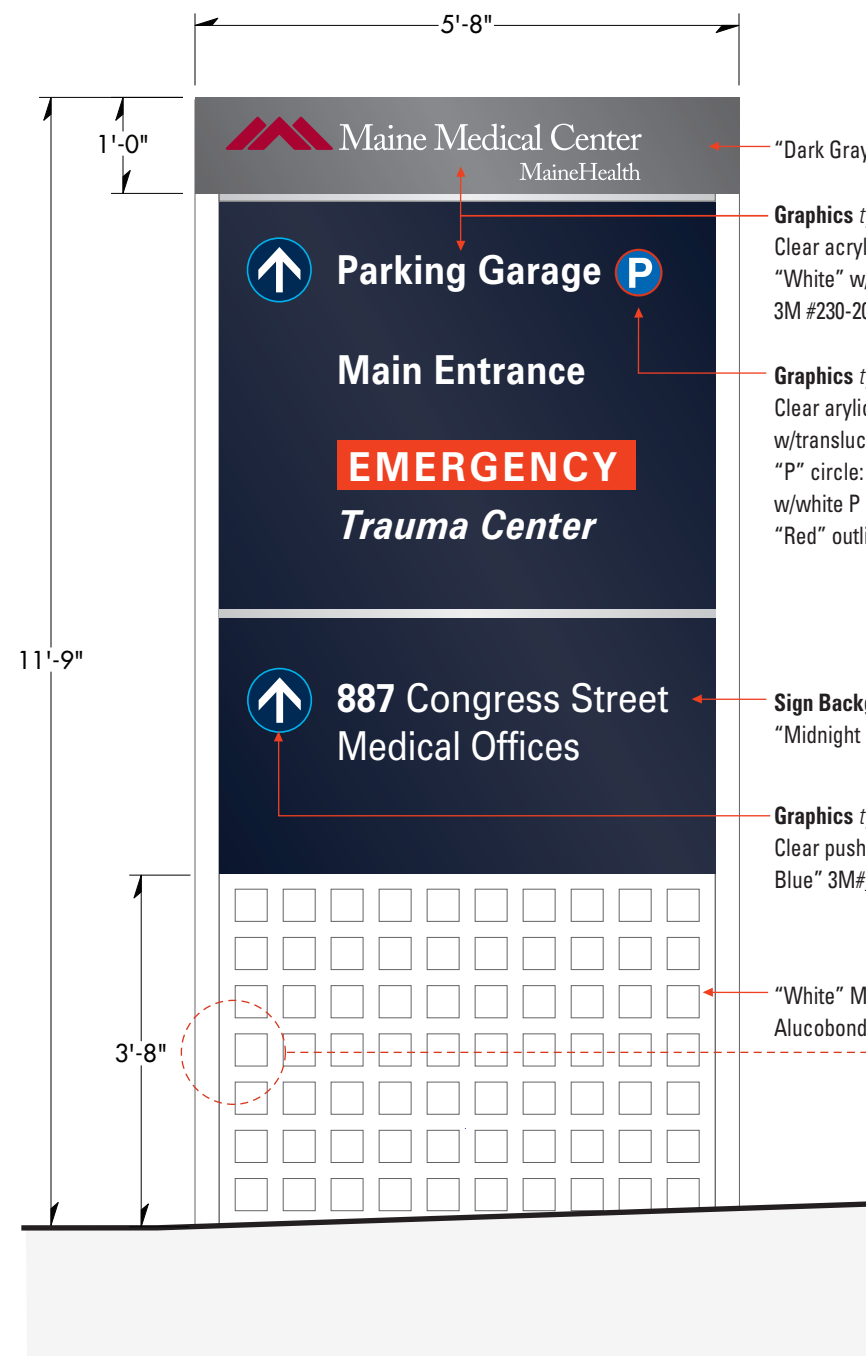
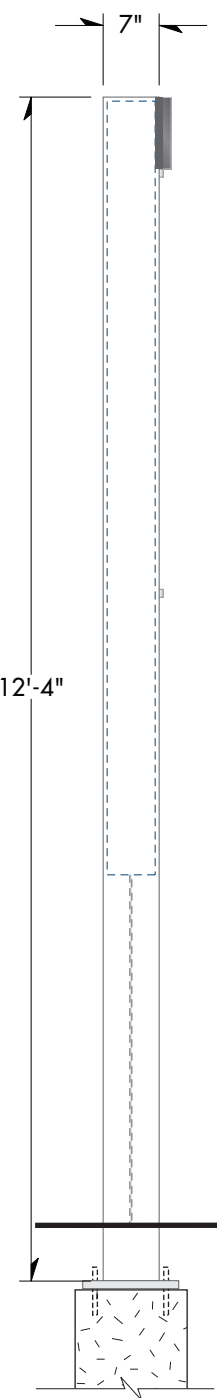
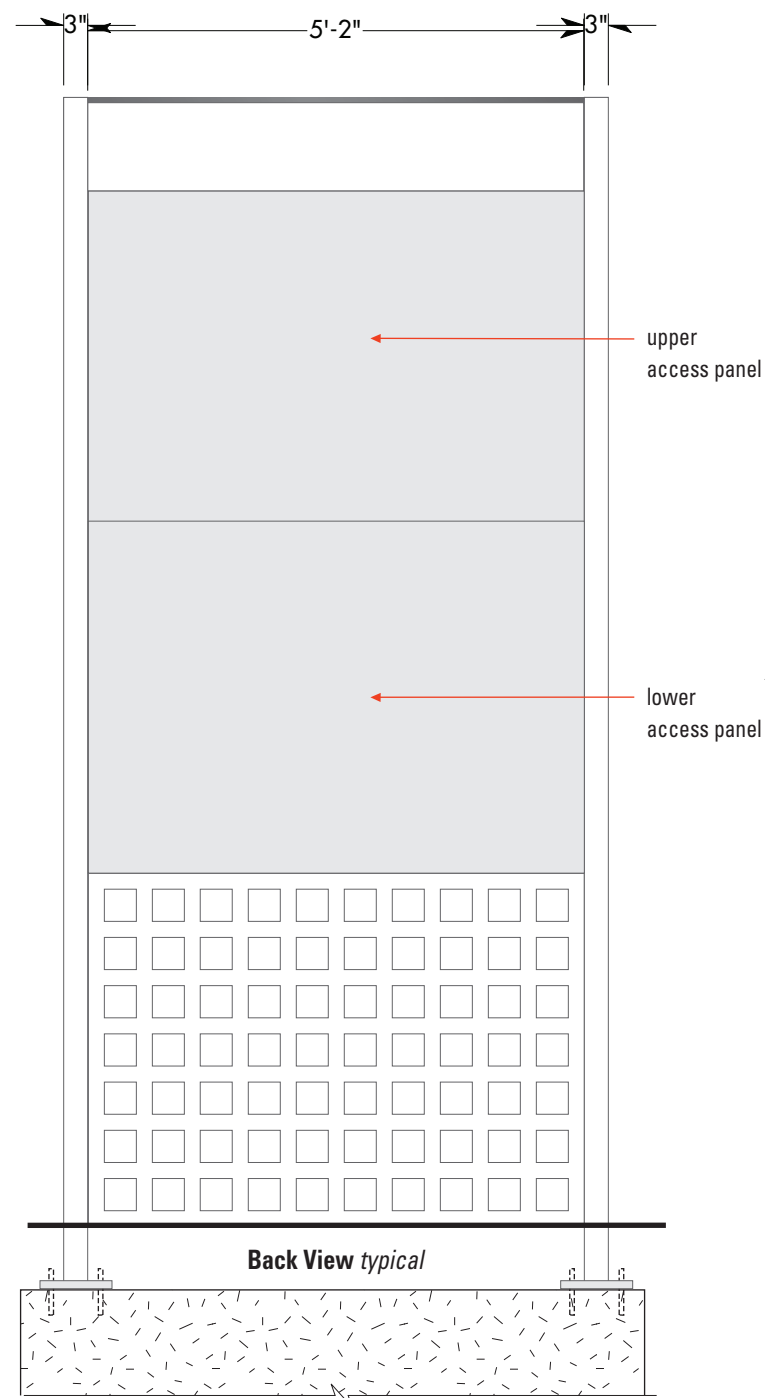
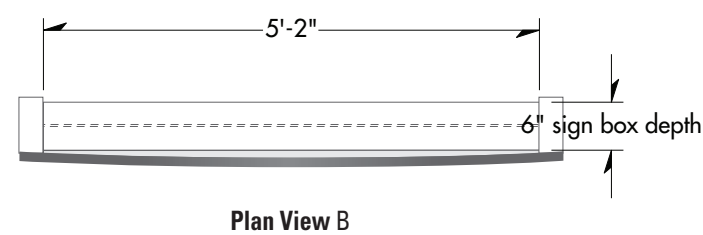

- “Dark Gray Metallic” MP# \_\_\_\_\_
- Graphics typical**  
Clear acrylic push-thru graphics  
“White” w/logo “Red” translucent vinyl  
3M #230-20
- Graphics typical**  
Clear acrylic push-thru circle w/  
w/translucent vinyl graphics;  
“P” circle: “Intense Blue” 3M #220-47  
w/white P and translucent  
“Red” outline 3M #230-33
- Sign Background**  
“Midnight Blue Metallic” MP# \_\_\_\_\_
- Graphics typical**  
Clear push through circle w/ “Bright  
Blue” 3M# \_\_\_\_\_ outline
- “White” MP# \_\_\_\_\_ color to match  
Alucobond “Birch” #B2000-D

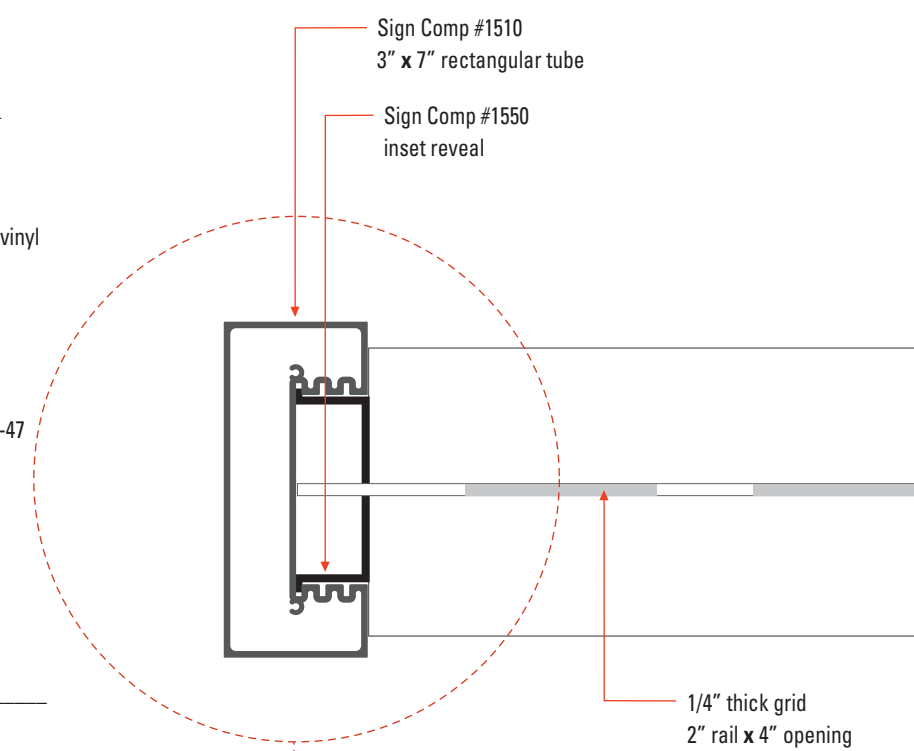

**D1** Sign Post/Grid Detail  
**B** Scale: 3" = 1'-0"

**D1** Primary Directional Sign 1  
**1** Scale: 1/2" = 1'-0"



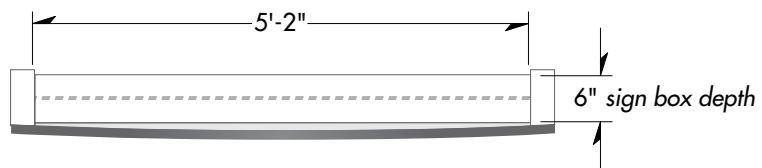

Top View typical

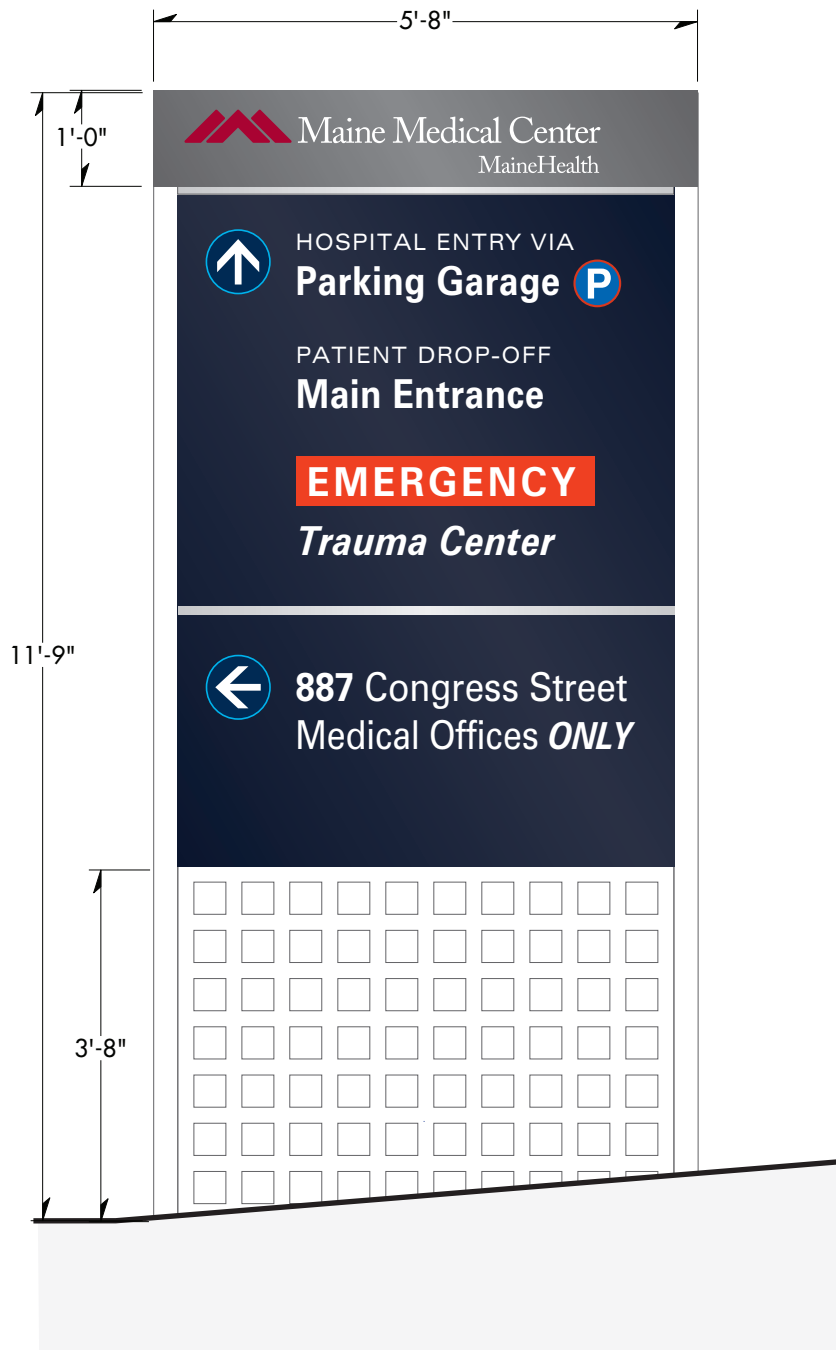

**D1** Primary Directional Sign D1-2  
2 Scale: 1/2" = 1'-0"

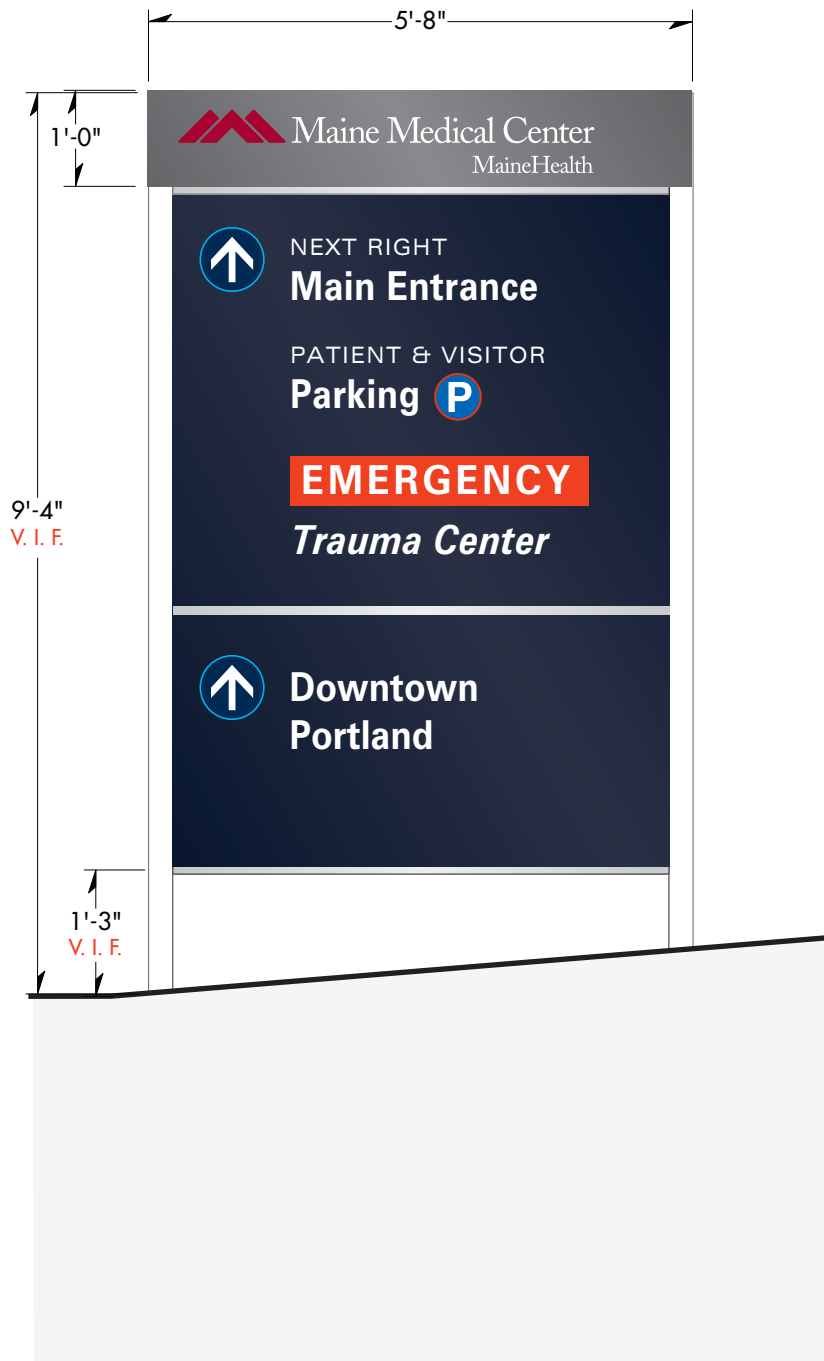

**D1** Primary Directional Sign D1-3  
3 Scale: 1/2" = 1'-0"

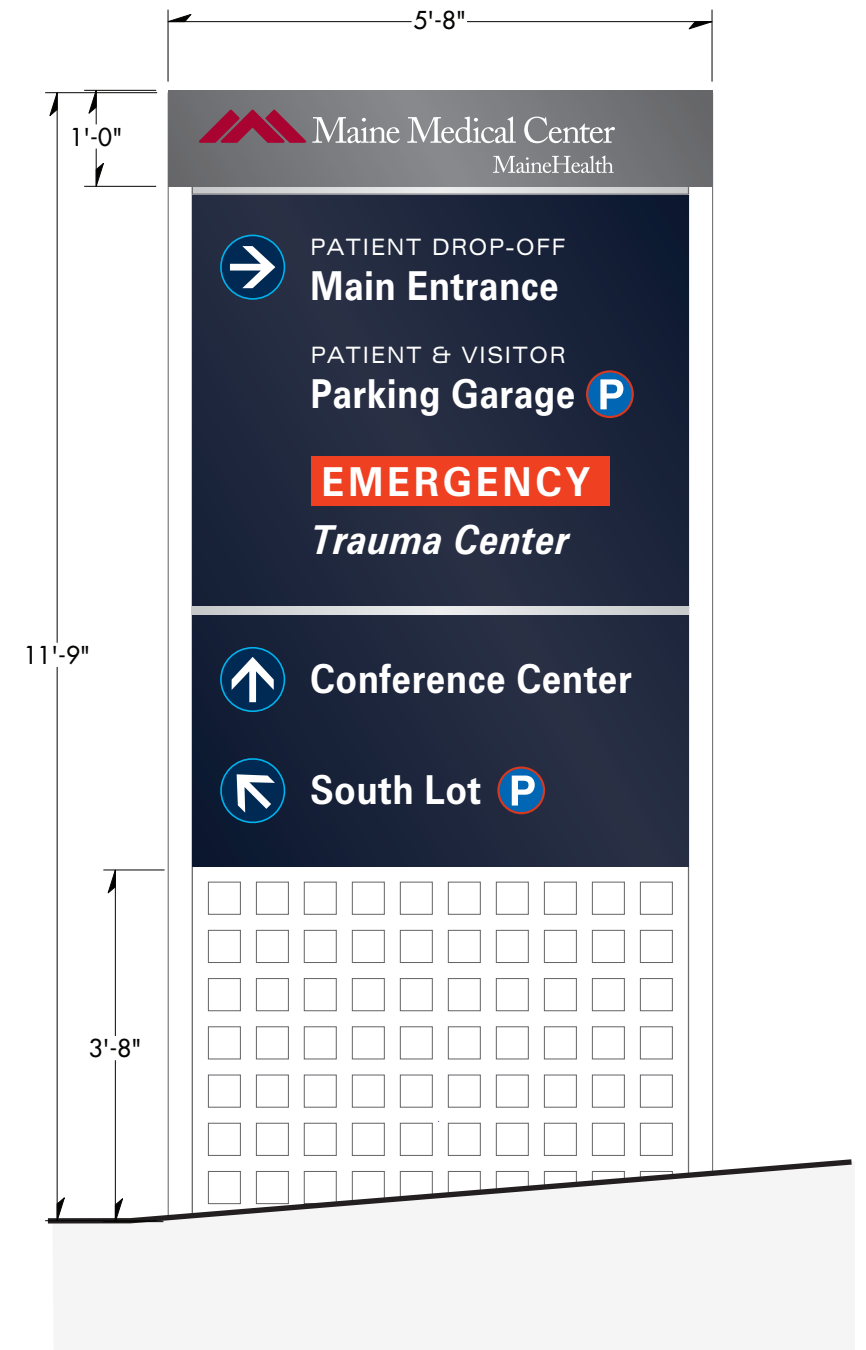

**D1** Primary Directional Sign D1-4  
4 Scale: 1/2" = 1'-0"

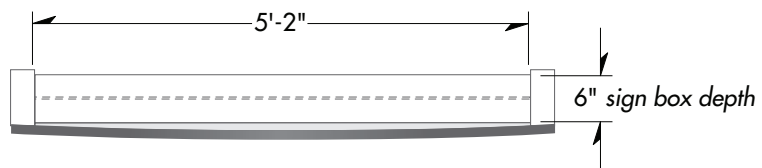

Top View typical

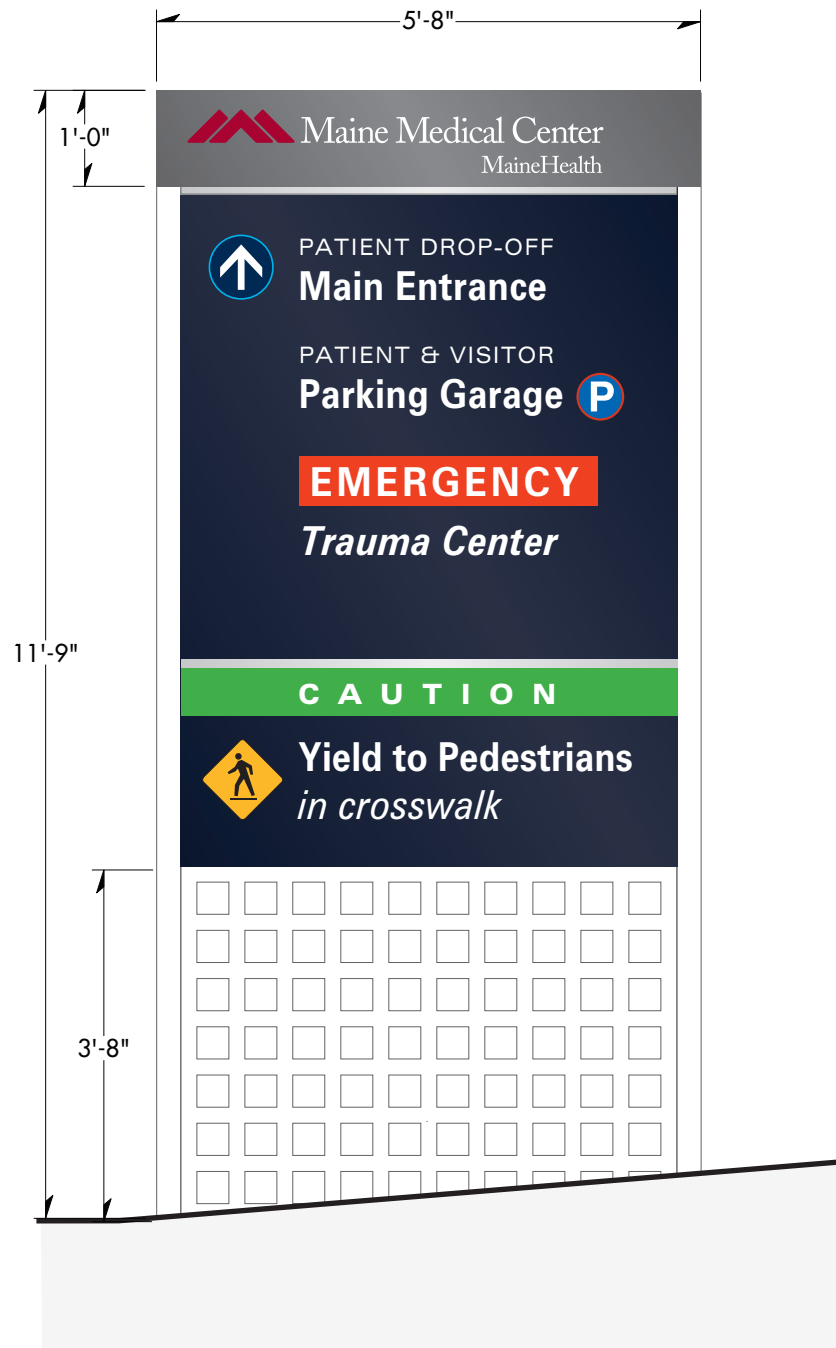

**D1** Primary Directional Sign D1-5  
**5** Scale: 1/2" = 1'-0"

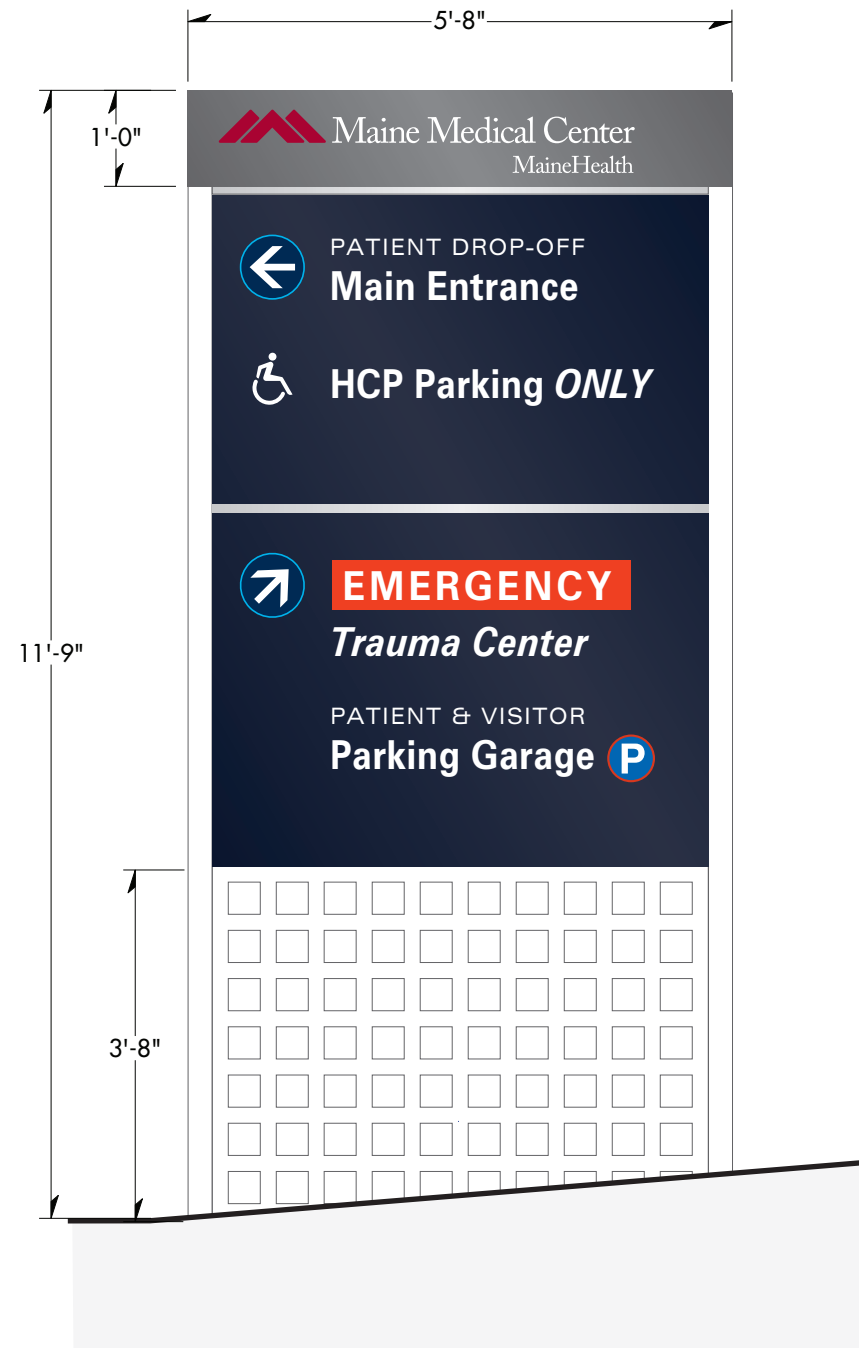

**D1** Primary Directional Sign D1-6  
**6** Scale: 1/2" = 1'-0"



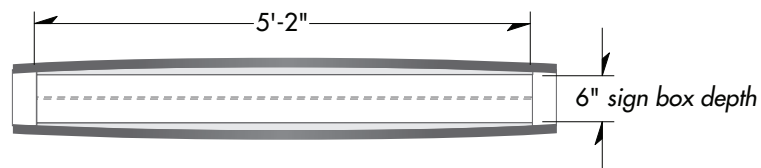

Top View D1.7 double-sided

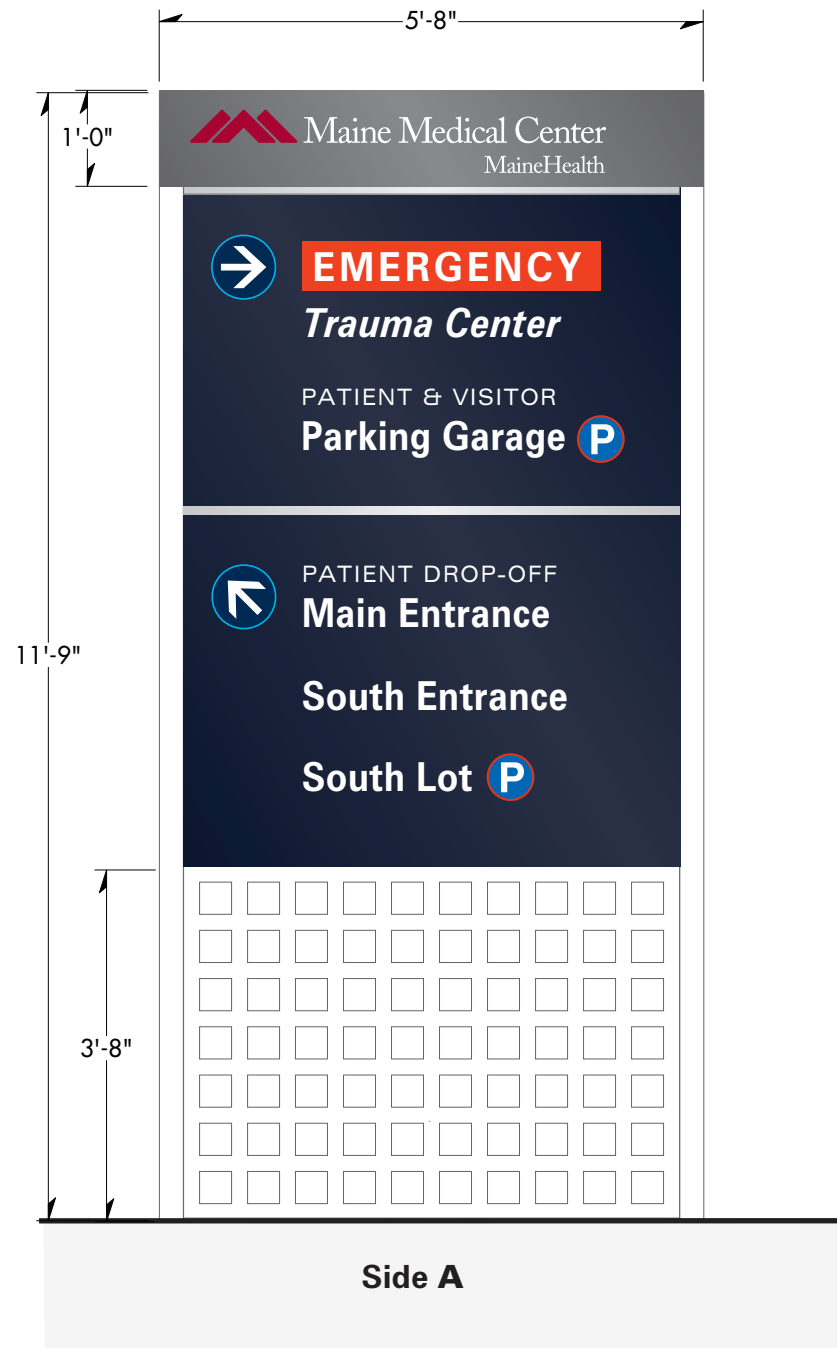

Side A

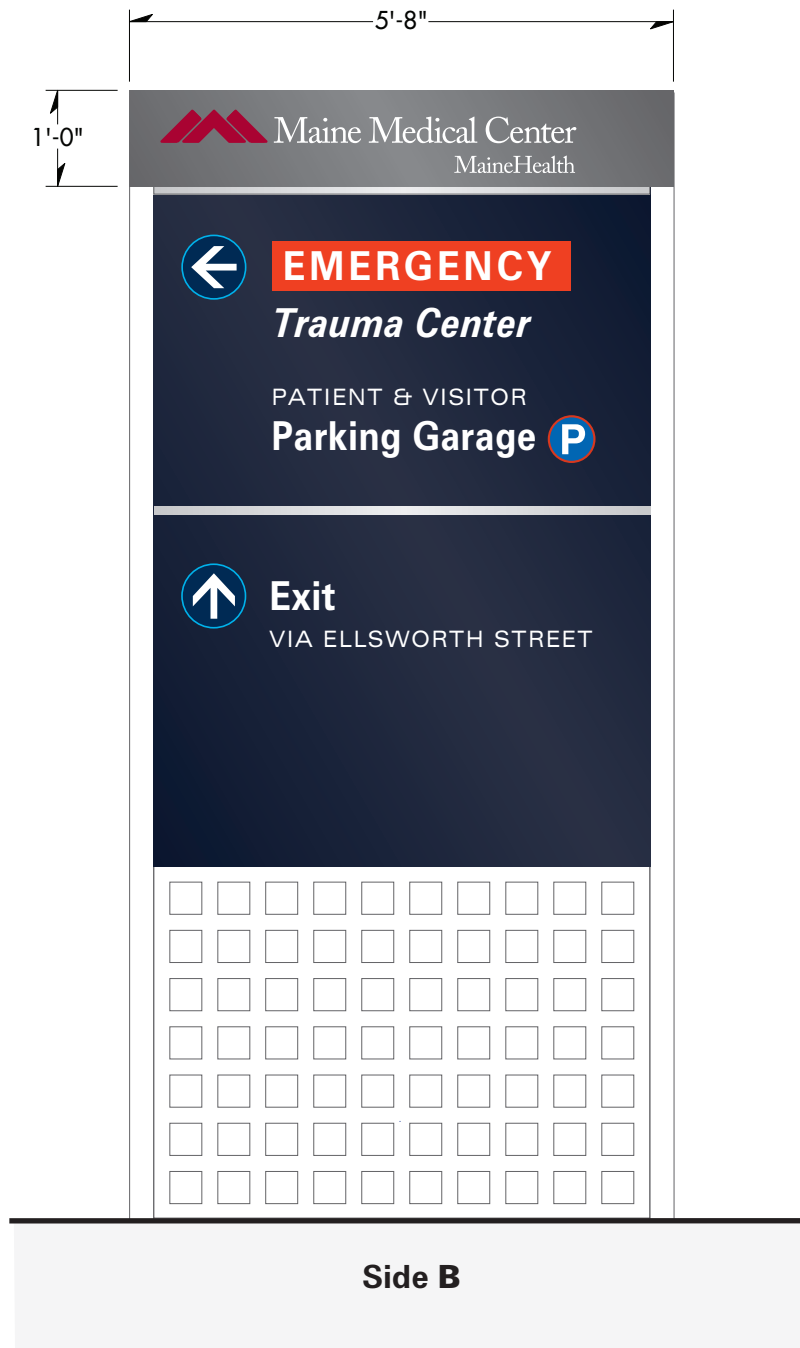

Side B

**D1** Primary Directional Sign Double-sided D1-7 side A  
7 Scale: 1/2" = 1'-0"

Primary Directional Sign Double-sided D1-7 side B  
Scale: 1/2" = 1'-0"

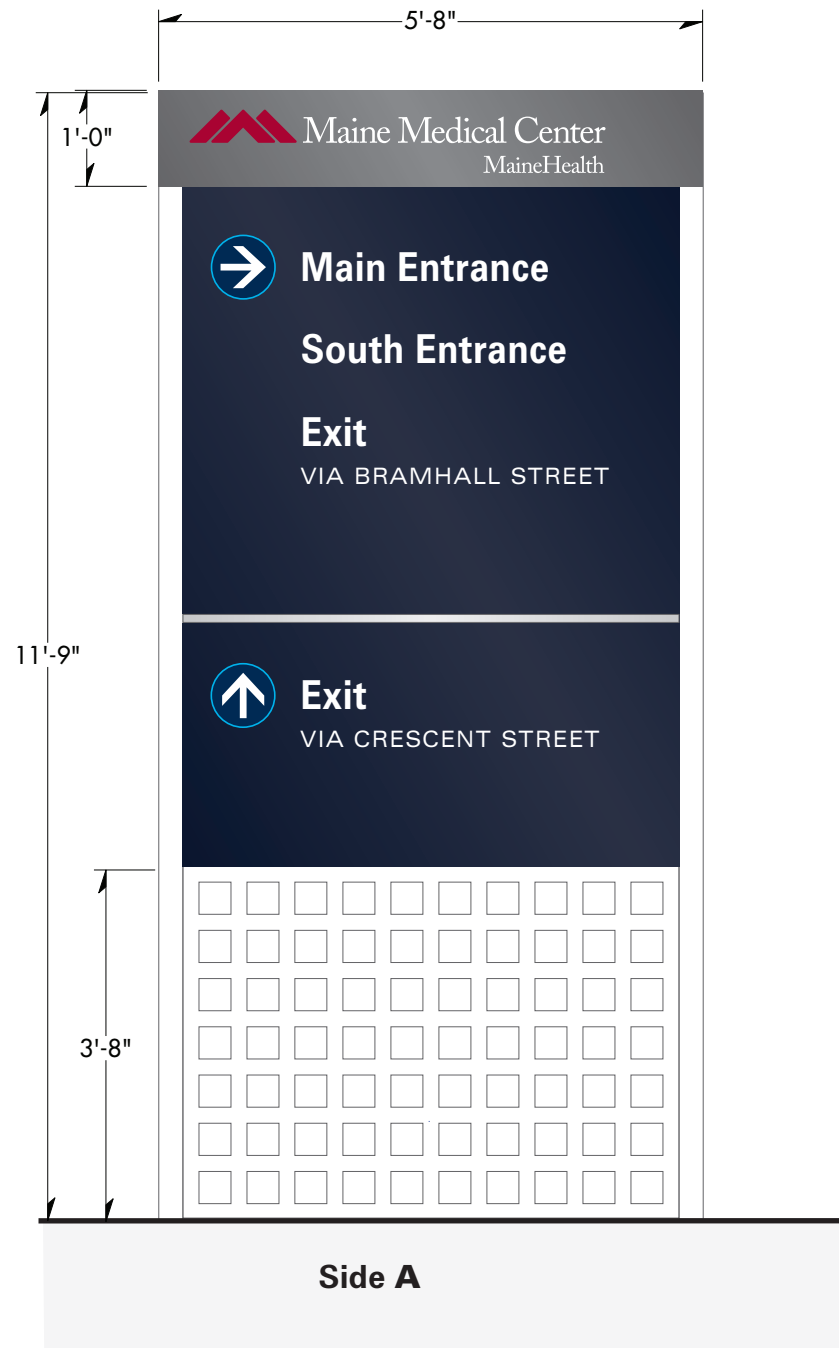

**D1** Primary Directional Sign *D1-8A*  
**8A** Scale: 1/2" = 1'-0"

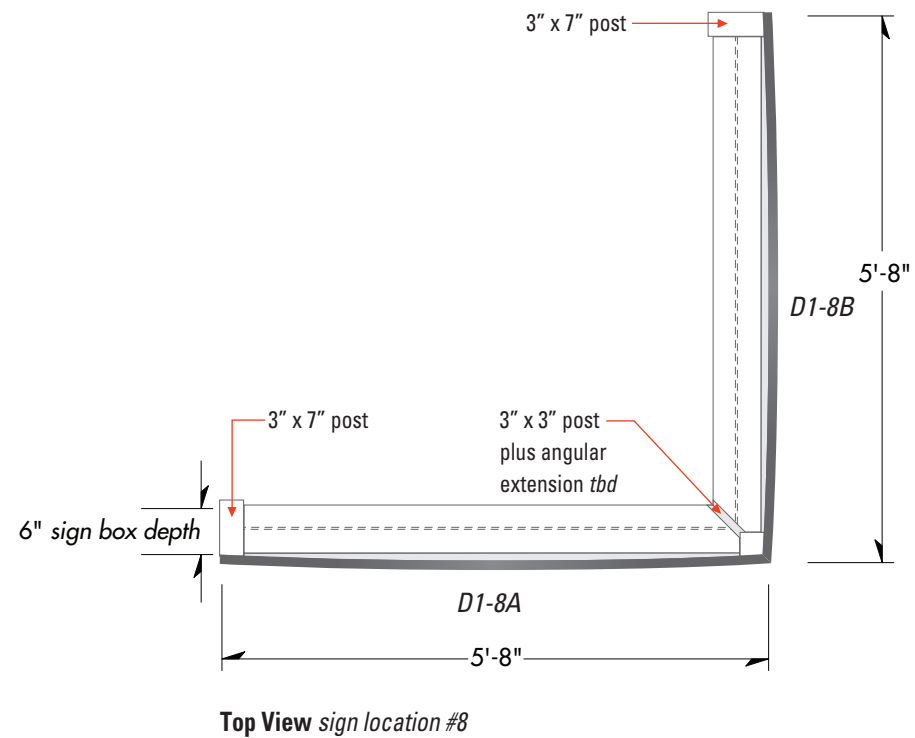

Top View sign location #8

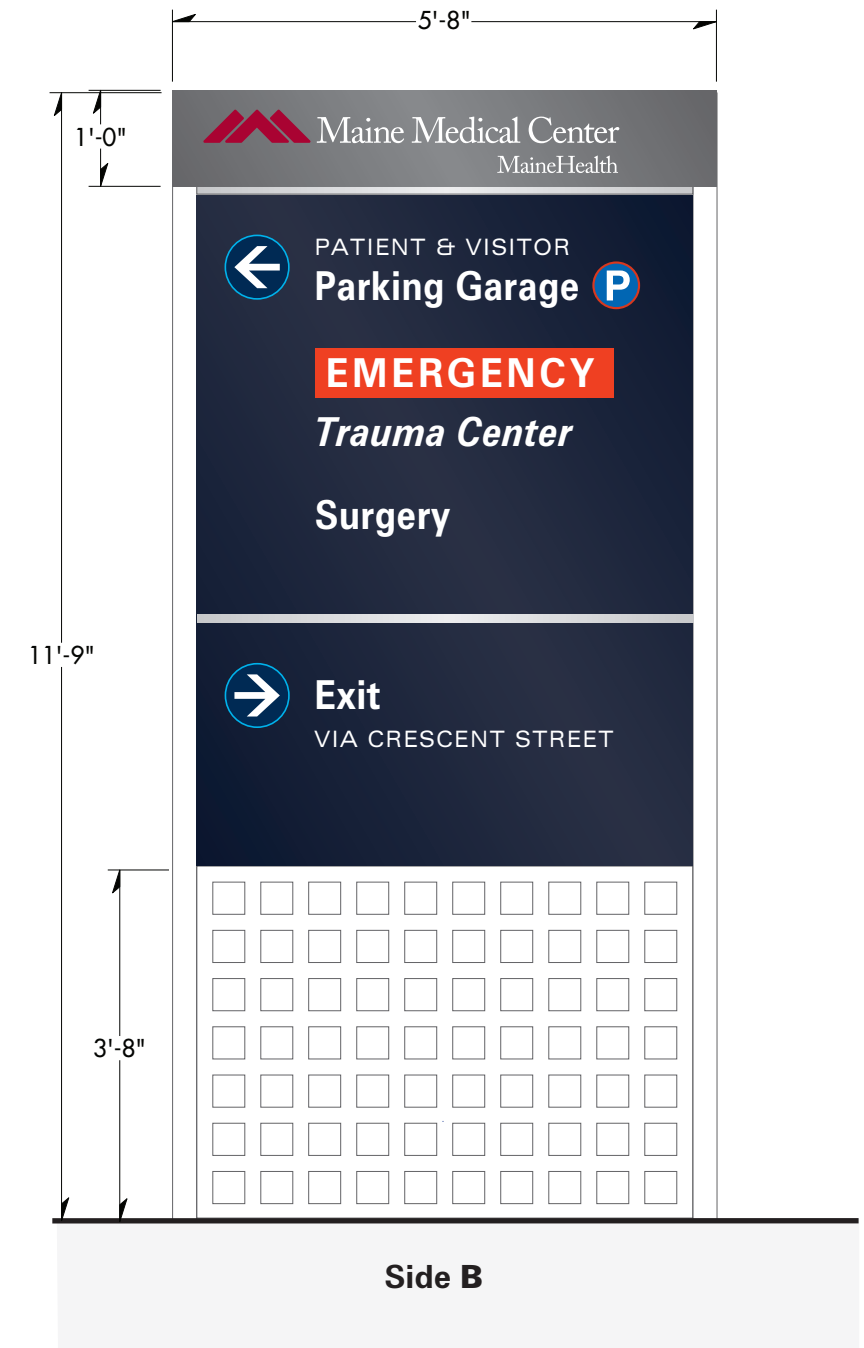

**D1** Primary Directional Sign *D1-8B*  
**8B** Scale: 1/2" = 1'-0"



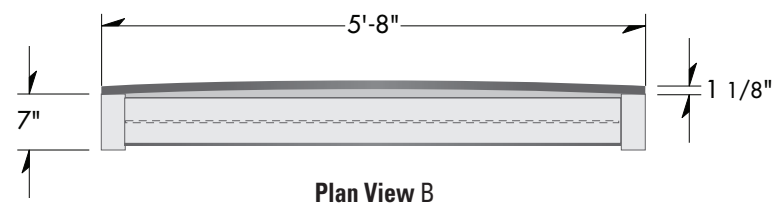

Side View

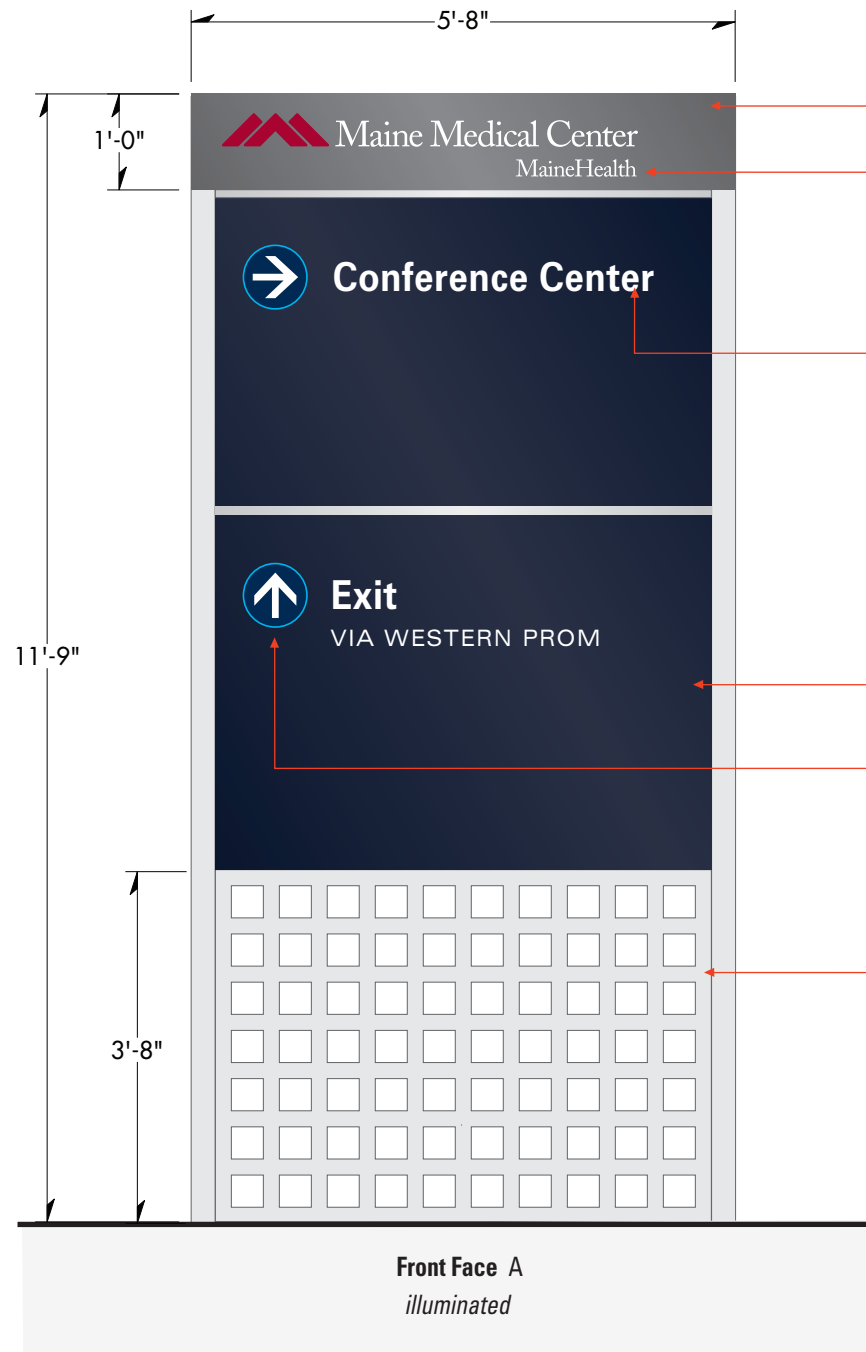
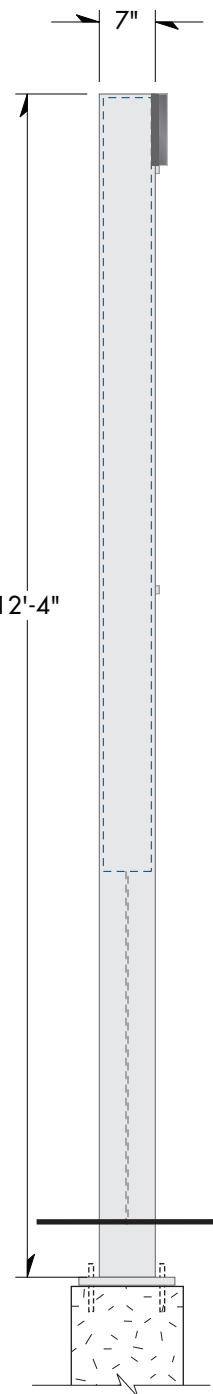
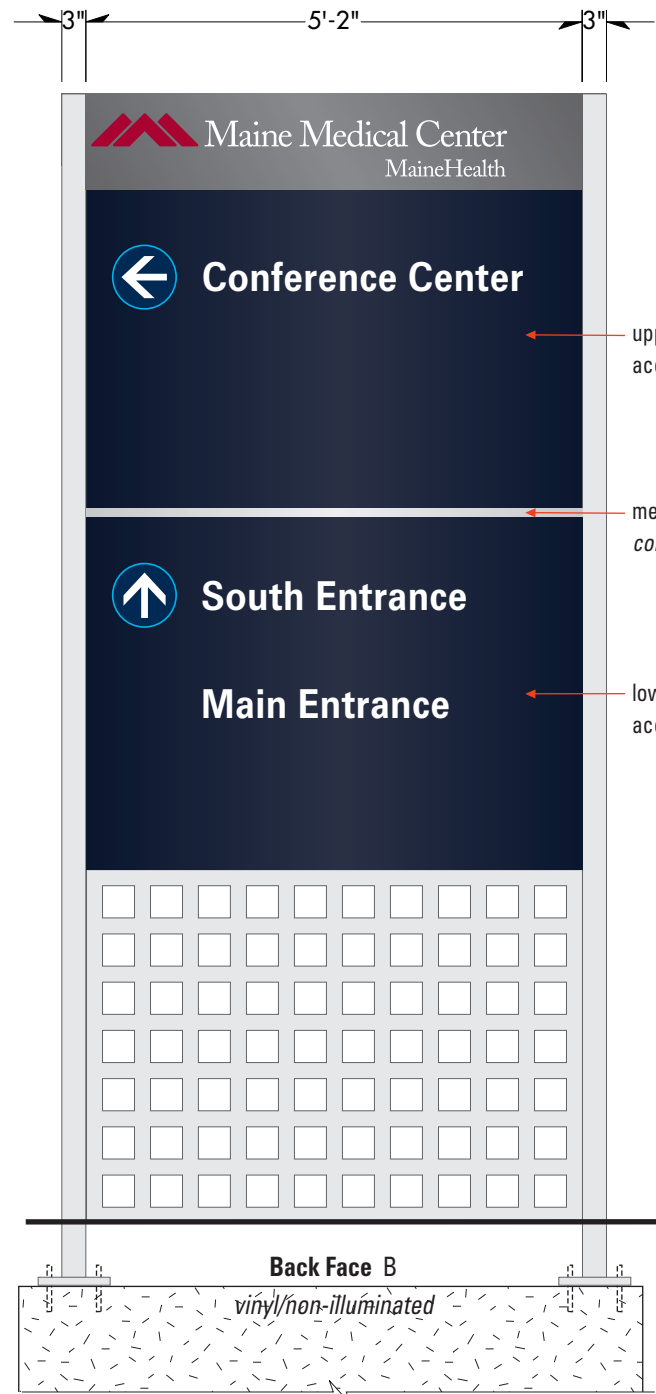
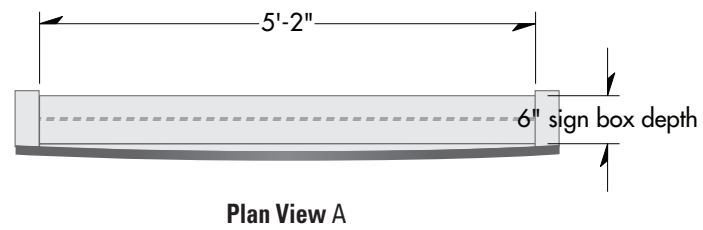

- "Warm Gray Metallic" MP# \_\_\_\_\_
- Graphics typical**  
Clear acrylic push through graphics w/ translucent vinyl on face "White" 3M#230-20
- Circles typical**  
Clear acrylic push through circle w/ vinyl graphics  
Arrow circle: "Dark Blue Metallic (?) " 3M#tbd w/ white illuminated arrow  
P circle: "Intense Blue" 3M#220-47 w/ white illuminated P and translucent "Red" outline 3M#230-33 for "Red" illumination
- "Midnight Blue Metallic" MP# \_\_\_\_\_
- Clear push through circle w/ "Bright Blue" 3M# \_\_\_\_\_ outline  
NOTE: illumination color surrounding circle push through to be "Bright Blue" (not white)
- "White" MP# \_\_\_\_\_ to match Duranar XL Silver Gray #UC50958

**D1** Primary Directional Sign Revised  
9 Scale: 1/2" = 1'-0"

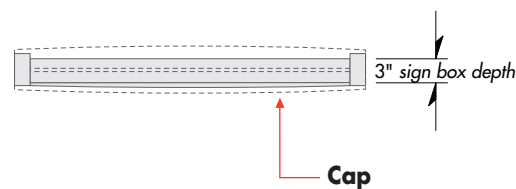

Top View typical

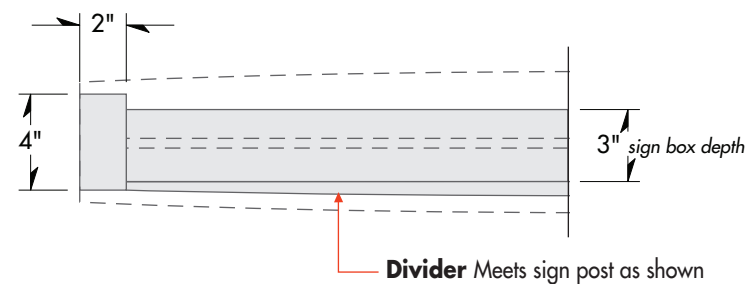

Detail 1 1/2" = 1'-0"

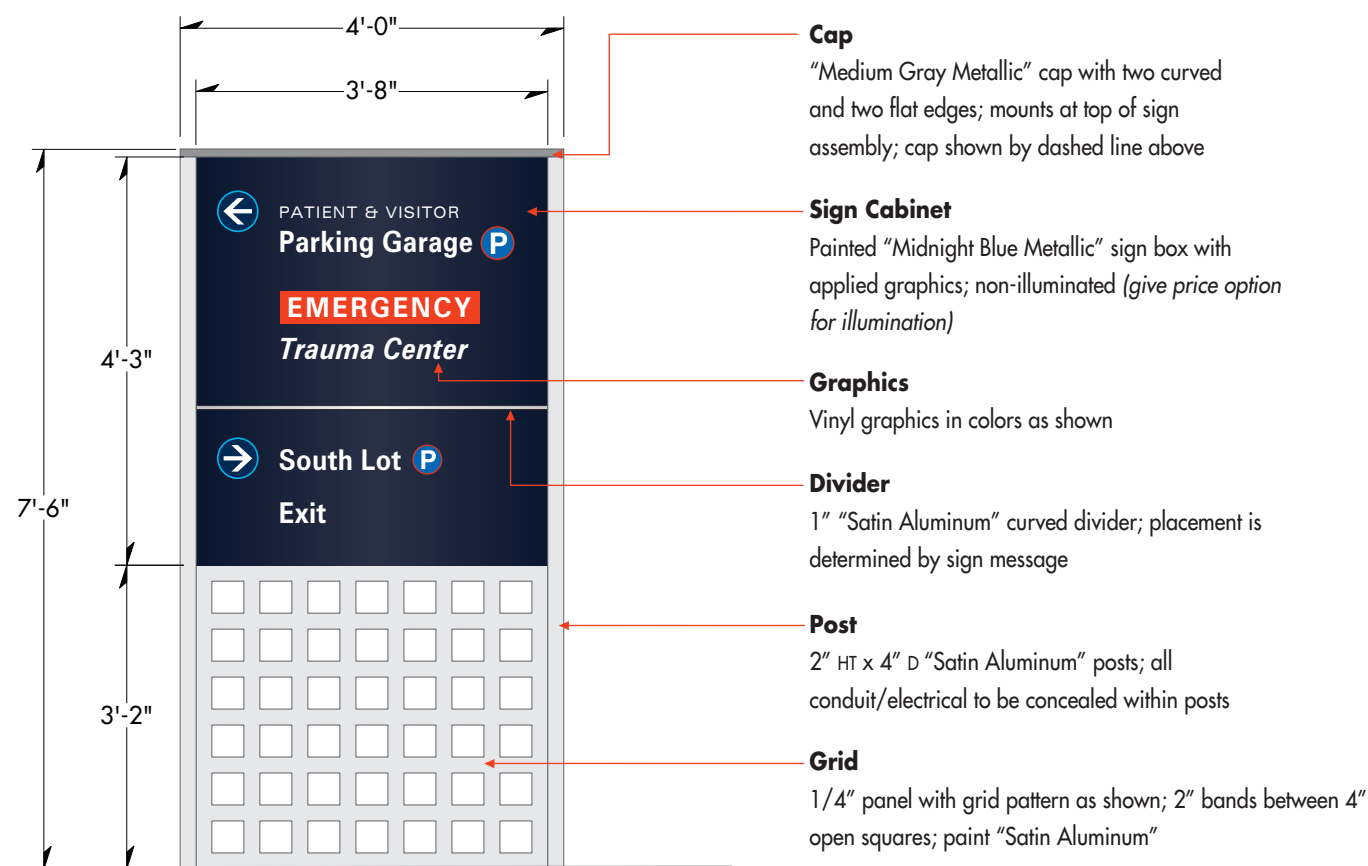

**D2** Secondary Directional Sign  
1 Scale: 1/2" = 1'-0"

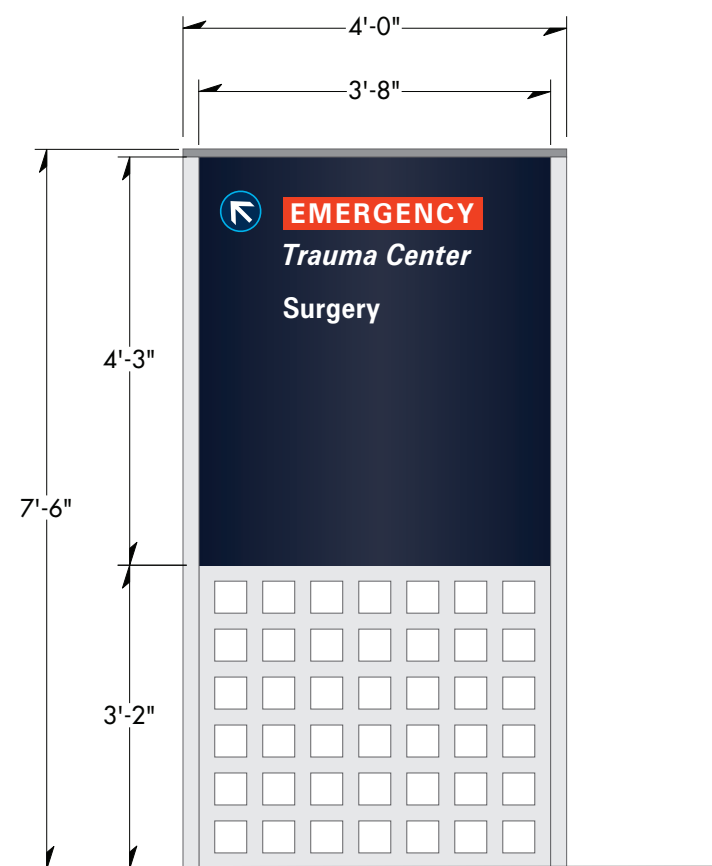

**D2** Secondary Directional Sign  
2 Scale: 1/2" = 1'-0"