

EXISTING	DESCRIPTION	PROPOSED
---	PROPERTY LINE/R.O.W.	---
---	ABUTTER LINE/R.O.W.	---
---	BUILDING	---
---	EDGE PAVEMENT	---
---	PAVEMENT SHOULDER	---
---	EDGE CONCRETE	---
---	CURB LINE	---
---	CONTOURS	---
---	SPOT GRADE	---
---	RETAINING WALL	---
---	DECIDUOUS TREE	---
---	CONIFEROUS TREE	---
---	SIGN	---
---	GAS	---
---	GAS GATE VALVE	---
---	GAS METER	---
---	GAS MANHOLE	---
---	WATER	---
---	WATER GATE VALVE	---
---	WATER SHUT OFF	---
---	HYDRANT	---
---	WATER MANHOLE	---
---	SANITARY MANHOLE	---
---	STORM DRAIN	---
---	UNDER DRAIN	---
---	DRAINAGE MANHOLE	---
---	CATCH BASIN	---
---	OVERHEAD UTILITY	---
---	UNDERGROUND UTILITY	---
---	TRANSFORMER PAD	---
---	ELECTRICAL MANHOLE	---
---	TELEPHONE MANHOLE	---
---	LIGHT POLE	---
---	UTILITY POLE	---
---	CITY WIRE	---
---	RIPRAP	---
---	INLET PROTECTION	---

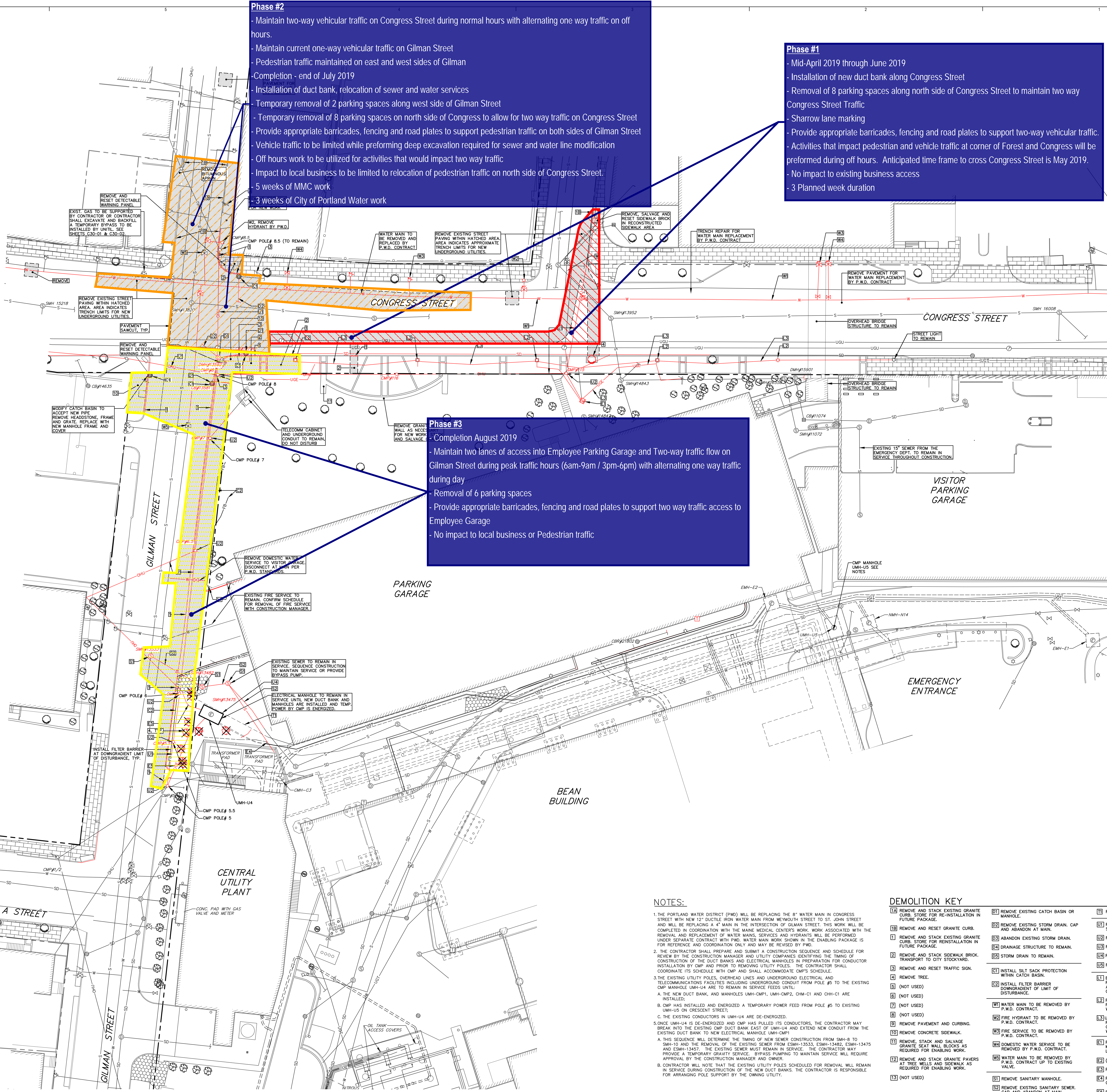

Phase #2

- Maintain two-way vehicular traffic on Congress Street during normal hours with alternating one way traffic on off hours.
- Maintain current one-way vehicular traffic on Gilman Street
- Pedestrian traffic maintained on east and west sides of Gilman
- Completion - end of July 2019
- Installation of duct bank, relocation of sewer and water services
- Temporary removal of 2 parking spaces along west side of Gilman Street
- Temporary removal of 8 parking spaces on north side of Congress to allow for two way traffic on Congress Street
- Provide appropriate barricades, fencing and road plates to support pedestrian traffic on both sides of Gilman Street
- Vehicle traffic to be limited while performing deep excavation required for sewer and water line modification
- Off hours work to be utilized for activities that would impact two way traffic
- Impact to local business to be limited to relocation of pedestrian traffic on north side of Congress Street.
- 5 weeks of MMC work
- 3 weeks of City of Portland Water work

Phase #1

- Mid-April 2019 through June 2019
- Installation of new duct bank along Congress Street
- Removal of 8 parking spaces along north side of Congress Street to maintain two way Congress Street Traffic
- Sharrow lane marking
- Provide appropriate barricades, fencing and road plates to support two-way vehicular traffic.
- Activities that impact pedestrian and vehicle traffic at corner of Forest and Congress will be performed during off hours. Anticipated time frame to cross Congress Street is May 2019.
- No impact to existing business access
- 3 Planned week duration

Phase #3

- Completion August 2019
- Maintain two lanes of access into Employee Parking Garage and Two-way traffic flow on Gilman Street during peak traffic hours (6am-9am / 3pm-6pm) with alternating one way traffic during day
- Removal of 6 parking spaces
- Provide appropriate barricades, fencing and road plates to support two way traffic access to Employee Garage
- No impact to local business or Pedestrian traffic

NOTES:

1. THE PORTLAND WATER DISTRICT (PWD) WILL BE REPLACING THE 8" WATER MAIN IN CONGRESS STREET WITH NEW 12" DUCTILE IRON WATER MAIN FROM MENDHAM STREET TO ST. JOHN STREET AND WILL BE REPLACING A 4" MAIN AT THE INTERSECTION OF GILMAN STREET. THIS WORK WILL BE COMPLETED IN COORDINATION WITH THE MAINE MEDICAL CENTER'S WORK ASSOCIATED WITH THE REMOVAL AND REPLACEMENT OF WATER MAINS, SERVICES AND HYDRANTS. THIS WORK WILL BE PERFORMED UNDER SEPARATE CONTRACT WITH PWD. WATER MAIN WORK SHOWN IN THE ENABLING PACKAGE IS FOR REFERENCE AND COORDINATION ONLY AND MAY BE REVISED BY PWD.
2. THE CONTRACTOR SHALL PREPARE AND SUBMIT A CONSTRUCTION SEQUENCE AND SCHEDULE FOR REVIEW BY THE CONSTRUCTION MANAGER AND UTILITY COMPANIES IDENTIFYING THE TRING OF CONSTRUCTION OF THE DUCT BANKS AND ELECTRICAL MANHOLES IN PREPARATION FOR CONDUCTOR INSTALLATION BY CMP AND PRIOR TO REMOVING UTILITY POLES. THE CONTRACTOR SHALL COORDINATE ITS SCHEDULE WITH CMP AND SHALL ACCOMMODATE CMP'S SCHEDULE.
3. THE EXISTING UTILITY POLES, OVERHEAD LINES AND UNDERGROUND ELECTRICAL AND TELECOMMUNICATIONS FACILITIES INCLUDING UNDERGROUND CONDUIT FROM POLE #5 TO THE EXISTING CMP MANHOLE UMH-U4 ARE TO REMAIN IN SERVICE FEEDS UNTIL:
 - A. THE NEW DUCT BANK, AND MANHOLES UMH-CMP1, UMH-CMP2, OIM-C1 AND OIM-C1 ARE INSTALLED;
 - B. CMP HAS INSTALLED AND ENERGIZED A TEMPORARY POWER FEED FROM POLE #5 TO EXISTING UMH-U4 ON CRESCENT STREET;
 - C. THE EXISTING CONDUCTORS IN UMH-U4 ARE DE-ENERGIZED.
5. ONCE UMH-U4 IS DE-ENERGIZED AND CMP HAS PULLED ITS CONDUCTORS, THE CONTRACTOR MAY BREAK INTO THE EXISTING CMP DUCT BANK EAST OF UMH-U4 AND EXTEND NEW CONDUIT FROM THE EXISTING DUCT BANK TO NEW ELECTRICAL MANHOLE UMH-CMP1.
- A. THIS SEQUENCE WILL DETERMINE THE TRING OF NEW SEWER CONSTRUCTION FROM SMH-8 TO SMH-10 AND THE REMOVAL OF THE EXISTING SEWER FROM SMH-13453, SMH-13462, SMH-13475 AND SMH-13487. THE EXISTING SEWER MUST REMAIN IN SERVICE. THE CONTRACTOR MAY PROVIDE A TEMPORARY GRAVITY SERVICE. BYPASS PUMPING TO MAINTAIN SERVICE WILL REQUIRE APPROVAL BY THE CONSTRUCTION MANAGER AND OWNER.
- B. CONTRACTOR WILL NOTE THAT THE EXISTING UTILITY POLES SCHEDULED FOR REMOVAL WILL REMAIN IN SERVICE DURING CONSTRUCTION OF THE NEW DUCT BANKS. THE CONTRACTOR IS RESPONSIBLE FOR ARRANGING POLE SUPPORT BY THE OWNING UTILITY.

DEMOLITION KEY

- | | | |
|---|--|--|
| [1] REMOVE AND STACK EXISTING GRANITE CURB. STORE FOR RE-INSTALLATION IN FUTURE PACKAGE. | [21] REMOVE EXISTING CATCH BASIN OR MANHOLE. | [41] REMOVE MMC TELECOMM CONDUIT. |
| [2] REMOVE AND RESET GRANITE CURB. | [22] REMOVE EXISTING STORM DRAIN, CAP AND ABANDON AT MAIN. | [42] REMOVE OVERHEAD UTILITIES AND SERVICES. |
| [3] REMOVE AND STACK EXISTING GRANITE CURB. STORE FOR RE-INSTALLATION IN FUTURE PACKAGE. | [23] ABANDON EXISTING STORM DRAIN. | [43] REMOVE UTILITY POLE AND GUY. |
| [4] REMOVE AND RESET TRAFFIC SIGN. | [24] BRANCH STRUCTURE TO REMAIN. | [44] REPLACE UTILITY POLE AND GUY. |
| [5] REMOVE TREE. | [25] STORM DRAIN TO REMAIN. | [45] REMOVE ELECTRICAL MANHOLE. |
| [6] (NOT USED) | [26] INSTALL SILT SACK PROTECTION WITHIN CATCH BASIN. | [46] REMOVE A/C UNIT. |
| [7] (NOT USED) | [27] INSTALL FILTER BARRIER DOWNSTREAM OF LIMIT OF DISTURBANCE. | [47] EXISTING STREET LIGHTING TO REMAIN. REMOVE, STORE AND RESET AS REQUIRED FOR NEW CONSTRUCTION. |
| [8] (NOT USED) | [28] WATER MAIN TO BE REMOVED BY P.W.D. CONTRACT. | [48] REMOVE AND SALVAGE STREET LIGHT POLE AND FIXTURES. REMOVE BASE WHERE NECESSARY FOR NEW WORK. |
| [9] REMOVE PAVEMENT AND CURBING. | [29] FIRE HYDRANT TO BE REMOVED BY P.W.D. CONTRACT. | [49] UNDERGROUND LIGHTING CONDUIT. REMOVE CONDUCTORS. REMOVE CONDUIT WHERE REQUIRED FOR NEW WORK. |
| [10] REMOVE CONCRETE SIDEWALK. | [30] FIRE SERVICE TO BE REMOVED BY P.W.D. CONTRACT. | [51] REMOVE AND REPLACE ELECTRICAL METER AND SERVICE FOR STREET LIGHTING. |
| [11] REMOVE STACK AND SALVAGE GRANITE SEAT WALL BLOCKS AS REQUIRED FOR ENABLING WORK. | [31] DOMESTIC WATER SERVICE TO BE REMOVED BY P.W.D. CONTRACT. | [52] (NOT USED) |
| [12] REMOVE AND STACK GRANITE PAVERS AT THE WELLS AND SIDEWALK AS REQUIRED FOR ENABLING WORK. | [32] WATER MAIN TO BE REMOVED BY P.W.D. CONTRACT UP TO EXISTING VALVE. | [53] REMOVE ELECTRICAL MANHOLE. |
| [13] (NOT USED) | [33] REMOVE SANITARY MANHOLE. | [54] REMOVE ELECTRICAL DUCT BANK TO CUT IN LOCATION. |
| | [34] REMOVE EXISTING SANITARY SEWER, CAP AND ABANDON AT MAIN. | [55] REMOVE ELECTRICAL CONDUIT/DUCT BANK POLE #5 TO MANHOLE. |
| | [35] MODIFY SEWER MANHOLE TO REMAIN. | |
| | [36] SANITARY SEWER TO REMAIN. | |

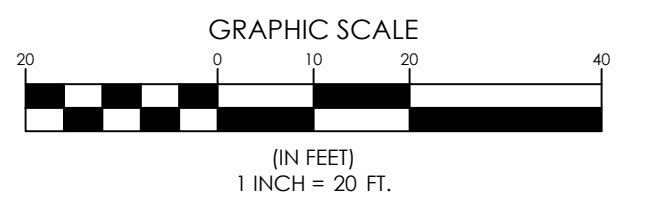

- CONSULTANTS**
- CONV./LANDSCAPE ARCHITECT
 Sebago Technics Inc.
 75 John Roberts Road, Suite 4A,
 South Portland, ME 04106
 - STRUCTURAL ENG. BUILDING ENVELOPE CONSULTANT
 Simpson Gumpertz & Heger Inc.
 41 Sevon Street Building 3, Suite 500,
 Waltham, MA 02453
 - MEPPY ENGINEERS/CONV. VOLTAGE
 AKF Group LLC
 99 Bedford Street, 2nd Floor, Boston, MA 02111
 - CONSTRUCTION MANAGER
 TURNER CONSTRUCTION
 2 Seaport Lane, Suite 205, Boston, MA 02210
 - ELEVATOR CONSULTANT
 VDA (Van Deusen & Associates)
 101 Summer Street, 4th Floor, Boston, MA 02110
 - COST ESTIMATOR
 D.G. Jones International
 3 Balcorn Green Common, Suite 202, Woburn, MA 01801
 - MEDICAL EQUIPMENT PLANNING
 Mitchell Planning
 630 Dundee Road, Suite 340, Northbrook, IL 60062

PROJECT TITLE
 Congress Street
 Building
 22 Bramhall Street
 Portland ME 04102

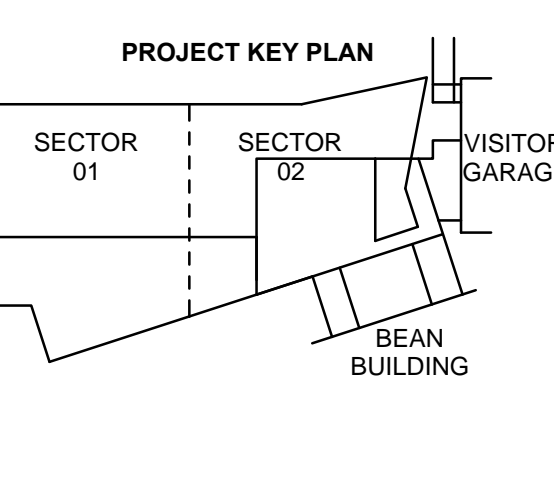
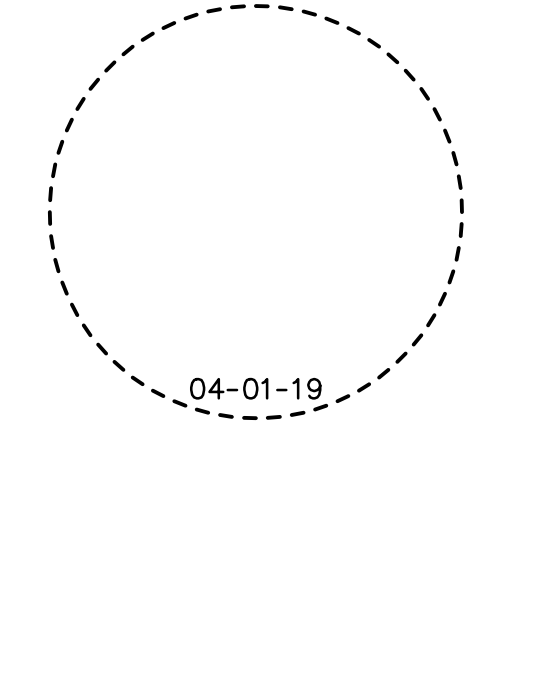

- OVERALL KEY PLAN**
- 1- NOT USED
 - 2- CONGRESS STREET
 - 3- VISITOR GARAGE
 - 4- EAST TOWER
 - 5- CENTRAL UTILITY PLANT
 - 6- BEAN BUILDING
 - 7- RICHARDS BUILDING
 - 8- MAINE GENERAL BUILDING

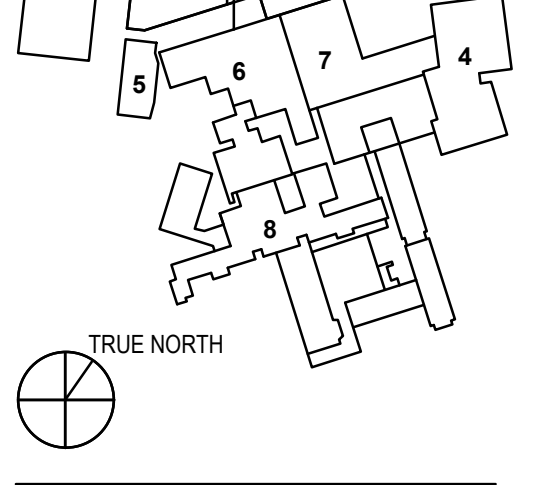

CONGRESS STREET ENABLING PACKAGE PERMIT SET
 APRIL 01, 2019

NO.	ISSUE	DATE
Job Number	152189.000	
Drawn	MAL/AMM	
Checked	DLR	
Approved	DLR	

DEMOLITION PLAN / CONGRESS STREET ENABLING WORK

SHEET NUMBER
 C01-01