

PERKINS

+ WILL

225 Franklin Street, Suite 1100
Boston, MA 02110
617.478.0300
617.478.0321
www.perkinswill.com

CLIENT



Maine Medical Center

22 Bramhall Street
Portland, ME 04102

CONSULTANTS

CIVIL/LANDSCAPE ARCHITECT

Sebaro Technics Inc.
75 John Roberts Road, Suite 1A,
South Portland, ME 04106

STRUCTURAL/ENGR. BUILDING ENVELOPE CONSULTANT

Simpson Gumpertz & Heger Inc.
41 Seport Street, Building 1, Suite 500,
Watertown, MA 02453

MEPE/ENGINEER/COOLING VOLTAGE

AKF Group LLC
98 Bedford Street, 2nd Floor, Boston, MA 02111

CONSTRUCTION MANAGER

TURNER CONSTRUCTION
2 Seaport Lane, Suite 200, Boston, MA 02210

ELEVATOR CONSULTANT

VDA (Van Dusen & Associates)
101 Summer Street, 4th Floor, Boston, MA 02110

COST ESTIMATOR

D.G. Jones International
3 Bakers Green Common, Suite 202, Woburn, MA 01801

MEDICAL EQUIPMENT PLANNING

Mitchell Planning
630 Dundee Road, Suite 340, Northbrook, IL 60062

PROJECT TITLE

Congress Street Building
22 Bramhall Street
Portland, ME 04102

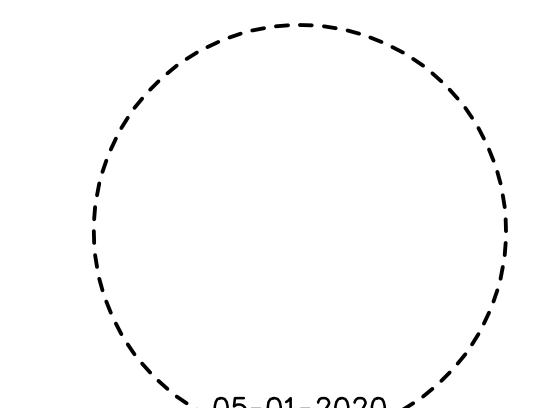

KEY PLANS

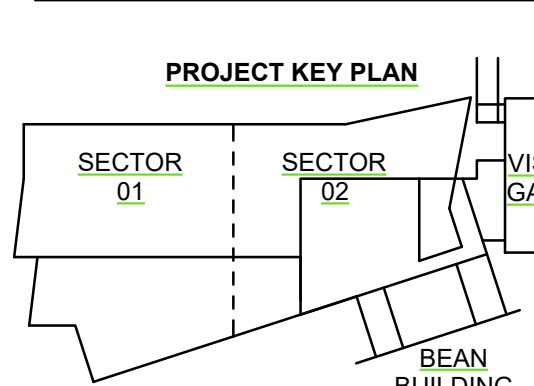

OVERALL KEY PLAN

- 1 - NOT USED
- 2 - CONGRESS STREET
- 3 - VISITOR GARAGE
- 4 - EAST TOWER
- 5 - CENTRAL UTILITY PLANT
- 6 - BEAN BUILDING
- 7 - RICHARDS BUILDING
- 8 - MAINE GENERAL BUILDING

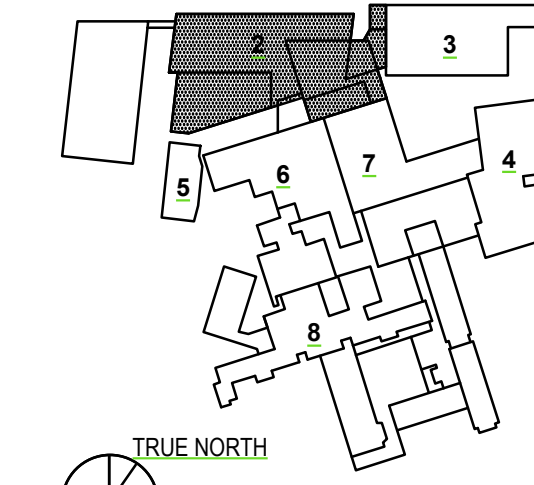

NO.	ISSUE	DATE

Job Number 152189.000
 Drawn MAL
 Checked WTC
 Approved DLR

TITLE
**GILMAN STREET
EASEMENT EXHIBIT**

SHEET NUMBER

03